

REV. A		SHEET 1 OF 2		RVPX-JE208EXX	
REVISIONS					
LTR	DESCRIPTION			DATE	
A	INITIAL RELEASE			17-DEC-19	

PART MARKING AS FOLLOWS
AMPHENOL 77820
'DATE CODE'

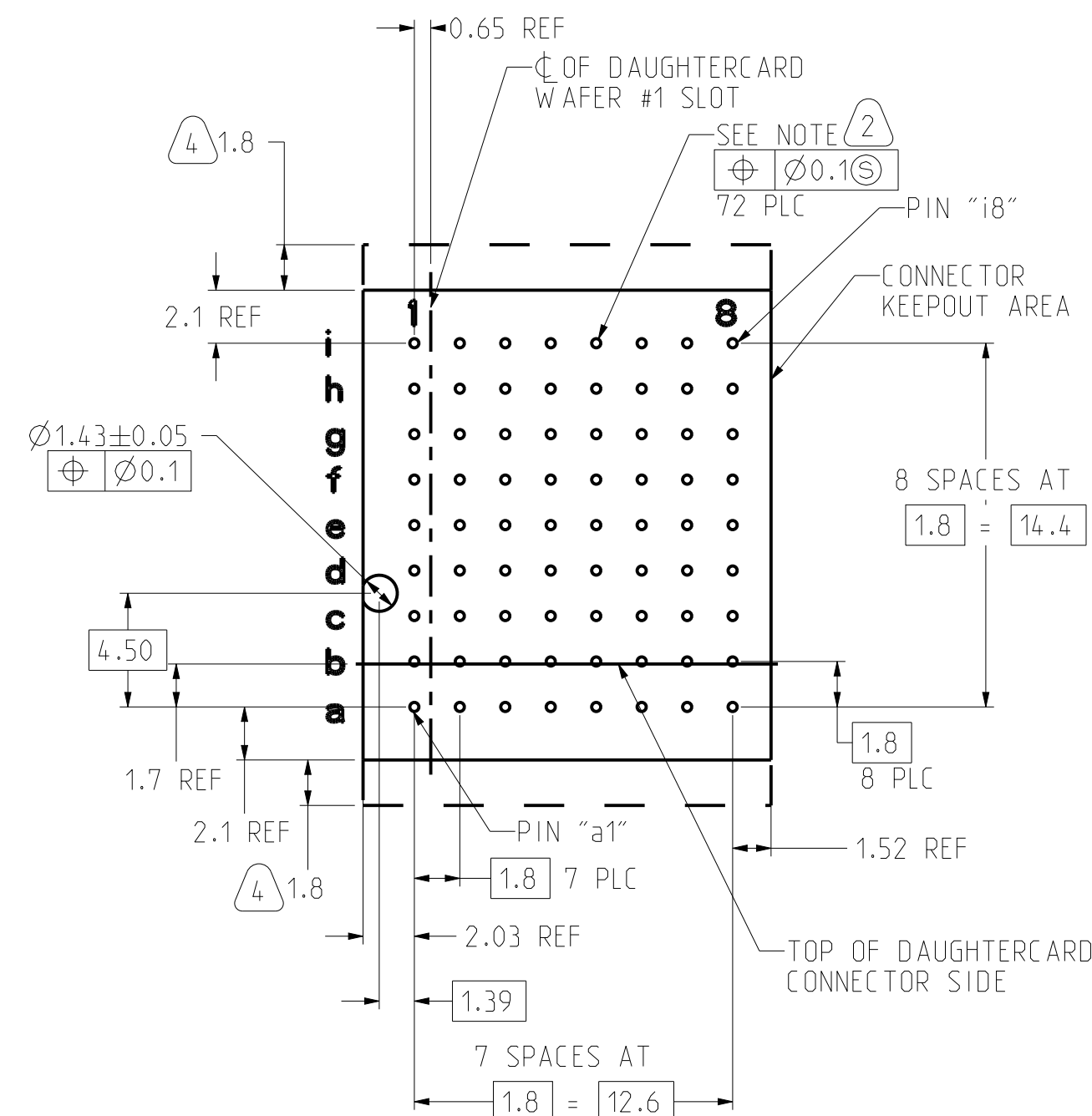
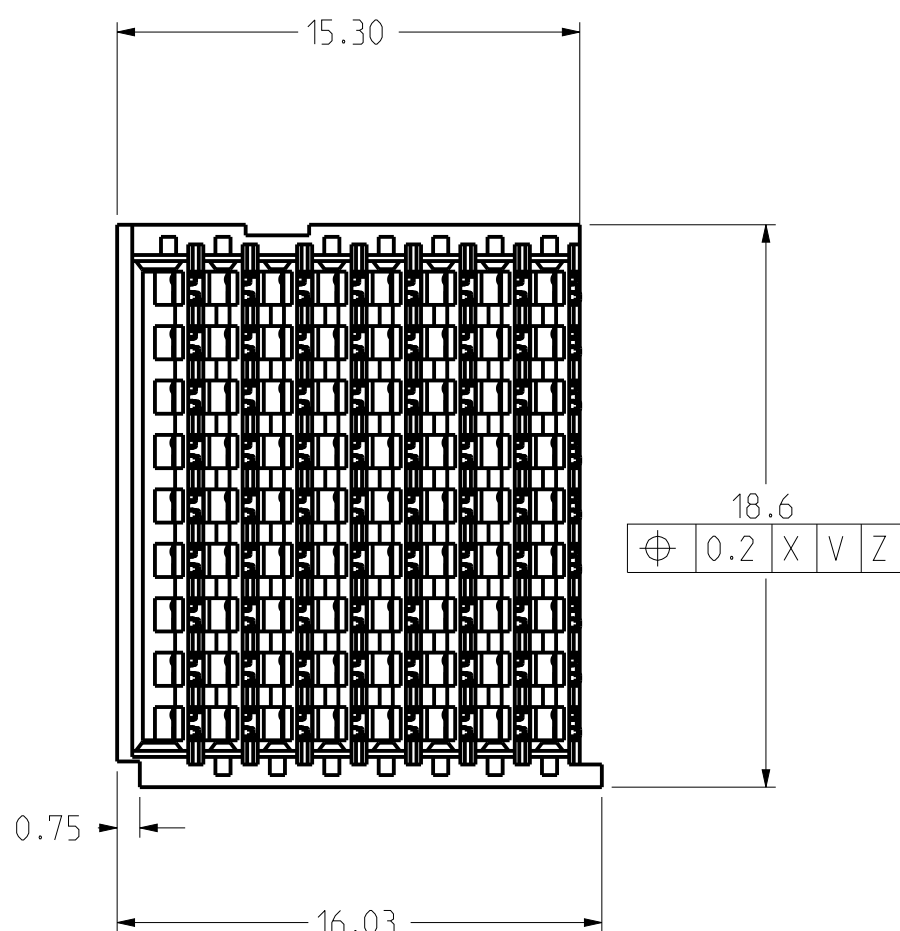
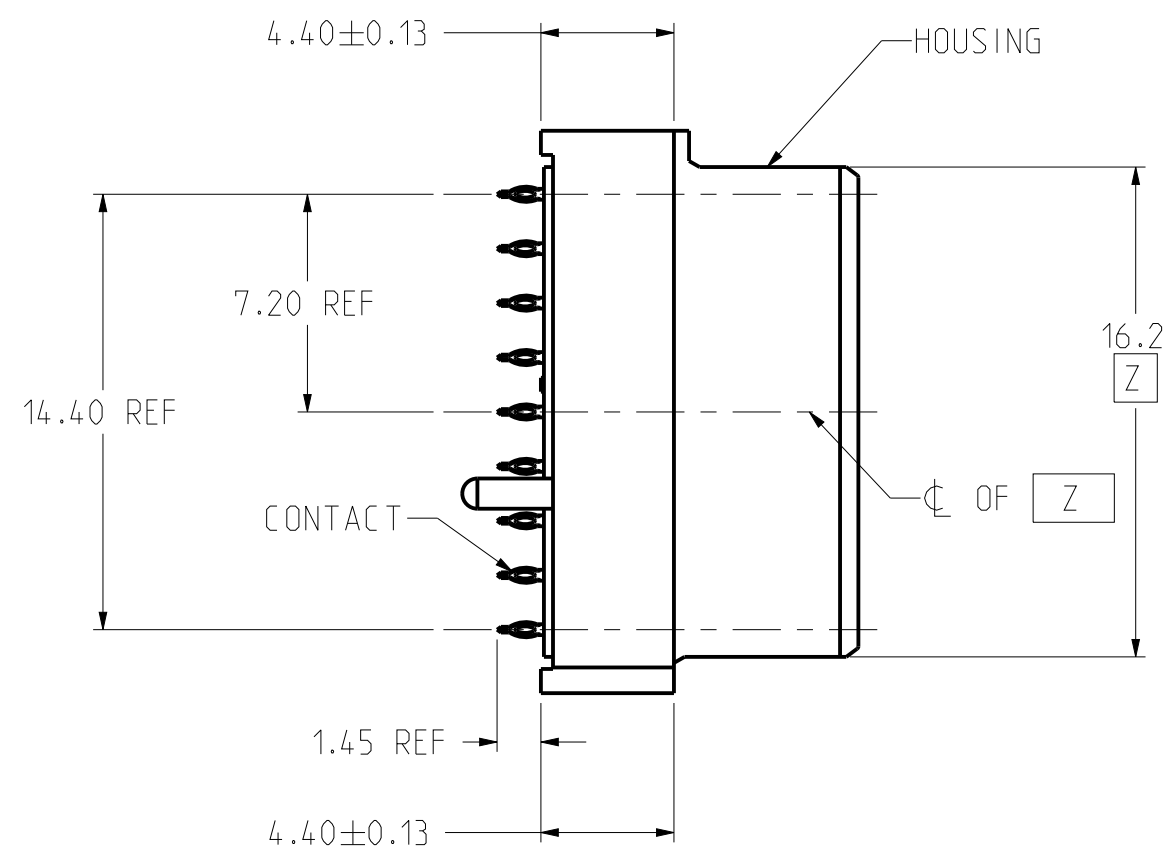
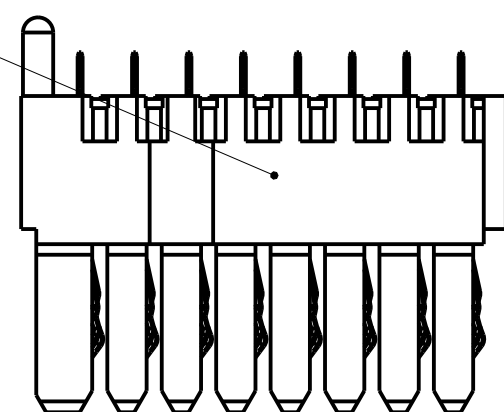

PC BOARD LAYOUT
(CONNECTOR SIDE)
SCALE 4/1
TABLE 1

PART MARKING AS FOLLOWS
'AAO PART NUMBER' (SEE TABLE 1)
'WORK ORDER NUMBER AS LOT NUMBER'

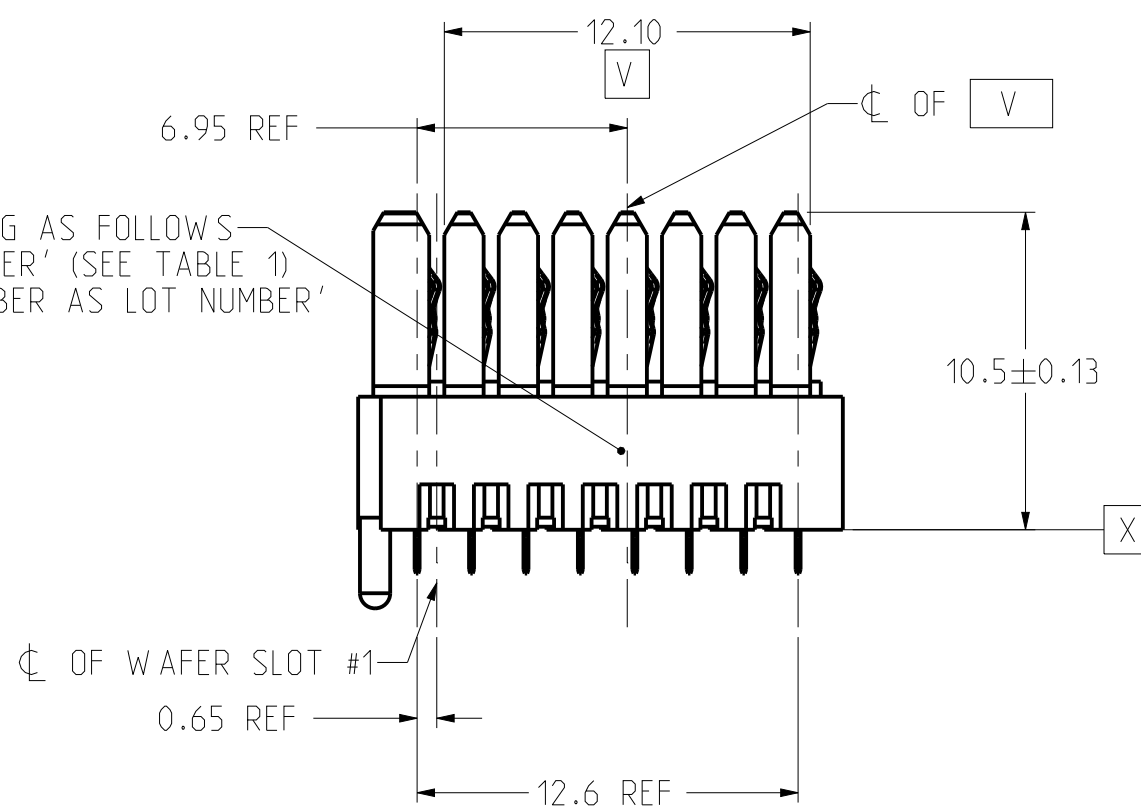

PLATING THICKNESS AND MATERIAL BY PART NUMBER			
PART NUMBER	GOLD IN CONTACT AREA	COMPLIANT	NICKEL OVERALL
RVPX-JE208EM1	50 μ-INCH MIN	50 μ-INCH MIN TIN	50 μ-INCH MIN
RVPX-JE208EM2	50 μ-INCH MIN	50 μ-INCH MIN TIN-LEAD	50 μ-INCH MIN
RVPX-JE208EC1	30 μ-INCH MIN	50 μ-INCH MIN TIN	50 μ-INCH MIN
RVPX-JE208EC2	30 μ-INCH MIN	50 μ-INCH MIN TIN-LEAD	50 μ-INCH MIN

- 4 ADDITIONAL CONNECTOR-SIDE KEEPOUT AREA REQUIRED IF CONNECTOR-SIDE EXTRACTION TOOL IS TO BE USED.
- 3 SEE TABLE 1 FOR PART NUMBER AND FINISHES
- 2 PTH CALLOUT TYPICAL HOLE
Ø0.43-.47 DRILL
Ø0.36 ±.05 FINISH HOLE
Ø0.75 PAD
- 1 HOUSING: GLASS FILLED LCP, UL94 - V0
CONTACT: CU ALLOY

NOTES:

THE USE OF THIS DOCUMENT IS UNLIMITED. HOWEVER, DOCUMENTS REFERENCED HEREON MAY CONTAIN LIMITED RIGHTS DATA.

UNLESS OTHERWISE SPECIFIED		SPECIFICATIONS		POS	QTY	PART NUMBER	DESCRIPTION	NOTE
LINEAR DIMENSIONS ARE IN MILLIMETERS TOLERANCES: .XXXX = ±. - ANGLES= ±1° .XXX = ±. - .XX = ±.13 .X = ±.5		MATERIAL SPEC. N/A		APPROVALS		DATE		PARTS LIST AMPHENOL CORPORATION 40-60 DELAWARE AVENUE SIDNEY, N.Y. 13858 CONNECTOR ASSEMBLY, BACKPLANE VERTICAL RECEPTACLE, 8 POS, END RVPX EVO 2
DIM.& TOL. PER ASME Y14.5M; DRM PER MIL-DTL-31000; OTHER Amphenol Stds. PER 9-3800		PROCESS SPEC. 9-3895 9-3856-5		PREPARED BY S.LANGELIER	ENGINEER IN CHARGE S.LANGELIER	17-DEC-19		
LEGENDS: =FLAG NOTE CALL OUT REFERENCE ONLY		THIRD ANGLE PROJECTION		DESIGN MANAGER G.PECK	DESIGN ACTIVITY GROUP BOARD LEVEL			
PRO/ENGINEER INFORMATION Pro/e Model Used: RVPX-JE208EXX.ASSEM Drawing Name: RVPX-JE208EXX		NONE		NEXT ASSEMBLY		SIZE C	CAGE CODE 77820	DOCUMENT NO. RVPX-JE208EXX
RELEASED / Jan. 14 2020, 2:35:51 PM		SCALE: 4/1		REF. RVPX-J08EXX		SHEET 1 OF 2		REV. A

REAR TRANSITION MODULE APPLICATION

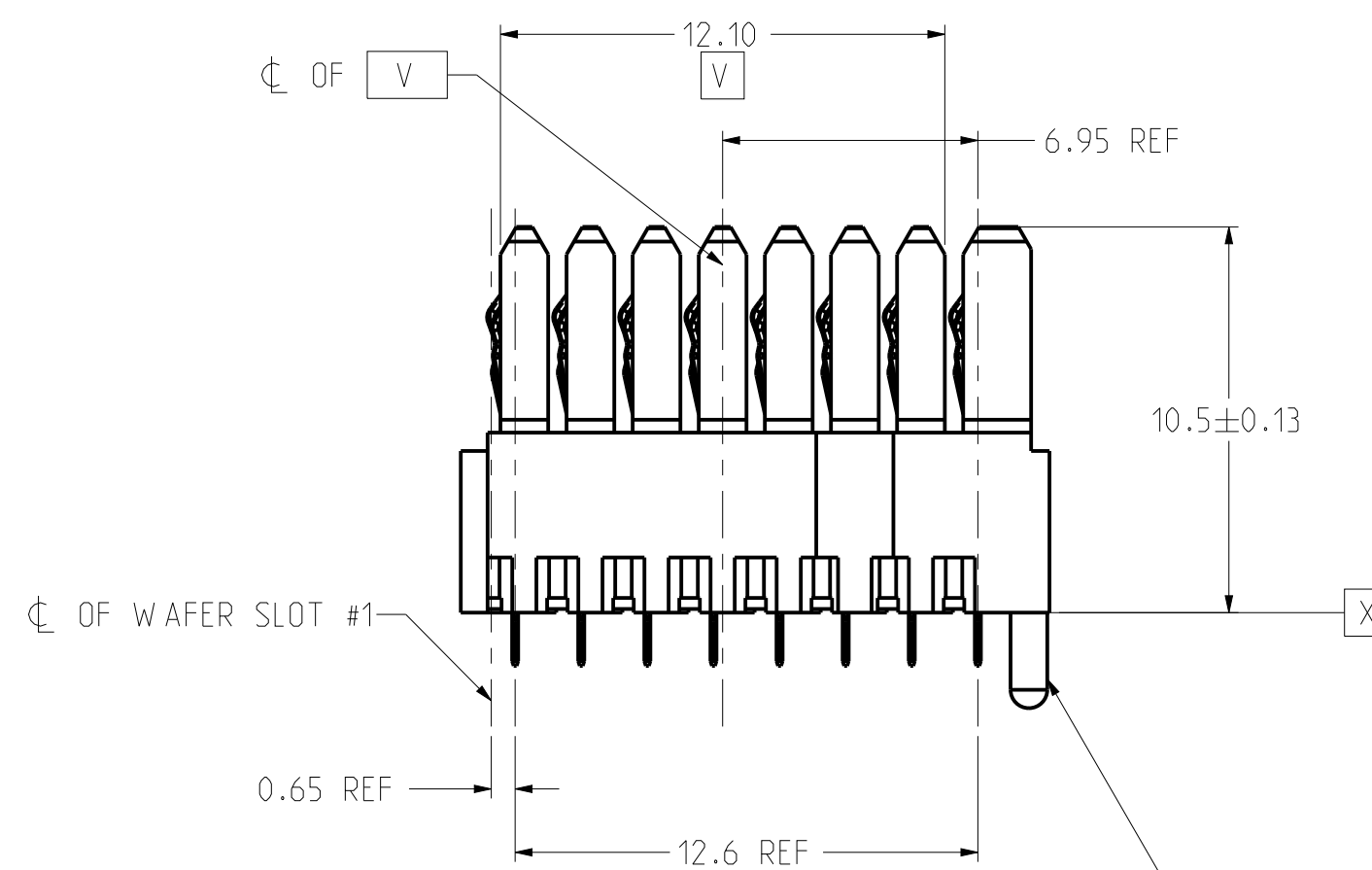
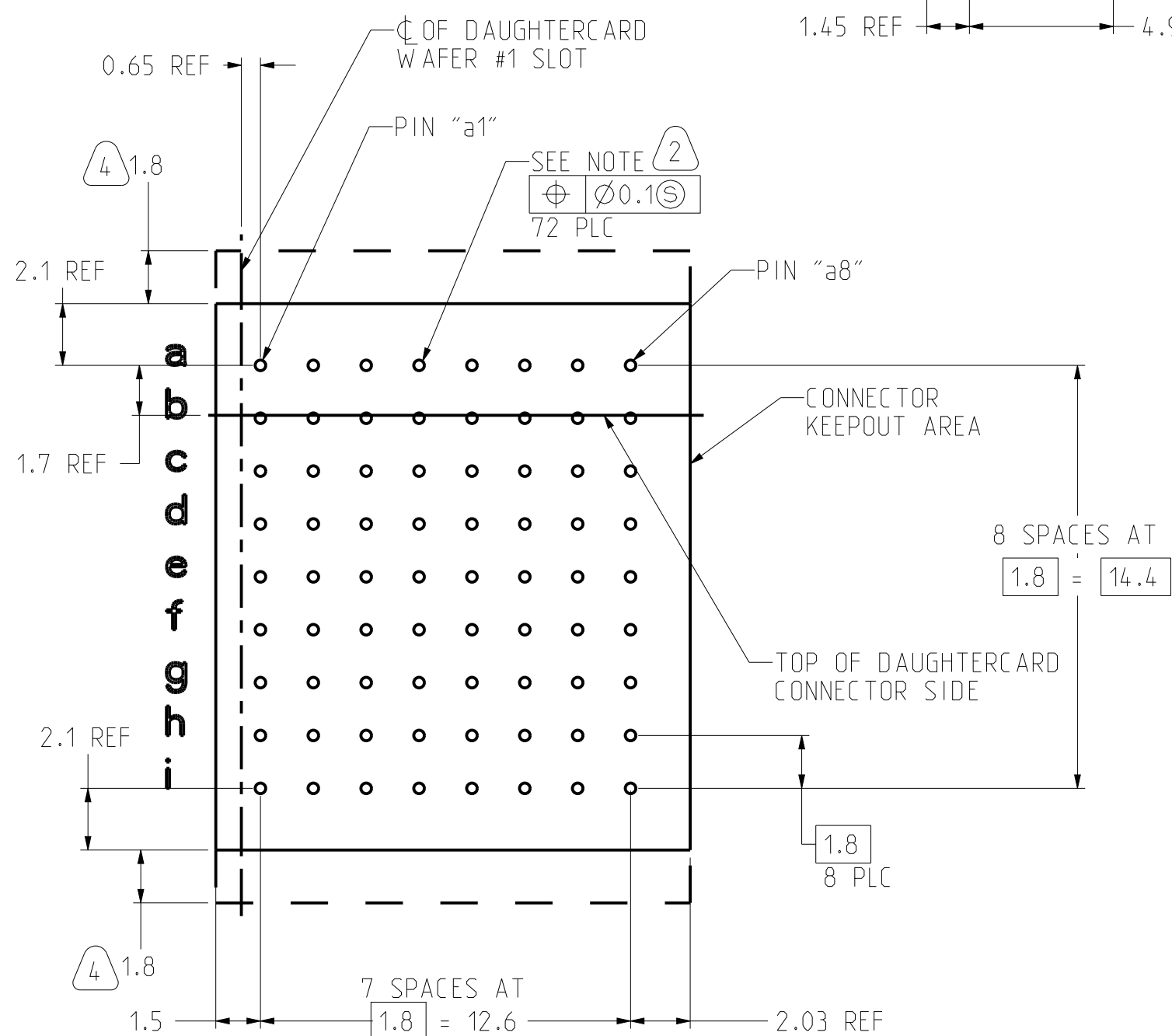
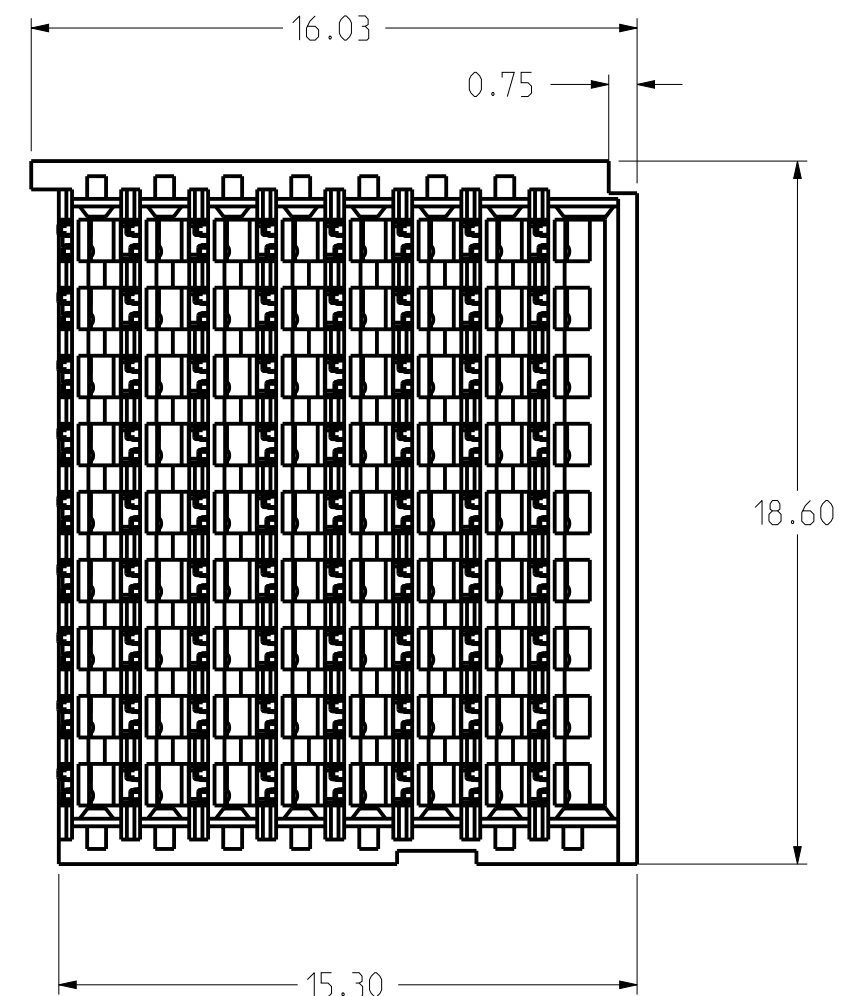
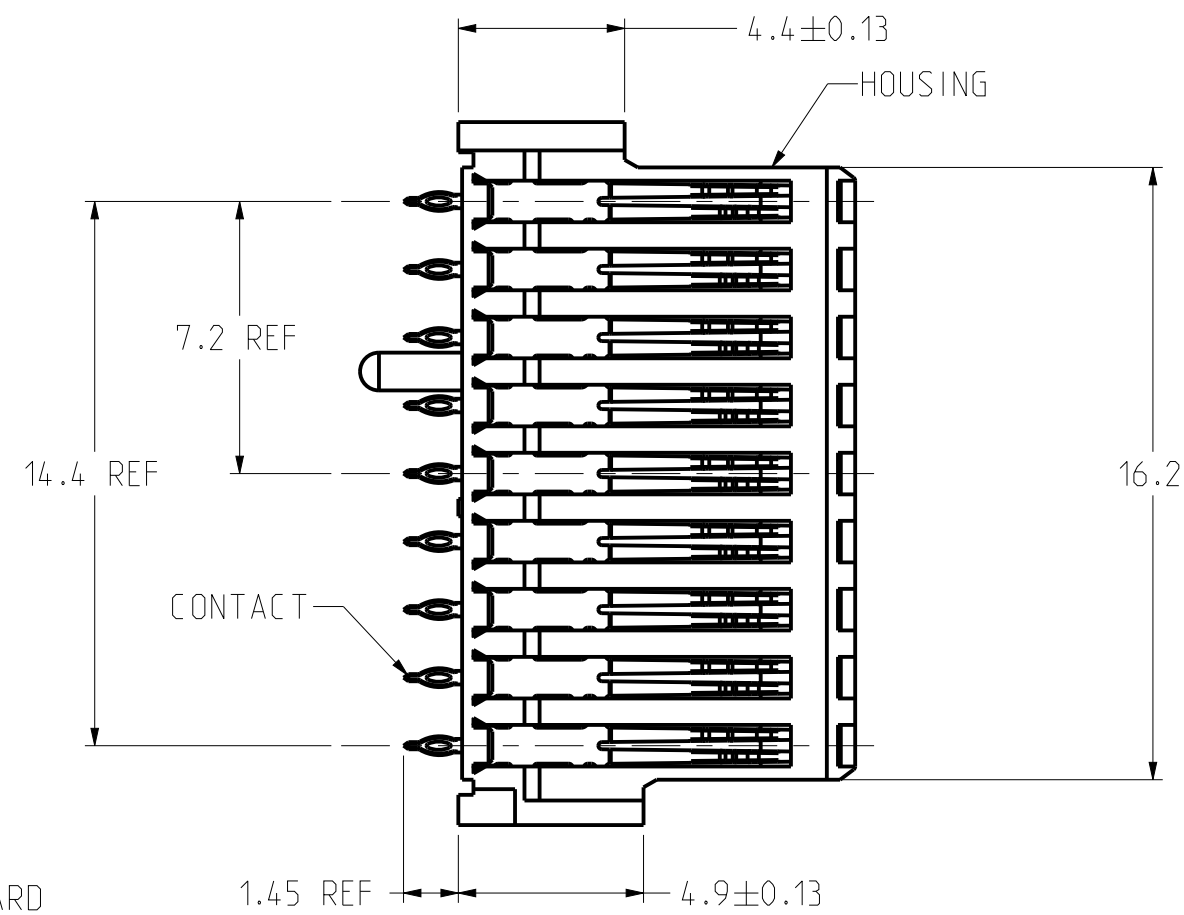

PLASTIC ALIGNMENT PIN MUST BE REMOVED FLUSH TO HOUSING BODY PRIOR TO INSERTION INTO RTM LAYOUT

NOTES:

THE USE OF THIS DOCUMENT IS UNLIMITED. HOWEVER, DOCUMENTS REFERENCED HEREON MAY CONTAIN LIMITED RIGHTS DATA.

RELEASED / Jan. 14 2020, 2:35:52 PM

SIZE C	CAGE CODE 77820	DOCUMENT NO. RVPX-JE208EXX	REV. A
SCALE: 4/1		REF: RVPX-J08EXX	SHEET 2 OF 2