

THIS COPY IS PROVIDED ON A RESTRICTED BASIS AND IS NOT TO BE USED IN ANY WAY DETRIMENTAL TO THE INTERESTS OF PANDUIT CORP.

PANDUIT PART NO.	"A"	"B"	WEIGHT lbs. / 100 (g) / pcs.
MP250W175	2.50 (63.5)	2.03 (51.6)	.25 (113.5)

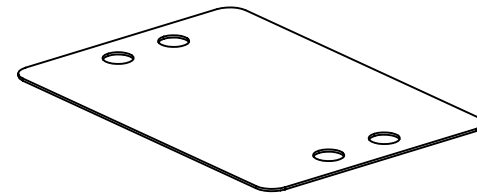
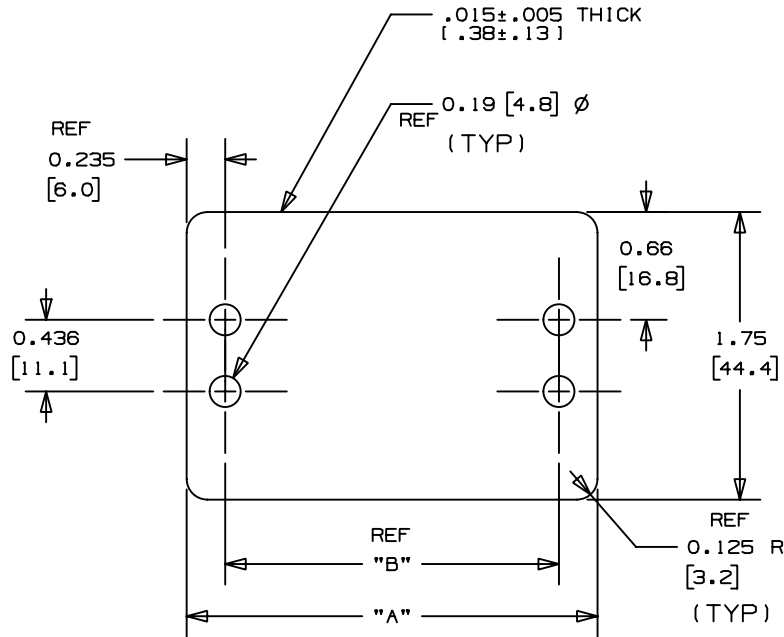

NOTES:
*1. SEE CURRENT PRICE SHEET FOR PART NUMBER SUFFIX DESIGNATION FOR PACKAGE SIZE.

DIMENSIONS IN BRACKETS ARE METRIC [mm]	
CAD FILENAME/LAYERS G00239GN_PB_MP250W175_01	
PANDUIT CORP. TINLEY PARK, ILLINOIS	
IDENTIFICATION MARKER PLATE	
UNLESS OTHERWISE SPECIFIED, DIMENSIONAL TOLERANCES ARE: (.X) ±0.05 [1.3] (.XXX) ±0.010 [0.25] (.XX) ±0.02 [0.5] ANGLES ± 5°	UNLESS OTHERWISE SPECIFIED, ALL DIMENSIONS ARE GIVEN IN INCHES, THIRD ANGLE PROJECTION.
DRAWN BY JAD	MAT'L: WHITE NYLON 6/6
DATE 1/10/2000	SCALE NONE
CHK'D	DRAWING NO. G00239GN
	DWG SIZE A

REV	DATE	BY	CHK	DESCRIPTION	ECN	R	CUST	SUP
I	8/3/01	LGG		ADDED REF AND UPDATED	G00239GN	I		
R	1-10-00	JAD		INITIAL RELEASE, REPLACES SS-4628 REV 4	G00239GN	R		