

6

5

4

3

2

1

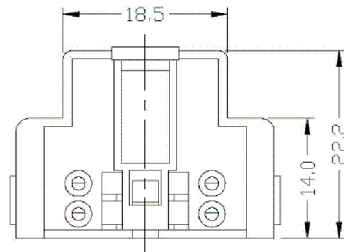
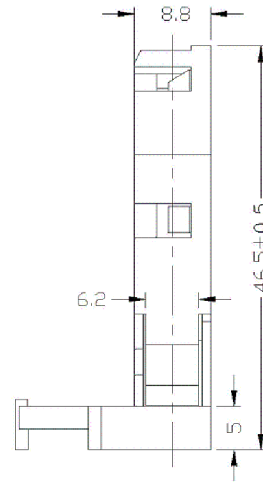
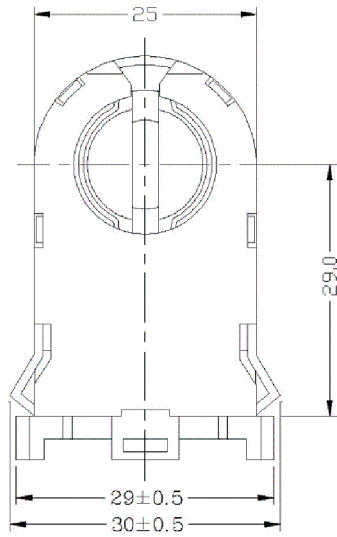

**SPECIFICATIONS:**

Housing: Thermoplastic, UL-94V-0 rated  
 Contacts: Copper alloy  
 Electrical ratings: 660W, 600V  
 Max. Operating temperature: 120°C  
 Applicable Wire type: 18AWG solid copper  
 ( acceptable for use with cooper clad wire such as AWM style 11125 )  
 Applicable Panel thickness: 1.0 - 1.5mm  
 For T8 bulb type  
 For G13 Base  
 For Rapid Start (I)

**Certifications:**  
 UL 542  
 UL 496  
 CSA 22.2 / 43



RoHS  
 COMPLIANT

**REVISIONS**

REV	DATE	CHANGE	CHK	CHK	APPR
A	11/16/17	UPDATED DRAWING	PB		

TOLERANCE UNLESS OTHERWISE SPECIFIED	
X	± 1
X.X	± 0.4
X.XX	± 0.13
DRAWN BY	PB
CHECK BY	
APPR BY	
DATE:	10/26/17

<b>Power Dynamics, Inc.</b>	
Phone: 973 560-0019 Whippany, New Jersey Fax: 973 560-0076	
PART: FLUORESCENT / LED T8 LAMPHOLDER FOR G13 BASE MEDIUM BI-PIN; NON-SHUNTED; TURN TYPE WITH LOCK FOR RAPID START	
PART #:	PD-FL-13
SIZE:	A
SCALE:	NTS
ALL DIMENSIONS FOR REFERENCE ONLY DIMENSIONS ARE IN MILLIMETERS	
SHEET	1 of 1
REV:	A

6

5

4

3

2

1