

THIS IS A C.A.D. GENERATED DRAWING
DO NOT MAKE MANUAL REVISIONS TO MASTER.

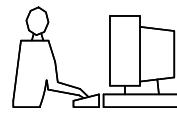

* UNLESS OTHERWISE SPECIFIED TOLERANCES
ON DECIMAL IS:
UNIT: MM

BACKSHELL KIT INCLUDES:

- (2) BACKSHELL HALVES
- (2) CLAMP
- (2) CLAMP SCREWS
- (2) SHELL SCREWS
- (2) MOUNTING BRACKETS
- (2) SCREWS

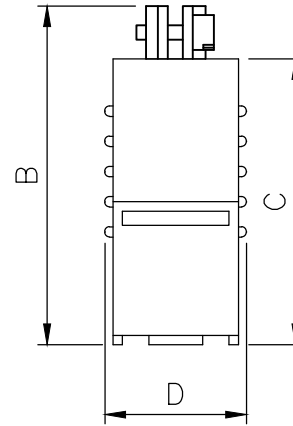
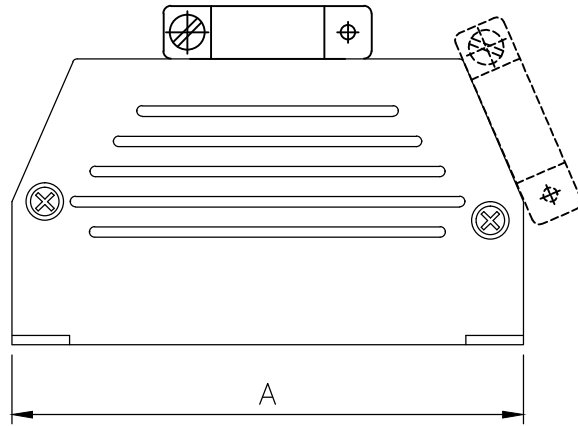

DIMENSIONS(MM/IN)				
SIZE	A±0.5	B±0.6	C±0.5	D±1.0
9	32.2	28.6	22.1	15.0
15	39.8	34.1	26.1	15.0
25	54.2	38.3	30.3	15.0
37	70.7	46.2	38.2	15.0

Ordering information:

SIZE	P/N-KITTED	Product Code
9-way	2801-0101-11	MHED-DS090F
15-way	2801-0101-12	MHED-DS150F
25-way	2801-0101-13	MHED-DS250F
37-way	2801-0101-14	MHED-DS370F

THESE DRAWINGS AND SPECIFICATIONS ARE THE PROPERTY OF MH CONNECTORS LTD. AND SHALL NOT BE REPRODUCED, COPIED OR USED AS THE BASIS FOR THE MANUFACTURE OR SALE OF APPARATUS WITHOUT WRITTEN PERMISSION.

DRAWN Haley	DATE 07-14-14
----------------	------------------

APPROVED	DATE
----------	------

SCALE	SHEET OF 1 OF 1	REV: 1.0
-------	--------------------	-------------

DRAWING No MHED-DSXXOF



THIS SERIES FULLY CONFORMS TO THE EUROPEAN UNION DIRECTIVES 2002/95/EC AND 2002/96/EC FOR RoHS COMPLIANCY.



MH CONNECTORS LTD.