

4

3

2

1

THIS DRAWING IS UNPUBLISHED. RELEASED FOR PUBLICATION, 19 .

© COPYRIGHT 19 BY AMP INCORPORATED. ALL RIGHTS RESERVED.

| LOC | DIST | REVISIONS   |                      |         |       |
|-----|------|-------------|----------------------|---------|-------|
| P   | LTR  | DESCRIPTION | DATE                 | DWN     | APVD  |
| AF  | 86   | A           | REV PER 0G3A-0561-01 | 090CT02 | JR MS |

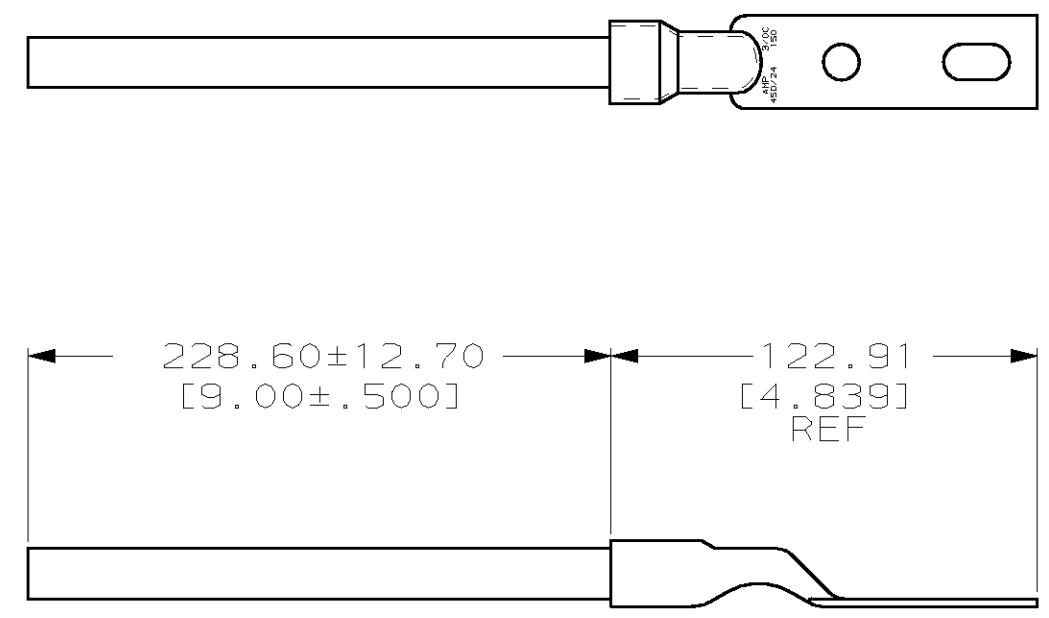

696059-1  
PART NUMBER

**AMP INCORPORATED**  
**CUSTOMER SERVICE SYSTEMS**

|  |  |  |
|--|--|--|
| FOR ADDITIONAL PRODUCT INFORMATION OR COPIES OF DRAWINGS AND TECHNICAL DOCUMENTS | PRODUCT INFORMATION CENTER<br>1-800-522-6752 | RECOMMENDED OPERATING TEMPERATURE:<br>170° MAX   |
| FOR APPLICATION TOOLING INFORMATION  | TOOLING ASSISTANCE CENTER<br>1-800-722-1111  | VOLTAGE RATING:<br>NOT APPLICABLE  |
| FOR ORDER ENTRY  | 1-800-526-5142                               | WIRE CROSS SECTIONAL AREA RANGE:<br>100.0-125.0mm <sup>2</sup> [190,000-231,000] CIR MILS<br>SOLID OR STRANDED |

THIS DRAWING IS A CONTROLLED DOCUMENT.

| DIMENSIONS:<br>mm [INCHES] | TOLERANCES UNLESS OTHERWISE SPECIFIED: |
|----------------------------|--|
|                            | 0 PLC ±-                               |
|                            | 1 PLC ±-                               |
|                            | 2 PLC ±-                               |
|                            | 3 PLC ±-                               |
|                            | 4 PLC ±-                               |
|                            | ANGLES ±-                              |
| MATERIAL -                 | FINISH -                               |

|                                     |  |
|-------------------------------------|--|
| DWN<br>PHILLIP M FORTNEY<br>230CT98 | <b>AMP</b> AMP Incorporated<br>Harrisburg, PA 17105-3608 |
| CHK<br>SCOTT UNGER<br>230CT98       |  |
| APVD<br>SCOTT UNGER<br>230CT98      | NAME   |
| PRODUCT SPEC<br>-                   | 228.60 [9.00] AMPPOWER CABLE PIGTAIL                     |
| APPLICATION SPEC<br>-               | SIZE CAGE CODE DRAWING NO RESTRICTED TO                  |
| WEIGHT -                            | A3 00779 C- 696059 -                                     |
| CUSTOMER DRAWING                    | SCALE NTS SHEET 1 OF 1 REV A                             |