

P.C. LAYOUT

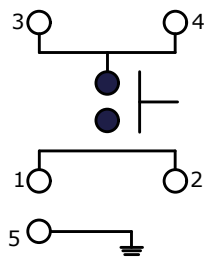

CIRCUIT: SPST ▲

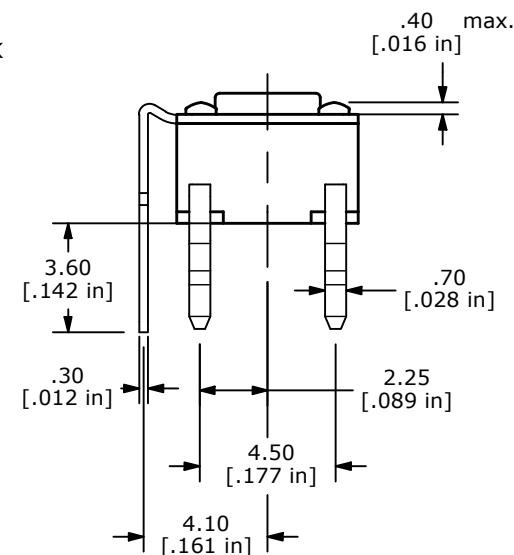
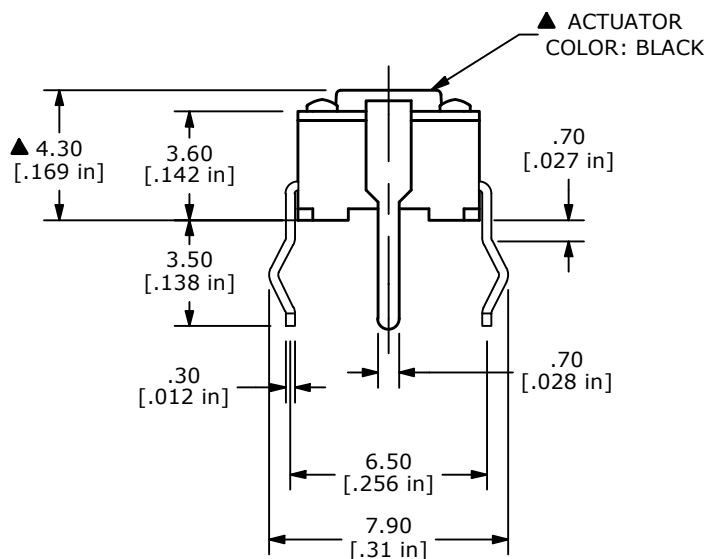
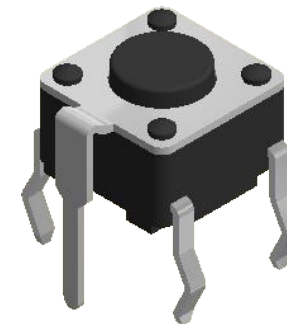
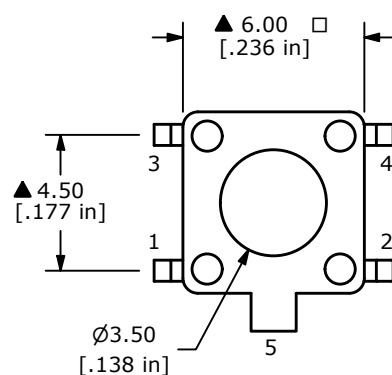

NOTES:

1. ALL DIMENSIONS IN MM [INCH]
2. GENERAL TOLERANCE: X.X = ± 0.4  
X.XX = ± 0.25
3. TERM. NUMBERS FOR REF. ONLY.
4. RATING: 50mA @ 12VDC
- ▲ 5. OPERATING FORCE: 160 ± 50gf
6. TRAVEL: 0.25 +0.2/-0.1mm
7. CONTACT RESISTANCE: 100 mΩ MAX.
- ▲ 8. CONTACT MATERIAL: SILVER
9. DIELECTRIC STRENGTH: 250V RMS min.
10. INSULATION RESISTANCE: 100 MEGAΩ min.
11. ELECTRICAL LIFE: 100,000 CYCLES
12. ▲ DENOTES CRITICAL PARAMETER.
13. OPERATING TEMP: -40°C to 85°C
14. PACKAGE: POLYBAG / 750 PIECES PER BAG

C	24508	CHANGE OPERATING TEMPERATURE	9/29/20	JM
B	23227	Added Actuator Diameter	2/19/18	MW
A	20807	RELEASED FOR PRODUCTION	10/03/12	RC
REV	PCR NO	DESCRIPTION	DATE	BY



TITLE TLE1105F160Q				
SCALE	DATE	DR	DWG	REV
4:1	10/3/2012	RC	P010100	C

THE INFORMATION CONTAINED IN THIS DOCUMENT IS PROPRIETARY TO E-SWITCH AND IS NOT TO BE COPIED OR TRANSFERRED