

Data sheet | Item number: 787-1017

Switched-mode power supply; Compact; 1-phase; 18 VDC output voltage;
2.5 A output current

www.wago.com/787-1017

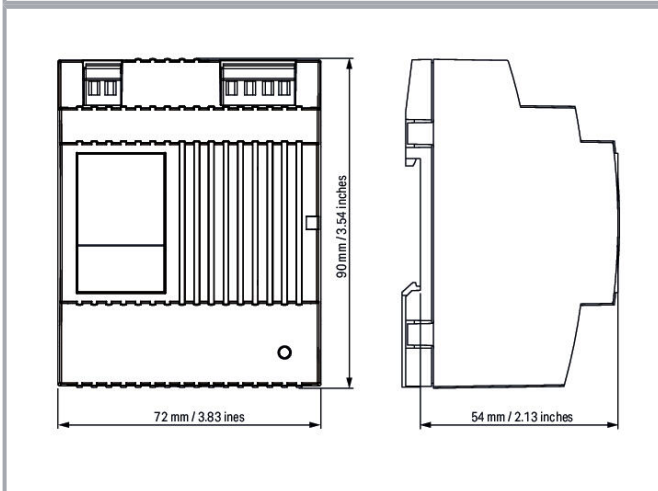
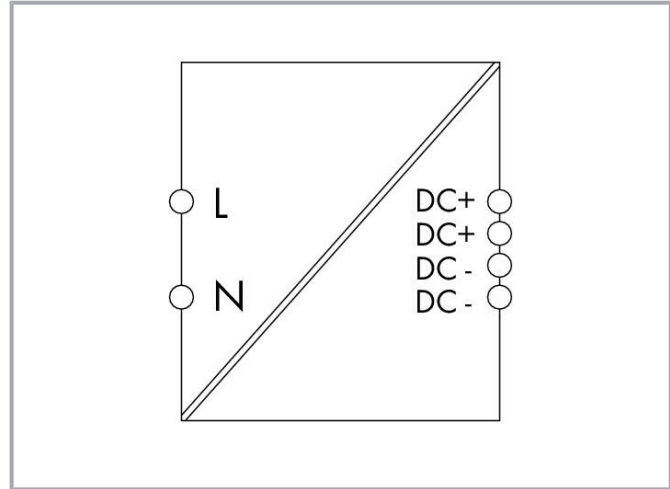

Item description

Features:

—
Subject to changes. Please also observe the further product documentation!

WAGO GmbH & Co. KG
Hansastr. 27
32423 Minden
Phone: +49571 887-0 | Fax: +49571 887-169
Email: info.de@wago.com | Web: www.wago.com

Do you have any questions about our products?
We are always happy to take your call at +49 (571) 887-44222.



- Switched-mode power supply
- Natural convection cooling when horizontally mounted
- Stepped profile, ideal for distribution boards/boxes
- Overhead mounting is possible with derating
- Suitable for both parallel and series operation
- Electrically isolated output voltage (SELV) per EN 61010-2-201/UL 60950-1; PELV per EN 60204

Data

Technical data

Input

Phases	1
Nominal input voltage $U_{i\text{nom}}$	1 x AC 100 ... 240 V
Input voltage range	1 x AC 85 ... 264 V; DC 120 ... 300 V
Input voltage derating	$I_o \leq 2 \text{ A} (< 100 \text{ VAC})$
Nominal mains frequency range	44 ... 66 Hz; 0 Hz
Input current I_i	$\leq 0.5 \text{ A} (230 \text{ VAC}); \leq 0.9 \text{ A} (110 \text{ VAC})$
Inrush current	$\leq 30 \text{ A} (\text{NTC})$
Power factor correction (PFC)	Passive
Mains failure hold-up time	$\geq 10 \text{ ms} (230 \text{ VAC}); \geq 10 \text{ ms} (110 \text{ VAC})$

Output

Nominal output voltage $U_{o\text{nom}}$	DC 18 V (SELV)
Output voltage range	DC 15 ... 28 V (adjustable)
Nominal output current $I_{o\text{nom}}$	2.4 A (18 VDC); 2 A (24 VDC; in any mounting position)
Nominal output power	43 W
Residual ripple	$\leq 100 \text{ mV}$ (peak-to-peak)
Current limitation	$1.1 \times I_{o\text{nom}}$ (typ.)
Overload behavior	Constant current

Signaling and Communication

Signaling	1 x Status indication LED (green)
Operation status indicator	Green LED (U_o)

Subject to changes. Please also observe the further product documentation!



Efficiency/power losses

Power loss P_l	$\leq 2.6 \text{ W}; \leq 8.1 \text{ W (230 VAC; nominal load)}$
Power loss (max.) $P_{l(max)}$	8.2 W (100 VAC / 18 VDC; 2.4 A)
Efficiency (typ.)	84 %

Circuit protection

Internal fuse	T 2 A / 250 VAC
Backup fusing (required)	An external DC fuse is required for the DC input voltage.
Backup fusing (recommended)	Circuit breaker: 6 A (C characteristic), 10 A (B characteristic) or higher

Safety and protection

Protection class	II
Protection type	IP20; per EN 60529
Overvoltage category	II
Pollution degree	2
Transient suppression (primary)	Varistor
Overvoltage protection; secondary	$\leq 40 \text{ VDC}$ (in the event of a fault)
Short-circuit-protected	Yes
Open-circuit-proof	Yes
Parallel operation	Yes
Series operation	Yes
MTBF	> 500,000 h (per IEC 61709)

Connection data

Connection type 1	Input/Output
Connection technology	CAGE CLAMP®
WAGO connector	WAGO 740 Series
Solid conductor	0.08 ... 2.5 mm ² / 28 ... 12 AWG
Fine-stranded conductor	0.08 ... 2.5 mm ² / 28 ... 12 AWG
Strip length	6 ... 7 mm / 0.24 ... 0.28 inches

Physical data

Width	72 mm / 2.835 inches
Height	89 mm / 3.504 inches

Subject to changes. Please also observe the further product documentation!

WAGO GmbH & Co. KG
 Hansastr. 27
 32423 Minden
 Phone: +49571 887-0 | Fax: +49571 887-169
 Email: info.de@wago.com | Web: www.wago.com

Do you have any questions about our products?
 We are always happy to take your call at +49 (571) 887-44222.



Depth	59 mm / 2.323 inches
Depth from upper-edge of DIN-rail	55 mm / 2.165 inches

Mechanical Data

Mounting type	DIN-35 rail
---------------	-------------

Material Data

Flammability class per UL94	V0
Weight	264 g

Environmental requirements

Ambient temperature (operation)	-25 ... +60 °C (Device starts at -40 °C (type-tested))
Ambient temperature (storage)	-25 ... +80 °C
Ambient temperature UL (operation at U _N)	-25 ... +55 °C
Relative humidity	5 ... 96 % (no condensation permissible)
Derating	-3 %/K (> 45 °C)

Standards and specifications

Conformity marking	CE
Standards/specifications	EN 61010-1 EN 61010-2-201 EN 61204-3 UL 60950-1 UL 508

Commercial data

Product Group	6 (INTERFACE ELECTRONIC)
eCl@ss 10.0	27-04-07-01
eCl@ss 9.0	27-04-07-01
ETIM 8.0	EC002540
ETIM 7.0	EC002540
PU (SPU)	1 pcs
Packaging type	box
Country of origin	DE
GTIN	4050821595731
Customs tariff number	85044083900

Subject to changes. Please also observe the further product documentation!



Environmental Product Compliance

RoHS Compliance Status



Compliant, No Exemption

Approvals / Certificates

General approvals

Logo	Approval	Additional Approval Text	Certificate name
	EAC Brjansker Zertifizierungsstelle	TP TC 004/2011, TP TC 020/2011	EAC RU C-DE.AM02.B.00089_19
	UL Underwriters Laboratories Inc.	UL 60950-1	E255815
	UL Underwriters Laboratories Inc.	UL 508	E255817

Declarations of conformity and manufacturer's declarations

Logo	Approval	Additional Approval Text	Certificate name
	EU-Declaration of Conformity WAGO GmbH & Co. KG	-	-
	UK-Declaration of Conformity WAGO GmbH & Co. KG	-	-

Optional accessories

Tool

Operating tool



Item no.: 210-769
SCREWDRIVER; green

www.wago.com/210-769

Subject to changes. Please also observe the further product documentation!



Item no.: 210-720

Operating tool; Blade: 3.5 x 0.5 mm; with a partially insulated shaft; multicoloured

Marking accessories

Marking strip



Item no.: 210-831

Marking strips; on reel; 2.3 mm wide; plain; Self-adhesive; white

www.wago.com/210-831



Item no.: 210-832

Marking strips; on reel; 3 mm wide; plain; Self-adhesive; white

www.wago.com/210-832

Downloads

Documentation

Bid Text

787-1017 X81 - Datei	2019 Jun 24	xml 7.2 kB	Download
-------------------------	-------------	---------------	----------

787-1017 docx - Datei	2019 Jun 12	docx 21.5 kB	Download
--------------------------	-------------	-----------------	----------

Instruction Leaflet

Power Supply COMPACT	29-03-2021 2021 Dec 20	pdf 2.2 MB	Download
----------------------	---------------------------	---------------	----------

Additional Information

Disposal and Recycling Electrical and electronic equipment, Batteries, Packaging	V 1.1.0 2022 Aug 18	pdf 2.2 MB	Download
---	------------------------	---------------	----------

CAD/CAE-Data

CAD data

2D/3D Models 787-1017	URL	Download
-----------------------	-----	----------

CAE data

EPLAN Data Portal 787-1017	URL	Download
----------------------------	-----	----------

WSCAD Universe 787-1017

Subject to changes. Please also observe the further product documentation!



[URL](#) [Download](#)

ZUKEN Portal 787-1017

[URL](#) [Download](#)

Environmental Product Compliance

Compliance Search

Environmental Product Compliance 787-1017

[URL](#) [Download](#)

Switched-mode power supply; Compact; 1-phase; 18 VDC output voltage; 2.5 A output current

Installation Notes

Product family

EPSITRON COMPACT Power

EPSITRON® COMPACT POWER: Compact, High-Performance Power Supplies

[Show all products from the family](#)

Subject to changes. Please also observe the further product documentation!

WAGO GmbH & Co. KG

Hansastr. 27

32423 Minden

Phone: +49571 887-0 | Fax: +49571 887-169

Email: info.de@wago.com | Web: www.wago.com

Do you have any questions about our products?

We are always happy to take your call at +49 (571) 887-44222.