

Physical	
Dimensions	10.8mm x 5.8mm x 3mm (0.42" x 0.22" x 0.12")
Use Case	On metal
Attachment	Site applied adhesive
Weight	1 gram

Electrical/RF	
Typical Read Range	6 - 7 feet at 36dBm ERP
Frequency	902-928 MHz
IC Platform	Impinj Monza R6-P
IC Memory	EPC up to 128 bits, 96 bits serialized TID and up to 64 bits of user memory

Environmental	
Classification	IP68
Operating Temperature	-50°C to +85°C (-58° to +185°F)
Temperature Tolerance	-50°C to +185°C (-58° to +365°F)

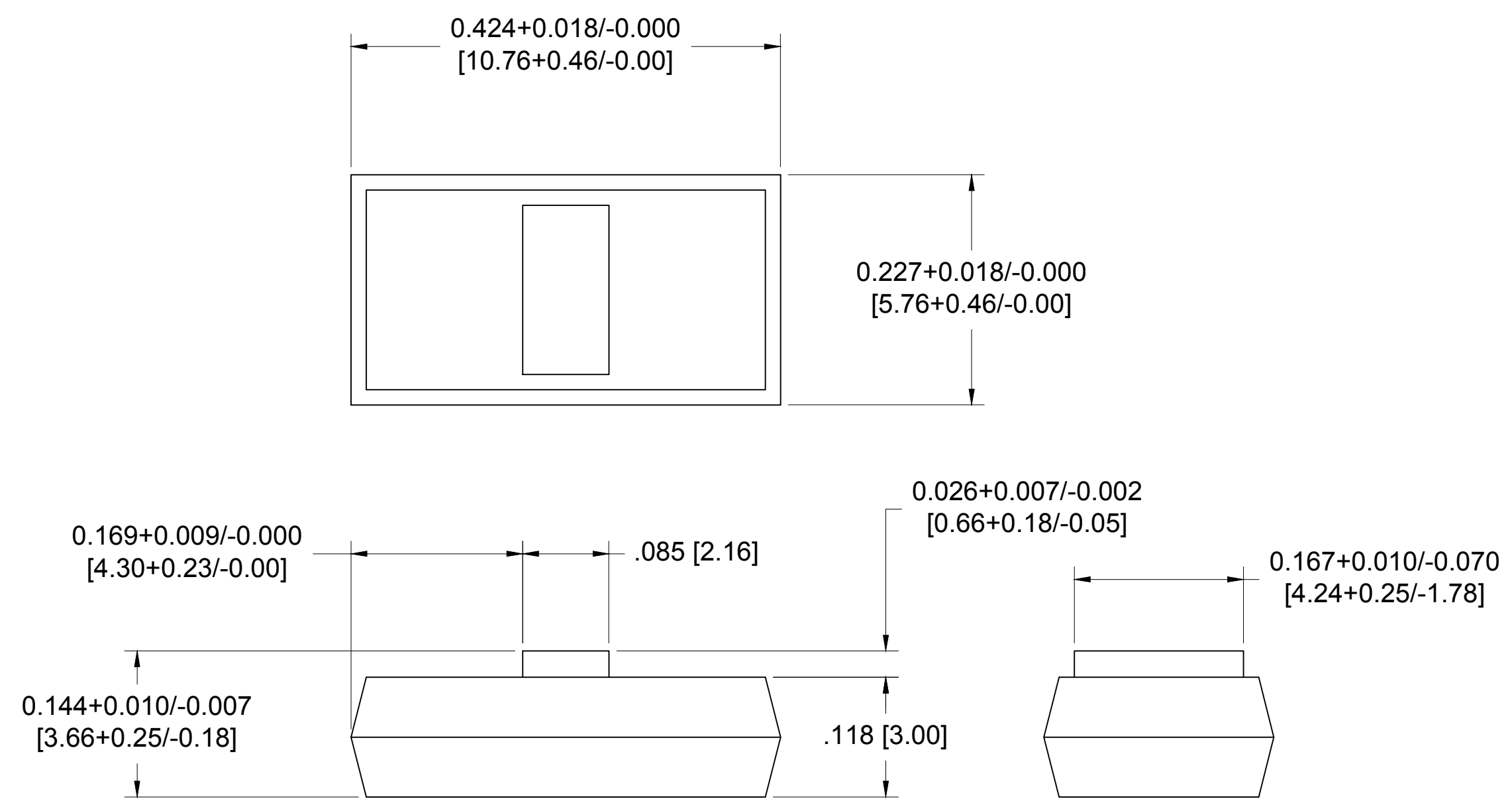

NOTES:
 1. DIMENSIONS FOR CHIP ENCAPSULATION ARE FOR CLEARANCE, SHAPE IS NOT REPRESENTATIVE.

PRELIMINARY RELEASE EC NO: USW2019-0134 DRWN: MJM 2019/02/06	QUALITY SYMBOL	GENERAL TOLERANCES (UNLESS SPECIFIED)		DIMENSION STYLE		SCALE	DESIGN UNITS	THIRD ANGLE PROJECTION	
	▼=0	mm	INCH	IN/MM		8:1	INCH		
	▽=0	4 PLACES	±---	±---	DRAWN BY	DATE	TITLE		
		3 PLACES	±---	±.010	MMALONE	2019/02/06	RFID SALES DRAWING		
		2 PLACES	±.25	±.030	CHECKED BY	DATE	----		
	1 PLACE	±.76	±---	APPROVED BY	DATE	MATERIAL NO.			
		ANGULAR ±1/2°		DENGLISH	2019/03/04	MOLEX INCORPORATED			
		DRAFT WHERE APPLICABLE MUST REMAIN WITHIN DIMENSIONS		MATERIAL NO.		DOCUMENT NO.		SHEET NO.	
				133561401		SD-13556-1401		1 OF 1	
				SIZE	THIS DRAWING CONTAINS INFORMATION THAT IS PROPRIETARY TO MOLEX INCORPORATED AND SHOULD NOT BE USED WITHOUT WRITTEN PERMISSION				
				C					