

TRS5-70BCR01V

Aliases (USEF70BCR01000)

KEMET, TRS, Thermal Reed Switch, Axial, 2.5C Temperature Accuracy, High Reliability, High-Speed Response, Long Operational Life, Excellent Environmental Durability, High Temperature Accuracy, 70°C, Break

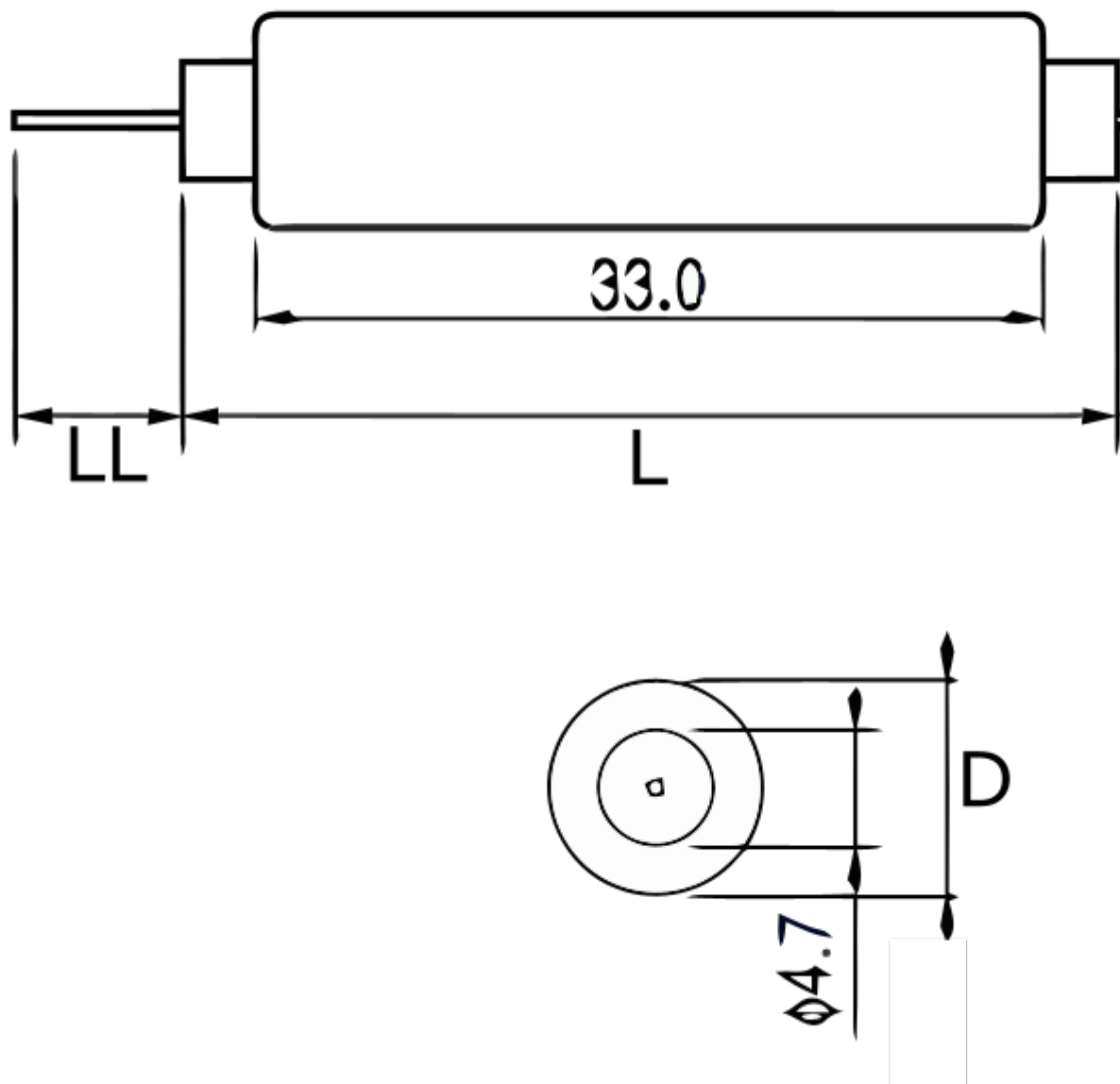

Click [here](#) for the 3D model.

Dimensions

D 7mm NOM

Dimensions

L 40mm NOM

LL 8.5mm NOM

Packaging Specifications

Packaging Tray, Box

Packaging Quantity 600

Component Weight 3.1 g

General Information

Series TRS

Type Thermal Reed Switch

Style Axial

Description Thermal Reed Switch

Features High Reliability, High-Speed Response, Long Operational Life, Excellent Environmental Durability, High Temperature Accuracy

Lead Wire Leads

RoHS Yes

REACH Yes

Specifications

Switching Temperature 70C +/-2.5C

Temperature Range -20/+130°C

Contact Type Break

Voltage AC 264 VAC MAX (Opening/Closing)

Current 0.275 Amps AC MAX (Opening/Closing), 1 mAmps MIN (5VDC, Opening/Closing)

Resistance 150 mOhms MAX (Contact Resistance)

Max Opening/Closing Power 60.5 W (AC/DC)

Max Opening/Closing Voltage 264 V (AC)

Differential Temperature 10C Maximum

Statements of suitability for certain applications are based on our knowledge of typical operating conditions for such applications, but are not intended to constitute - and we specifically disclaim - any warranty concerning suitability for a specific customer application or use. This Information is intended for use only by customers who have the requisite experience and capability to determine the correct products for their application. Any technical advice inferred from this Information or otherwise provided by us with reference to the use of our products is given gratis, and we assume no obligation or liability for the advice given or results obtained.

Generated 5/18/2023 - ace23d67-0bda-4d8b-9b1c-b1751e09d9a2

© 2006 - 2023 KEMET

Generated 5/18/2023 - ace23d67-0bda-4d8b-9b1c-b1751e09d9a2

© 2006 - 2023 KEMET