

THIS DRAWING IS A CONTROLLED DOCUMENT FOR THE COMPANY'S PROPRIETARY INFORMATION. IT IS SUBJECT TO CHANGE AND THE COMPANY ASSUMES NO LIABILITY FOR THE LATEST REVISION. CONTACT THE COMPANY FOR THE LATEST REVISION.

THE COMPANY AND ITS VENDORS MAKE NO WARRANTY, EXPRESS OR IMPLIED, THAT THE PARTS LISTED HEREIN ARE THE BEST AVAILABLE WITHOUT WRITTEN AUTHORIZATION FROM AMP INCORPORATED, HARRISBURG, PA.

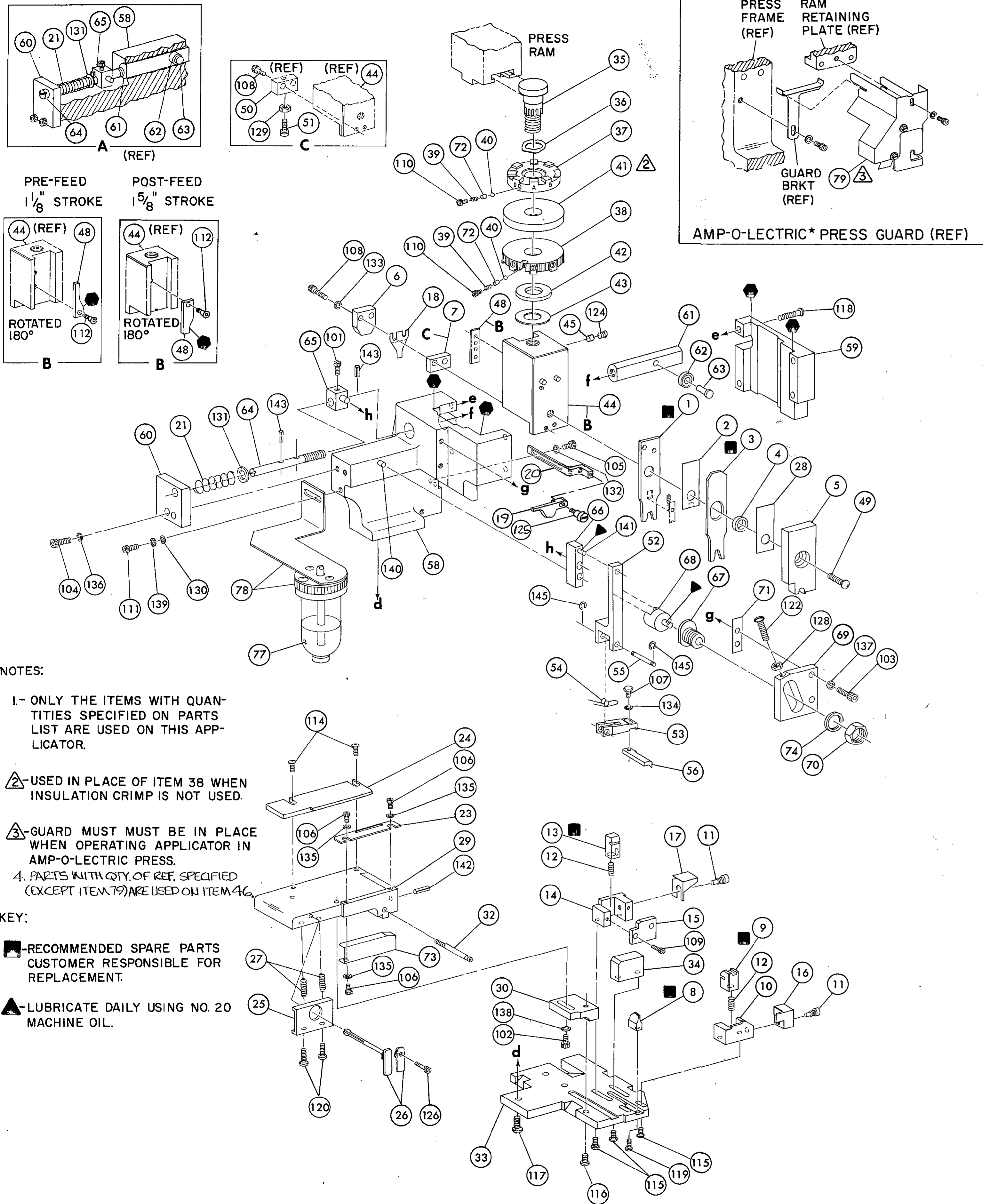

NOTES:

- 1.- ONLY THE ITEMS WITH QUANTITIES SPECIFIED ON PARTS LIST ARE USED ON THIS APPLICATOR.
2. USED IN PLACE OF ITEM 38 WHEN INSULATION CRIMP IS NOT USED.
3. GUARD MUST BE IN PLACE WHEN OPERATING APPLICATOR IN AMP-O-LECTRIC PRESS.
4. PARTS WITH QTY. OF REF. SPECIFIED (EXCEPT ITEM 79) ARE USED ON ITEM 46.

KEY:

- RECOMMENDED SPARE PARTS CUSTOMER RESPONSIBLE FOR REPLACEMENT.
- LUBRICATE DAILY USING NO. 20 MACHINE OIL.

QTY	PART NO	DESCRIPTION	ITEM NO
REF	21045-3	RING, RETAINING 'C' (.187 DIA) FEED FINGER PIN	145
	144	REF 454220-1 CAP, HOUSING	59
	REF 454485-1	HOUSING	58
	REF 5-21028-1	PIN, SLOT SPR (.125 DIA X .50) ADJ ROD	143
1	4-21028-0	PIN, SLOT SPR (.093 DIA X .75) STR G PLATE	142
REF	1-21030-1	PIN, DOWEL (.187 DIA X .50) LEVER	141
	REF 690542-2	PAWL, FEED	56
REF	1-21030-6	PIN, DOWEL (.187 DIA X 1.25) HOUSING	140
	REF 240624-1	PIN, FEED FINGER	55
	REF 691499-1	SPRING, FEED FINGER	54
	REF 690541-1	FINGER, FEED	53
	REF 455679-1	LEVER, TERMINAL FEED ARM	52
	REF 811242-2	BUMPER, HOLDDOWN	51
	REF 690153-1	SPACER, TONKER	50
3	21057-2	WASHER, LOCK (NO 4) FRONT STRIP GUIDE	135
1	21024-4	WASHER, LOCK (NO 8) FEED FINGER	134
	REF 7-21002-9	BOLT, CRIMPER	49
	REF 690602-5	CAM PRE - FEED 1/8 STROKE	48
	REF 21024-5	WASHER, LOCK (NO 10) STRIP GUIDE ADJ BLOCK	138
	REF 137	REF 1	811242-2
	REF 21024-5	WASHER, LOCK (NO 10) ADJ PLATE	137
	REF 21024-5	WASHER, LOCK (NO 10) FEED GUIDE ROD	136
3	21057-2	WASHER, LOCK (NO 4) FRONT STRIP GUIDE	135
1	21024-4	WASHER, LOCK (NO 8) FEED FINGER	134
	REF 133	REF 1	21024-4
	REF 21024-4	WASHER, LOCK (NO 8) STRIPPER	132
	REF 21899-4	WASHER, FLAT (5/16 DIA) SCREW ADJ	131
	REF 21899-2	WASHER, FLAT (NO 10) LUB ASSY	130
	REF 21068-5	NUT, HEX MACH (6-32) HOLDDOWN	129
	REF 21068-5	NUT, HEX MACH (6-32) FEED ADJ	128
	REF 22353-8	SCR. SHLD. (.187 DIA X .250 LG) DRAG LEVER	126
	REF 456667-1	SCR. SHLD. (.188 DIA X .25 LG) STRIPPER	125
	REF 21009-2	SCR. SKT SET (1/4-20 X .25) (LOC-WEL) RAM	124
	REF 22341-6	BALL, STEEL	40
	REF 690170-1	SPRING, COMPRESSION	39
	REF 690142-1	DISC, INSULATION	38
	REF 5-690692-9	DISC, WIRE	37
	REF 22480-5	WASHER, SPRING	36
	REF 690212-1	POST, RAM	35
	REF 690786-3	SUPPORT, TERMINAL	34
	REF 455675-1	PLATE, BASE	33
	REF 690432-3	SCREW, ADJUSTMENT	32
	REF 455689-1	BLOCK, STRIP GUIDE ADJ	30
	REF 455671-1	PLATE, STRIP GUIDE	29
	REF 1-455888-0	SPACER, FRONT SHEAR DEPRESSOR	28
	REF 1-22284-0	SPRING, DRAG	27
	REF 690546-1	LEVER, DRAG RELEASE	26
	REF 240792-1	DRAG, STOCK	25
	REF 5-690504-5	GUIDE STRIP (REAR)	24
	REF 690438-1	GUIDE, STRIP (FRONT)	23
	REF 2-21000-7	SCR. SKT HD CAP (8-32 X .50) DEPRESSOR	108
	REF 2-22603-0	SCR. HEX HD MACH (8-32 X .31) FEED FINGER	107
	REF 1-21000-3	SCR. SKT HD CAP (4-40 X .25) F STRIP GUIDE	106
	REF 2-21000-7	SCR. SKT HD CAP (8-32 X .50) STRIPPER	105
	REF 3-21000-6	SCR. SKT HD CAP (10-32 X .62) FEED ADJ BLOCK	103
	REF 3-21000-4	SCR. SKT HD CAP (10-32 X .38) SG ADJ BLOCK	102
	REF 3-21000-4	SCR. SKT HD CAP (10-32 X .38) PIVOT BLOCK	101
	REF 455749-1	GUARD, WINDOW	79
	REF 1-465184-0	LUBRICATOR ASSY	78
	REF 5-22280-0	SPRING, SHEAR	12
	REF 690461-1	STOP, SHEAR	11
	REF 690459-1	HOLDER, SHEAR (FRONT)	10
	REF 454276-1	SHEAR, FLOAT (FRONT)	9
	REF 3-458834-4	ANVIL	8
	REF 690517-1	SPACER, DEPRESSOR (REAR)	7
	REF 22594-8	DEPRESSOR, SHEAR (REAR)	6
	REF 240628-1	DEPRESSOR, SHEAR (FRONT)	5
	REF 240626-1	SPACER, TUBULAR, INS CRIMPER	4
	REF 240633-1	CRIMPER, INSULATION	3
	REF 455680-1	SPACER, CRIMPER	2
	REF 240629-1	CRIMPER, WIRE	1

QTY	PART NO	DESCRIPTION	ITEM NO
	REF 3-21064-2	SCR. RD HD MACH (6-32 X 1.50) FEED ADJ	122
	REF 2	REF 1	690212-1
	REF 2-21002-9	SCR. BUT HD SKT CAP (10-32 X .75) DRAG	120
	REF 22738-8	SCR. BUT HD SKT CAP (8-32 X .38) (LOC-WEL) ANVIL	119
	REF 2-21002-9	SCR. BUT HD SKT CAP (10-32 X .75) CAP	118
	REF 1-24073-9	SCR. BUT HD SKT CAP (1/4-20 X .75) HOUSING	117
	REF 2-21002-7	SCR. BUT HD SKT CAP (10-32 X .50) SG ADJ BLOCK	116
	REF 4	REF 1	455671-1
	REF 2-21002-2	SCR. BUT HD SKT CAP (8-32 X .50) SHEAR	115
	REF 2-21002-2	SCR. BUT HD SKT CAP (8-32 X .50) R STRIP GUIDE	114
	REF 1	REF 2	1-455888-0
	REF 3-21003-0	SCR. FLAT HD SKT CAP (6-32 X .50) CAM	112
	REF 3-21000-4	SCR. SKT HD CAP (10-32 X .38) LUBRICATOR ASSY	111
	REF 23030-1	SCR. SKT HD CAP (6-32 X .25) (LOC-WEL) CP DISC	110
	REF 2-21000-7	SCR. SKT HD CAP (6-32 X .50) REAR SHEAR PLATE	109
	REF 2-22603-0	SCR. SKT HD CAP (8-32 X .50) DEPRESSOR	108
	REF 1	REF 4-22284-9	SPRING, FEED RETURN
	REF 3	REF 1	458950-1
	REF 1	REF 1	458949-1
	REF 3-21000-7	SCR. SKT HD CAP (10-32 X .75) FEED ROD GUIDE	104
	REF 3-21000-6	SCR. SKT HD CAP (10-32 X .62) FEED ADJ BLOCK	103
	REF 1	REF 1	691667-1
	REF 3-21000-4	SCR. SKT HD CAP (10-32 X .38) SG ADJ BLOCK	102
	REF 3-21000-4	SCR. SKT HD CAP (10-32 X .38) PIVOT BLOCK	101
	REF 455749-1	GUARD, WINDOW	79
	REF 1-465184-0	LUBRICATOR ASSY	78
	REF 5-22280-0	SPRING, SHEAR	12
	REF 690461-1	STOP, SHEAR	11
	REF 690459-1	HOLDER, SHEAR (FRONT)	10
	REF 454276-1	SHEAR, FLOAT (FRONT)	9
	REF 3-458834-4	ANVIL	8
	REF 690517-1	SPACER, DEPRESSOR (REAR)	7
	REF 22594-8	DEPRESSOR, SHEAR (REAR)	6
	REF 240628-1	DEPRESSOR, SHEAR (FRONT)	5
	REF 240626-1	SPACER, TUBULAR, INS CRIMPER	4
	REF 240633-1	CRIMPER, INSULATION	3
	REF 455680-1	SPACER, CRIMPER	2
	REF 240629-1	CRIMPER, WIRE	1

QTY	PART NO	DESCRIPTION	ITEM NO
	REF 458109-1	WASHER, SPECIAL	74
1	454877-3	PLATE, STRIP GUIDE COVER	73
2	690603-1	SPRING, ASSIST	72
REF	690517-1	SPACER	71
	REF 22594-8	NUT, HEX	70
	REF 240628-1	PLATE, ADJUSTMENT	69
	REF 240626-1	SHAFT, PIVOT	68
	REF 240633-1	BUSHING	67
	REF 455680-1	LEVER, INTERMEDIATE	66
	REF 240629-1	BLOCK, PIVOT	65
	REF 240632-2	SCREW, ADJUSTMENT FEED ROD	64
	REF 240659-3	PIN, CAM ROLLER	63
	REF 240658-1	ROLLER, CAM	62
	REF 454398-2	ROD, FEED	61
REF	454178-1	GUIDE, FEED ROD	60

CRIMPING DATA				APPLICATOR WILL APPLY	
PAD LTR	CRIMP HEIGHT	WIRE SIZE	WIRE STRIP LENGTH	62358	
A	.040	# 20			
B	.037	# 22			
C	.033	# 24			
D	NOT USED				
CRIMP	SIZE	TYPE	FEED	APPL INST	
WIRE	.055	F	400	A1 8040	
INSUL	.090	F			
WIRE RANGE		INSULATION RANGE		PRESS NO	
24 to 20		.042 to .073		565435-5	
REMARKS AMP-O-LECTRIC PRE-FEED					

REMARKS		NO	REV
APPL USED ON MACHINE PART NO		TO APPLY TERMINAL	
CUSTOMER NAME	MACH SERIAL NO	DISTRIBUTION	
ADDRESS	APPL SERIAL NO	ORIGINAL	
CITY	PURCHASE ORDER	CUSTOMER COPY	
	ENG APP	FIELD ENG COPY	

P/F LTR	REVISION RECORD	APP DATE	P/F LTR	REVISION RECORD	APP DATE	P/F LTR	REVISION RECORD	APP DATE

SET UP GAGE 10-1 458631-1 823
DR 3-4-15 AB5-7
WOLFE

0150-699-95
ECN A187588
REV DER ECN R3052
REV 06/12/99

NAME MINIATURE QUICK CHANGE APPLICATOR
SIDE FEED (.080 DIA. PIN)

AMP INCORPORATED
Harrisburg, Pa.

LOC A D NO 466399-2 REV 2