

| REVISIONS |     |                           |           |     |      |
|-----------|-----|---------------------------|-----------|-----|------|
| P         | LTR | DESCRIPTION               | DATE      | DWN | APVD |
| D         |     | REVISED PER ECO-18-012722 | 14AUG2018 | JMS | WW   |
| D1        |     | REVISED PER ECO-20-012418 | 10SEP2020 | AP  | WW   |
| D2        |     | REVISED PER ECN-22-145617 | 23JUN2022 | AP  | MT   |

UNLESS OTHERWISE SPECIFIED:  
 1. CA19400 BRASS, TENSILE STRENGTH: 379-455 MPg (55-66 KSI) (HARDNESS REF R30T 55-62)

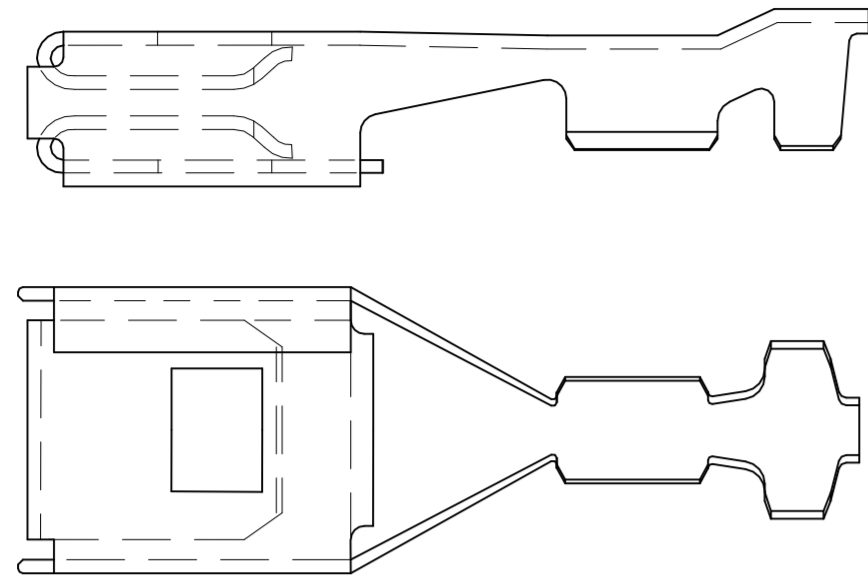

OPTIONAL CONSTRUCTION SHOWN

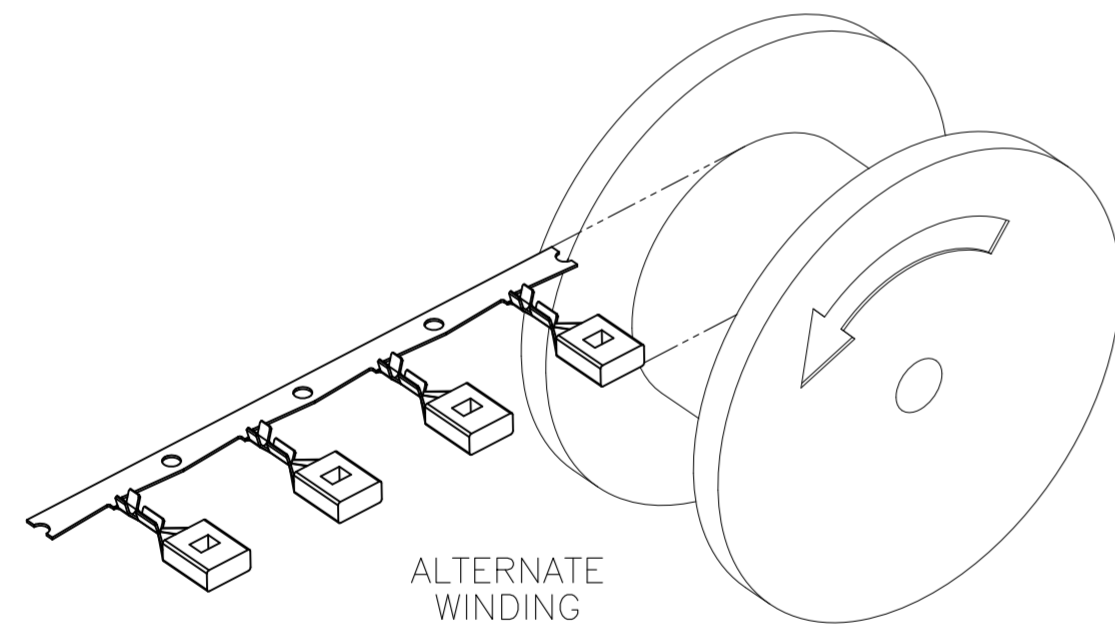
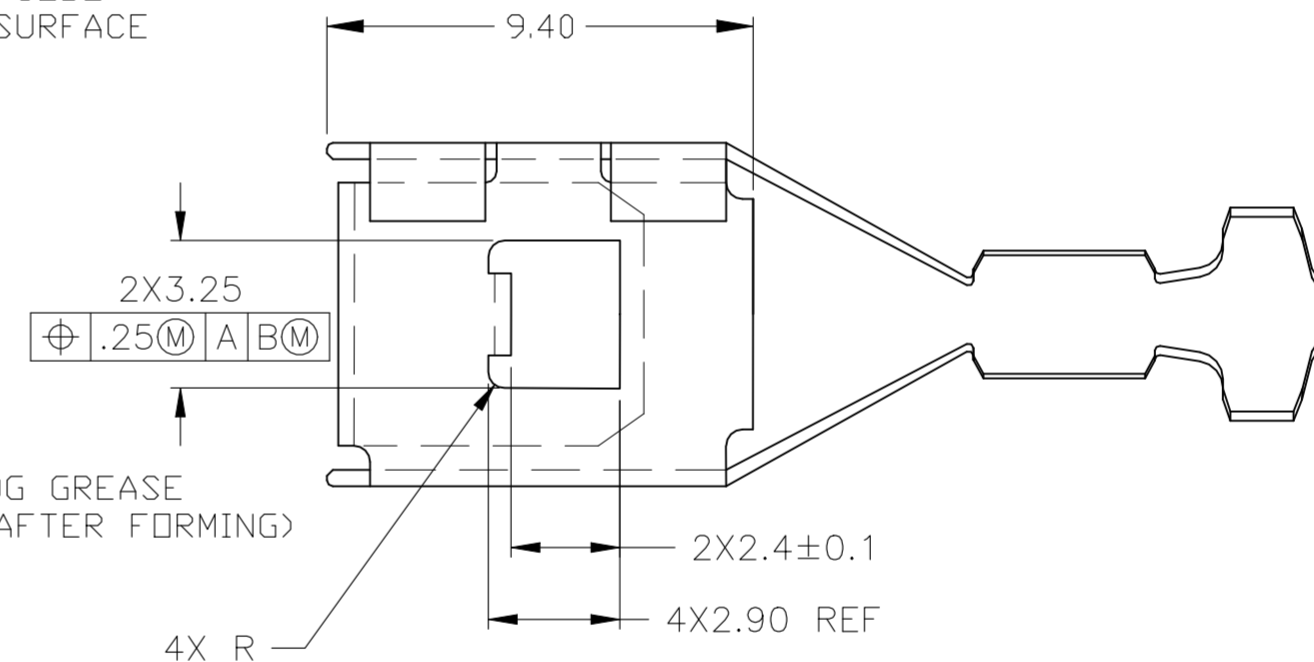
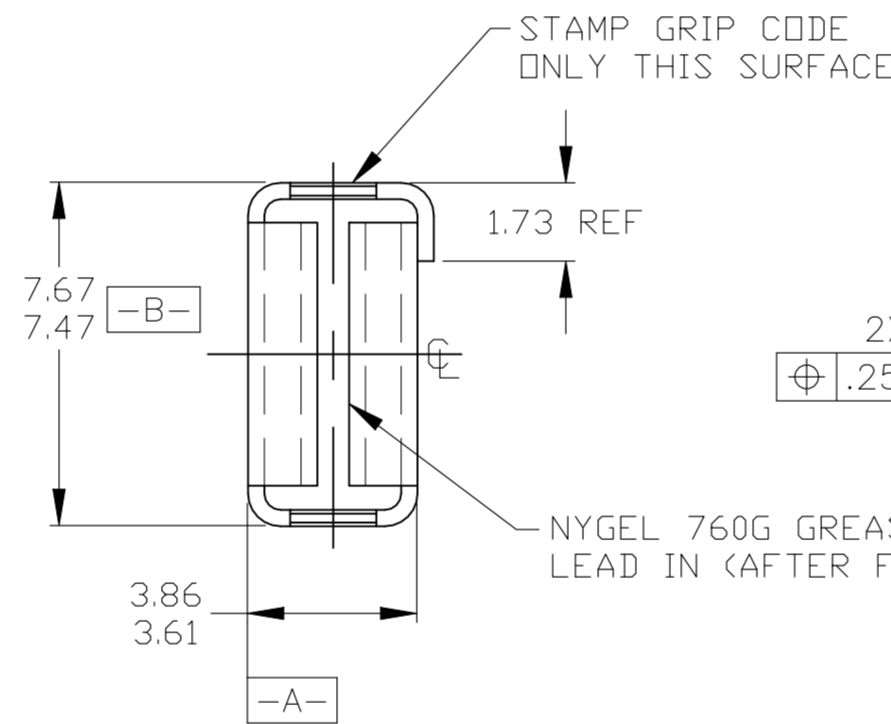
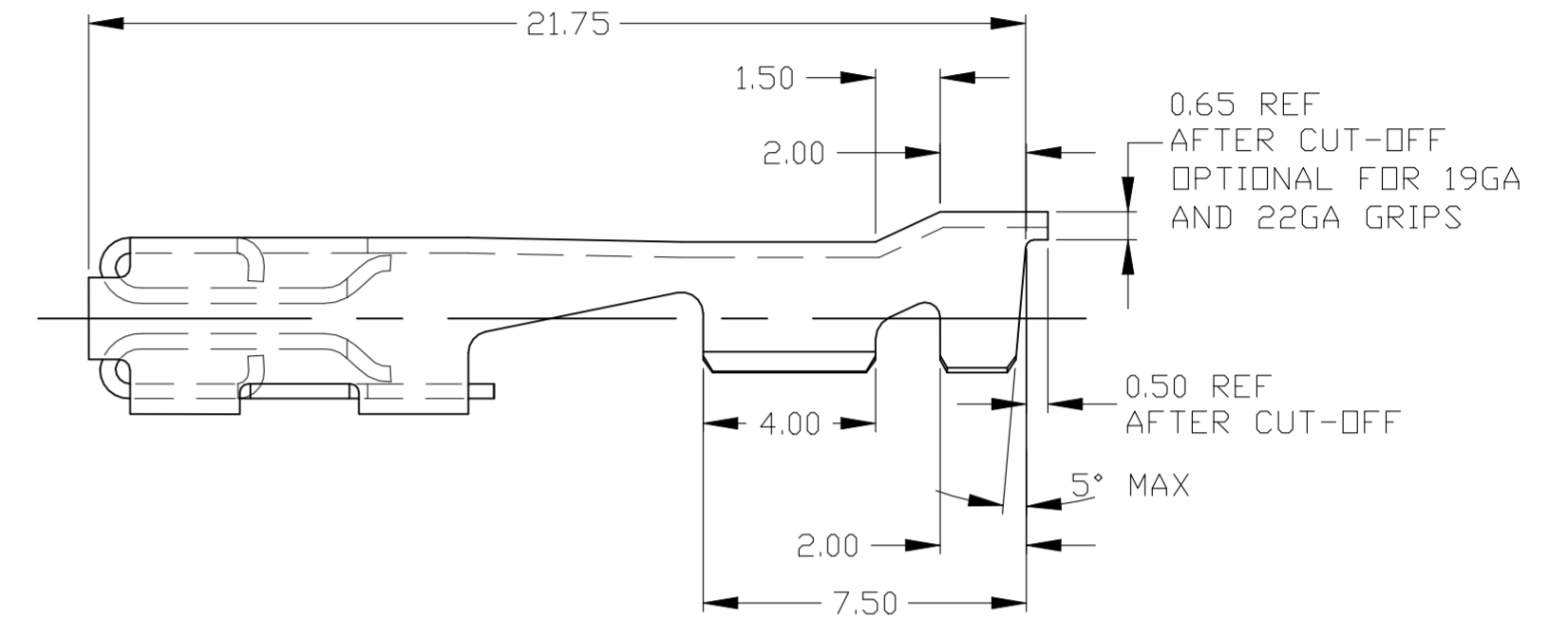

ALTERNATE WINDING

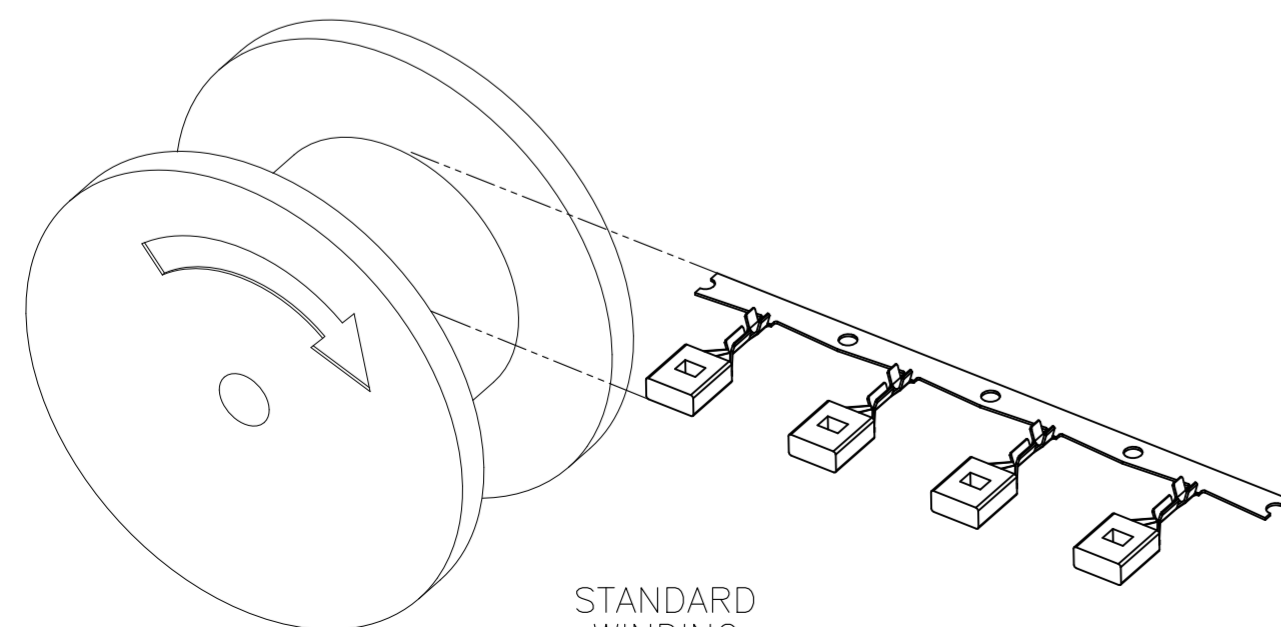

STANDARD WINDING

| OBsolete | TE P/N    | TE P/N    | TE P/N      | WIRE SIZE | INSERTION-EXTRACTION REQUIREMENTS  |
|----------|-----------|-----------|-------------|-----------|--|
|          | REWOUND   | UNGREASED | GREASED     |           |  |
| OBsolete | -         | 1438231-7 | -           | 22        | USING A POLISHED STEEL BLADE 6.22 [.245] X 0.81 [.032] FIRST INSERTION FORCE MAX 10.0N [2.2LBS] OR ANY INDIVIDUAL READING TO A DEPTH OF INSERTION OF 5.25/5.5 (UNGREASED AND GEASED) |
| OBsolete | -         | 1438231-6 | -           | 19        |  |
| OBsolete | -         | 1438231-5 | 3-1438231-3 | 18        | FOR S.P.C. WITH CPK OF 16.7 MIN MAX FIRST INSERTION 11.0N [2.42LBS] BOTH GREASED AND UNGREASED   |
|          | 1438231-8 | 1438231-4 | 3-1438231-2 | 14        |  |
| OBsolete | -         | 1438231-3 | -           | 13        | FOURTH EXTRACTION FORCE MIN 6.8N [15.8LBS] UNGREASED   |
|          | -         | 1438231-2 | -           | 11        |  |
|          | 1438231-9 | 1438231-1 | 3-1438231-1 | 10        | FOURTH EXTRACTION FORCE MIN 4.0N [0.89LBS] (GREASED)   |
|          |           |           |             |           | NOTE: REF ABOVE FOR INSERTION DEPTH  |

|  |  |                  |            |           |                                 |
|--|--|------------------|------------|-----------|---------------------------------|
| THIS DRAWING IS A CONTROLLED DOCUMENT. |  | DWN              | JR BUSSARD | 09MAY2003 | TE Connectivity                 |
| DIMENSIONS: mm                         |  | CHK              | DM REVAK   | 09MAY2003 |                                 |
| TOLERANCES UNLESS OTHERWISE SPECIFIED: |  | APVD             | DM REVAK   | 09MAY2003 | CHART<br>250 TERMINAL<br>FEMALE |
| 0 PLC ± -                              |  | PRODUCT SPEC     |            |           |                                 |
| 1 PLC ± -                              |  | APPLICATION SPEC |            |           | SIZE                            |
| 2 PLC ± 0.25                           |  |                  |            |           |                                 |
| 3 PLC ± -                              |  |                  |            |           | CAGE CODE                       |
| 4 PLC ± -                              |  |                  |            |           |                                 |
| ANGLES ± 2°                            |  |                  |            |           | DRAWING NO                      |
| FINISH                                 |  |                  |            |           |                                 |
| MATERIAL                               |  | WEIGHT           | 0.000000   | A2        | 00779                           |
|  |  | CUSTOMER DRAWING |            |           |                                 |
|  |  |                  |            | SCALE     | 5:1                             |
|  |  |                  |            | SHEET     | 1 of 1                          |
|  |  |                  |            | REV       | D2                              |