

注：
NOTE

1. 材料 MATERIAL
ピン : □0.635×14.2 黄銅、ニッケル下地金めっき
PIN : □0.635×14.2 BRASS GOLD OVER NICKEL PLATING
ウエハー : ポリアミド、UL94V-0
WAFER: POLYAMIDE,UL94V-0
2. 6極以上に適応 TO BE APPLIED FOR 6 CKT.AND MORE THAN 6 CKT.
3. 5極以下はロック部スリットなし NO SLIT IS PROVIDED FOR 5 CKT.AND LESS THAN 5 CKT.
4. ELV 及び RoHS 適合品 ELV AND RoHS COMPLIANT

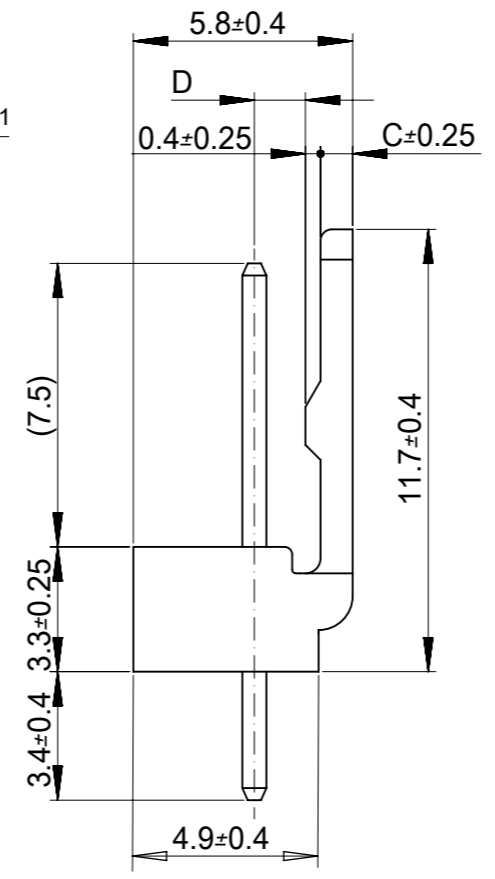
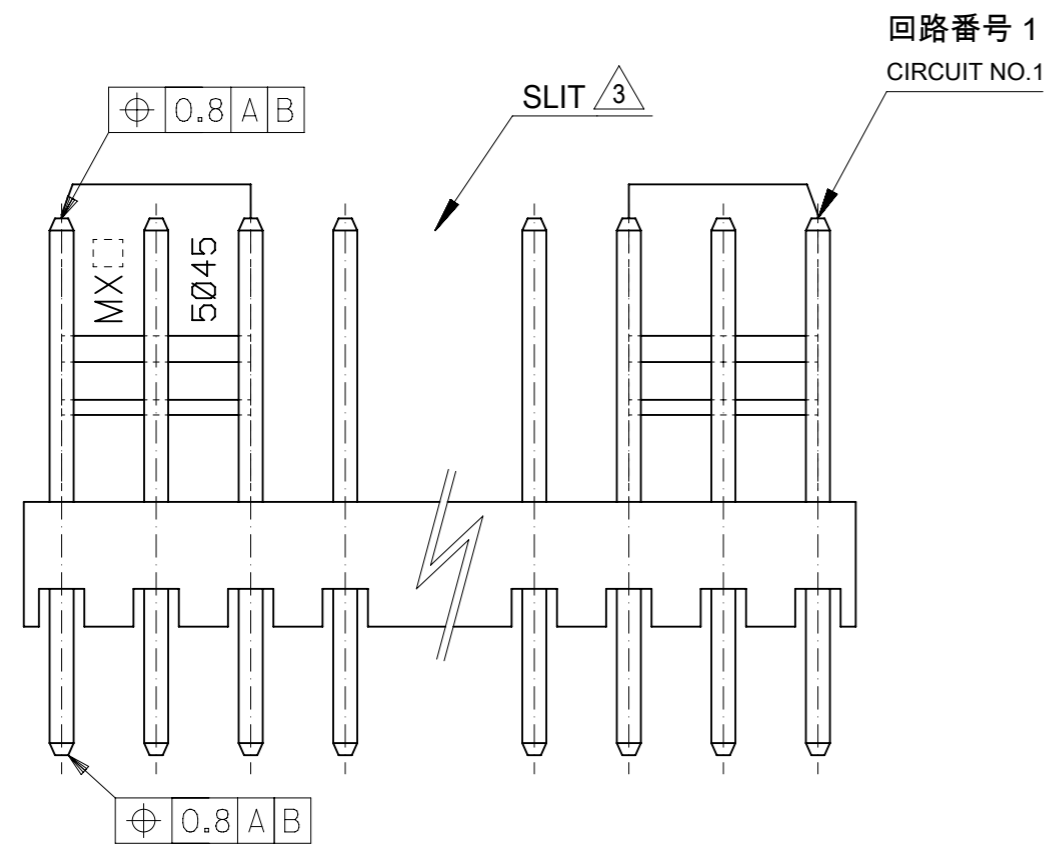

1.35	0.85	35 ^{+0.3} _{-0.45}	35	22 11 1151	15
↑	↑	32.5 ^{+0.25} _{-0.45}	32.5	↑ 1141	14
		30 ^{+0.25} _{-0.4}	30	↑ 1131	13
		27.5 ^{+0.25} _{-0.4}	27.5	↑ 1121	12
		25 ^{+0.2} _{-0.4}	25	↑ 1111	11
		22.5 ^{+0.2} _{-0.4}	22.5	↑ 1101	10
		20 ^{+0.15} _{-0.35}	20	↑ 1091	9
		17.5 ^{+0.15} _{-0.35}	17.5	↑ 1081	8
		15 ^{+0.1} _{-0.3}	15	↑ 1071	7
		12.5 ^{+0.1} _{-0.3}	12.5	↑ 1061	6
		10 ^{+0.15} _{-0.3}	10	↑ 1051	5
1.35	0.85	7.5 ^{+0.15} _{-0.3}	7.5	↑ 1041	4
1.2	1	5 ^{+0.15} _{-0.3}	5	↑ 1031	3
1.2	1	2.5 ^{+0.15} _{-0.3}	2.5	22 11 1021	2
D	C	B	A	ORDER No.	極数 CKT.

MODEL No. : 5045-**AG

THIS DRAWING CONTAINS INFORMATION THAT IS PROPRIETARY TO MOLEX ELECTRONIC TECHNOLOGIES, LLC AND SHOULD NOT BE USED WITHOUT WRITTEN PERMISSION

EC NO: 168849 DRWN: QHE31 CHK'D: SAKIYAMA APPR: TKANEKO	2017/11/28	2017/11/30	2017/12/26	GENERAL TOLERANCES (UNLESS SPECIFIED) DIMENSION UNITS: mm SCALE: 5:1 DRWN BY: RHORI DATE: 2013/11/25 CHK'D BY: KASAKAWA DATE: 2013/11/28 APPR BY: NUKITA DATE: 2013/11/28	
	ANGULAR TOL ± 3.0 °				
	4 PLACES	± 0.2			
	3 PLACES	± 0.2			
	2 PLACES	± 0.2			
1 PLACE	± 0.2				
0 PLACES	± 0.2				
DRAFT WHERE APPLICABLE MUST REMAIN WITHIN DIMENSIONS				DRAWING SIZE: A3 THIRD ANGLE PROJECTION	MINI-LATCH 2.5 HEADER ASS'Y ST WITH LOCK GOLD PLATING PRODUCT CUSTOMER DRAWING
SERIES: 5045		MATERIAL NUMBER: SEE CHART		CUSTOMER: GENERAL MARKET	
DOCUMENT NUMBER: SD-5045-001		DOC TYPE: PSD	DOC PART: 001	SHEET NUMBER: 1 OF 1	