

## Quality Control Standard

### 出货品质标准

Valued customer 客户名称 :	Customer Product Name/No. (客户产品名称/编号):	打印机切刀	
Model No 机种编号 :	Swatch No.: 样品编号	Date作成日: <b>2023/1/10</b>	Rev.
Our Code No. 仕样编号 :	(Please Use Our Code No. To Order) (订货时请用此仕样编号)	Rev. Date修订日:	
		备注	DV ROHS

### 1. Conditions of Standard Operation / 工作条件

1- 1 )Driving Voltage 驱动电压	: <b>20</b> V	DC Constant between motor terminals. 马达端子电压 <b>20</b> V 直流恒压。
1- 2 )Direction of Rotation 回转方向	: <b>CW</b>	viewing from metal housing. <b>CW</b> 面对马达金属外壳时。
1- 3 )Position of Motor 马达放置状态	: To be placed horizontally when measuring. 测试时水平放置。	

1- 4 )Operating Temperature工作温度	: <b>-10</b> °C to <b>60</b> °C	噪音测试示意图
1- 5 )Operating Humidity工作湿度	: 30%RH to 95%RH	

### 2. Conditions of Standard Test / 测试条件

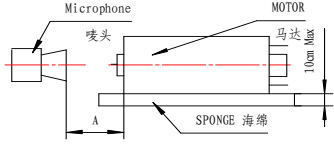
2- 1 )Testing Temperature测试温度	: 10°C to 30°C	
2- 2 )Testing Humidity测试湿度	: 30%RH to 95%RH	

### 3. Initial Electrical Characteristics / 初期特性

3- 1 ) No Load Speed 无负荷转速	: <b>8000</b> ± <b>1200</b> rpm	: <b>8000</b> ± <b>1200</b> 转/分
3- 2 ) No Load Current 无负荷电流	: <b>50</b> mA max.	: 最大 <b>50</b> 毫安培
3- 3 ) Load Speed 负荷转速	At Load <b>1.96</b> mNm : <b>6950</b> ± <b>1050</b> rpm	: <b>6950</b> ± <b>1050</b> 转/分
3- 4 ) Load Current 负荷电流	负载 <b>1.96</b> mNm : <b>160</b> mA max.	: 最大 <b>160</b> 毫安培
3- 5 ) Stall Torque 堵转扭力	At Load <b>1.6 &amp; 6.4</b> mNm : <b>11.5</b> mNm min.	: 最小 <b>11.5</b> mNm
3- 6 ) Stall Current 堵转电流	在负载点 <b>1.6 &amp; 6.4</b> mNm : <b>970</b> mA max.	: 最大 <b>970</b> 毫安培
3- 7 ) Mechanical Noise(vertical from housing side 30 cm Background noise 30dB Max) 机械噪音(距离铁壳侧 30 cm, 环境噪音30dB Max)	: <b>55</b>	dB Or below(RMS)JIS-A Characteristics dB 以下(RMS) JIS-A特性
3- 8 ) Reference Performance Curve 参考性能曲线	: As per attached Sheet <b>FP180-KT-10370</b>	: 所附图表为 <b>FP180-KT-10370</b>
3- 9 ) Dimensions 外形尺寸	: As per Drawing attached <b>WG- F180T-Y390</b>	: 所附图面为 <b>WG- F180T-Y390</b>
3- 10 ) End play of Shaft 虚位	: <b>0.05</b> ~ <b>0.60</b> mm	: <b>0.05</b> ~ <b>0.60</b> 毫米

For &amp; on behalf of Customer

For &amp; on behalf of Standard Motor Co., Ltd.

Jack Lee 2023/01/11



As a reminder, the specification should be signed and returned within two weeks, or it will be considered as acceptable by the customer. 如果客户两周内不签字确认并返回, 将被视为已认可此规格。

性能表只供参考  
马达实际参数请以马达出货标准为主



**STANDARDMOTOR 標準微型摩打有限公司**

两点法: 16.3 g.cm & 65.3 g.cm

Model/Winding 型号/卷线	Voltage 电压 V	No Load 无负荷		At Maximum Efficiency 最大效率点				At Maximum Output 最大功率点				Stall 停止	
		Current 电流 A	Speed 转速 rpm	Current 电流 A	Speed 转速 rpm	Torque 扭矩 g.cm	Efficiency 效率 %	Current 电流 A	Speed 转速 rpm	Torque 扭矩 g.cm	Output 功率 W	Current 电流 A	Torque 扭矩 g.cm
FP180-KT-10370	20.0	0.034	7998	0.157	6584	28.0	60.0	0.384	3999	79.1	3.24	0.733	158.2

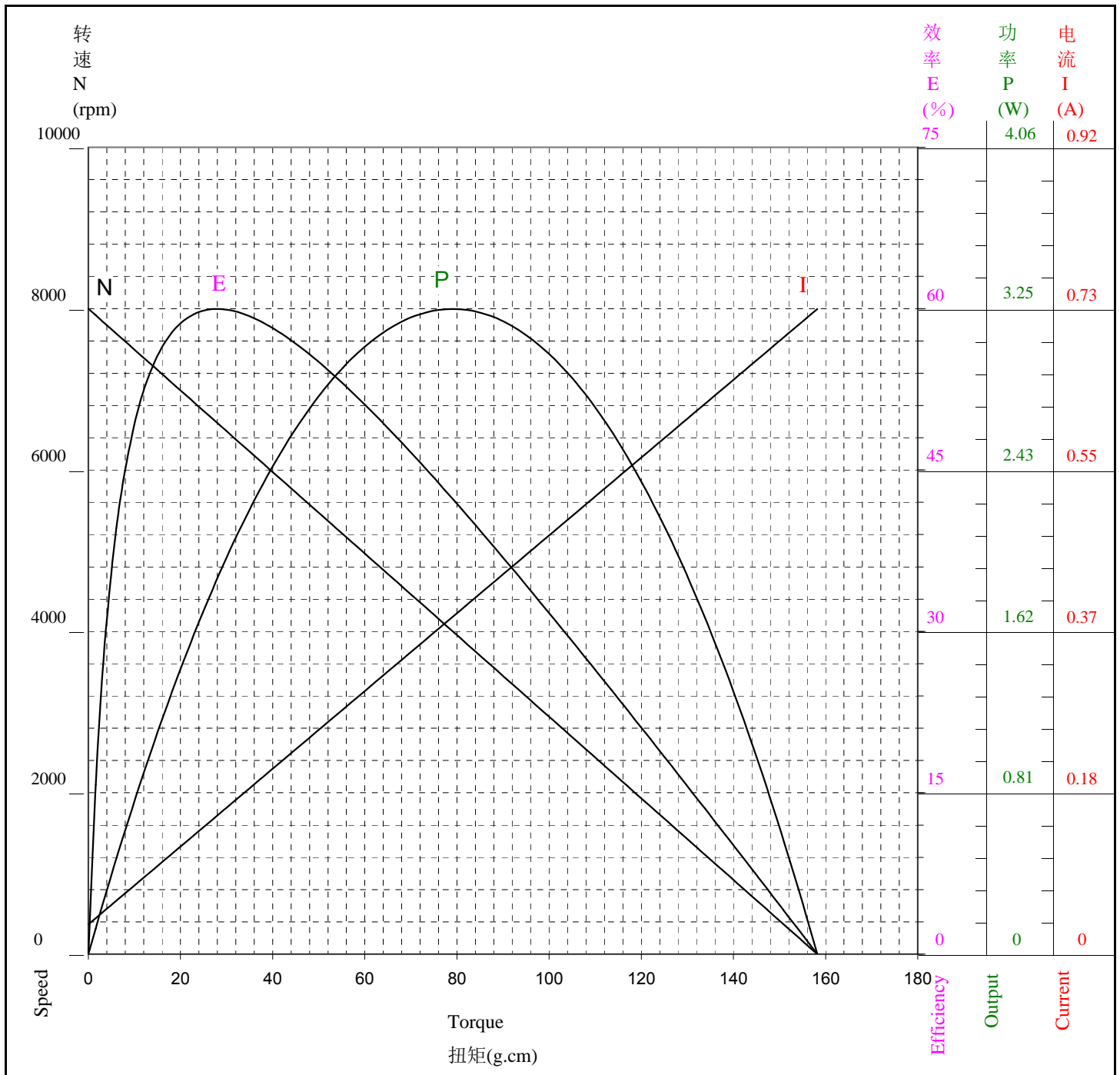

MARK	POSITION	DESCRIPTION	DATE	BY

马达回转向  
DIRECTION OF ROTATION

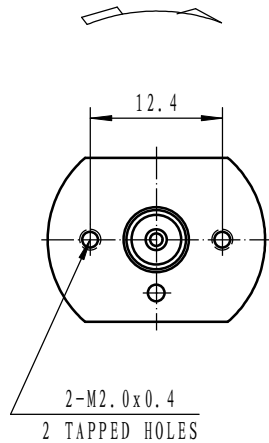

SEE NOTES 1  
参见备注 1

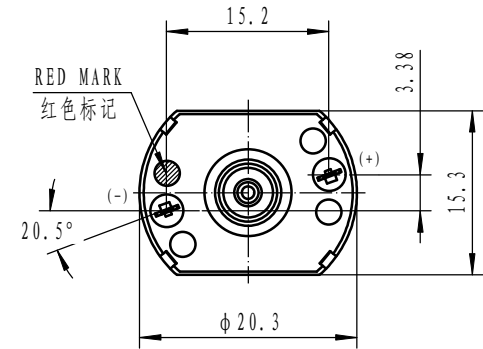
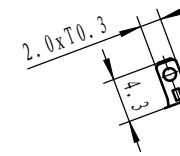
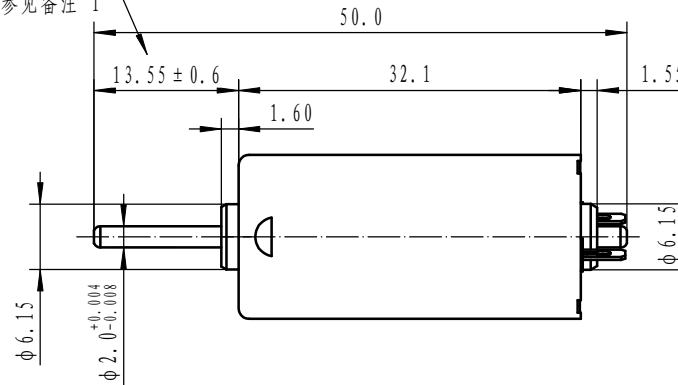

SEE NOTE 3  
参见备注 3

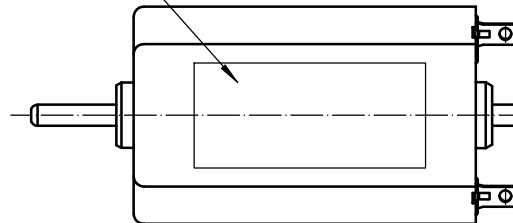

NOTES(备注):

1. THIS DIM APPLIES ONLY WHEN MOTOR SHAFT IS IN EXTREME RIGHT POSITION  
该尺寸适用于将轴压于右侧时
2. SHAFT END PLAY 0.05~0.50  
马达虚位(轴向串动)0.05~0.50
3. SPECIFIED CONTENT WILL BE TYPEGRAPHICALED IN CONFORMITY TO GETUP BOOK OF MOTOR  
按马达仕様书印刷指定内容

Characteristic	DWN. BY	刘露	DWN. DATE	2023.01.04	TITLE	Motor Outline Drawing		
	Cpk ≥ 1.33	CHK. BY	CHK. DATE		DWG. No.	WG-F180T-Y390		
	Quality control	APP. BY	APP. DATE		Undeclared tolerance	± 0.3	Angle tolerance	± 3°
Not mark	Not required	STANDARD MOTOR CO., LTD.			SCALE	2:1	Rev.	- A3