

4 CIRCUIT SHOWN

IMPRINT ON THIS SIDE WHERE APPLICABLE

8.25 TYP [0.325]

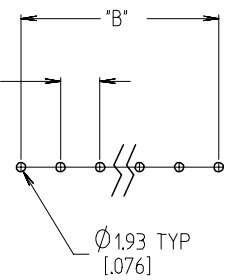

PTH PATTERN SCALE 1:1

NOTES:

1. MATERIAL: SEE TABLE
2. FINISH: SEE TABLE
3. "XX" REFERS TO THE QUANTITY OF CIRCUITS.
4. INCH DIMENSIONS ARE SHOWN IN BRACKETS [XXX].
5. ALL COMPONENTS ARE ROHS COMPLIANT.
6. FOR IMPRINTING SEE SD-38120-001.

|      |      |  |               |                    |
|------|------|--|---------------|--------------------|
| 5    | *XX* | SCREW, #6-32X.250, PAN, PH-SL, W/WSHR (-50 OPTION) | STEEL         | ZN, CLEAR CHROMATE |
| 4    | *XX* | SCREW, #6-32X.250, PAN, PH-SL (-49 OPTION)         | BRASS         | NICKEL             |
| 3    | *XX* | SCREW, #6-32X.250, PAN, PH-SL                      | STEEL         | ZN, CLEAR CHROMATE |
| 2    | *XX* | TERMINAL, PC, RA, #6-32                            | BRASS         | TIN                |
| 1    | 1    | INSULATOR, SR, MOLDED                              | THERMOPLASTIC | BLACK              |
| ITEM | QTY  | DESCRIPTION  | MATERIAL      | FINISH             |

|                          |                 |
|--------------------------|-----------------|
| INITIAL RELEASE          | QUALITY SYMBOLS |
| EC NO: ETC2007-0010      | ▽=0             |
| DRW:NEHLE 2006/08/07     | ▽=0             |
| CHKD:IMACNEIL 2006/08/08 |                 |
| APPR:RDEROSS 2006/08/09  |                 |
| REV                      | DESCRIPTION     |
| A                        |                 |

| GENERAL TOLERANCES (UNLESS SPECIFIED)                |        |
|--|--------|
| mm   | INCH   |
| 4 PLACES ± ---                                       | ± ---  |
| 3 PLACES ± ---                                       | ± .005 |
| 2 PLACES ± 0.13                                      | ± .01  |
| 1 PLACE ± 0.3  | ± ---  |
| ANGULAR ± 2 °  |        |
| DRAFT WHERE APPLICABLE MUST REMAIN WITHIN DIMENSIONS |        |

| DIMENSION STYLE |              |
|-----------------|--------------|
| MM/IN           |              |
| DRAWN BY        | DATE         |
| EHILE           | 2006/07/25   |
| CHECKED BY      | DATE         |
| RDEROSS         | 2006/07/25   |
| APPROVED BY     | DATE         |
| RDEROSS         | 2006/07/25   |
| MATERIAL NO.    | DOCUMENT NO. |
| SEE CHART       | SD-38701-003 |

|   |              |                        |
|---|--------------|------------------------|
| SCALE   | DESIGN UNITS | THIRD ANGLE PROJECTION |
| 2:1   | INCH         |                        |
| TITLE   |              |                        |
| 8.26MM [0.325] SR BTS PC RA ASSY, NO MTG  |              |                        |
| MATERIAL NO.  |              |                        |
| MOLEX INCORPORATED  |              |                        |
| DOCUMENT NO.  |              | SHEET NO.              |
| SD-38701-003  |              | 1 OF 2                 |
| THIS DRAWING CONTAINS INFORMATION THAT IS PROPRIETARY TO MOLEX INCORPORATED AND SHOULD NOT BE USED WITHOUT WRITTEN PERMISSION |              |                        |

| NO. OF CIRCUITS "XX" | DIM. "A" |      | DIM. "B" |       | ASSEMBLY MATERIAL NO. (-C OPTION) | ASSEMBLY MATERIAL NO. (-C-49 OPTION) | ASSEMBLY MATERIAL NO. (-C-50 OPTION) | ASSEMBLY MATERIAL NO. (-C-50-11B OPTION) |
|----------------------|----------|------|----------|-------|-----------------------------------|--------------------------------------|--------------------------------------|--|
|                      | mm       | INCH | mm       | INCH  |                                   |                                      |                                      |  |
| 02                   | 18.4     | 0.73 | 8.26     | 0.325 | 387015302                         | -                                    | 387015902                            | -  |
| 03                   | 26.7     | 1.05 | 16.51    | 0.650 | 387015303                         | 387090060                            | 387015903                            | -  |
| 04                   | 34.9     | 1.38 | 24.77    | 0.975 | 387015304                         | 387090095                            | 387015904                            | -  |
| 05                   | 43.2     | 1.70 | 33.02    | 1.300 | 387015305                         | 387015605                            | 387015905                            | -  |
| 06                   | 51.4     | 2.03 | 41.28    | 1.625 | 387015306                         | 387090127                            | 387015906                            | -  |
| 07                   | 59.7     | 2.35 | 49.53    | 1.950 | 387015307                         | -                                    | 387015907                            | -  |
| 08                   | 67.9     | 2.68 | 57.79    | 2.275 | 387015308                         | 387015608                            | 387015908                            | -  |
| 09                   | 76.2     | 3.00 | 66.04    | 2.600 | 387015309                         | -                                    | 387015909                            | -  |
| 10                   | 84.5     | 3.33 | 74.30    | 2.925 | 387015310                         | -                                    | 387015910                            | -  |
| 11                   | 92.7     | 3.65 | 82.55    | 3.250 | 387015311                         | -                                    | 387015911                            | -  |
| 12                   | 101.0    | 3.98 | 90.81    | 3.575 | 387015312                         | 387015612                            | 387015912                            | -  |
| 13                   | 109.2    | 4.30 | 99.06    | 3.900 | 387015313                         | -                                    | 387015913                            | -  |
| 14                   | 117.5    | 4.63 | 107.32   | 4.225 | 387015314                         | -                                    | 387015914                            | -  |
| 15                   | 125.7    | 4.95 | 115.57   | 4.550 | 387015315                         | -                                    | 387015915                            | 387090262                                |
| 16                   | 134.0    | 5.28 | 123.83   | 4.875 | 387015316                         | -                                    | 387015916                            | -  |
| 17                   | 142.2    | 5.60 | 132.08   | 5.200 | 387015317                         | -                                    | 387015917                            | -  |
| 18                   | 150.5    | 5.93 | 140.34   | 5.525 | 387015318                         | -                                    | 387015918                            | -  |
| 19                   | 158.8    | 6.25 | 148.59   | 5.850 | 387015319                         | -                                    | 387015919                            | -  |
| 20                   | 167.0    | 6.58 | 156.85   | 6.175 | 387015320                         | -                                    | 387015920                            | -  |
| 21                   | 175.3    | 6.90 | 165.10   | 6.500 | 387015321                         | -                                    | 387015921                            | -  |
| 22                   | 183.5    | 7.23 | 173.36   | 6.825 | 387015322                         | -                                    | 387015922                            | -  |
| 23                   | 191.8    | 7.55 | 181.61   | 7.150 | 387015323                         | -                                    | 387015923                            | -  |
| 24                   | 200.0    | 7.88 | 189.87   | 7.475 | 387015324                         | -                                    | 387015924                            | -  |
| 25                   | 208.3    | 8.20 | 198.12   | 7.800 | 387015325                         | 387015625                            | 387015925                            | -  |
| 26                   | 216.5    | 8.53 | 206.38   | 8.125 | 387015326                         | -                                    | 387015926                            | -  |
| 27                   | 224.8    | 8.85 | 214.63   | 8.450 | 387015327                         | -                                    | 387015927                            | -  |
| 28                   | 233.0    | 9.18 | 222.89   | 8.775 | 387015328                         | -                                    | 387015928                            | -  |
| 29                   | 241.3    | 9.50 | 231.14   | 9.100 | 387015329                         | -                                    | 387015929                            | -  |
| 30                   | 249.6    | 9.83 | 239.40   | 9.425 | 387015330                         | -                                    | 387015930                            | -  |

|   |                               |  |        |                           |                    |  |                      |                            |  |
|---|-------------------------------|--|--------|---------------------------|--------------------|--|----------------------|----------------------------|--|
| INITIAL RELEASE<br>EC NO: ETC2007-0010<br>DRW: NEHLE 2006/08/07<br>CHKD: IMACNEIL 2006/08/08<br>APPR: RDEROSS 2006/08/09<br>A | QUALITY SYMBOLS<br>▽=0<br>▽=0 | GENERAL TOLERANCES (UNLESS SPECIFIED)                      |        | DIMENSION STYLE<br>MM/IN  |                    | SCALE<br>2:1   | DESIGN UNITS<br>INCH | THIRD ANGLE PROJECTION<br> |  |
|   |                               | mm   | INCH   | DRAWN BY<br>EHILE         | DATE<br>2006/07/25 | TITLE<br>8.26MM [.325] SR BTS<br>PC RA ASSY, NO MTG  |                      |                            |  |
|   |                               | 4 PLACES ± ---   | ± ---  | CHECKED BY<br>RDEROSS     | DATE<br>2006/07/25 | APPROVED BY<br>RDEROSS   |                      |                            | MOLEX INCORPORATED<br>DOCUMENT NO.<br>SD-38701-003 |
|   |                               | 3 PLACES ± ---   | ± .005 | APPROVED BY<br>RDEROSS    |                    | DATE<br>2006/07/25   | SHEET NO.<br>2 OF 2  |                            |  |
| 2 PLACES ± 0.13   | ± .01                         | DRAFT WHERE APPLICABLE<br>MUST REMAIN<br>WITHIN DIMENSIONS |        | MATERIAL NO.<br>SEE CHART |                    | THIS DRAWING CONTAINS INFORMATION THAT IS PROPRIETARY TO MOLEX<br>INCORPORATED AND SHOULD NOT BE USED WITHOUT WRITTEN PERMISSION |                      |                            |  |
| 1 PLACE ± 0.3   | ± ---                         | ANGULAR ± 2 °  |        | SIZE<br>B                 |                    |  |                      |                            |  |