

1

2

3

4

5

6

7

NOTES:**MATERIAL**

- 1.Pin(outer sleeve): Brass, machined CuZn38Pb2
 - ② 2.Clip(contact 4 finger): Beryllium copper, heat treated
 - 3.Plating(outer sleeve): 2um/80u"nickel, 5um/200u"TiN
 - 4.Plating(contact): 2um/80u"nickel, Gold flash
 - 5.Insulator Material: Glass filled PBT, UL94V-0 Black
- ELECTRICAL**
- 1.Current Rating: 3Amps/contact max.
 - 2.Contact Resistance: 4mΩ/contact max.
 - 3.Insulation Resistance: ≥10000MΩ at 500VAC
 - 4.Operating Voltage: 100 VRMS/150VDC
- MECHANICAL**
- 1.Average Insertion force with steel pin of $\phi 0.43\text{mm}/0.017''$: <250g
 - 2.Average Withdrawal force with steel pin of $\phi 0.43\text{mm}/0.017''$: >50g min.
 - 3.Mechanical life cycle: 200 mln.
 - 4.Operation Temperature: -40°C to +105°C
 - 5.Soldering temperature: +220°C, 10s max.

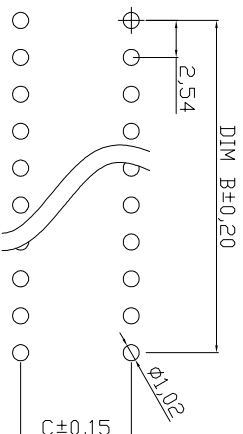
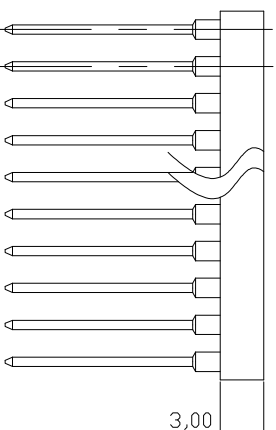
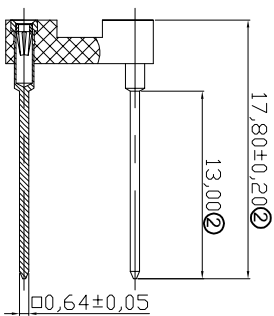
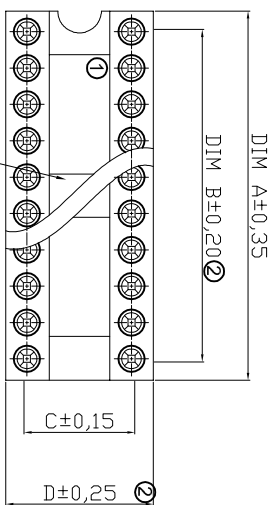
**Packing: Tube**

Contact	DIM A	DIM B	DIM C	DIM D	Note
6	7.62	5.08	7.62	10.16	
8	10.16	7.62	7.62	10.16	
10	12.70	10.16	7.62	10.16	
14	17.78	15.24	7.62	10.16	W/O Bar
16	20.32	17.78	7.62	10.16	
18	22.86	20.32	7.62	10.16	
① 20	25.40	22.86	7.62	10.16	
③ 24	30.48	27.94	15.24	17.78	
③ 28	30.56	33.02	15.24	17.78	W Bar
③ 40	50.80	48.26	15.24	17.78	

RoHS compliant

Unit: mm

Scale	Free TOLERANCE	Free TOL	Id.	Modification	Date	Name
X.	±0.50	±0.10	①	Update	30.10.2014	Amy
X.X	±0.30	±0.10	②	Update to new drawing	28.10.2016	Amy
X.XX	±0.20	±0.10	③	Update drawing	27.04.2018	Segal
X.XXX	±0.10	±0.10	④	Update	17.02.2014	Amy
DIM	±0.10	±0.10	⑤	Drawn	17.02.2014	Amy
Angle	±5°	±5°				
Angle	TOL	TOL				

Customer-No.

ASSMANN WSW-No.

AR xx-HZW/TTN

Drawing-No.

ASS 6290 CO

rev03

Replace

ASS 3579 CO
ASS 3580 CO

Sheet

1

2

3

4

5

6

7

H

G

G

H