

| PART NUMBER | REV | FIRST USED | DESCRIPTION |
|-------------|-----|------------|--------------------|
| 1852157-1 | A | 122500-1 | CUTS CARRIER |
| 1852157-2 | A | 565435-5 | CUTS CARRIER |
| 1852157-3 | A | 354500-1 | CUTS CARRIER |
| 1852157-6 | A | 122500-1 | CONTINUOUS CARRIER |
| 7-1852157-7 | A | 354500-1 | SPARE PARTS |

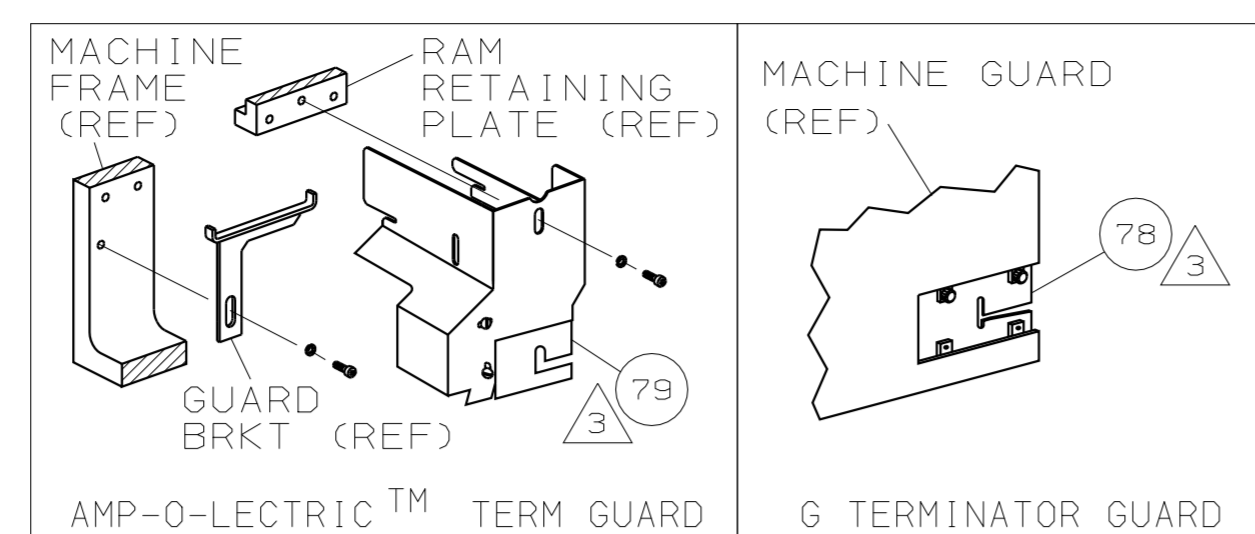

| TERMINAL NAME: Micro-Match COSI CONTACT | | | |
|---|---------------------------|-----------|------------------|
| 338096 | | | |
| PAD LTR | CRIMP HEIGHT | WIRE SIZE | |
| A | .031 ±.002 [0.79 ±0.05mm] | 24 | |
| B | .029 ±.002 [0.74 ±0.05mm] | 26 | |
| C | .026 ±.002 [0.66 ±0.05mm] | 28 | |
| D | NOT | USED | |
| CRIMP | SIZE | TYPE | RANGE |
| WIRE | .042 [1.07mm] | F | 28-24 |
| INSUL | .055 [1.40mm] | 0 | ∅.030-.040 |
| WIRE STRIP LENGTH | TERM APPL SPEC | FEED | APPL INSTRUCTION |
| .098 [2.50] | 114-19051 | .236 | 408-8040 |
| SET UP GAGE | LAYOUT | | |
| 458637-1 | - | | |

| | | |
|-----|-------------------|----------------|
| -1 | LEADMAKER | MECH POST FEED |
| -2 | BENCH MODEL K | MECH PRE FEED |
| -3 | BENCH MODEL G | MECH PRE FEED |
| -6 | LEADMAKER | MECH POST FEED |
| -77 | BENCH & LEADMAKER | SPARE PARTS |

- 1 RECOMMENDED SPARE PARTS.
- 2 GREASE LIGHTLY.
- 3 GUARD MUST BE IN PLACE WHEN OPERATING APPLICATOR IN A BENCH MACHINE.
- 4 LUBRICATE DAILY USING NO. 20 MACHINE OIL.

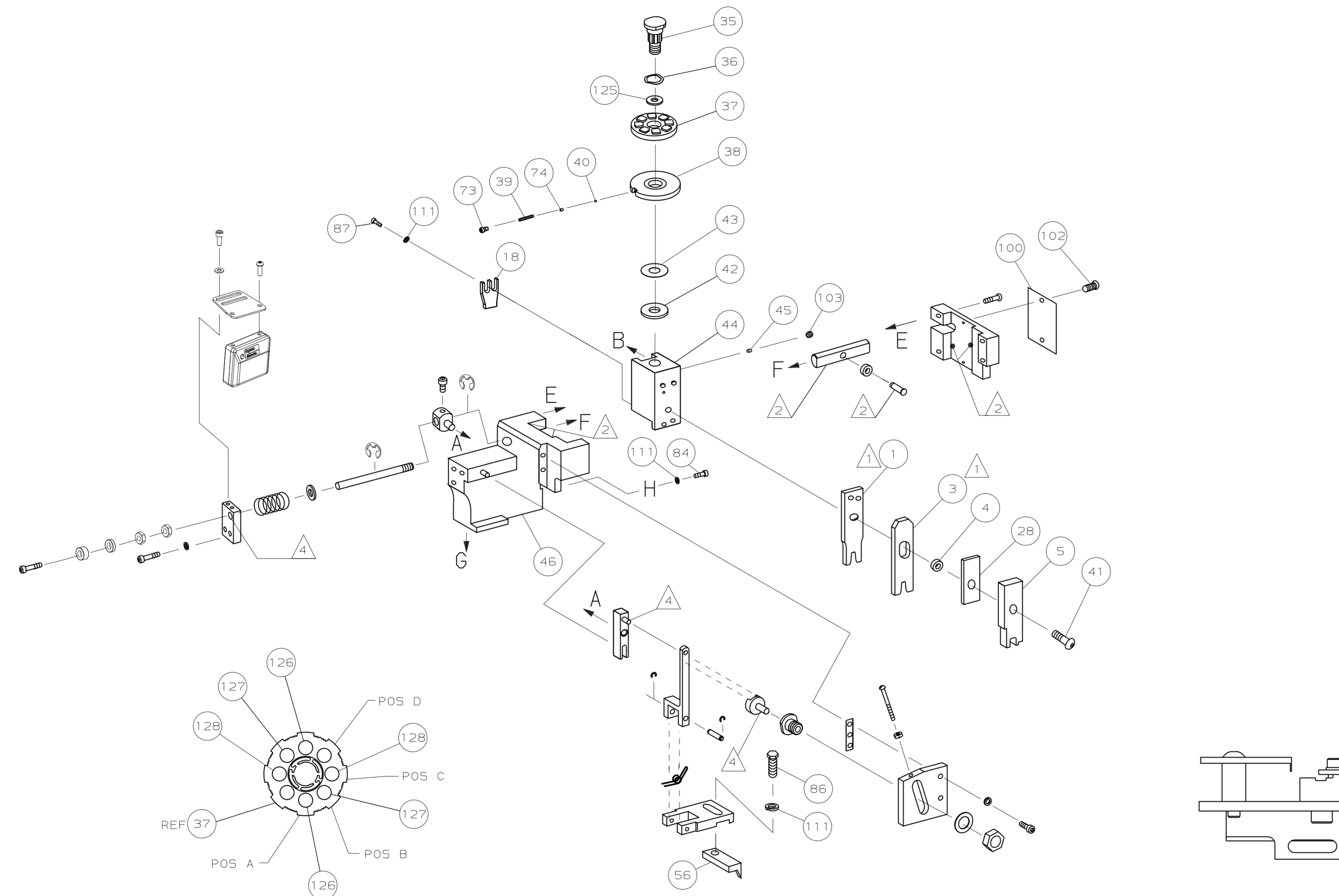

| QTY | REQD | PER | ASSY | PART NO | DESCRIPTION | ITEM NO | | | |
|-----|------|-----|------|---------|-------------|------------|------------------------------------|-------------------------|----|
| - | 2 | 2 | 2 | 2 | - C | 4-354779-2 | PIN, WIRE DISC (.3200)B | 129 | |
| - | 2 | 2 | 2 | 2 | - C | 3-354779-4 | PIN, WIRE DISC (.3160)B | 127 | |
| - | 2 | 2 | 2 | 2 | - C | 3-354779-0 | PIN, WIRE DISC (.3140)A | 126 | |
| - | 1 | 1 | 1 | 1 | - A | 986950-1 | WASHER, FLAT PRECISION | 125 | |
| - | 1 | 1 | 1 | 1 | - A | 217238-1 | GENERAL INSTRUCTION PACKAGE | 124 | |
| - | 1 | 1 | 1 | 1 | - | 4088040 | SF APPL INST 408-8040 | 123 | |
| - | 1 | 1 | 1 | 1 | - A | 21024-5 | WASHER, LOCK (#10)ADJ BLOCK | 117 | |
| - | 4 | 4 | 4 | 4 | - A | 21024-4 | WASHER, LOCK (#8) STRIPPER | 111 | |
| - | 1 | 1 | 1 | 1 | - A | 21009-2 | SCR, SKT SET (1/4-20x.25 LW) RAM | 103 | |
| - | 2 | 2 | 2 | 2 | - A | 21017-2 | SCR, DRIVE (#2x.19) ID PLATE | 102 | |
| - | 1 | 1 | 1 | 1 | - B | 461264-1 | PLATE, IDENTIFICATION | 100 | |
| - | 1 | 1 | 1 | 1 | - A | 22733-8 | SCR, BHC (8-32x.38 LW) ANVIL | 98 | |
| - | 2 | 2 | 2 | 2 | - A | 2-21002-2 | SCR, BHC (8-32x.50) SHEAR HOLDER | 94 | |
| - | 1 | 1 | 1 | 1 | - A | 1-21002-7 | SCR, BHC (6-32x.38) CAM | 91 | |
| - | 2 | 2 | 2 | 2 | - A | 2-21000-5 | SCR, SHC (8-32x.25) TERM H DWN | 87 | |
| - | 1 | 1 | 1 | 1 | - A | 2-22603-0 | SCR, HEX HD (8-32x.31) FEED FINGER | 86 | |
| - | 1 | 1 | 1 | 1 | - A | 2-21000-7 | SCR, SHC (8-32x.50) STRIPPER | 84 | |
| - | 1 | 1 | 1 | 1 | - A | 3-21000-4 | SCR, SHC (10-32x.38) SG ADJ BL | 81 | |
| - | - | - | - | - | REF | - | GUARD, WINDOW | 79 | |
| - | - | - | - | - | REF | - | INSERT, GUARD | 78 | |
| - | 1 | 1 | 1 | 1 | - A | 690603-1 | SPRING, ASSIST | 74 | |
| - | 1 | 1 | 1 | 1 | - A | 23030-1 | SCR, SHC (6-32x.25 SL) INS DISC | 73 | |
| - | 1 | 1 | 1 | 1 | - B | 458537-2 | PAWL, FEED | 56 | |
| - | - | 1 | - | - | - | B | 690602-6 | CAM, PRE-FEED 1 5/8 ST | 49 |
| - | - | - | 1 | - | - | B | 690602-5 | CAM, PRE-FEED 1 1/8 ST | 48 |
| - | 1 | - | - | 1 | - | B | 690501-4 | CAM, POST-FEED 1 5/8 ST | 47 |
| - | 1 | 1 | 1 | 1 | - B | 459456-1 | APPLICATOR, BASIC (SUBASSY) | 46 | |
| - | 1 | 1 | 1 | 1 | - A | 690191-1 | PLUG, NYLON | 45 | |
| - | 1 | 1 | 1 | 1 | - C | 455673-3 | RAM | 44 | |
| - | 1 | 1 | 1 | 1 | - A | 690125-1 | WASHER, LAMINATED | 43 | |
| - | 1 | 1 | 1 | 1 | - A | 690124-9 | WASHER, RAM | 42 | |
| - | 1 | 1 | 1 | 1 | - A | 7-21002-9 | BOLT, CRIMPER (5/16x1.00) | 41 | |
| - | 1 | 1 | 1 | 1 | - A | 23241-6 | BALL, STEEL | 40 | |
| - | 1 | 1 | 1 | 1 | - A | 690170-1 | SPRING, COMPRESSION | 39 | |
| - | 1 | 1 | 1 | 1 | - C | 690142-5 | DISC, INSULATION | 38 | |
| - | 1 | 1 | 1 | 1 | - D | 354777-1 | DISC, WIRE | 37 | |
| - | 1 | 1 | 1 | 1 | - A | 22480-5 | WASHER, SPRING | 36 | |
| - | 1 | 1 | 1 | 1 | - B | 690212-1 | POST, RAM | 35 | |
| - | 2 | 2 | 2 | 2 | - A | 2-21002-3 | SCREW, BHC (8-32x.62) | 33 | |
| - | 1 | 1 | 1 | 1 | - A2 | 1320908-9 | SPACER, STRIP GUIDE | 30 | |
| - | 1 | 1 | 1 | 1 | - A1 | 1633091-1 | SUB-ASSY, FEEDTRACK | 29 | |
| - | 1 | 1 | 1 | 1 | - C | 455888-1 | SPACER, FRONT SHEAR DEP | 28 | |
| - | 1 | 1 | 1 | 1 | - A2 | 1320928-1 | PLATE, STRIP GUIDE | 24 | |
| - | 1 | 1 | 1 | 1 | - B | 690472-8 | STRIPPER | 22 | |
| - | 1 | 1 | 1 | 1 | - B | 1-690518-1 | HOLDER, TERMINAL | 18 | |
| - | 1 | - | - | - | - | C | 679625-1 | HOLDER, SHEAR (FRONT) | 17 |
| - | 1 | 1 | 1 | 1 | - B | 318563-1 | GUARD, CHIP, FRONT | 16 | |
| - | 1 | 1 | 1 | 1 | - A | 3-22280-3 | SPRING, SHEAR | 12 | |
| - | 1 | 1 | 1 | 1 | - B | 690461-1 | STOP, SHEAR | 11 | |
| - | - | 1 | 1 | 1 | - C | 690459-1 | HOLDER, SHEAR (FRONT) | 10 | |
| 1 | 1 | 1 | 1 | 1 | - C | 462006-1 | SHEAR, FLOAT (FRONT) | 9 | |
| 1 | 1 | 1 | 1 | 1 | - C | 1-662182-8 | ANVIL | 8 | |
| - | 1 | 1 | 1 | 1 | - C | 2-455889-0 | DEPRESSOR, SHEAR (FRONT) | 5 | |
| - | 1 | 1 | 1 | 1 | - B | 1-238011-6 | SPACER, BLOCK CRIMPER | 4 | |
| 1 | 1 | 1 | 1 | 1 | - C | 5-683454-9 | CRIMPER, INSULATION | 3 | |
| 1 | 1 | 1 | 1 | 1 | - C | 3-456401-0 | CRIMPER, WIRE | 1 | |

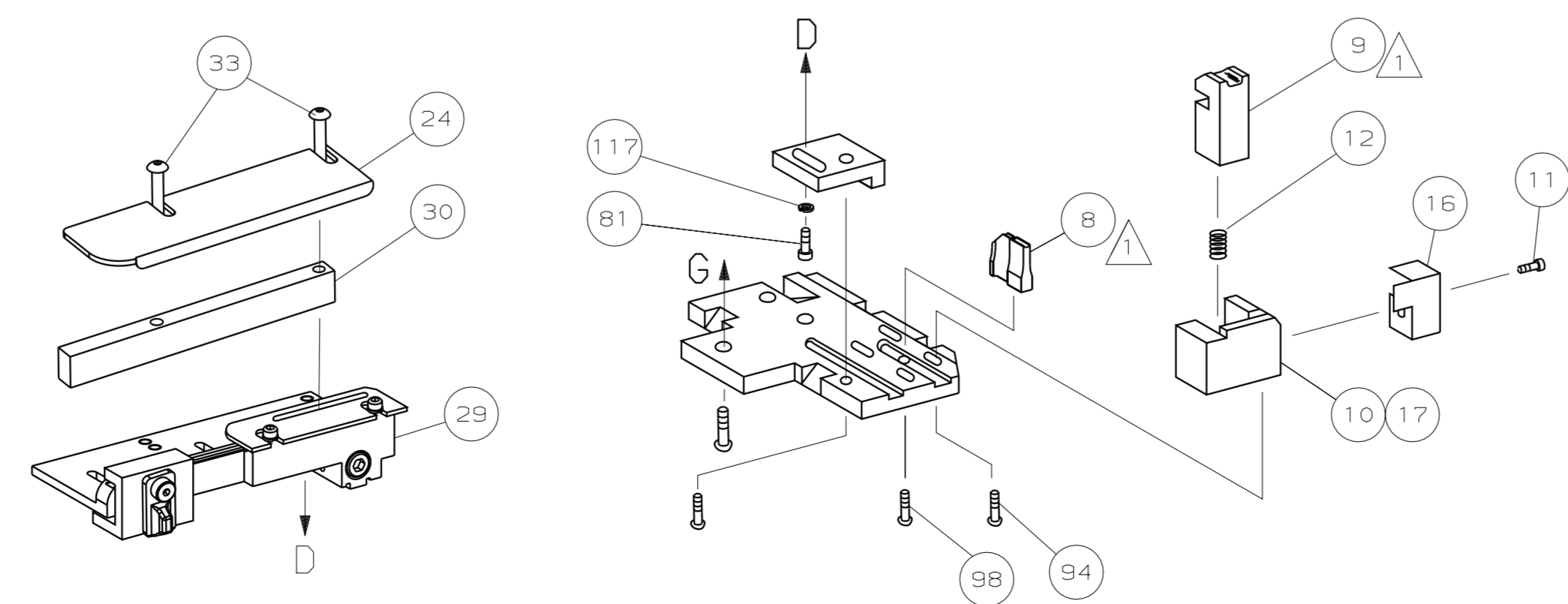
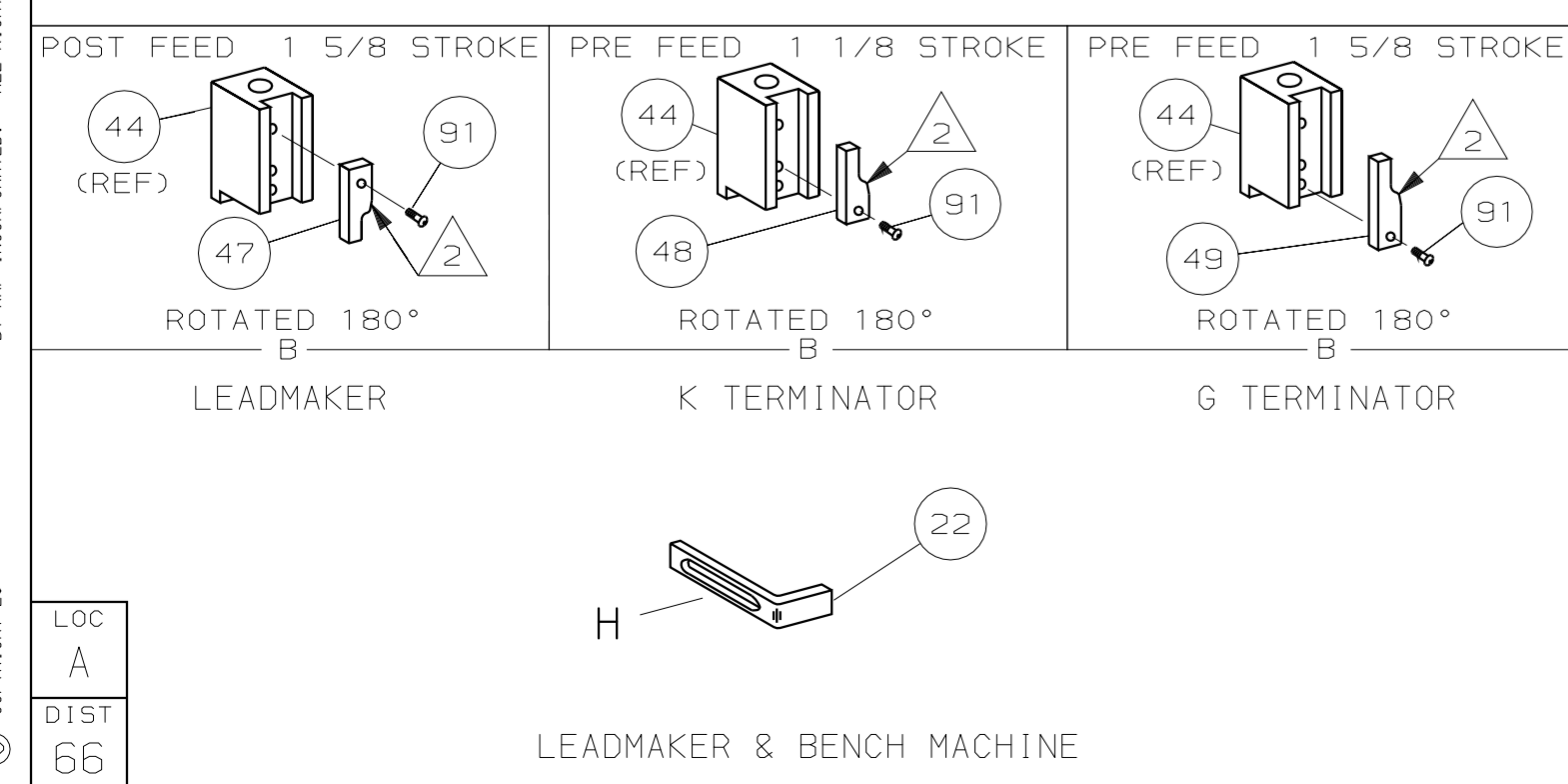

| DIMENSIONS IN INCHES. DO NOT SCALE PRINT. TOLERANCES UNLESS OTHERWISE SPECIFIED: | | MATERIAL | | FINISH | |
|--|--------------|-------------------------------|---------|---------------|---|
| DR | 11NOV05 | APP | 14NOV05 | HT TR | - |
| R.O.WILSON | T.ELBIN | | | | |
| 2 | PLC DEC ±.02 | | | | |
| 3 | PLC DEC ± | | | | |
| 4 | PLC DEC ± | | | | |
| ANGLES ± | | | | | |
| SURF TEXTURE: ✓ | | | | | |
| REMOVE BURRS, BREAK SHARP EDGES R.015 MAX | | | | | |
| SCALE: - | | DWG NO: 1852157 | | SHEET 1 OF 1 | |
| CAGE CODE: 00779 | | CUSTOMER AND ASSEMBLY DRAWING | | RESTRICTED TO | |

THIS DRAWING IS A CONTROLLED DOCUMENT.

20

THIS DRAWING IS UNPUBLISHED. RELEASED FOR PUBLICATION BY AMP INCORPORATED. ALL RIGHTS RESERVED. © COPYRIGHT 20

LOC A
DIST 66

1852157

D

C

B

A