

### BU-1420701301 (CONN SMA JACK R/A 50 OHM PCB)

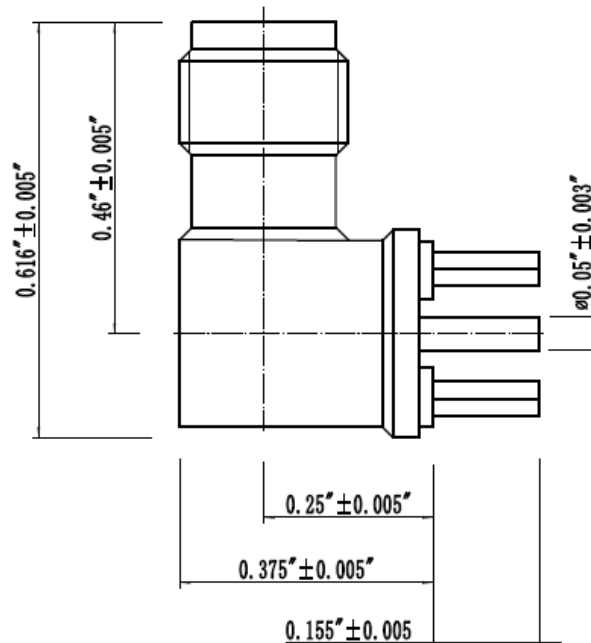

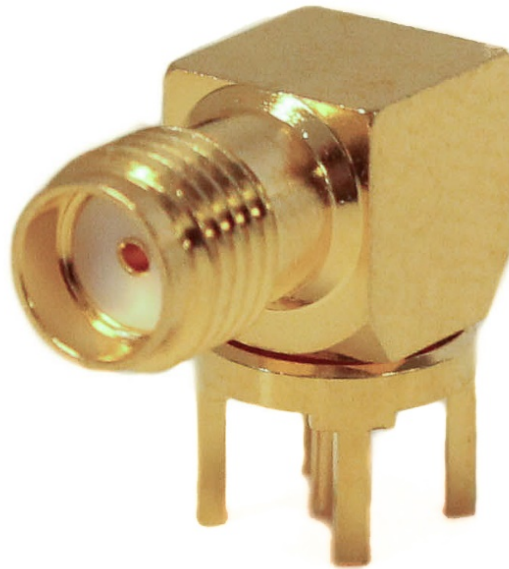
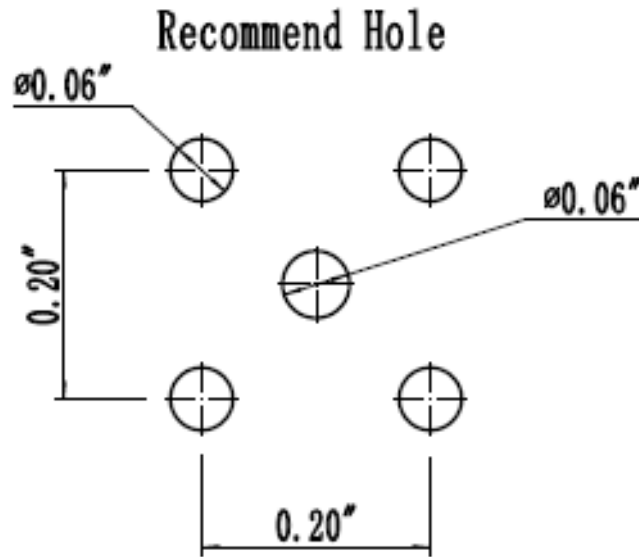

(Dimensions in Inches)

- Impedance: 50 Ohms
- Frequency Range: 0-18G
- Working Voltage: 335V at Sea Level
- Dielectric Withstanding Voltage: 1000V min at sea level
- Contact resistance: <3 milliohms
- Mating Torque: 7-10 Inch Pounds
- Material:
  - Body – 1U" Gold plated Brass
  - Contact – 3U" Gold plated Beryllium Copper
  - Insulator – Teflon
- Meets or Exceeds the applicable paragraph of MIL-C-39012
- Operating Temperature:  $-65^{\circ}\text{C}$  ( $-85^{\circ}\text{F}$ ) to  $150^{\circ}\text{C}$  ( $302^{\circ}\text{F}$ )
- RoHS 3 Compliant