

SIDE VIEW

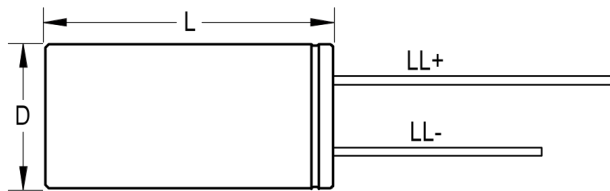

TERMINAL END VIEW

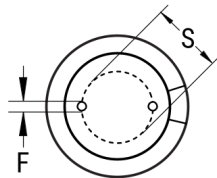

Click [here](#) for the 3D model.

| Dimensions  |                |
|-------------|----------------|
| D           | 16mm +/-0.5mm  |
| L           | 25mm +2mm      |
| S           | 7.5mm +/-0.5mm |
| LL Negative | 15mm MIN       |
| LL Positive | 20mm MIN       |
| F           | 0.8mm NOM      |

| Packaging Specifications |           |
|--------------------------|-----------|
| Packaging                | Bulk, Bag |
| Packaging Quantity       | 1000      |

| General Information |                                     |
|---------------------|-------------------------------------|
| Series              | ESK                                 |
| Dielectric          | Aluminum Electrolytic               |
| Description         | Single Ended, Aluminum Electrolytic |
| RoHS                | Yes                                 |
| Lead                | Wire Leads                          |
| AEC-Q200            | No                                  |

| Specifications          |                        |
|-------------------------|------------------------|
| Capacitance             | 1,000 uF               |
| Capacitance Tolerance   | 20%                    |
| Voltage DC              | 63 VDC, 79 VDC (Surge) |
| Temperature Range       | -40/+85°C              |
| Rated Temperature       | 85°C                   |
| Life                    | 2000 Hrs               |
| Dissipation Factor      | 10% 120Hz 20C          |
| Ripple Current          | 1310 mAmps (120Hz 85C) |
| Leakage Current         | 630 uA (2min 20°C)     |
| Impedance Ratio at -25C | 3                      |
| Impedance Ratio at -40C | 3                      |