

PANEL CUTOUT

PANEL THICKNESS	X
0.75-1.25	19.20
1.25-2.0	19.40
2.00-3.00	19.60

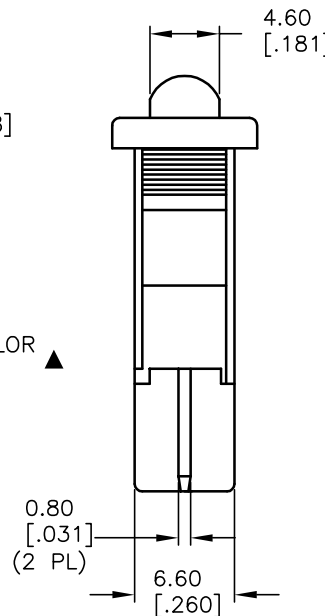
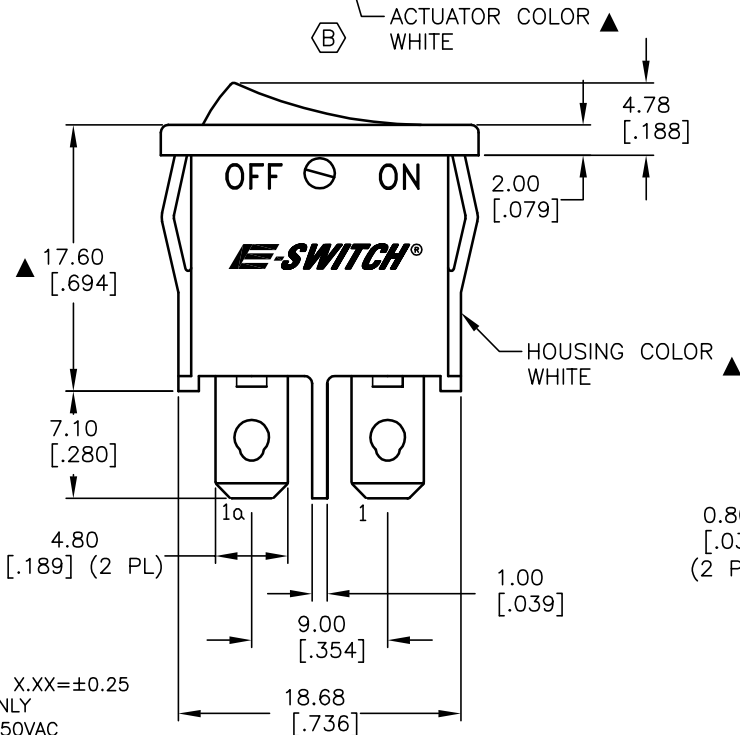
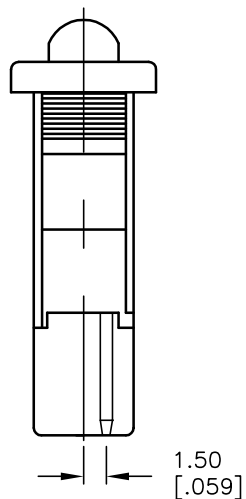

SWITCH FUNCTION	
POS. 1	POS. 2
ON	OFF
1-1a	OPEN

CONTACT CONFIGURATION

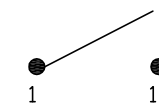

CIRCUIT: SPST

NOTES:

- ALL DIMENSIONS IN MM
- GENERAL TOLERANCE: X.X=±0.4; X.XX=±0.25
- TERMINAL NUMBERS FOR REF ONLY
- RATING: 4(1)A @250VAC, 6A @250VAC
10A @125VAC
- MATERIALS: TERMINALS: COPPER ALLOY W/SILVER PLATING
CONTACTS: COIN SILVER
- MECHANICAL LIFE: >50,000 CYCLES
- ELECTRICAL LIFE: >10,000 CYCLES
- CONTACT RESISTANCE: < 20 MEGA-OHMS (INITIAL)
- INSULATION RESISTANCE: > 1000 MEGA-OHMS @ 500VDC
- DIELECTRIC STRENGTH: >1500VAC 1 MINUTE (INITIAL)
>3000V BETWEEN POLES
- ▲ DENOTES CRITICAL PARAMETER.

E-SWITCH®

B	14372	WORDING OF COLOR NOTE	10/4/04	AR
A	14316	RELEASED FOR PRODUCTION	9/15/04	AR
REV.	ECN No.	DESCRIPTION	DATE	CHKD

TITLE				
R6AWHTWHTFF				
SCALE	DATE	DR	DWG	REV
2:1	9/15/04	AR	M060315	B

THE INFORMATION CONTAINED IN THIS DOCUMENT IS PROPRIETARY TO E-SWITCH AND IS NOT TO BE COPIED OR TRANSFERRED