

| DASH NO | CABLES ACCOMMODATED | A DIM | B DIM | C FLATS | D FLATS | E DIA | ASSEMBLE PER |
|---------|--|-------|-------|---------|---------|-------|--------------|
| -7 | TRC-50-2 TRC-75-2 | 1.135 | .096 | .438 | .438 | .500 | TAI-189 |
| -8 | 8227, BELDEN | 1.716 | .130 | .625 | .688 | .750 | TAI-103 |
| -9 | TWC-78-2 TWC-124-2 | 1.135 | .096 | .438 | .438 | .500 | TAI-102 |
| -A9 | BL782, TIMES BL982, TIMES BL1242, TIMES | | | | | | |
| -10 | RG-22 754E, AT&T | | | | | | |
| -11 | 760A, AT&T | 1.716 | .130 | .625 | .688 | .750 | TAI-103 |
| -12 | 16 PEVL, AT&T V1-AL, GENERAL | | | | | | TAI-128 |
| -13 | TRF-59, TIMES | | | | | | TAI-129 |
| -13A | 8232, BELDEN | | | | | | TAI-165 |
| -14 | 8233, BELDEN | | | | | | TAI-129 |
| -23 | 250-3884, MICRODOT | | | | | | TAI-189 |
| -24 | 202-3934, MICRODOT | | | | | | TAI-102 |
| -24A | 9530A5117, RAYCHEM | | | | | | TAI-189 |
| -25 | T-43M, GENERAL | | | | | | TAI-102 |
| -25A | 5021H5331, RAYCHEM | | | | | | TAI-189 |
| -26 | 7028A5518, RAYCHEM | 1.135 | .096 | .438 | .438 | .500 | TAI-102 |
| -27 | T19TPSJ2619EN, WOVEN 202-3927, MICRODOT 202-3942, MICRODOT | | | | | | |
| -29 | TWC-78-1/TWC-124-1A | | | | | | |
| -30 | 761A, AT&T 8441, BELDEN | | | | | | |
| -32 | TRC-50-1 | | | | | | |
| -33 | TRC-75-1 | | | | | | |
| -42 | 21-204, ESSEX 4463, CONSOLIDATED | | | | | | TAI-189 |
| -43 | 250-4044/250-4045 293-3930, MICRODOT | | | | | | |
| -45 | M27500-22TE2T14 1100-66F, STANDARD | | | | | | TAI-102 |
| -46 | 9860, BELDEN | | | | | | 1.716 |
| -47 | M17/176-00002 | 1.135 | .096 | .438 | .438 | .500 | TAI-102 |
| -49 | TWAC-78-1F2 | | | | | | |
| -54 | 89207, BELDEN | 1.716 | .130 | .625 | .688 | .750 | TAI-189 |
| -55 | 89272, BELDEN | | | | | | |
| -56 | GC875GC1, GRUMMAN | | | | | | |
| -57 | GC875GB1, GRUMMAN | | | | | | |
| -58 | GC875TM24H, GRUMMAN | | | | | | |
| -59 | GC875LN1, GRUMMAN | | | | | | |
| -60 | M17/177, THERMATICS 380-10045, BOEING | | | | | | |
| -64 | 7528A5314, RAYCHEM | | | | | | |

DATA CONTAINED IN THIS DOCUMENT IS PROPRIETARY TO TROMPETER ELECTRONICS INC. AND SHALL NOT BE DISCLOSED, COPIED OR USED FOR PROCUREMENT OR MANUFACTURE WITHOUT EXPRESS WRITTEN PERMISSION OF TROMPETER ELECTRONICS INC.

| REVISIONS | | 310-0025 | SH 1 |
|-----------|-----------------------|----------|----------|
| REV | DESCRIPTION | DATE | APPROVED |
| U | REVISED PER ECD 14778 | 11-5-02 | RAM |

| CABLE ENTRY | | | |
|-------------|------|---------|------|
| DASH NO | DIA | DASH NO | DIA |
| -7 | .274 | -29 | .191 |
| -8 | .345 | -30 | .235 |
| -9 | .285 | -32 | .191 |
| -A9 | .285 | -33 | .217 |
| -10 | .455 | -42 | .300 |
| -11 | .347 | -43 | .200 |
| -12 | .485 | -45 | .183 |
| -13 | .362 | -46 | .475 |
| -13A | .352 | -47 | .164 |
| -14 | .490 | -49 | .132 |
| -23 | .183 | -54 | .323 |
| -24 | .191 | -55 | .250 |
| -24A | .200 | -56 | .191 |
| -25 | .285 | -57 | .191 |
| -25A | .285 | -58 | .198 |
| -26 | .191 | -59 | .198 |
| -27 | .145 | -60 | .217 |
| | | -64 | .183 |

FIG 1 Δ
-9 SHOWN

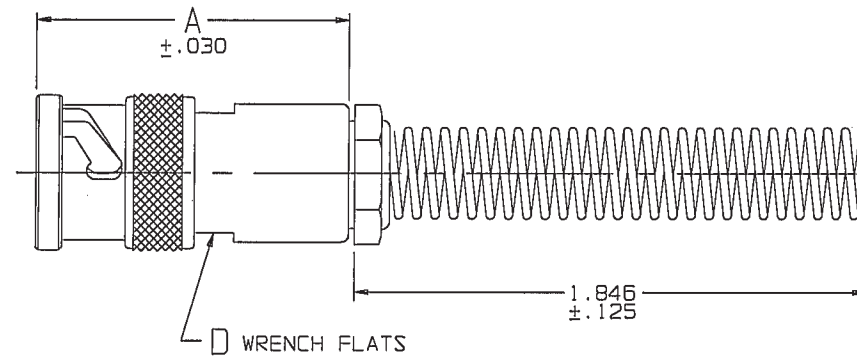
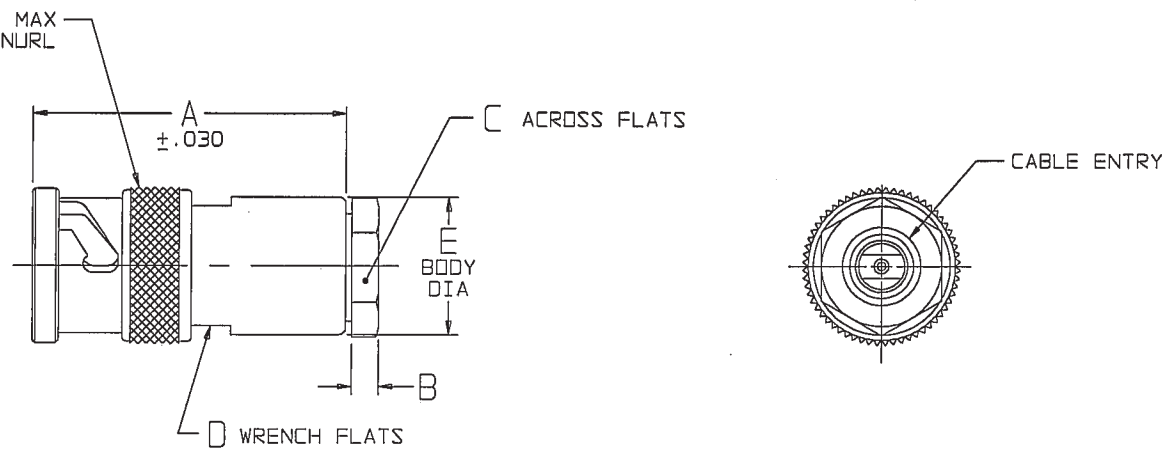

FIG 2
-9 SHOWN



RED INDICATES ORIGINAL

6. EXAMPLE OF A COMPLETE MODEL NO.

PL74 -47 Δ

BASIC MODEL NO. DASH NO.

Δ IF BEND RELIEF SPRING REQD (SEE FIG 1)
ADD SUFFIX "BR" TO MODEL NO
(NOT AVAILABLE WITH CABLE GROUPS -8, -10, -11,
-12, -13, -13A, -14, -46 & -54)

Δ CLAMP NUT OMITTED

Δ 2-LUG BAYONET CONCENTRIC TWINAX/TRIAX TRB CABLE PLUG

2. FINISH: TFS-1A (NICKEL)

1. ALL DIM ARE IN INCHES

| TYPE Δ | DASH NO/CABLE GROUP | | | | | | | | | | | | | | | | |
|---------------|---------------------|-----|------|-----|-----|------|------|-----|-----|-----|-----|-----|-----|-----|-----|-----|-----|
| TWINAX | -8 | -9 | -A9 | -10 | -11 | -12 | -24 | -25 | -27 | -29 | -30 | -45 | -46 | -47 | -49 | -54 | -55 |
| TRIAx | -7 | -13 | -13A | -14 | -23 | -24A | -25A | -26 | -32 | -33 | -42 | -43 | -56 | -57 | -59 | -60 | -64 |
| QUADRAx | -58 | | | | | | | | | | | | | | | | |

INTERPRET DRAWING PER MIL-STD-100
DIMENSIONS ARE IN INCHES
AND INCLUDE FINISH THICKNESS
UNLESS OTHERWISE SPECIFIED

DRAWN AAH DATE 11-4-02
CHECKED [Signature] DATE 11-5-02
QUALITY [Signature] DATE 11-5-02
HANDLE [Signature] DATE 11/5/02
APPROVED [Signature] DATE 11/4/02

TOL: UNLESS SPECIFIED
.XX
.XXX ±.005
.XXXX
ANGLES

TROMPETER
RF connectivity
a cinch connectivity solutions brand

TITLE: PL74/PL74BR
SIZE CAGE CODE DRAWING NO. REV.
B 14949 310-0025 U
SCALE NONE DATE: 3/27/78 SHEET 1C

305-0515
NEXT ASSY

CAD FILE NO. 310-0025U
DO NOT SCALE DWG