

PART NO. 92301-0107  
 DWG. NO. SD-92301-159

CIRCUIT IDENTIFICATION

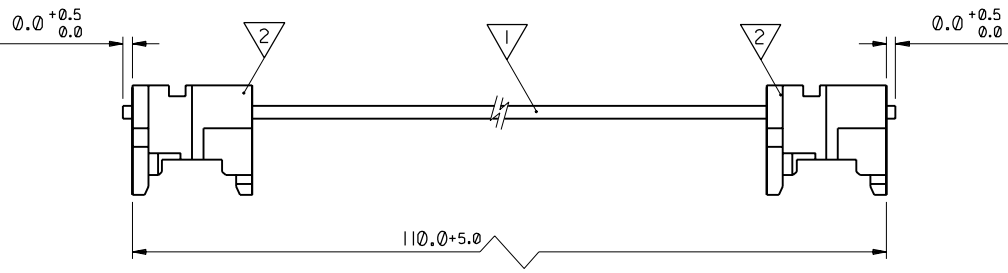
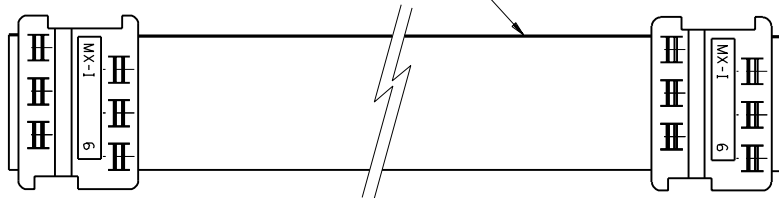

ITEM	COMPONENT	DESCRIPTION	QTY	NOTE
1	99026-0028	6 CCT 28 AWG STRANDED TINNED RIBBON CABLE	1	3, 4
2	90327-0357	PICOFLEX FEMALE IDT CONNECTOR	2	1, 2, 4

NOTES:

1. SEE PRODUCT SPECIFICATIONS PS-99020-0011.
2. SEE TERMINATION SPECIFICATION ES-99033-0001.
3. SEE CABLE SPECIFICATION ES-99027-0006.
4. HARNESSES TO BE 100% ELECTRICALLY TESTED.

CUSTOMER P/N: 4352-016

CHANGE LENGTH  
 EC NO. E2000-014  
 DRWN:DMCN 99/0824  
 CHK: / / /  
 APPR: / / /  
 A3

QUALITY SYMBOLS  
 MAJOR =  
 CRITICAL =  
 C =

GENERAL TOLERANCES:  
 (UNLESS SPECIFIED)

	mm	INCH
4 PLACES	±0.	±.
3 PLACES	±0.	±.
2 PLACES	±0.	±.
1 PLACE	±0.	±.

ANGULAR: ± 1/2°

DRAFT WHERE APPLICABLE MUST  
 REMAIN WITHIN DIMENSIONS

SCALE  
 4 : 1

DESIGN UNITS  
 mm  INCH

THIRD ANGLE  
 PROJECTION

DRAWN BY & DATE  
 D.RYAN 99/03/05

CHECKED BY & DATE  
 J.HORGAN 99/03/05

APPROVED BY & DATE  
 MWILHITE 99/03/05

CAD FILENAME  
 s2301107.DGN

DIMENSIONS:		SHT	REV
<input type="checkbox"/> mm	<input type="checkbox"/> INCH		
<input checked="" type="checkbox"/> mm	<input type="checkbox"/> INCH		
TITLE: 6 CCT RIBBON CABLE HARNESS			
MATERIAL NO. 92301-0107		DRAWING NO. SD-92301-159	SHEET NO. 1 OF 1
THIS DRAWING CONTAINS INFORMATION THAT IS PROPRIETARY TO MOLEX INCORPORATED AND SHOULD NOT BE USED WITHOUT WRITTEN PERMISSION.			