

THIS DRAWING IS UNPUBLISHED. RELEASED FOR PUBLICATION
 © COPYRIGHT - By - ALL RIGHTS RESERVED.

REVISIONS					
P	LTR	DESCRIPTION	DATE	DWN	APVD
	AH19	DWG CLARITY AND REMOVAL OF 2-62935-0	30MAY2019	SV	PKS

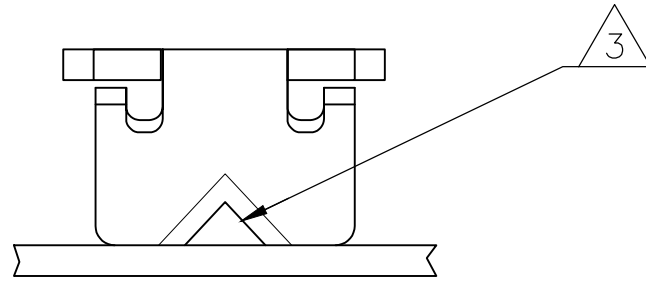

- 1 CONTINUOUS STRIP ON REELS WITH TERMINALS LOCATED ON 5.59±0.08 [.220±.003] CENTERS.
- 2 SLOT ACCEPTS EITHER A SINGLE OR DOUBLE MAGNET WIRE OF THE SAME SIZE AND TYPE.
COPPER RANGE 0.36-0.57mm [#27-#23 AWG].
ALUMINUM RANGE 0.51-0.64mm [#24-#22 AWG]
ALUMINUM WIRE RANGE IS APPLICABLE FOR POST TIN PLATED PART NUMBERS ONLY
- 3 POKE-IN ACCEPTS A 0.50-0.90mm² [#20-#18] AWG SOLID OR FUSED STRANDED LEAD WIRE.
- 4 SPECIAL REEL QUANTITY - SPAIN PRODUCTION ONLY.
- 5 PRELIMINARY - NOT FOR PRODUCTION.
- 6 NON-US PRODUCTION ONLY.
- 7 PREPRODUCTION - FASR REQUIRED.

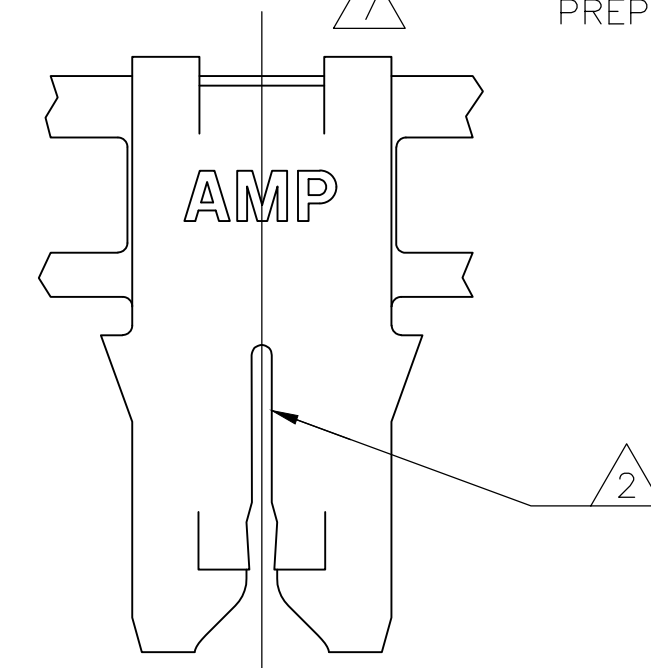
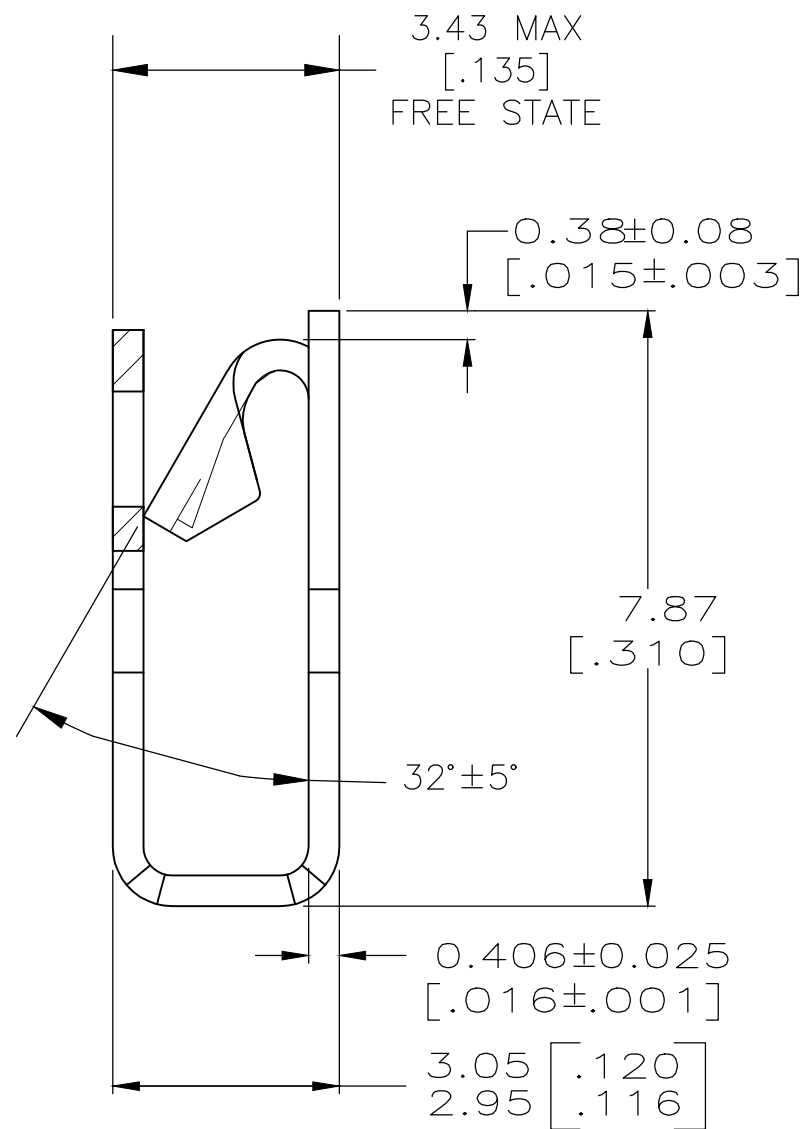
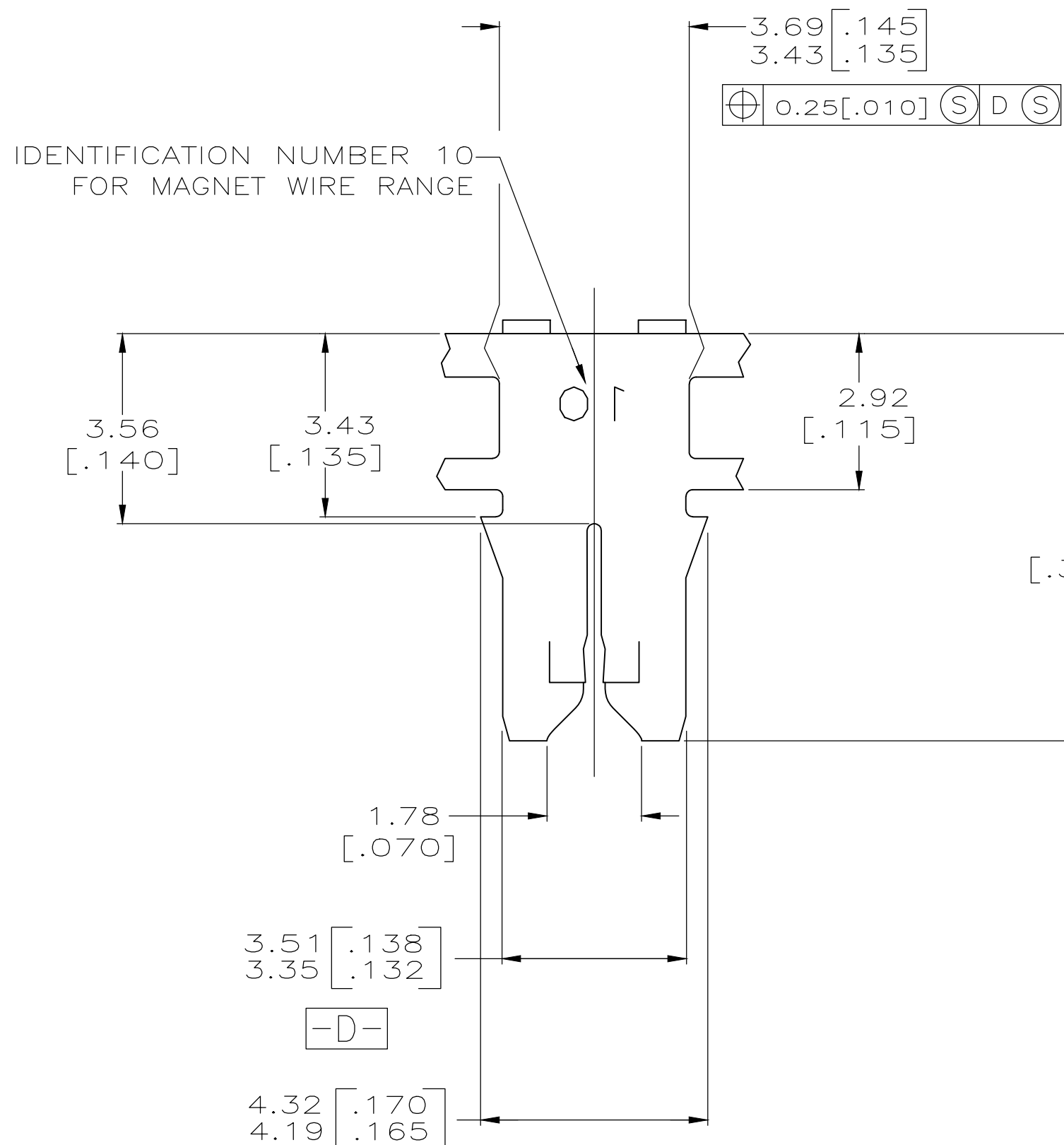

	STANDARD	PAPER SPLICE	WITH PAPER	TIN PLATED	BRASS	1-62935-2
	STANDARD	PAPER SPLICE	WITHOUT PAPER	TIN PLATED	CuNiSi	62935-9
	STANDARD	PAPER SPLICE	WITHOUT PAPER	TIN PLATED	BRASS	62935-8
	STANDARD	SPLICE FREE	WITH PAPER	TIN PLATED	BRASS	62935-7
	REVERSE	WELD SPLICE	WITHOUT PAPER	TIN PLATED	BRASS	62935-6
OBSOLETE	STANDARD	WELD SPLICE	WITHOUT PAPER	TIN PLATED	BRASS	62935-5
OBSOLETE	STANDARD	SPLICE FREE	PLASTIC REEL W/O PAPER	TIN PLATED	BRASS	62935-4
	STANDARD	WELD SPLICE	WITH PAPER	TIN PLATED	BRASS	62935-3
	STANDARD	WELD SPLICE	PLASTIC REEL W/ PAPER	NONE	BRASS	62935-2
	STANDARD	WELD SPLICE	WITHOUT PAPER	TIN PLATED	BRASS	62935-1
REELING DIRECTION	SPLICE		REELING	FINISH	MATERIAL	PART NUMBER

THIS DRAWING IS A CONTROLLED DOCUMENT.

DIMENSIONS: INCHES

TOLERANCES UNLESS OTHERWISE SPECIFIED:

0 PLC	±	-
1 PLC	±	-
2 PLC	±	0.25 [.010]
3 PLC	±	-
4 PLC	±	-
ANGLES	±	-

MATERIAL: SEE TABLE

FINISH: SEE TABLE

THIS DRAWING IS A CONTROLLED DOCUMENT.

DWN: MICHAEL S. FEHER 15MAR2004

CHK: KURT A. RANDOLPH 15MAR2004

APVD: KURT A. RANDOLPH 15MAR2004

NAME: KURT A. RANDOLPH

PRODUCT SPEC: 108-2012

APPLICATION SPEC: 114-2046

WEIGHT: 0

CUSTOMER DRAWING

SCALE: 10:1

SHEET: 1 OF 1

REV: AH19

TE Connectivity

TERMINAL, POKE-IN, 300 SERIES MAG-MATE

SIZE: A2

CAGE CODE: 00779

DRAWING NO: C-62935

RESTRICTED TO: -