

Rev	AWO #	Description	Date	Appr
-		RELEASED	4/22/14	

APPROVED: _____
 DATE: _____ TITLE: _____

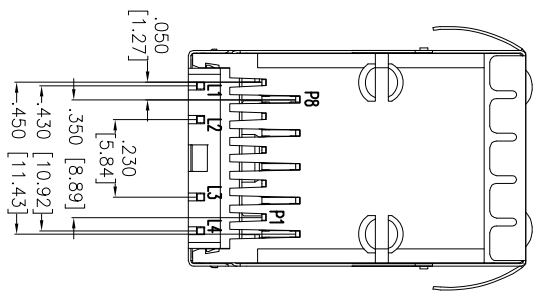
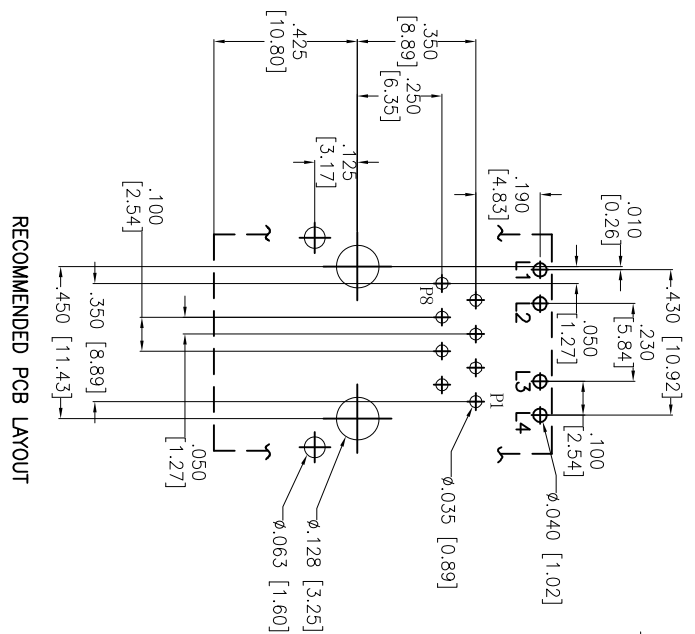
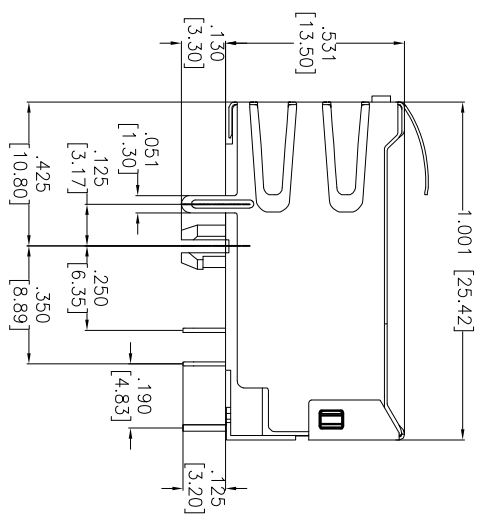
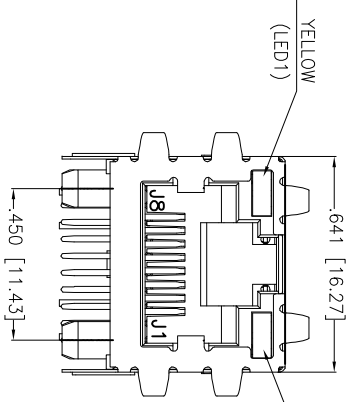

Yellow	(LED1)	Green	(LED2)												
L1	L2	L3	L4												
<table border="1"> <thead> <tr> <th>Emitting Color</th> <th>I_p (mA)</th> <th>V_f@I_f=20mA</th> <th>I_r @V_r=5V</th> </tr> </thead> <tbody> <tr> <td>Green</td> <td>565</td> <td>1.7V~2.6V</td> <td>10µA max.</td> </tr> <tr> <td>Yellow</td> <td>585</td> <td>1.7V~2.6V</td> <td>10µA max.</td> </tr> </tbody> </table>				Emitting Color	I _p (mA)	V _f @I _f =20mA	I _r @V _r =5V	Green	565	1.7V~2.6V	10µA max.	Yellow	585	1.7V~2.6V	10µA max.
Emitting Color	I _p (mA)	V _f @I _f =20mA	I _r @V _r =5V												
Green	565	1.7V~2.6V	10µA max.												
Yellow	585	1.7V~2.6V	10µA max.												

X	PLATING
0	15 µin Gold
1	30 µin Gold
2	50 µin Gold

SPECIFICATIONS:
 Material: Thermoplastic, rated UL 94V-0
 Insulator color: Black
 Contacts: Phosphor Bronze
 Shield: Stainless, pre-soldering
 Contact Plating: Gold Flash over Nickel underplate on contact area, Tin over Copper underplate on tails
 (See chart for thickness).
 Electrical:
 Insulation resistance: 500 Mohms min
 Dielectric withstanding voltage: 1000 VAC for 1 minute
 Temperature Rating:
 Operating temperature: 0°C to +70°C
 Environmental:
 Lead free, RoHS compliant.

UNLESS OTHERWISE SPECIFIED
 ALL DIMENSIONS ARE INCHES [MM]
 TOLERANCES: EXCEPT AS NOTED
 INCHES
 .X ±.10 Ø.X ±.10
 .XX ±.020 Ø.XXX ±.015
 .XXX ±.015 Ø.XXXX ±.010
 APPROVALS

ADAM TECH
 909 Ratway Avenue, Union, NJ 07083
 Phone: 908-687-5000 Fax: 908-687-5710

TITLE: MODULAR JACK GANGED 1 PORT, 8P8C
 W/ LED1 YELLOW & LED2 GREEN

DRAWN	AY	4/22/14
CHECKED	NP	4/22/14
APPROVED		

SIZE	PART NO.	REV.
X	MTJ-885X1-FSP-PG-LG-MTY	
REF:	S00J01C	SCALE: NTS
		SHEET 1 OF 2



6

5

4

3

2

1

Rev	AWO #	Description	Date	Appr
		SEE SHT 1 OF 2 FOR REVISION		

APPROVED: _____

DATE: _____ TITLE: _____

D

C

B

A

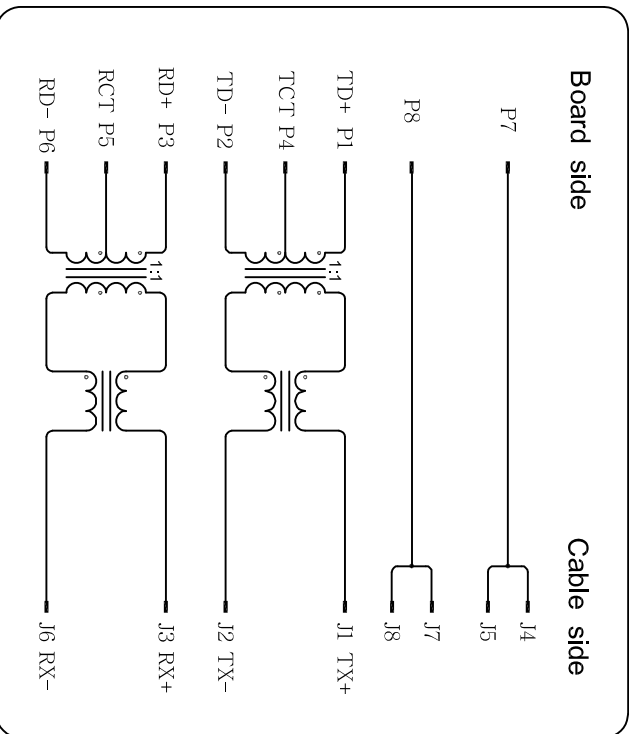

ELECTRICAL CHARACTERISTICS :

1. INSERTION LOSS :
 - 1~100 MHZ -1.0dB MAX.
2. RETURN LOSS(LOAD 100Ω) :
 - 1~30 MHZ -18dB MIN
 - 30~60 MHZ -16dB MIN
 - 60~80 MHZ -12dB MIN
3. COMMON MODE REJECTION
 - 1~100 MHZ -30dB MIN
4. CROSS TALK
 - 1~100 MHZ -30dB MIN
5. INDUCTANCE @ 100KHZ, 0.1V, 8mA DC BIAS
 - (P1-P2),(P3-P6) : 350 uH MIN
6. HI-POT TEST
 - PCB SIDE TO CABLE SIDE : 1500VAC 60S OR 2250VDC 60S
7. TURNS RATION 100KHZ
 - (P1-P2) : (J1-J2) = 1:1 ±%5
 - (P3-P6) : (J3-J6) = 1:1 ±%5

ADAM TECH

909 Rahway Avenue, Union, NJ 07083
Phone: 908-687-5000 Fax: 908-687-5710

TITLE: MODULAR JACK GANGED, 2 PORT, 8P8C
W/ LED1 YELLOW & LED2 GREEN

UNLESS OTHERWISE SPECIFIED ALL DIMENSIONS ARE INCHES [MM]		TOLERANCES: EXCEPT AS NOTED	
.X INCHES	± .10	Ø.X HOLES	± .10
.XX	± .020	Ø.XXX	± .015
.XXX	± .015	Ø.XXXX	± .010
APPROVALS		DATE	
DRAWN	AY		4/22/14
CHECKED	YC		4/22/14
APPROVED			
SIZE	PART NO.	REV.	
X	MTJ-88SX1-FSP-PG-LG-M7Y	-	
REF:	SUM/01C	SCALE:	NTS
		SHEET	2 OF 2

6

5

4

3

2

1