

REVISIONS				
REV	ECO	DESCRIPTION	DATE	BY APPR
A1	-	RELEASED DRAWING	Nov-9-17	Rookie Tommy
A2	-	ADD THE GS PART NUMBER	Jan-28-19	Blink Tommy
A3	-	CHANGE HAND CRIMPER	Nov-8-19	Flan Tommy

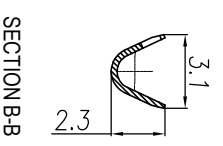
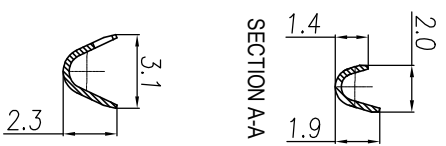
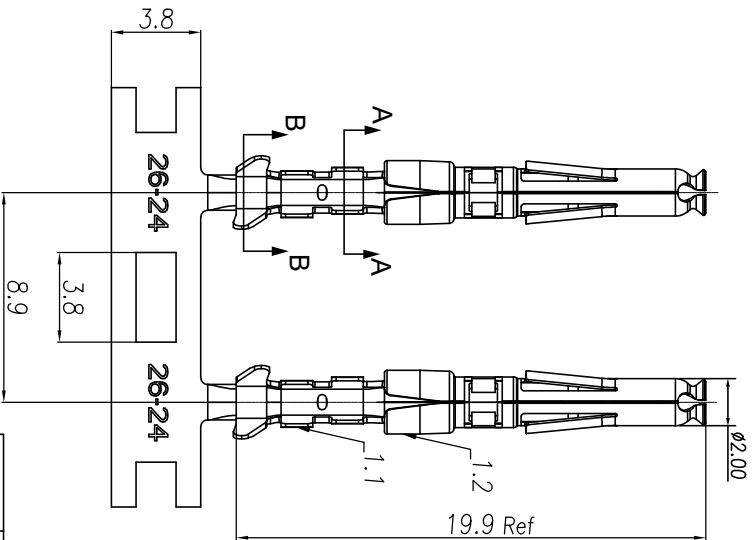
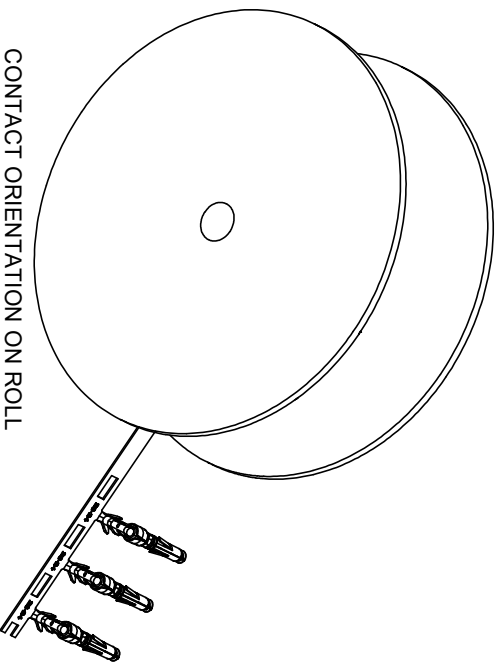

- CONTACT ORIENTATION ON ROLL
 NOTES: (UNLESS OTHERWISE SPECIFIED)
- MATERIAL:
 - CONTACT BODY: COPPER ALLOY.
 - OUTER SPRING: STAINLESS STEEL.
 - SPECIFICATIONS:
 - CURRENT RATING: 5A MAX.
 - TERMINATION TYPE: CRIMPING.
 - WIRE RANGE: 26~24AWG.
 - WIRE INSULATION DIA(MAX): $\varnothing 2.2\text{mm}$.
 - ROHS COMPLIANT.
 - ALL DIMENSIONS ARE FOR REFERENCE USE ONLY.
 - AVAILABLE TOOLS:
 - HAND CRIMPER: MFX-3958. A3
 - CRIMP APPLICATOR: MFX-3957.
 - EXTRACTION TOOL: QXRT20.

P/N	CONTACT PLATING(MATING AREA)
SS24W2T	TIN PLATING OVER NICKEL.
SS24W2N	NICKEL PLATING OVER COPPERIZE.
SS24W2F	GOLD FLASH PLATING OVER NICKEL.
SS24W2G5	5 μ " GOLD PLATING OVER NICKEL.
SS24W2G10	10 μ " GOLD PLATING OVER NICKEL.
SS24W2G15	15 μ " GOLD PLATING OVER NICKEL.
SS24W2G30	30 μ " GOLD PLATING OVER NICKEL.

QUANTITY	PART NUMBER	DESCRIPTION	ITEM
		MATERIALS LIST	
<p>UNLESS OTHERWISE SPECIFIED 1) All dimensions are in millimeters. 2) Tolerances are as follows: 1 Pt. DEC 40-30 Fractions 1/16 3 Pt. DEC 20-08 Angles 30° 3) Note reference = △</p>			
SIGNATURES		DATE	
DRAWN: Ril	CHECKED: Mih	Nov-8-19	
ENGINEER: Tommy	APPROVE: Tommy	Nov-8-19	
MATERIAL SPECIFICATIONS		CUSTOMER: Nov-8-19	
PROCESS SPECIFICATIONS		<p>THE DRAWING IS SUBJECT TO THE SPECIFICATIONS AND PERFORMANCE DATA OF THE MANUFACTURER'S CATALOG. THE MANUFACTURER'S CATALOG IS THE REFERENCE FOR ALL DIMENSIONS AND TOLERANCES. REPRODUCTION AND REVISIONS ARE THE PROPERTY OF THE MANUFACTURER. ALL DIMENSIONS ARE IN MILLIMETERS UNLESS OTHERWISE SPECIFIED.</p>	
NEXT ASBY:		SCALE: NONE	
ECO-MATE SOCKET CONTACT, STAMPED, 24-26AWG, SIZE 20		REVISION: A3	

Amphenol
 Sine Systems - www.amphenol-sine.com
 44724 Montey Drive
 Clinton Township, MI 48038