



# WLD4FP-1G3121A0ZZZ

W4F

MINIATURE PHOTOELECTRIC SENSORS

**SICK**  
Sensor Intelligence.



Illustration may differ



## Ordering information

| Type               | Part no. |
|--------------------|----------|
| WLD4FP-1G3121A0ZZZ | 1121469  |

Other models and accessories → [www.sick.com/W4F](http://www.sick.com/W4F)

## Detailed technical data

### Features

|   |   |
|---|---|
| <b>Functional principle</b>   | Photoelectric retro-reflective sensor                 |
| <b>Functional principle detail</b>  | With minimum distance to reflector (dual lens system) |
| <b>Sensing range</b>  |   |
| Sensing range min.  | 0 m   |
| Sensing range max.  | 4.5 m   |
| Maximum distance range from reflector to sensor (operating reserve 1)                           | 0.015 m ... 4.5 m                                     |
| Recommended distance range from reflector to sensor (operating reserve 3,75)                    | 0.035 m ... 3.9 m                                     |
| Reference reflector   | Reflector P250  |
| Recommended sensing range for the best performance  | 0.035 m ... 3.9 m                                     |
| <b>Polarisation filters</b>   | Yes   |
| <b>Emitted beam</b>   |   |
| Light source  | PinPoint LED  |
| Type of light   | Visible red light                                     |
| Shape of light spot   | Point-shaped  |
| Light spot size (distance)  | Ø 38 mm (1,000 mm)                                    |
| Maximum dispersion of the emitted beam around the standardized transmission axis (squint angle) | < +/- 1.5° (at Ta = +23 °C)                           |
| <b>Key LED figures</b>  |   |

|                        |   |  |
|------------------------|---|--|
| Normative reference    | EN 62471:2008-09   IEC 62471:2006, modified |  |
| LED risk group marking | Free group                                  |  |
| Wave length            | 635 nm                                      |  |
| Average service life   | 100,000 h at $T_a = +25\text{ °C}$          |  |
| <b>Adjustment</b>      | None  | -  |
| <b>Indication</b>      | LED green                                   | Operating indicator<br>Static on: power on   |
|                        | LED yellow                                  | Status of received light beam<br>Static on: object not present<br>Static off: object present<br>Flashing: Below the 1.5 function reserve |

### Safety-related parameters

|                                     |  |
|-------------------------------------|--|
| <b>MTTF<sub>D</sub></b>             | 1,390 years                                  |
| <b>DC<sub>avg</sub></b>             | 0 %  |
| <b>T<sub>M</sub> (mission time)</b> | 20 years (EN ISO 13849)<br>Rate of use: 60 % |

### Electrical data

|                                     |  |  |
|-------------------------------------|--|--|
| <b>Supply voltage U<sub>B</sub></b> | 10 V DC ... 30 V DC <sup>1)</sup>                                      |  |
| <b>Ripple</b>                       | ≤ 5 V <sub>pp</sub>  |  |
| <b>Usage category</b>               | DC-12 (According to EN 60947-5-2)<br>DC-13 (According to EN 60947-5-2) |  |
| <b>Current consumption</b>          | ≤ 20 mA, without load. At U <sub>B</sub> = 24 V                        |  |
| <b>Protection class</b>             | III  |  |
| <b>Digital output</b>               | Number   | 1  |
|                                     | Type   | Push-pull: PNP/NPN   |
|                                     | Signal voltage PNP HIGH/LOW  | Approx. U <sub>B</sub> -2.5 V / 0 V  |
|                                     | Signal voltage NPN HIGH/LOW  | Approx. U <sub>B</sub> / < 2.5 V   |
|                                     | Output current I <sub>max.</sub>                                       | ≤ 100 mA   |
|                                     | Circuit protection outputs   | Reverse polarity protected<br>Overcurrent protected<br>Short-circuit protected |
|                                     | Response time  | ≤ 500 μs   |
|                                     | Repeatability (response time)  | 150 μs <sup>2)</sup>   |
|                                     | Switching frequency  | 1,000 Hz <sup>3)</sup>   |
| <b>Pin/Wire assignment</b>          | Function of pin 4/black (BK)   | Digital output, light switching, object present → output Q LOW                 |

<sup>1)</sup> Limit values.

<sup>2)</sup> Signal transit time with resistive load in switching mode.

<sup>3)</sup> With light/dark ratio 1:1.

### Mechanical data

|                |             |
|----------------|-------------|
| <b>Housing</b> | Rectangular |
|----------------|-------------|

|   |                           |
|---|---------------------------|
| <b>Dimensions (W x H x D)</b>                         | 16 mm x 40.1 mm x 12.1 mm |
| <b>Connection</b>                                     | Cable, 3-wire, 2 m        |
| <b>Connection detail</b>                              |                           |
| Deep-freeze property                                  | Do not bend below 0 °C    |
| Conductor size  | 0.14 mm <sup>2</sup>      |
| Cable diameter  | Ø 3.4 mm                  |
| Length of cable (L)                                   | 2 m                       |
| <b>Material</b>                                       |                           |
| Housing   | Plastic, VISTAL®          |
| Front screen  | Plastic, PMMA             |
| Cable   | PVC                       |
| <b>Weight</b>   | Approx. 30 g              |
| <b>Maximum tightening torque of the fixing screws</b> | 0.4 Nm                    |

Ambient data

|  |   |
|--|---|
| <b>Enclosure rating</b>                    | IP66 (EN 60529)<br>IP67 (EN 60529)<br>IP69 (EN 60529)   |
| <b>Ambient operating temperature</b>       | -40 °C ... +60 °C   |
| <b>Ambient temperature, storage</b>        | -40 °C ... +75 °C   |
| <b>Typ. Ambient light immunity</b>         | Artificial light: ≤ 50,000 lx<br>Sunlight: ≤ 50,000 lx  |
| <b>Shock resistance</b>                    | 30 g, 11 ms (3 positive and 3 negative shocks along X, Y, Z axes, 18 total shocks (EN60068-2-27)) |
| <b>Vibration resistance</b>                | 10 Hz ... 1,000 Hz (Amplitude 1 mm, 3 x 30 min (EN60068-2-6))                                     |
| <b>Air humidity</b>                        | 35 % ... 95 %, Relative humidity (no condensation)  |
| <b>Electromagnetic compatibility (EMC)</b> | EN 60947-5-2  |
| <b>Resistance to cleaning agent</b>        | ECOLAB  |
| <b>UL File No.</b>                         | NRKH.E181493 & NRKH7.E181493  |

Classifications

|                     |          |
|---------------------|----------|
| <b>eCl@ss 5.0</b>   | 27270902 |
| <b>eCl@ss 5.1.4</b> | 27270902 |
| <b>eCl@ss 6.0</b>   | 27270902 |
| <b>eCl@ss 6.2</b>   | 27270902 |
| <b>eCl@ss 7.0</b>   | 27270902 |
| <b>eCl@ss 8.0</b>   | 27270902 |
| <b>eCl@ss 8.1</b>   | 27270902 |
| <b>eCl@ss 9.0</b>   | 27270902 |
| <b>eCl@ss 10.0</b>  | 27270902 |
| <b>eCl@ss 11.0</b>  | 27270902 |
| <b>eCl@ss 12.0</b>  | 27270904 |
| <b>ETIM 5.0</b>     | EC002717 |
| <b>ETIM 6.0</b>     | EC002717 |

|                       |          |
|-----------------------|----------|
| <b>ETIM 7.0</b>       | EC002717 |
| <b>ETIM 8.0</b>       | EC002717 |
| <b>UNSPSC 16.0901</b> | 39121528 |

### Connection type

Cable, 3-wire

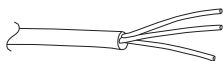

### Connection diagram

Cd-043

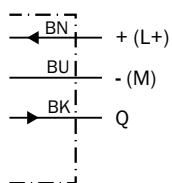

### Truth table

Push-pull: PNP/NPN - light switching Q

|                         | Light switching Q (normally closed (upper switch), normally open (lower switch)) |                             |
|-------------------------|--|-----------------------------|
|                         | Object not present → Output HIGH   | Object present → Output LOW |
| Light receive           | ✓  | ✗                           |
| Light receive indicator | ☉  | ✗                           |
| Load resistance to L+   | ✗  | ⚠                           |
| Load resistance to M    | ⚠  | ✗                           |
|                         |  |                             |

Push-pull: PNP/NPN – dark switching  $\bar{Q}$

|                         | Dark switching $\bar{Q}$ (normally open (upper switch), normally closed (lower switch)) |                              |
|-------------------------|---|------------------------------|
|                         | Object not present → Output LOW   | Object present → Output HIGH |
| Light receive           | ✓   | ✗                            |
| Light receive indicator | ☉   | ✗                            |
| Load resistance to L+   | ⚠   | ✗                            |
| Load resistance to M    | ✗   | ⚠                            |
|                         |   |                              |

### Characteristic curve

Reflective tape

Operating reserve

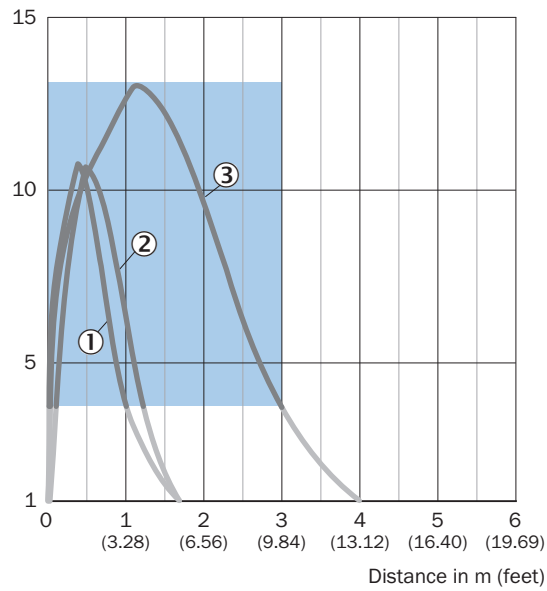

Recommended sensing range for the best performance

- ① Reflective tape REF-DG
- ② Reflective tape REF-IRF-56
- ③ Reflective tape REF-AC1000

Standard reflectors

Operating reserve

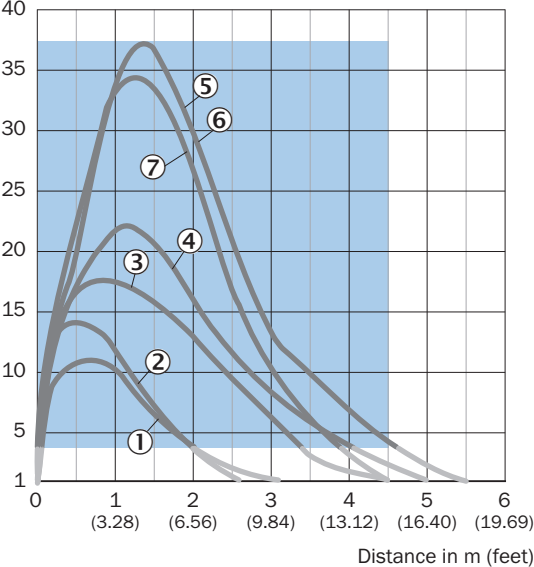

- Recommended sensing range for the best performance
- ① Reflector PL22
- ② Reflector PL20A
- ③ Reflector PL30A
- ④ Reflector PL40A
- ⑤ Reflector PL80A
- ⑥ Reflector C110A
- ⑦ Reflector P250

Fine triple reflectors

Operating reserve

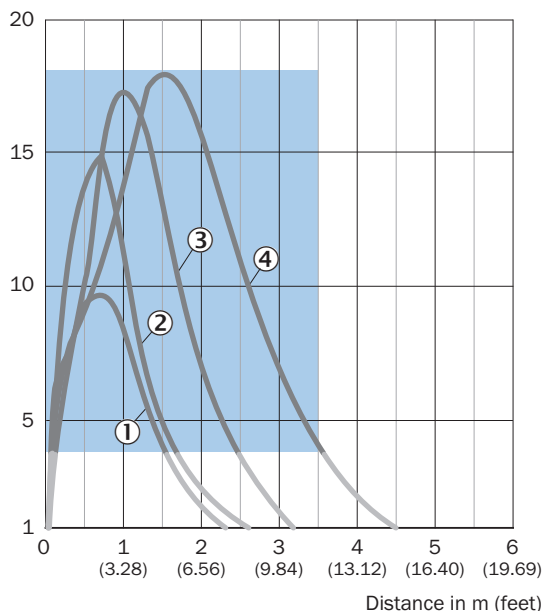

- Recommended sensing range for the best performance
- ① PL10FH reflector
- ② PL10F reflector
- ③ Reflector PL20F
- ④ Reflector P250F

Chemical-resistant reflectors

Operating reserve

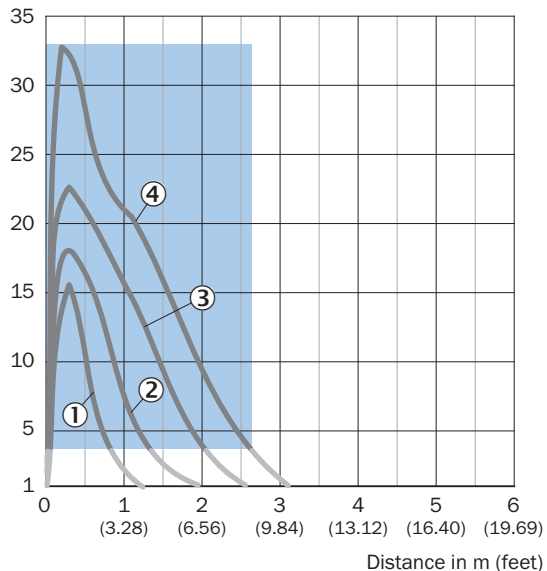

- Recommended sensing range for the best performance
- ① PL10F CHEM reflector
- ② Reflector PL20 CHEM
- ③ Reflector P250 CHEM
- ④ Reflector P250H



## Light spot size

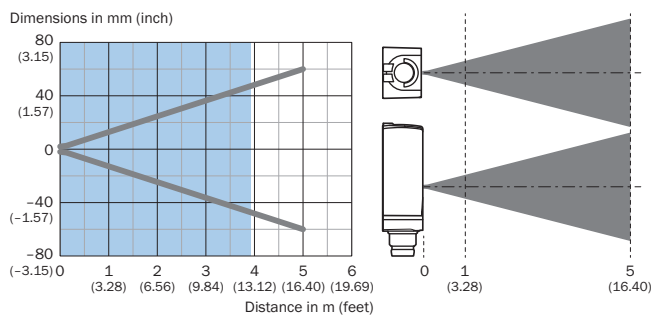

Recommended sensing range for the best performance

## Sensing range diagram

### Standard reflectors

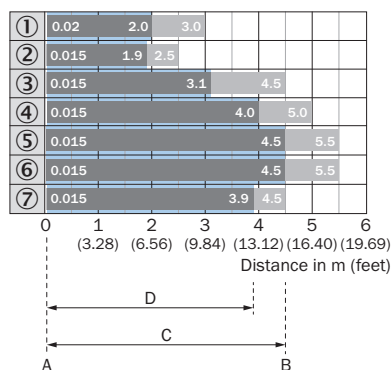

A = Sensing range min. in m

B = Sensing range max. in m

C = Maximum distance range from reflector to sensor (operating reserve 1)

D = Recommended distance range from reflector to sensor (operating reserve 3.75)

Recommended sensing range for the best performance

- ① Reflector PL22
- ② Reflector PL20A
- ③ Reflector PL30A
- ④ Reflector PL40A
- ⑤ Reflector PL80A
- ⑥ Reflector C110A
- ⑦ Reflector P250

### Reflective tape

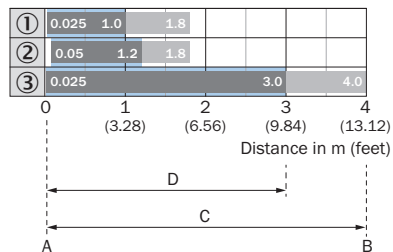

A = Sensing range min. in m  
 B = Sensing range max. in m  
 C = Maximum distance range from reflector to sensor (operating reserve 1)  
 D = Recommended distance range from reflector to sensor (operating reserve 3.75)

Recommended sensing range for the best performance

- ① Reflective tape REF-DG (50 x 50 mm)
- ② Reflective tape REF-IRF-56
- ③ Reflective tape REF-AC1000

### Fine triple reflectors



A = Sensing range min. in m  
 B = Sensing range max. in m  
 C = Maximum distance range from reflector to sensor (operating reserve 1)  
 D = Recommended distance range from reflector to sensor (operating reserve 3.75)

Recommended sensing range for the best performance

- ① PL10FH reflector
- ② PL10F reflector
- ③ Reflector PL20F
- ④ Reflector P250F

### Chemical-resistant reflectors

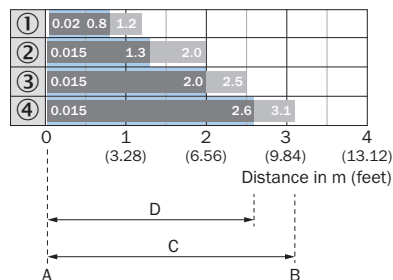

A = Sensing range min. in m  
 B = Sensing range max. in m  
 C = Maximum distance range from reflector to sensor (operating reserve 1)  
 D = Recommended distance range from reflector to sensor (operating reserve 3.75)

Recommended sensing range for the best performance

- ① PL10F CHEM reflector
- ② Reflector PL20 CHEM
- ③ Reflector P250 CHEM
- ④ Reflector P250H

## Adjustments

Display and adjustment elements

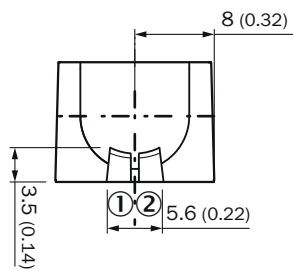

- ① LED green
- ② LED yellow

## Dimensional drawing (Dimensions in mm (inch))

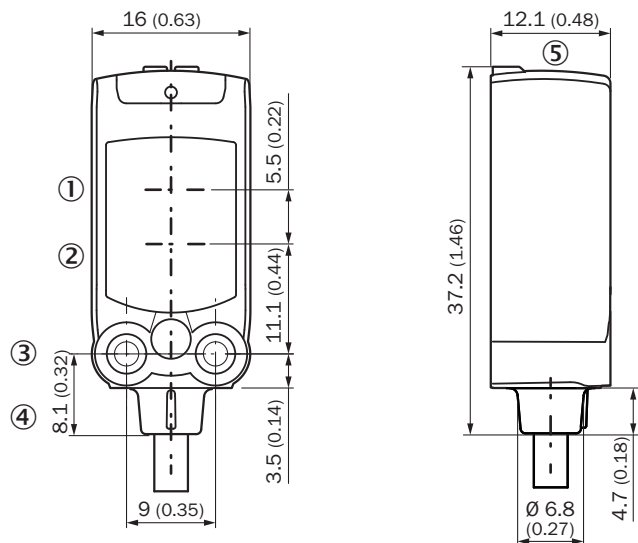



- ① Center of optical axis, sender
- ② Center of optical axis, receiver
- ③ M3 mounting hole
- ④ Connection
- ⑤ Display and adjustment elements

## Recommended accessories

Other models and accessories → [www.sick.com/W4F](http://www.sick.com/W4F)

|   | Brief description  | Type     | Part no. |
|---|--|----------|----------|
| Mounting brackets and plates  |  |          |          |
|  | Mounting bracket for wall mounting, Stainless steel 1.4571, mounting hardware included | BEF-W4-A | 2051628  |

|   | <b>Brief description</b>   | <b>Type</b> | <b>Part no.</b> |
|---|--|-------------|-----------------|
| <b>Plug connectors and cables</b>   |  |             |                 |
|  | Head A: male connector, M8, 3-pin, straight<br>Cable: unshielded   | STE-0803-G  | 6037322         |
| <b>Reflectors</b>   |  |             |                 |
|  | Fine triple reflector, screw connection, suitable for laser sensors, 20 mm x 32 mm, PM-MA/ABS, Screw-on, 2 hole mounting | PL10F       | 5311210         |

## SICK AT A GLANCE

SICK is one of the leading manufacturers of intelligent sensors and sensor solutions for industrial applications. A unique range of products and services creates the perfect basis for controlling processes securely and efficiently, protecting individuals from accidents and preventing damage to the environment.

We have extensive experience in a wide range of industries and understand their processes and requirements. With intelligent sensors, we can deliver exactly what our customers need. In application centers in Europe, Asia and North America, system solutions are tested and optimized in accordance with customer specifications. All this makes us a reliable supplier and development partner.

Comprehensive services complete our offering: SICK LifeTime Services provide support throughout the machine life cycle and ensure safety and productivity.

For us, that is “Sensor Intelligence.”

## WORLDWIDE PRESENCE:

Contacts and other locations –[www.sick.com](http://www.sick.com)