

IN THE CONSTANT PURPOSE OF IMPROVING ITS PRODUCTS, AMPHENOL SOCAPEX RESERVES THE RIGHT TO MODIFY ANY DIMENSION OR CHARACTERISTICS.  
FM.NPD.0036.THYZE.PUNE rev C

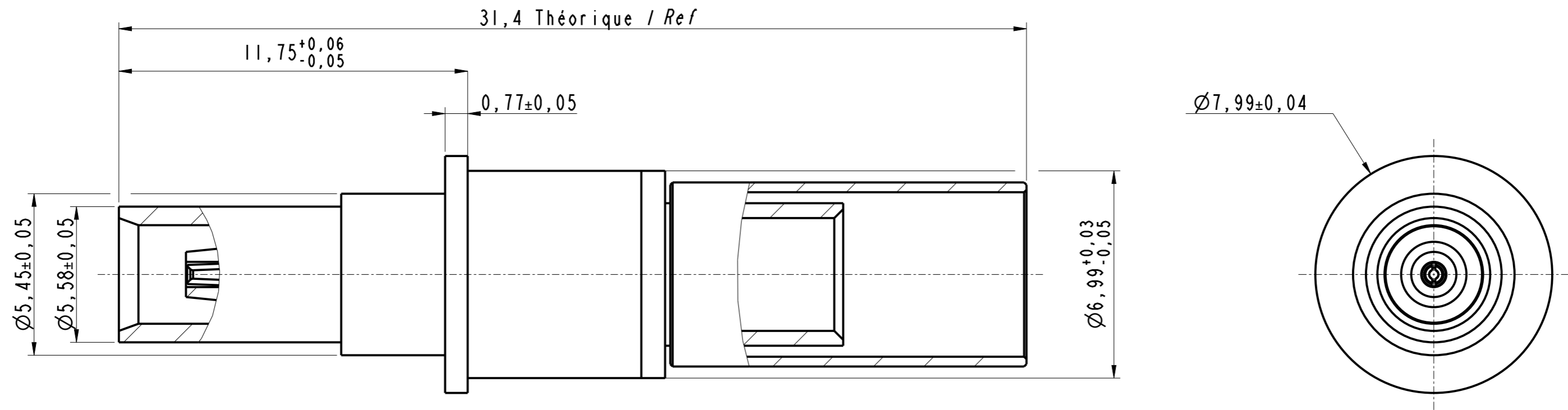

**Note**

- ① - Contact livré non assemblé  
*Contact delivered unassembled*
- ② - Cable compatible: CXN3671  
*Cable compatible: CXN3671*
- ③ - Outil de sertissage:  
Contact intérieur TBD  
Contact extérieur TBD  
- *Crimping tool:*  
Inner contact TBD  
Outer contact TBD
- ④ - *Matières:*  
- Contact extérieur: inox  
- Contact intérieur: alliage de cuivre  
- Fut de sertissage et ferrule: laiton  
- Isolants: PTFE ou équivalent  
*Material:*  
- Outer contact: Stainless steel  
- Inner contact: copper alloy  
- Crimping barrel and ferrule: brass  
- Inserts: PTFE or equivalent
- ⑤ - *Traitements:*  
- Contact extérieur: passivation  
- Contact intérieur, fut de sertissage et ferrule: dorure  
*Finish:*  
- Outer contact: passivation  
- Inner contact, crimping barrel and ferrule: Gold

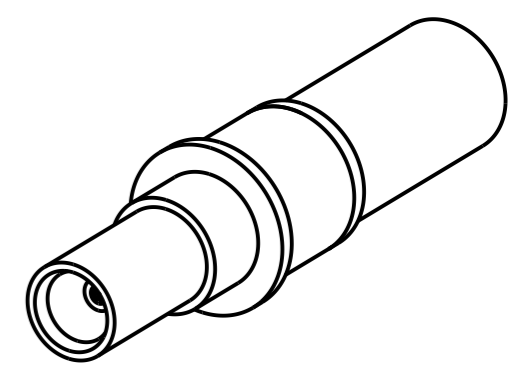

<b>Broche Coax T8 75 ohms 12G-SDI</b> <b>Pin coax S8 75 ohms 12G-SDI</b> <b>Ref : 612460</b>			
DRAWN BY : M.PRUD'HOM		UPDATED BY : M.LAINE	
		LAST APPROVED BY : L.LAGRANGE	
<small>ALL DIMENSIONS ARE IN MM</small> 	<b>AMPHENOL SOCAPEX</b>		<small>ORIGINAL DRAWING DATE :</small> 24/02/21
	<small>B.P. 29 74311 THYZE CEDEX</small>		<small>CONFIGURATION DATA ARE AVAILABLE IN PDM</small>
SCALE : 7			<small>REV : B</small> <small>PAGE : 1/1</small>
			<b>172-PLC-271-00</b>