

| PART NUMBER | REV | FIRST USED |
|-------------|-----|------------|
| 565864-2    | R   | 1-471273-2 |

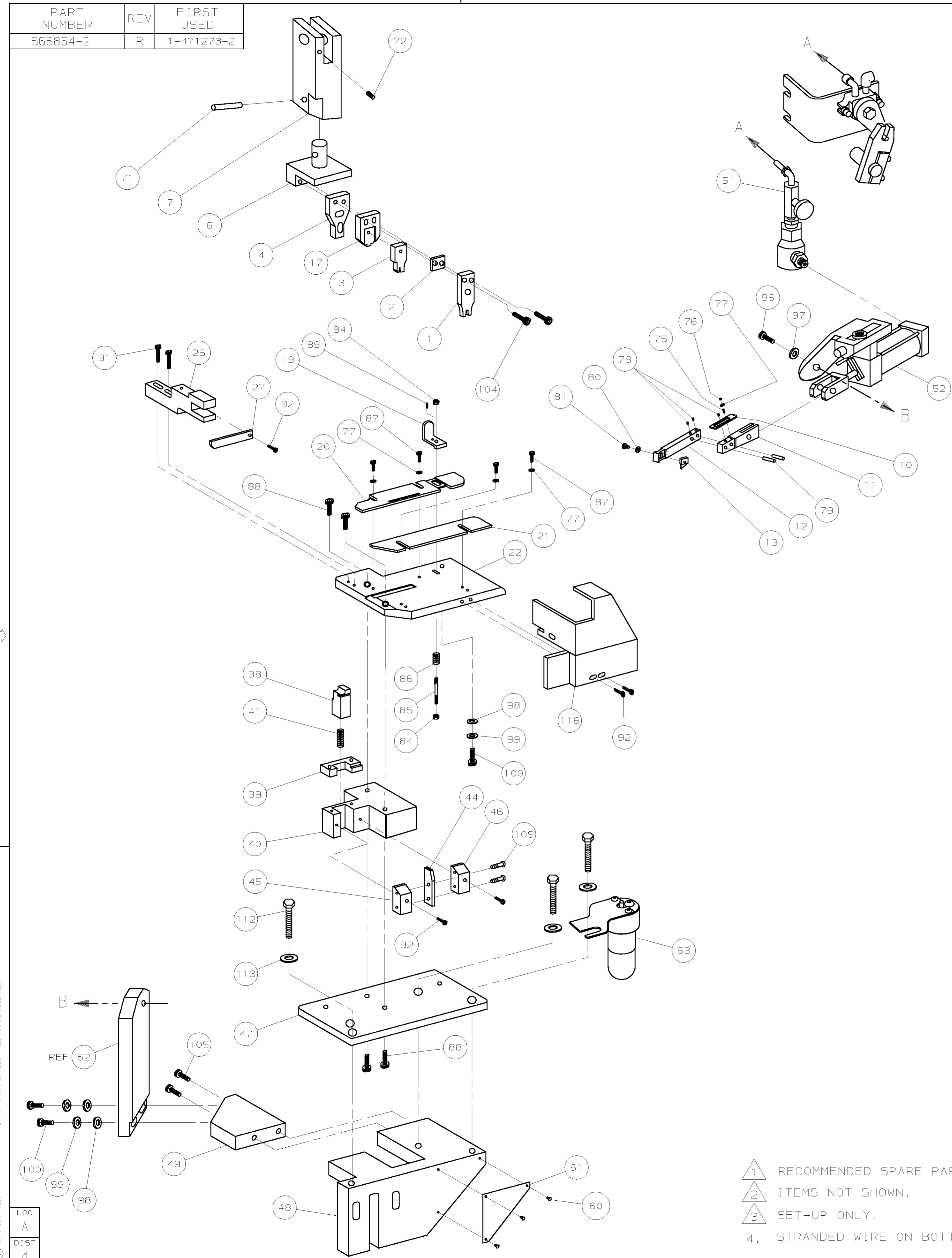

- △ 1 RECOMMENDED SPARE PARTS.
- △ 2 ITEMS NOT SHOWN.
- △ 3 SET-UP ONLY.
- 4. STRANDED WIRE ON BOTTOM.

| TERMINAL NAME: | SPLICE   |
|----------------|----------|
|                | 61300    |
| TERM APPL SPEC | 114-2088 |

| CRIMPING DATA               |           |             |             |
|-----------------------------|-----------|-------------|-------------|
| CRIMP HEIGHT                | ROD DIA   | WIRE SIZE   |             |
| .129                        | .091      | 18 STRANDED |             |
| -                           | -         | -           |             |
| -                           | -         | -           |             |
| CRIMP                       | SIZE      | TYPE        | RANGE       |
| WIRE                        | .180      | F           | 10K-16K CMA |
| INSUL                       | .230      | 0           | .140-.185   |
| FEED                        | APPL INST | SET UP GAGE | LAYOUT      |
| .620                        | -         | -           | -           |
| WIRE STRIP LENGTH .275-.315 |           |             |             |

| QTY | U/M | DWG SIZE | PART NO   | DESCRIPTION   | ITEM NO |
|-----|-----|----------|-----------|---|---------|
| -   | -   | -        | -         | -   | 125     |
| -   | -   | -        | -         | -   | 124     |
| -   | -   | -        | -         | -   | 123     |
| 1   | -   | -        | 453602-1  | MOUNT, BRACKET 30°                                      | 122     |
| 1   | -   | A        | 2-21002-0 | BHCS, 8-32 x .25  | 121     |
| -   | -   | -        | -         | -   | 120     |
| -   | -   | -        | -         | -   | 119     |
| -   | -   | -        | -         | -   | 118     |
| -   | -   | -        | -         | -   | 117     |
| 1   | -   | B        | 461028-2  | GUARD   | 116     |
| -   | -   | -        | -         | -   | 115     |
| -   | -   | -        | -         | -   | 114     |
| 3   | -   | A        | 371178    | BASE MOUNT WASHER                                       | 113     |
| 3   | -   | A        | 3-21015-1 | SCR, HEX HD 3/8-16 X 1.00                               | 112     |
| -   | -   | -        | -         | -   | 111     |
| -   | -   | -        | -         | -   | 110     |
| 2   | -   | A        | 2-21002-1 | SCR, BHC 8-32 X .38                                     | 109     |
| -   | -   | -        | -         | -   | 108     |
| -   | -   | -        | -         | -   | 107     |
| -   | -   | -        | -         | -   | 106     |
| 2   | -   | A        | 1-21001-0 | SCR, SHC, 1/4-20 X 2.0                                  | 105     |
| 2   | -   | A        | 21001-7   | SCR, SHC, 1/4-20 X 1.25                                 | 104     |
| -   | -   | -        | -         | -   | 103     |
| -   | -   | -        | -         | -   | 102     |
| -   | -   | -        | -         | -   | 101     |
| 2   | -   | A        | 21001-5   | SCR, SHC 1/4-20 X .88                                   | 100     |
| 2   | -   | A        | 21024-6   | WASHER, LOCK #1/4                                       | 99      |
| 2   | -   | A        | 21055-8   | WASHER, FLAT #1/4                                       | 98      |
| -   | -   | -        | -         | -   | 97      |
| -   | -   | -        | -         | -   | 96      |
| -   | -   | -        | -         | -   | 95      |
| -   | -   | -        | -         | -   | 94      |
| -   | -   | -        | -         | -   | 93      |
| 3   | -   | A        | 2-21000-8 | SCR, SHC 8-32 X .63                                     | 92      |
| -   | -   | -        | -         | -   | 91      |
| -   | -   | -        | -         | -   | 90      |
| 1   | -   | A        | 3-21008-0 | SCR, SET SELF-LOC 6-32 X .32                            | 89      |
| 5   | -   | A        | 21001-3   | SCR, SHC 1/4-20 X .62                                   | 88      |
| 4   | -   | A        | 2-21000-7 | SCR, SHC 8-32 X .50                                     | 87      |
| 1   | -   | A        | 373469    | STOCK DRAG SPRING                                       | 86      |
| 1   | -   | B        | 370573    | DRAG STUD   | 85      |
| 2   | -   | A        | 21021-4   | NUT, HEX, SELF-LOC 10-32                                | 84      |
| -   | -   | -        | -         | -   | 83      |
| -   | -   | -        | -         | -   | 82      |
| 1   | -   | A        | 2-21000-6 | SCR, SHC 8-32 X .38                                     | 81      |
| 1   | -   | A        | 21024-4   | WASHER, LOCK #8   | 80      |
| 2   | -   | A        | 1-21030-5 | FEED FINGER PIN, DOWEL                                  | 79      |
| 3   | -   | A        | 3-21006-8 | SCR, SET 8-32 X .12                                     | 78      |
| 5   | -   | A        | 21055-6   | WASHER, FLAT #8   | 77      |
| 1   | -   | A        | 21018-6   | NUT, JAM 8-32   | 76      |
| 1   | -   | A        | 4-21006-4 | SCR, SET 8-32 X .50                                     | 75      |
| -   | -   | -        | -         | -   | 74      |
| -   | -   | -        | -         | -   | 73      |
| 1   | -   | A        | 2-21549-3 | SCR, SET SELF-LOC 1/4-20 X .50                          | 72      |
| 1   | -   | A        | 6-21029-9 | PIN, SLOTTED SPR .312 X 1.50                            | 71      |
| -2  | U/M | DWG SIZE | PART NO   | DESCRIPTION   | ITEM NO |
| -   | -   | -        | -         | REVISION OF EACH ASSY NO (WHEN BLANK, USE DWG REVISION) | -       |

| QTY | U/M | DWG SIZE | PART NO    | DESCRIPTION   | ITEM NO |
|-----|-----|----------|------------|---|---------|
| -   | -   | -        | -          | -   | 70      |
| -   | -   | -        | -          | -   | 69      |
| -   | -   | -        | -          | -   | 68      |
| -   | -   | -        | -          | -   | 67      |
| -   | -   | -        | -          | -   | 66      |
| -   | -   | -        | -          | -   | 65      |
| -   | -   | -        | -          | -   | 64      |
| 1   | -   | C        | 465184-8   | LUBRICATOR ASSY   | 63      |
| -   | -   | -        | -          | -   | 62      |
| 1   | -   | B        | 452373-1   | PLATE I.D.  | 61      |
| 3   | -   | A        | 21017-6    | SCR, RH DRIVE   | 60      |
| -   | -   | -        | -          | -   | 59      |
| -   | -   | -        | -          | -   | 58      |
| -   | -   | -        | -          | -   | 57      |
| -   | -   | -        | -          | -   | 56      |
| -   | -   | -        | -          | -   | 55      |
| -   | -   | -        | -          | -   | 54      |
| -   | -   | -        | -          | -   | 53      |
| 1   | -   | B        | 690021-1   | AIR FEED CYLINDER SUB-ASSY                              | 52      |
| 1   | -   | C        | 692655-5   | AIR FEED VALVE SUB-ASSY                                 | 51      |
| -   | -   | -        | -          | -   | 50      |
| 1   | -   | -        | 465319-2   | EXTENSION, BASE 30°                                     | 49      |
| 1   | -   | C        | 570238     | BASE MOUNT  | 48      |
| 1   | -   | B        | 465317-1   | BASE PLATE  | 47      |
| 1   | -   | -        | 811839-3   | AUX ANVIL HOLDER  | 46      |
| 1   | -   | B        | 811838-3   | ANVIL HOLDER  | 45      |
| 1   | -   | C        | 692183-2   | ANVIL   | 44      |
| -   | -   | -        | -          | -   | 43      |
| -   | -   | -        | -          | -   | 42      |
| 1   | -   | A        | 387083     | SHEAR SPRING  | 41      |
| 1   | -   | B        | 565076-1   | BASE BLOCK  | 40      |
| 1   | -   | B        | 811239-1   | SHEAR, PLATE  | 39      |
| 1   | -   | B        | 465324-4   | SHEAR, FLOATING   | 38      |
| -   | -   | -        | -          | -   | 37      |
| -   | -   | -        | -          | -   | 36      |
| -   | -   | -        | -          | -   | 35      |
| -   | -   | -        | -          | -   | 34      |
| -   | -   | -        | -          | -   | 33      |
| -   | -   | -        | -          | -   | 32      |
| -   | -   | -        | -          | -   | 31      |
| -   | -   | -        | -          | -   | 30      |
| -   | -   | -        | -          | -   | 29      |
| -   | -   | -        | -          | -   | 28      |
| 1   | -   | A        | 811266-2   | STRIPPER  | 27      |
| 1   | -   | B        | 692875-1   | MOUNT, STRIPPER   | 26      |
| -   | -   | -        | -          | -   | 25      |
| -   | -   | -        | -          | -   | 24      |
| -   | -   | -        | -          | -   | 23      |
| 1   | -   | B        | 692187-1   | STRIP GUIDE PLATE                                       | 22      |
| 1   | -   | B        | 465320-5   | FRONT STRIP GUIDE                                       | 21      |
| 1   | -   | B        | 465350-5   | REAR STRIP GUIDE  | 20      |
| 1   | -   | B        | 387650-4   | DRAG, STOCK   | 19      |
| -   | -   | -        | -          | -   | 18      |
| 1   | -   | -        | 465340-1   | ADJ CRIMP MOUNT ASSY                                    | 17      |
| -   | -   | -        | -          | -   | 16      |
| -   | -   | -        | -          | -   | 15      |
| -   | -   | -        | -          | -   | 14      |
| 1   | -   | A        | 811645-1   | TIP, FEED FINGER  | 13      |
| 1   | -   | B        | 811644-1   | FINGER, FEED  | 12      |
| 1   | -   | A        | 810131     | ARM, FEED FINGER  | 11      |
| 1   | -   | A        | 374999     | TENSION ADJUSTING PLATE                                 | 10      |
| -   | -   | -        | -          | -   | 9       |
| -   | -   | -        | -          | -   | 8       |
| 1   | -   | B        | 471167     | RAM   | 7       |
| 1   | -   | B        | 465325-1   | TOOL HOLDER   | 6       |
| -   | -   | -        | -          | -   | 5       |
| 1   | -   | B        | 387265     | SHEAR DEPRESSOR   | 4       |
| 1   | -   | -        | 2-472817-4 | INSULATION CRIMPER 3                                    | 3       |
| 1   | -   | B        | 370692     | SPACER  | 2       |
| 1   | -   | C        | 453910-1   | WIRE CRIMPER  | 1       |
| -2  | U/M | DWG SIZE | PART NO    | DESCRIPTION   | ITEM NO |
| -   | -   | -        | -          | REVISION OF EACH ASSY NO (WHEN BLANK, USE DWG REVISION) | -       |

QTY RECD PER ASSY

DIMENSIONS IN INCHES. DO NOT SCALE PRINT. TOLERANCES UNLESS OTHERWISE SPECIFIED:

2 PLC DEC ±  
3 PLC DEC ±  
4 PLC DEC ±  
ANGLES ±  
SURF TEXTURE: ✓  
REMOVE BURRS, BREAK SHARP EDGES R.015 MAX

MATL - HT TR - FIN -

DR M. YOUNGER 8-18-03 APP - T. ELBIN  
CHK - C. ERISMAN REL - B. McPHERSON

NAME - STD APPL (30 DEG ROTATED SPLICE) MACHINE REF STD APPL  
SCALE 1:4 DWG NO 565864-2 SHEET 1 OF 1 REV R

AMP Incorporated Harrisburg, PA 17105-3608

CASE CODE 00779 CUSTOMER AND ASSEMBLY DRAWING 1 RESTRICTED TO

THIS DRAWING IS UNCONTROLLED DOCUMENT FOR AMP INCORPORATED. IT IS SUBJECT TO CHANGE AND REVISION WITHOUT NOTICE. ENGINEERING ORGANIZATION SHOULD BE CONTACTED FOR THE LATEST REVISION.  
 DATE: 1999  
 BY: AMP INCORPORATED. ALL RIGHTS RESERVED.  
 THIS DRAWING IS UNCONTROLLED DOCUMENT FOR AMP INCORPORATED. IT IS SUBJECT TO CHANGE AND REVISION WITHOUT NOTICE. ENGINEERING ORGANIZATION SHOULD BE CONTACTED FOR THE LATEST REVISION.  
 DATE: 1999  
 BY: AMP INCORPORATED. ALL RIGHTS RESERVED.

565864-2