



Perishable Tooling Specification Sheet Order No. 63801-7570

FEATURES

- For use in tools 514158-7 and 514158-8 (see document RAS-98100-001, sheet 17)

SCOPE

Products: FFC-to-Wire Splice Terminals 98100-0001 and 98100-0002. For additional product application information see documents RAS-98100-001 and RPS-98100-001.

CRIMP SPECIFICATION

See document RAS-98100-001 for crimp specifications.

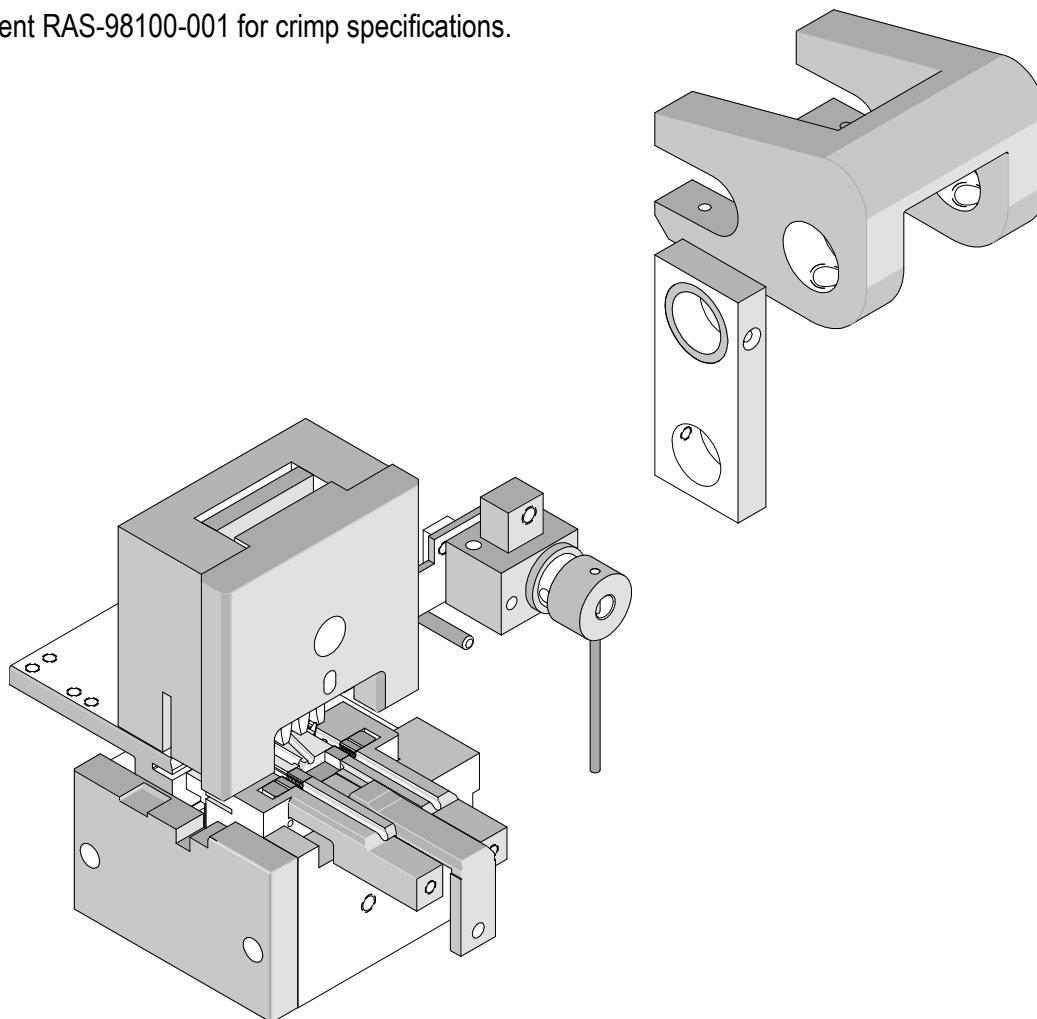

PARTS LIST

Perishable Tool Kit 63801-7570			
Item	Order No	Description	Reference Part Number
1	63801-7501	Stop, Conductor	1-519685-7
2	63801-7502	Lever	3-519533-4
3	63801-7503	Holding Fixture	2-519679-2B
4	63801-7504	Holding Fixture	1-519679-2A
5	63801-7505	Slider	1-519688-0
6	63801-7506	Insulation Crimper	3-519628-6A
7	63801-7507	Wire Crimper	3-519628-5A
8	63801-7508	Wire Anvil	2-519627-5A
9	63801-7509	Insulation Anvil	2-519627-6A
10	63801-7510	Guide – Anvil	9-519659-9A
11	63801-7511	Anvil – FFC	2-519627-7B
12	63801-7512	Diode Clamp	6-519515-7B
13	63801-7513	Wire Clamp	4-519515-6A
14	63801-7514	FFC Crimper	3-519628-7A-B
15	63801-7515	Knife	9-519547-2A
16	63801-7516	Feed Finger	514869-3A
17	63801-7517	Blade	519690-3A
18	63801-7518	Insert, Clamp	3-519617-8A
19	63801-7519	Insert, Clamp	3-519617-7A
20	63801-7520	Holding Fixture	6-519679-1A
21	63801-7521	Wire Clamp	9-519515-0A
22	63801-7522	Insert, Clamp	6-519617-2A
23	63801-7523	Diode Clamp	4-519688-4
24	63801-7524	Stop	4-519685-4
25	63801-7525	Hold-down	3-519619-3
26	63801-7526	Terminal Shear	2-519679-1
27	63801-7527	Bearing Block	2-519526-4
28	63801-7528	Lever	3-519533-5A
29	63801-7529	Lever, Forked	434947-1
30	63801-7530	Lever, Knee	434948
31	63600-2999	Oil-less Bushing	LFZB5-5
32	63801-7532	Upper Holder	3-519514-6
33	63801-7533	Upper Holder	4-519514-4
34	63801-7534	Holding Fixture – Wire/Diode	8-519679-4

Assembly Drawings

Figure 1: Upper Tooling (Applications with Insulation Crimping)

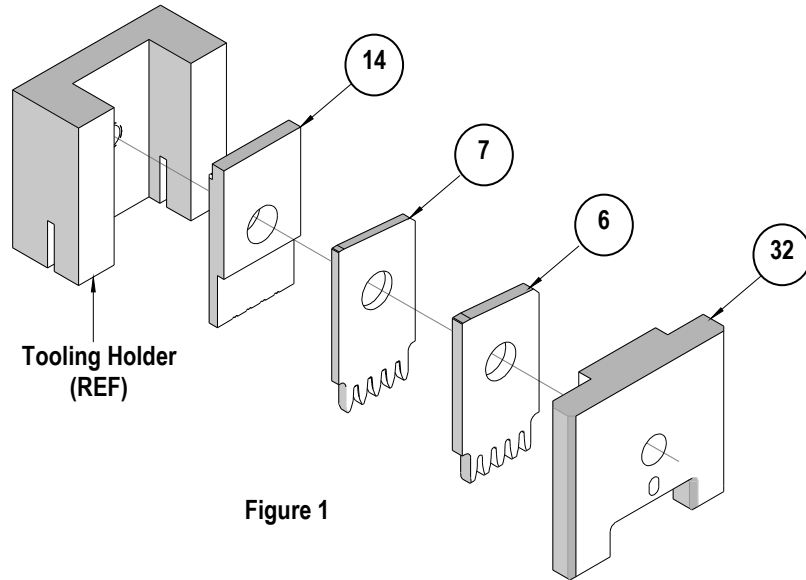

Figure 1

Figure 2: Lower Tooling (Applications with Insulation Crimping)

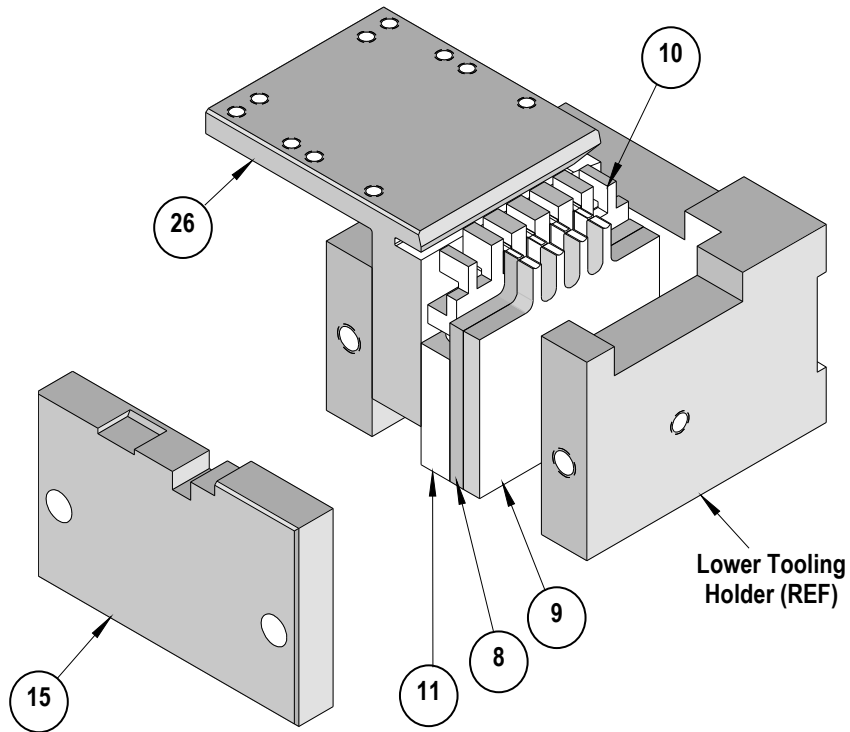

Figure 2

Figure 3: Upper Tooling (Applications without Insulation Crimping)

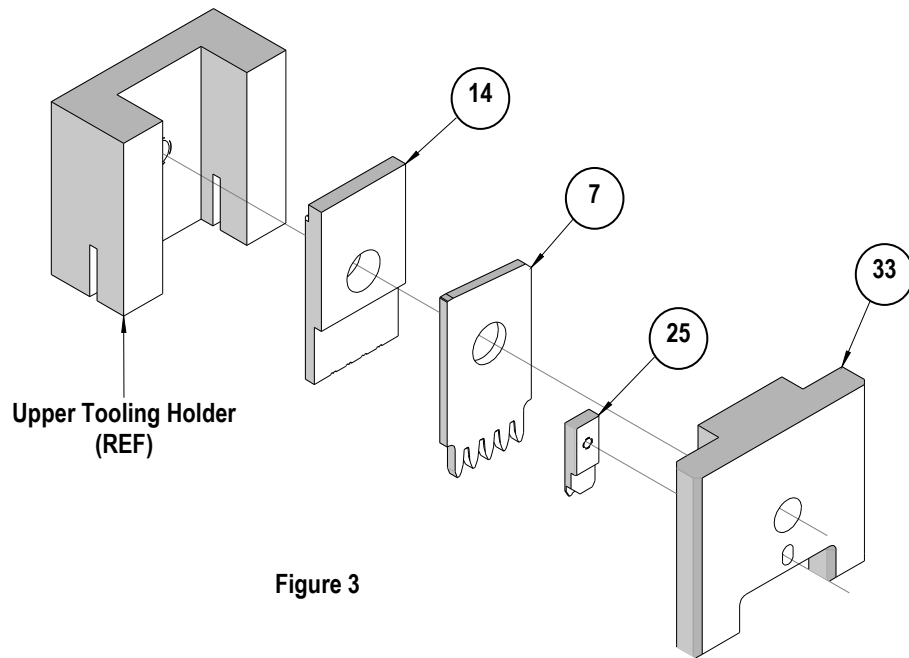

Figure 3

Figure 4: Lower Tooling (Applications without Insulation Crimping)

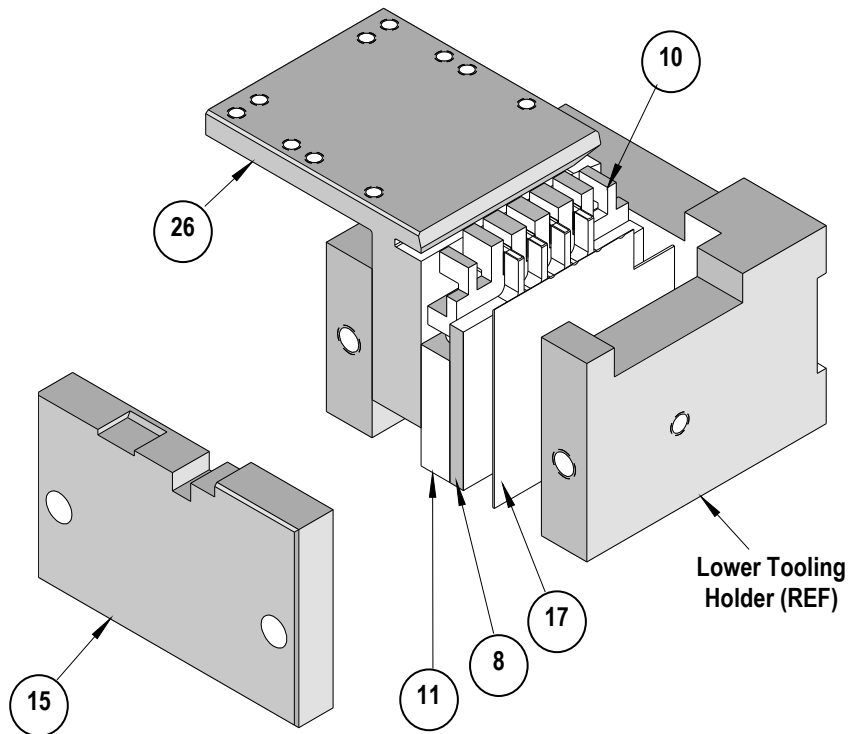

Figure 4

Figure 5: Wire Clamp (Applications with Insulation Crimping)

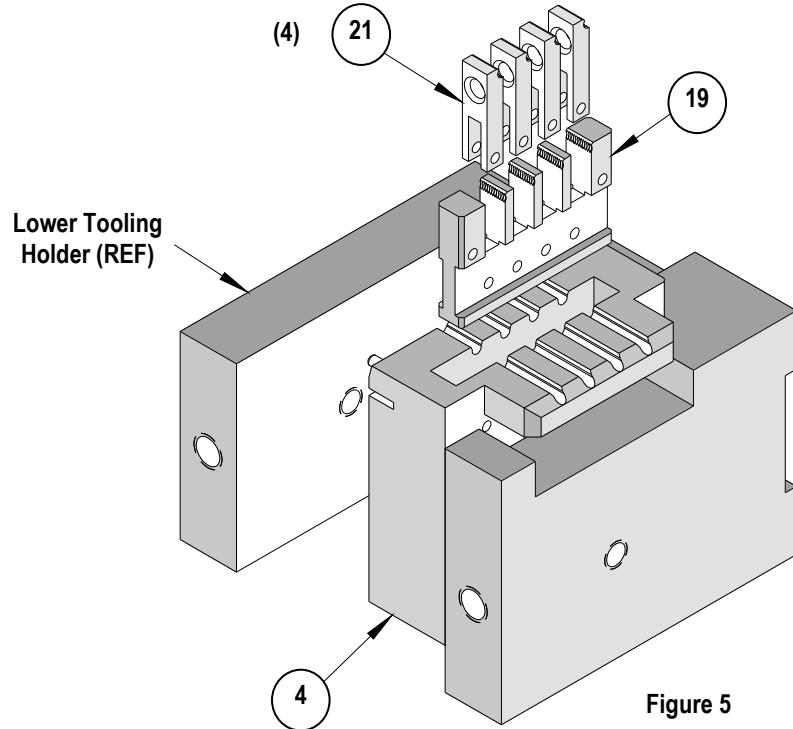

Figure 6: Wire Clamp (Applications without Insulation Crimping)

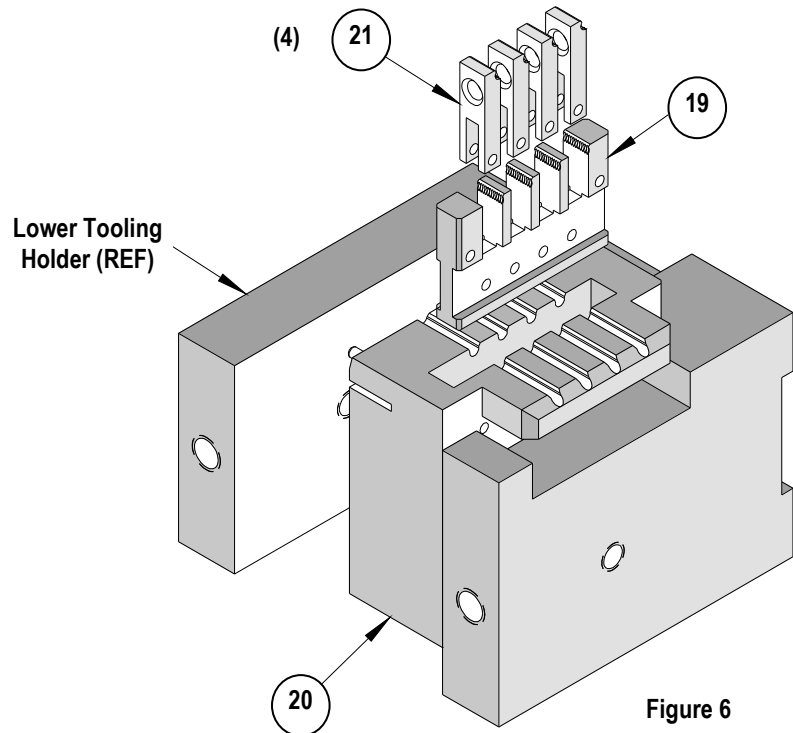

Figure 7: Diode Clamp (Applications with Insulation Crimping)

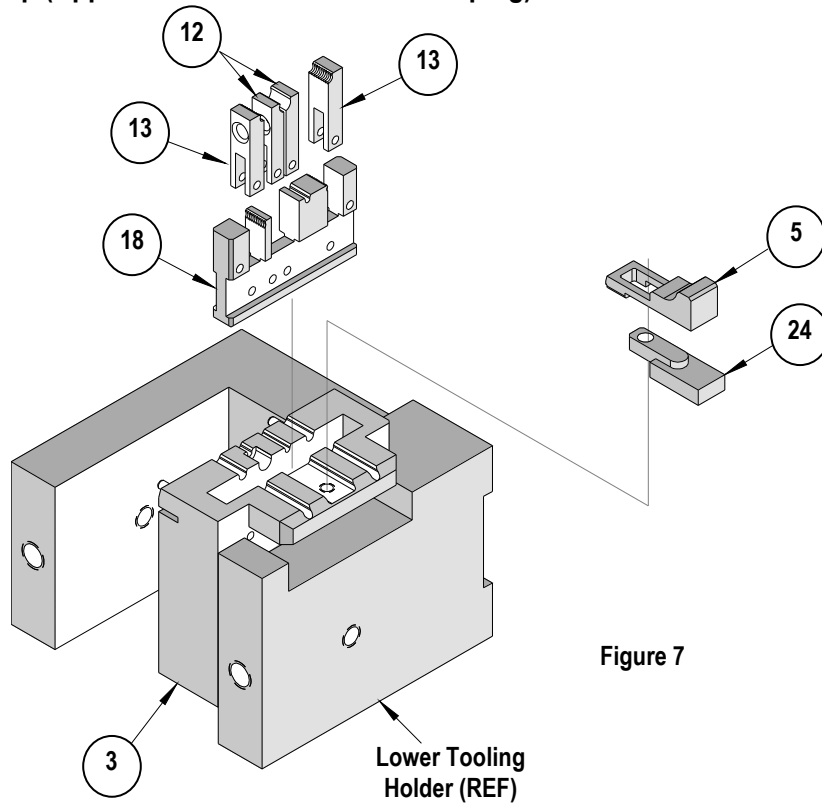

Figure 7

Figure 8: Diode Clamp (Applications without Insulation Crimping)

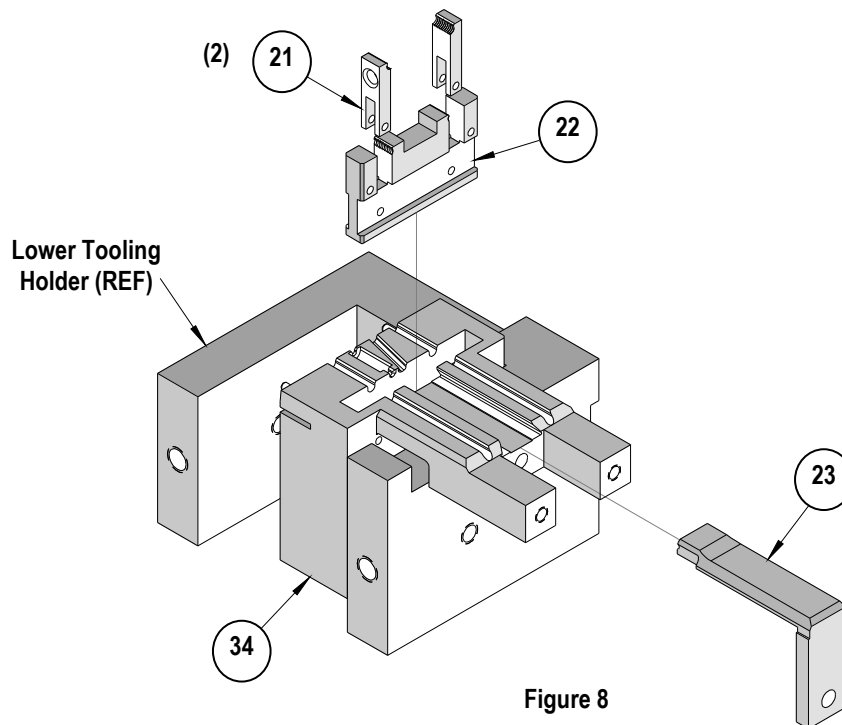

Figure 8

Figure 9: Contact Feed Track Parts

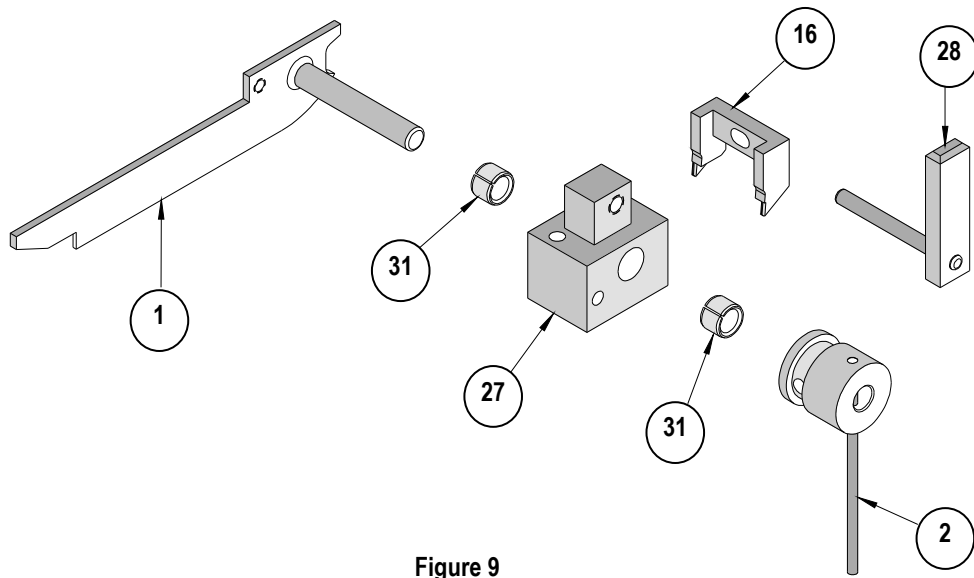

Figure 9

Figure 10: Press Linkage Parts

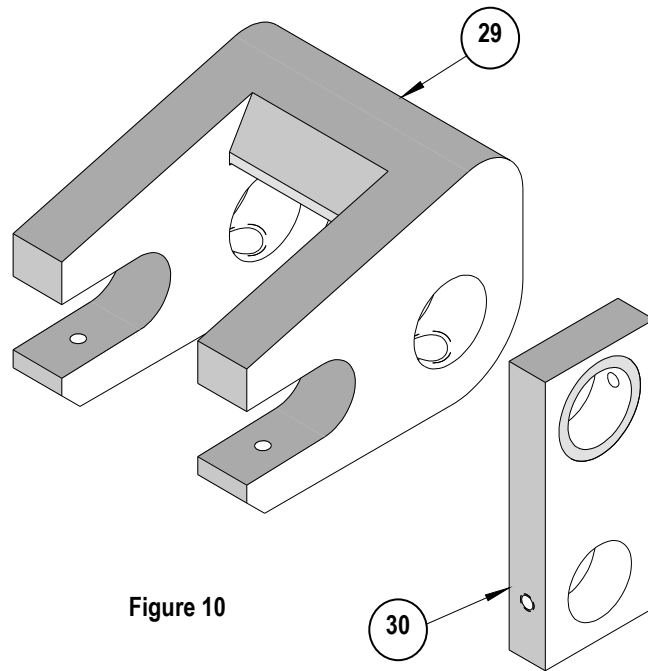

Figure 10

Americas Headquarters
 Lisle, Illinois 60532 U.S.A.
 1-800-78MOLEX
 amerinfo@molex.com

Far East North Headquarters
 Yamato, Kanagawa, Japan
 81-462-65-2324
 feninfo@molex.com

Far East South Headquarters
 Jurong, Singapore
 65-6-268-6868
 fesinfo@molex.com

European Headquarters
 Munich, Germany
 49-89-413092-0
 eurinfo@molex.com

Corporate Headquarters
 2222 Wellington Ct.
 Lisle, IL 60532 U.S.A.
 630-969-4550
 Fax: 630-969-1352

Visit our Web site at <http://www.molex.com>