

THIS DRAWING IS UNPUBLISHED. RELEASED FOR PUBLICATION  
 © COPYRIGHT BY TYCO ELECTRONICS CORPORATION. ALL INTERNATIONAL RIGHTS RESERVED.

LOC	DIST	REVISIONS					
		P	LTR	DESCRIPTION	DATE	DWN	APVD
-	-	A		REDRAW PER ECO-11-000958	19JAN11	HMR	NE

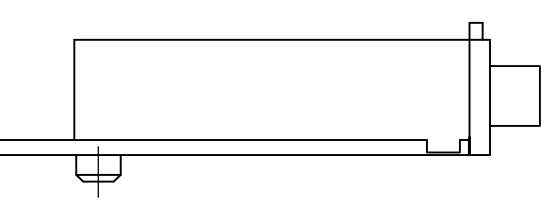
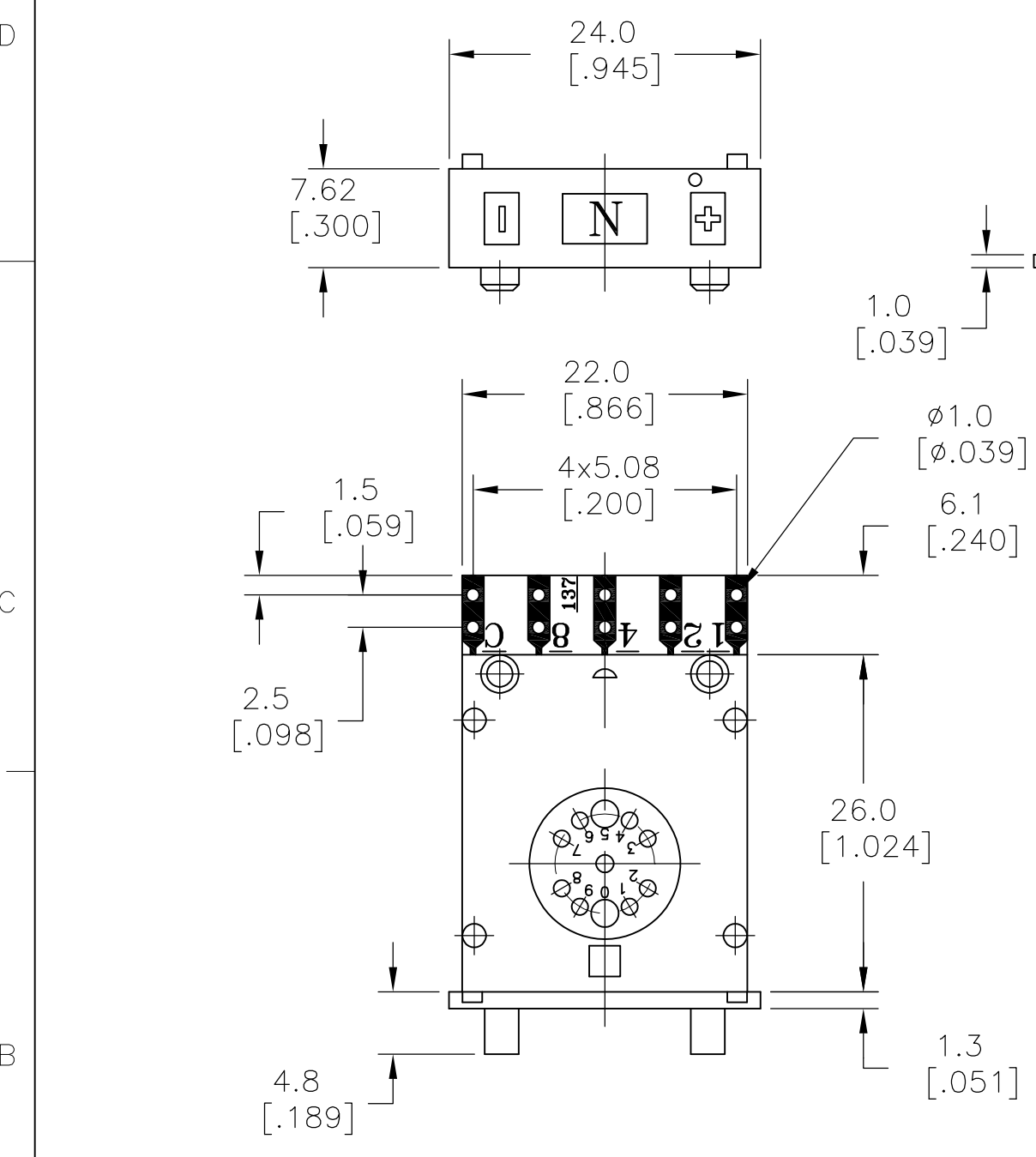

		BCD COMPLEMENT					
		PIN CONNECTION					
		C	1	2	4	8	
POSITION	0	●	●	●	●	●	
	1	●		●	●	●	N
	2	●	●		●	●	Kp
	3	●			●	●	Sc
	4	●	●	●		●	Lb
	5	●		●		●	
	6	●	●			●	
	7	●				●	
	8	●	●	●	●		
	9	●		●	●		

PRINTING

**TECHNICAL DATA**

**MECHANICAL**

PERMISSIBLE AMBIENT TEMPERATURE: -20°C TO +80°C.  
 EXPECTED LIFE (SWITCHING CYCLES): 1,000,000  
 ACTUATING FORCE APPROX: 4N  
 WEIGHT APPROX: 4g  
 DIGIT HEIGHT: 4.9[.193]  
 CLICK ACTION: MARKED  
 VIBRATION: DIN EN 60068-2-6  
 SHOCK: DIN EN 60068-2-27

**ELECTRICAL**

OPERATING VOLTAGE: MAX 40V  
 CONTACT LOAD STATIC: MAX 1A  
 CONTACT LOAD DYNAMIC(RESISTIVE): MAX 100mA  
 CONTACT RESISTANCE (MEASURED FROM THE SUPPLY LINE TO THE OUTPUT): <100mΩ

**MATERIAL**

HOUSING: PPO  
 PC BOARD BASE MATERIAL: FR4  
 CONTACT SURFACE: Au OVER Ni ON Cu  
 SLIDING CONTACT: Au OVER Ni ON COPPER ALLOY

HOUSING BLACK  
 KEYS BLACK  
 DRUM BLACK  
 PAINTING WHITE (TURNED BY 90°, PLUS BUTTON RIGHT)  
 SWITCHABLE 1-4

2-1437602-8  
 PART NO

THIS DRAWING IS A CONTROLLED DOCUMENT.		DWN RAGHAVENDRA 19JAN11	Tyco Electronics Corporation Harrisburg, PA 17105-3608	
DIMENSIONS: mm [INCHES]		CHK EPPLEY NAZ 19JAN11	Tyco Electronics	
TOLERANCES UNLESS OTHERWISE SPECIFIED:		APVD EPPLEY NAZ 19JAN11	NAME BCD COMPLEMENT PUSHWHEEL SWITCH	
0 PLC ±		PRODUCT SPEC	SIZE	
1 PLC ± 0.2[.008]		APPLICATION SPEC	CAGE CODE	DRAWING NO
2 PLC ± 0.15[.006]		WEIGHT	RESTRICTED TO	
3 PLC ±		A3 00779 C-2-1437602-8		
4 PLC ±		CUSTOMER DRAWING		
ANGLES ± -		SCALE	SHEET	REV
MATERIAL		2:1 1 OF 1 A		
FINISH				