

Data sheet | Item number: 787-1007

Switched-mode power supply; for DALI module (753-647); 1-phase; 18 VDC output voltage; 1.1 A output current; 2,50 mm²

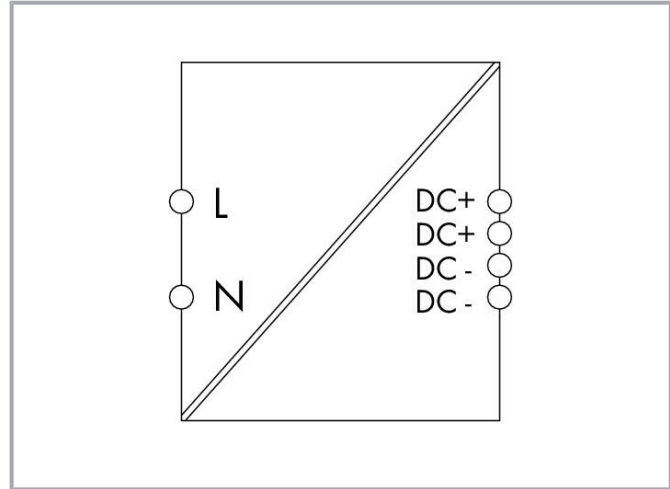

www.wago.com/787-1007



Subject to changes. Please also observe the further product documentation!

WAGO GmbH & Co. KG
Hansastr. 27
32423 Minden
Phone: +49571 887-0 | Fax: +49571 887-169
Email: info.de@wago.com | Web: www.wago.com

Do you have any questions about our products?
We are always happy to take your call at +49 (571) 887-44222.

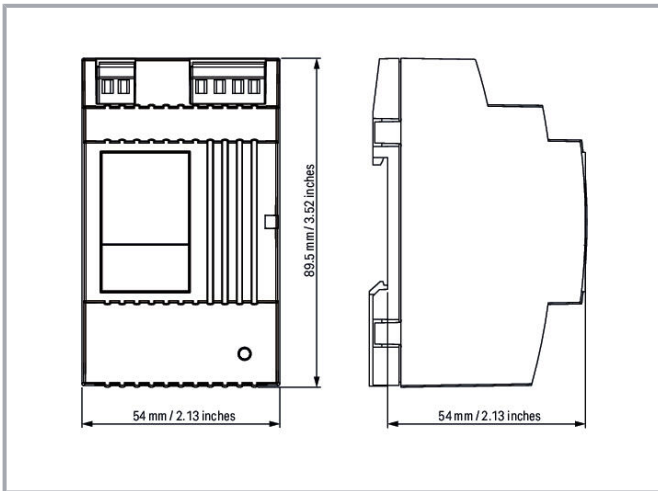

Item description

WAGO's 787-1007 Switched-Mode Power Supply is specially designed to supply the 753-647 DALI Multi-Master Module. This unit features a 54 mm wide DIN-rail-mount enclosure with an input voltage range of 85 to 264 VAC (120 ... 300 VDC). The power supply provides an output voltage of 18 VDC and a maximum output current of 1100 mA – enough to supply up to five parallel modules. The maximum current per DALI line is limited to 200 mA in each DALI Multi-Master Module.

- Supplies up to five 753-647 DALI Multi-Master Modules*
- Suitable for protection class II equipment
- Natural convection cooling when horizontally mounted
- Stepped profile, ideal for distribution boards/boxes

Data

Technical data

Input

Phases	1
Nominal input voltage $U_{i\text{nom}}$	1 x AC 100 ... 240 V
Input voltage range	1 x AC 85 ... 264 V; DC 120 ... 300 V
Nominal mains frequency range	44 ... 66 Hz; 0 Hz
Input current I_i	≤ 0.4 A (230 VAC); ≤ 0.6 A (110 VAC)
Inrush current	≤ 30 A (NTC)
Mains failure hold-up time	≥ 80 ms (230 VAC); ≥ 10 ms (110 VAC)

Subject to changes. Please also observe the further product documentation!



Output

Nominal output voltage $U_{o\text{ nom}}$	DC 18 V (SELV)
Nominal output current $I_{o\text{ nom}}$	1.1 A (18 VDC); 0.8 A (18 VDC; in any mounting position)
Nominal output power	19.8 W
Residual ripple	≤ 100 mV (peak-to-peak)
Current limitation	$1.1 \times I_{o\text{ nom}}$ (typ.)
Overload behavior	Constant current

Signaling and Communication

Signaling	1 x Status indication LED (green)
Operation status indicator	Green LED (U_o)

Efficiency/power losses

Power loss P_l	≤ 3 W; ≤ 6 W (nominal load)
Efficiency (typ.)	80 %

Circuit protection

Internal fuse	T 2 A / 250 VAC
Backup fusing (required)	An external DC fuse is required for the DC input voltage.
Backup fusing (recommended)	Circuit breaker: 6 A (C characteristic), 10 A (B characteristic) or higher

Safety and protection

Protection class	II
Protection type	IP20; per EN 60529
Overvoltage category	II
Pollution degree	2
Short-circuit-protected	Yes
Open-circuit-proof	Yes
MTBF	$> 500,000$ h (per IEC 61709)

Connection data

Connection type 1	Input/Output
-------------------	--------------

Subject to changes. Please also observe the further product documentation!



Connection technology	CAGE CLAMP®
WAGO connector	WAGO 740 Series
Solid conductor	0.08 ... 2.5 mm ² / 28 ... 12 AWG
Fine-stranded conductor	0.08 ... 2.5 mm ² / 28 ... 12 AWG
Strip length	6 ... 7 mm / 0.24 ... 0.28 inches

Physical data

Width	54 mm / 2.126 inches
Height	89 mm / 3.504 inches
Depth	59 mm / 2.323 inches
Depth from upper-edge of DIN-rail	55 mm / 2.165 inches

Mechanical Data

Mounting type	DIN-35 rail
---------------	-------------

Material Data

Flammability class per UL94	V0
Weight	170 g

Environmental requirements

Ambient temperature (operation)	-25 ... +60 °C
Ambient temperature (storage)	-25 ... +80 °C
Relative humidity	5 ... 96 % (no condensation permissible)

Standards and specifications

Conformity marking	CE
Standards/specifications	EN 61010-1 EN 61010-2-201 EN 61204-3 UL 60950-1 UL 508 DNV

Commercial data

Product Group	6 (INTERFACE ELECTRONIC)
eCl@ss 10.0	27-04-07-01
eCl@ss 9.0	27-04-07-01

Subject to changes. Please also observe the further product documentation!



ETIM 8.0	EC002540
ETIM 7.0	EC002540
PU (SPU)	1 pcs
Packaging type	box
Country of origin	CN
GTIN	4050821430575
Customs tariff number	85044083900

Environmental Product Compliance

RoHS Compliance Status	Compliant, No Exemption
------------------------	-------------------------



Approvals / Certificates

General approvals

Logo	Approval	Additional Approval Text	Certificate name
	EAC Brjansker Zertifizierungsstelle	TP TC 004/2011, TP TC 020/2011	EAC RU C-DE.AM02.B.00089_19
	UL Underwriters Laboratories Inc.	UL 60950-1	E255815

Optional accessories

Marking accessories

Marking strip		
	Item no.: 210-831 Marking strips; on reel; 2.3 mm wide; plain; Self-adhesive; white	www.wago.com/210-831
	Item no.: 210-832 Marking strips; on reel; 3 mm wide; plain; Self-adhesive; white	www.wago.com/210-832
Tool		
Operating tool		
	Item no.: 210-769 SCREWDRIVER; green	www.wago.com/210-769

Subject to changes. Please also observe the further product documentation!



Item no.: 210-720

Operating tool; Blade: 3.5 x 0.5 mm; with a partially insulated shaft; multicoloured

www.wago.com/210-720

Downloads

Documentation

Bid Text

787-1007 X81 - Datei	2019 Feb 19	xml 7.6 kB	Download
787-1007 doc - Datei	2015 Nov 23	doc 32.3 kB	Download
ausschreiben.de 787-1007		URL	Download

Instruction Leaflet

Stromversorgung f. DALI-Multi-Master-Klemme 753-647 DC 18 V, 1,1 A		pdf 165.5 kB	Download
---	--	-----------------	----------

Additional Information

Disposal and Recycling Electrical and electronic equipment, Batteries, Packaging	V 1.1.0 2022 Aug 18	pdf 2.2 MB	Download
---	------------------------	---------------	----------

CAD/CAE-Data

CAD data

2D/3D Models 787-1007		URL	Download
-----------------------	--	-----	----------

CAE data

EPLAN Data Portal 787-1007		URL	Download
WSCAD Universe 787-1007		URL	Download
ZUKEN Portal 787-1007		URL	Download

Subject to changes. Please also observe the further product documentation!

WAGO GmbH & Co. KG
 Hansastr. 27
 32423 Minden
 Phone: +49571 887-0 | Fax: +49571 887-169
 Email: info.de@wago.com | Web: www.wago.com

Do you have any questions about our products?
 We are always happy to take your call at +49 (571) 887-44222.



Environmental Product Compliance

Compliance Search

Environmental Product Compliance 787-1007

URL

Download

Switched-mode power supply; for DALI module (753-647); 1-phase; 18 VDC output voltage; 1.1 A output current; 2,50 mm²

Installation Notes

Product family

EPSITRON COMPACT Power

EPSITRON® COMPACT POWER: Compact, High-Performance Power Supplies

[Show all products from the family](#)

Subject to changes. Please also observe the further product documentation!

WAGO GmbH & Co. KG

Hansastr. 27

32423 Minden

Phone: +49571 887-0 | Fax: +49571 887-169

Email: info.de@wago.com | Web: www.wago.com

Do you have any questions about our products?

We are always happy to take your call at +49 (571) 887-44222.