

LOOSE PIECE		SPECIFICATIONS				
MATERIAL NUMBER	ENGINEERING NUMBER	STUD SIZE	"S" ±.005 [0.13]	"W" ±.010 [0.25]	"C" MIN.	"L" MAX.
191960005	A-535-06	6	.146 [3.71]	.316 [8.02]	.303 [7.70]	1.070 [27.18]
191960007	A-535-08	8	.173 [4.39]			
191960009	A-535-10	10	.198 [5.03]			

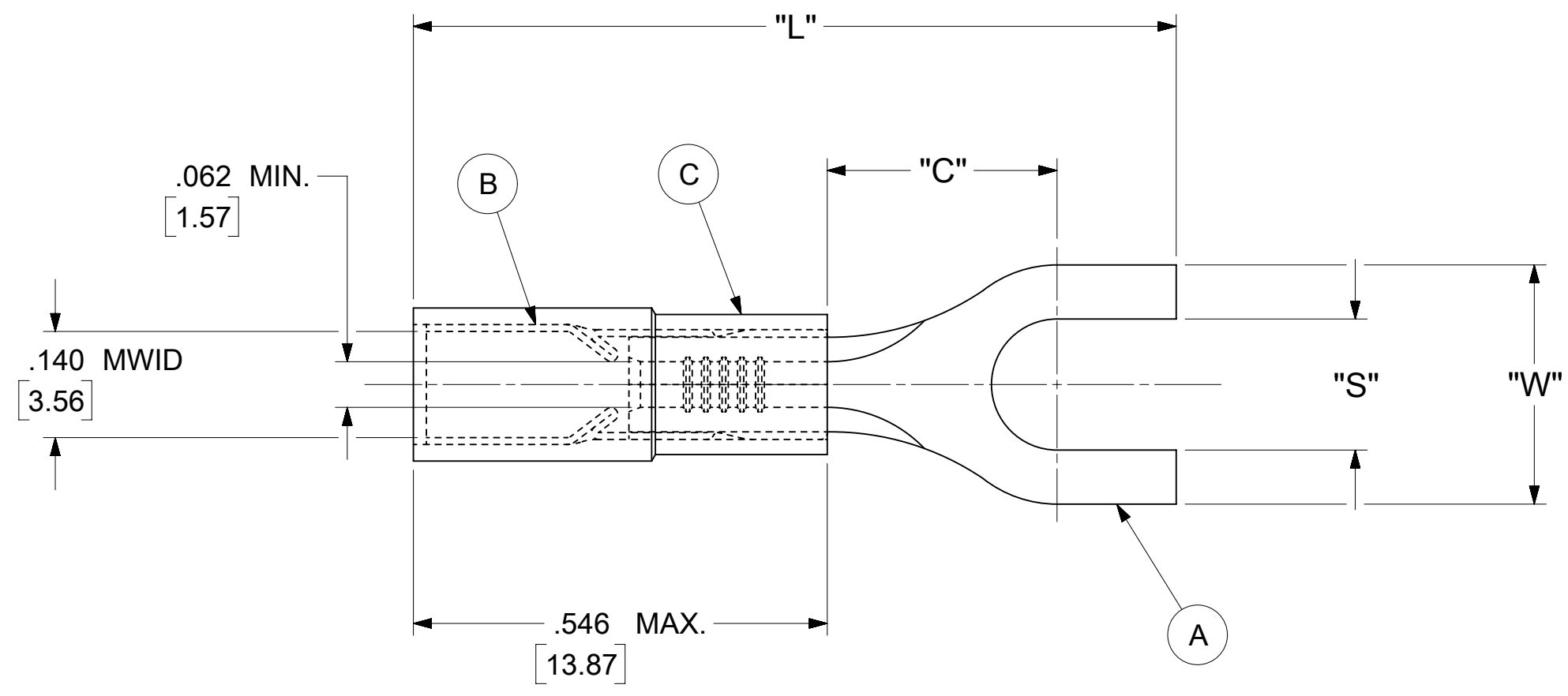

- NOTES:
- MATERIAL:
    - (A). TERMINAL: COPPER ( STOCK THICKNESS  $.028^{+.001}_{-.000}$  [0.71] )  
PLATING: ELECTRO-TIN (.0003 MIN.)
    - (B). TIN-PLATED BRASS FUNNEL FERRULE
    - (C). INSULATION: NYLON (COLOR CODED RED)
  - MWID: MAXIMUM WIRE INSULATION DIAMETER
  - WIRE SIZE: 22 - 18 AWG  
.25 - 1.5 MM<sup>2</sup>
  - "UL" LISTING #E32244  
"CSA" LISTING #18689
  - ALL DIMENSIONS IN INCHES/[MM].
  - PARTS ARE ROHS COMPLIANT.
  - DIMS. SHOWN ARE FOR REFERENCE ONLY.

<b>SYMBOLS</b> = 0 = 0 = 0 = 0 = 0 = 0 = 0	THIS DRAWING CONTAINS INFORMATION THAT IS PROPRIETARY TO MOLEX ELECTRONIC TECHNOLOGIES, LLC AND SHOULD NOT BE USED WITHOUT WRITTEN PERMISSION				
	DIMENSION UNITS		SCALE		CURRENT REV DESC: MIGRATION TO ECTR/NX
	INCH/MM		NTS		
	GENERAL TOLERANCES (UNLESS SPECIFIED)				
		MM	INCH	EC NO: 626470	
= 0		4 PLACES ± --- ± ---	DRWN: ABENJAMINLW 2019/09/20		
= 0		3 PLACES ± --- ± 0.005	CHK'D: GROJAS01 2019/10/29		
= 0		2 PLACES ± 0.13 ± 0.01	APPR: JMACNEIL 2019/11/04		
= 0		1 PLACE ± 0.26 ± ---	INITIAL REVISION:		
= 0		0 PLACES ± --- ± ---	DRWN: JJ 1984/11/14		
= 0		ANGULAR TOL ± 0.5°	APPR:		
= 0		DRAFT WHERE APPLICABLE MUST REMAIN WITHIN DIMENSIONS	THIRD ANGLE PROJECTION	DRAWING	SERIES
				C-SIZE	19196

DOCUMENT NUMBER				DOC TYPE	DOC PART	REVISION
ACD50302				PSD	001	A
MATERIAL NUMBER		CUSTOMER		SHEET NUMBER		
SEE TABLE		GENERAL MARKET		1 OF 1		