

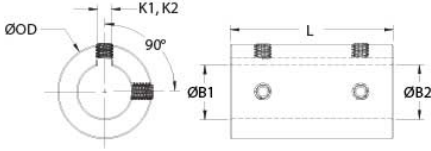

SCC-20-20-SS

Ruland SCC-20-20-SS, 1-1/4" x 1-1/4" Rigid Coupling, 303 Stainless Steel, Set Screw Style with Keyway, 2 1/16" OD, 3 1/4" Length



Description

Ruland SCC-20-20-SS is a set screw rigid coupling with 1.2500" x 1.2500" bores, 2 1/16" OD, 3 1/4" length, and 1/4" x 1/4" keyways. It has precision honed bores to ensure they are collinear and do not introduce misalignment or vibration into the system making it suitable for high precision servo applications as well as shaft to shaft connections. Forged screws test beyond ANSI standards to ensure maximum holding power. Tightly controlled bore tolerance of +.002"/+.0005" is maintained. SCC-20-20-SS is made from 303 stainless steel with hardware of like material for consistent corrosion resistance. It is machined from solid bar stock that is sourced exclusively from North American mills and is RoHS3 and REACH compliant. SCC-20-20-SS is manufactured in our Marlborough, MA factory under strict controls using proprietary processes.

Product Specifications

Bore (B1)	1.2500 in	Small Bore (B2)	1.2500 in
Keyway (K1)	1/4 in	Keyway (K2)	1/4 in
B1 Max Shaft Penetration	1.625 in	B2 Max Shaft Penetration	1.625 in
Bore Tolerance	+0.0020 in / +0.0005 in	Outer Diameter (OD)	2 1/16 in
Length (L)	3 1/4 in	Recommended Shaft Tolerance	+0.0000 in / -0.0005 in
Forged Set Screw	3/8-16	Screw Material	18-8 300 Series Stainless Steel
Hex Wrench Size	3/16 in	Screw Finish	Bright
Seating Torque	230 lb-in	Number of Screws	4 ea
Rated Torque	Rating Coming Soon	Moment of Inertia	1.4291 lb-in ²
Maximum Speed	4,000 RPM	Full Bearing Support Required?	No
Precision Honed Bores?	Yes	Zero-Backlash?	Yes
Material Specification	Type 303 Austenitic, Non-Magnetic Bar	Temperature	-40°F to 350°F (-40°C to 176°C)
Finish Specification	Bright, No Plating	Manufacturer	Ruland Manufacturing
Country of Origin	USA	Weight (lbs)	1.942700
UPC	634529076743	Tariff Code	8483.60.8000
UNSPC	31163009		

Note 1	Performance ratings are for guidance only. The user must determine suitability for a particular application.
Prop 65	⚠WARNING This product can expose you to the chemical Nickel (metallic), known to the State of California to cause cancer. For more information go to www.P65Warnings.ca.gov .

Installation Instructions

1. Align the SCC-20-20-SS set screw rigid coupling on the two shafts to be connected. There should be no misalignment.
2. Tighten the set screws in two stages, starting with the inside set screws. Using a 3/16 in torque wrench, tighten the inside set screws to 115 lb-in which is half the recommended seating torque. Repeat for the outside set screws, again tightening to half of the recommended seating torque.
3. Tighten the screws to the full recommended seating torque of 230 lb-in following the same pattern, starting with the inside set screws first.