

Product Specification



Patch Antenna JLT1575S13P4D

Feature

- High gain , Compact
- Pin type
- Customization available

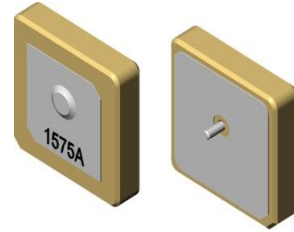

Electrical Specification

Center Frequency	1575.42± 3.0 MHz
Return Loss @ F0	≥ 15dB
Polarization	RHCP
Gain @ Zenith	-
Ground plane	30x30 mm
Impedance	50 Ω
Frequency Temperature Coefficient	±20 ppm/°C
Operation Temperature Range	-40 ~ +85°C

Mechanical Drawing

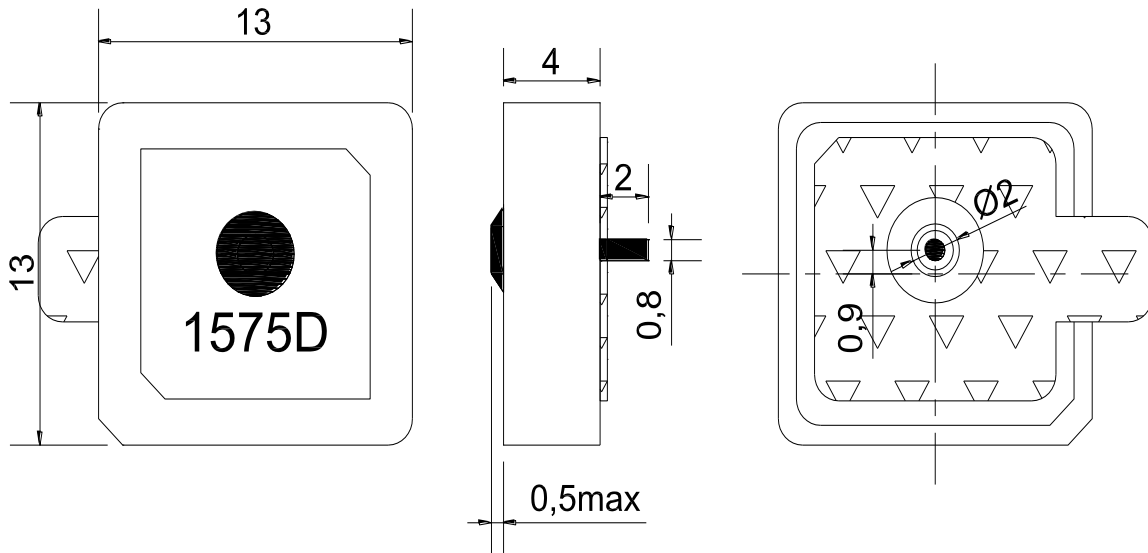

Tolerance Unless Otherwise Specified:±0.30
Unit: mm

Product Specification



Patch Antenna

JLT1575S13P4D

Test Fixture

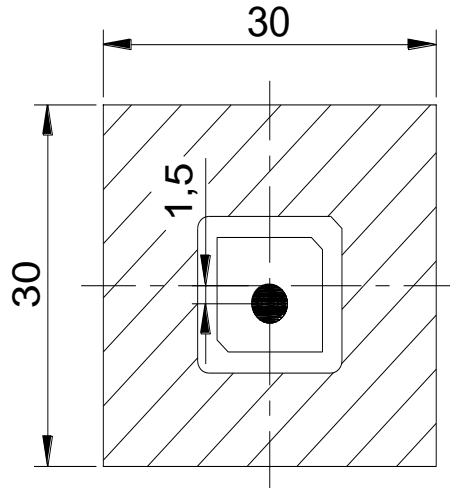

Characteristics

