

2-5PIN

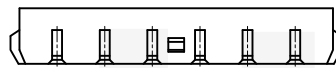

6PIN

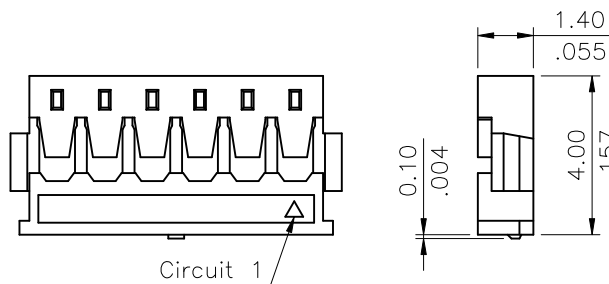
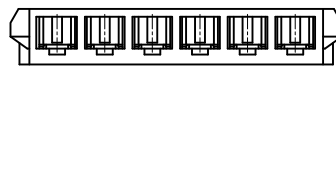
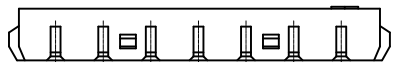
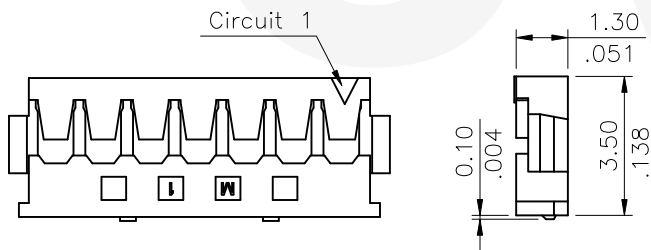
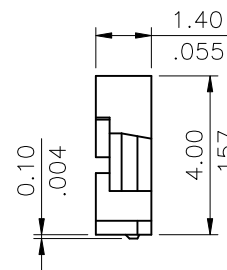

7PIN

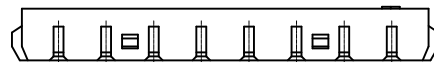
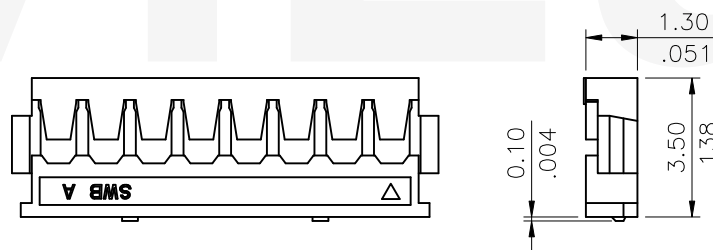
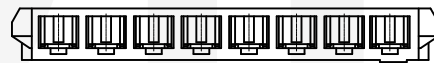

8-10PIN

Material:  
 ① \* Insulation: LCP UL 94V-0, Color Black

Ordering Code

CI63    \*\*    S    0000  
 ①    ②    ③    ④

- ① Series No.
- ② No. of Circuits: 02~10
- ③ S= Connector housing
- ④ Color option:  
0000= Black (Standard)

A = 1.20 x No. of Circuits  
 B = A + 1.9  
 C = A + 1.4

△ \* Available in 2 through 10 circuits

Halogen-Free

RoHS Compliant

④					DATE	UNIT: mm / inch	TITLE:
③						TOLERANCE UNLESS OTHERWISE SPECIFIED	1.20MM CRIMP TERMINAL HOUSING
②	Sun	7/23-18'	ECNT118172	2018.08.02 ISSUED	DRAWN BY: Sun	7/24-18'	MATERIAL:
①	Ken	10/17-17	ECNT117220/ECRB117042		ENGINEER: Sun	7/24-18'	.X ± 0.30/.012    X' ± 1'
SYM	NAME	DATE	REVISIONS		CHECKED BY: Eisley	7/27-18'	.XX ± 0.20/.008    .X' ±
					APPROVED BY: Eisley	7/27-18'	.XXX ± 0.10/.004    .XX' ±



瀚荃股份有限公司  
 CviLux Corporation

DRAWING NO.	CI6302SC	PART NO.	CI63**S0000
SCALE	5 / 1	SHEET	1 OF 1