

Combination type 1/2 protective device - FLT 60-400 - 2800107

Please be informed that the data shown in this PDF Document is generated from our Online Catalog. Please find the complete data in the user's documentation. Our General Terms of Use for Downloads are valid (<http://phoenixcontact.com/download>)



Type 1 / Class I / B arrester (lightning current arrester) with arc chopping spark gap, 1-channel. Housing width: 35 mm (2 div.)

Your advantages

- High discharge capacity
- 1-channel

Key Commercial Data

Packing unit	1 pc
GTIN	
GTIN	4046356479936

Technical data

Dimensions

Height	90 mm
Width	35.5 mm
Depth	65.5 mm
Horizontal pitch	2 Div.

Ambient conditions

Degree of protection	IP20 (only when all terminal points are used)
Ambient temperature (operation)	-40 °C ... 85 °C
Ambient temperature (storage/transport)	-40 °C ... 85 °C
Altitude	≤ 2000 m (amsl (above mean sea level))
Permissible humidity (operation)	5 % ... 95 %

General

IEC test classification	I
	T1

Combination type 1/2 protective device - FLT 60-400 - 2800107

Technical data

General

EN type	T1
IEC power supply system	TN-S
	TN-C
	TT
Mode of protection	L-PEN
Mounting type	DIN rail: 35 mm
Color	black
Housing material	PA 6.6
Degree of pollution	2
Flammability rating according to UL 94	V-0
Type	DIN rail module, one-piece
Number of positions	1
Surge protection fault message	none

Protective circuit

Nominal voltage U_N	230/400 V AC (TN)
	230/400 V AC (TT)
Nominal frequency f_N	50 Hz (60 Hz)
Maximum continuous operating voltage U_C (L-PEN)	400 V AC
Rated load current I_L	80 A
Residual current I_{PE}	< 0.1 mA
Standby power consumption P_C	≤ 40 mVA
Nominal discharge current I_n (8/20) μ s (L-PEN)	60 kA
Impulse discharge current (10/350) μ s (L-PEN), charge	30 As
Impulse discharge current (10/350) μ s (L-PEN), specific energy	900 kJ/ Ω
Impulse discharge current (10/350) μ s (L-PEN), peak current value I_{imp}	60 kA
Follow current interrupt rating I_{fi} (L-PEN)	2.5 kA
Short-circuit current rating I_{SCCR}	2.5 kA
Voltage protection level U_p (L-PEN)	≤ 5 kV
Front of wave sparkover voltage at 6 kV (1.2/50) μ s	≤ 5 kV
TOV behavior at U_T (L-PEN)	440 V AC (5 s / withstand mode)
	440 V AC (120 min / withstand mode)
Response time t_A (L-PEN)	≤ 100 ns
Max. backup fuse with V-type through wiring	80 A AC (gG)
Max. backup fuse with branch wiring	500 A AC (gG)

Connection data

Connection method	Screw connection
Screw thread	M6
Tightening torque	8 Nm
Stripping length	17 mm

Combination type 1/2 protective device - FLT 60-400 - 2800107

Technical data

Connection data

Conductor cross section flexible min.	16 mm ²
Conductor cross section flexible max.	35 mm ²
Conductor cross section solid min.	10 mm ²
Conductor cross section solid max.	50 mm ²
Conductor cross section AWG	6 ... 1

Standards and Regulations

Standards/regulations	IEC 61643-11 2011
	EN 61643-11 2012

Environmental Product Compliance

China RoHS	Environmentally friendly use period: unlimited = EFUP-e
	No hazardous substances above threshold values

Drawings

Dimensional drawing

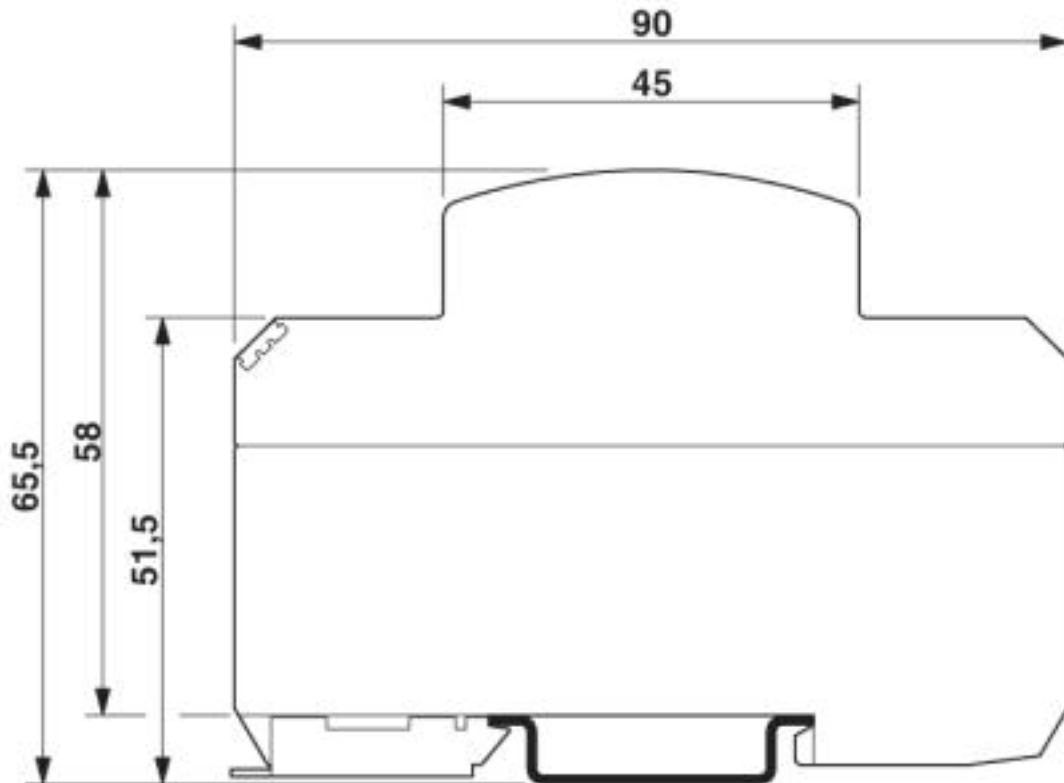

Combination type 1/2 protective device - FLT 60-400 - 2800107

Circuit diagram



Approvals

Approvals

Approvals

EAC

Ex Approvals

Approval details

EAC		RU C- DE.A*30.B01561
-----	--	-------------------------

Phoenix Contact 2019 © - all rights reserved
<http://www.phoenixcontact.com>

PHOENIX CONTACT GmbH & Co. KG
Flachsmarktstr. 8
32825 Blomberg
Germany
Tel. +49 5235 300
Fax +49 5235 3 41200
<http://www.phoenixcontact.com>