

THIS DRAWING IS UNPUBLISHED. RELEASED FOR PUBLICATION
 © COPYRIGHT 20 BY - ALL RIGHTS RESERVED.

RECOMMANDATION DECOUPE PANNEAU
 RECOMMENDED PANEL CUTOUT

VUE DE DESSUS / VIEW FROM TOP

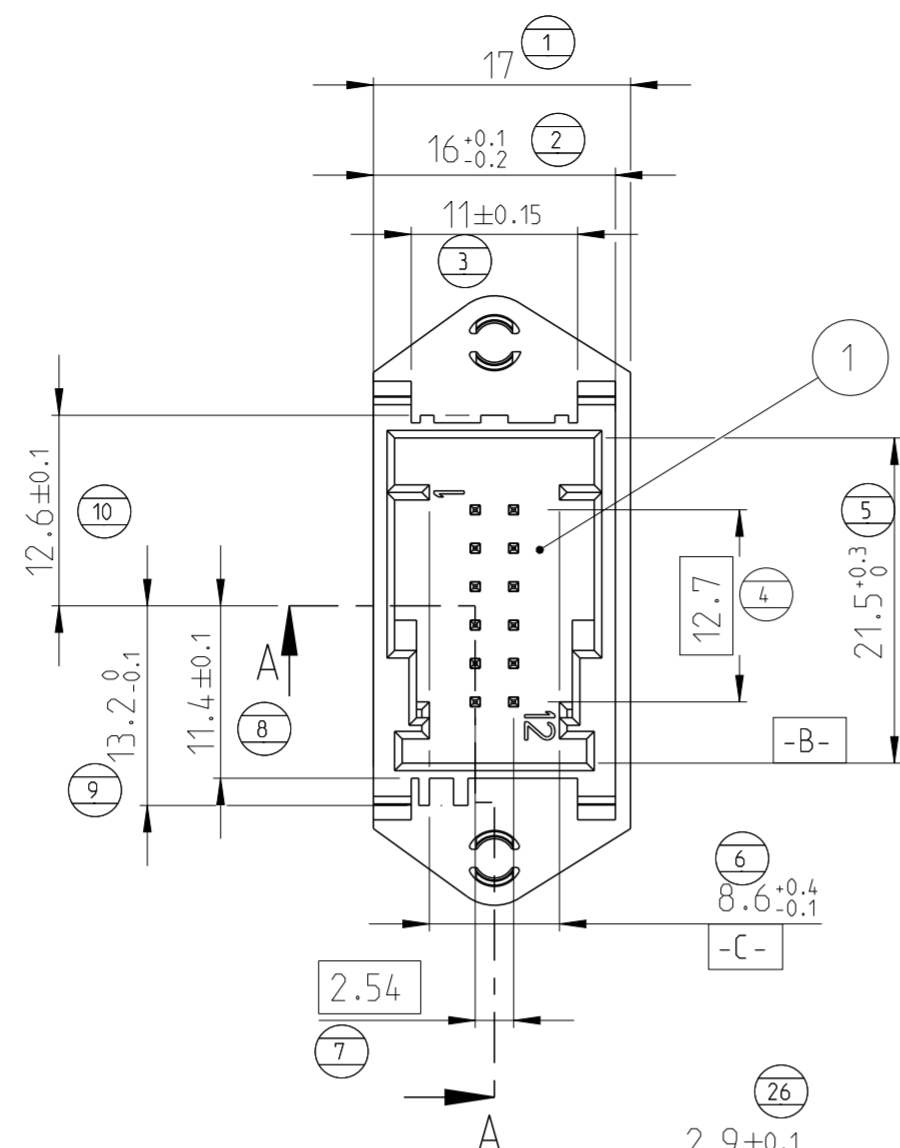
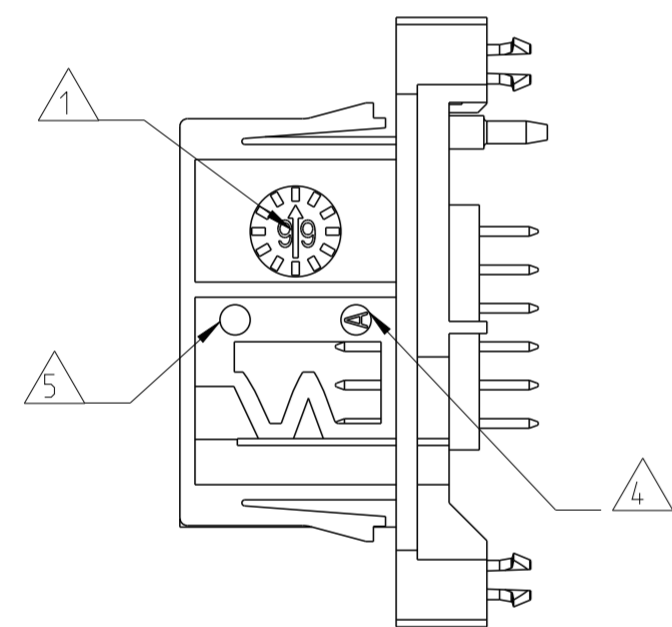
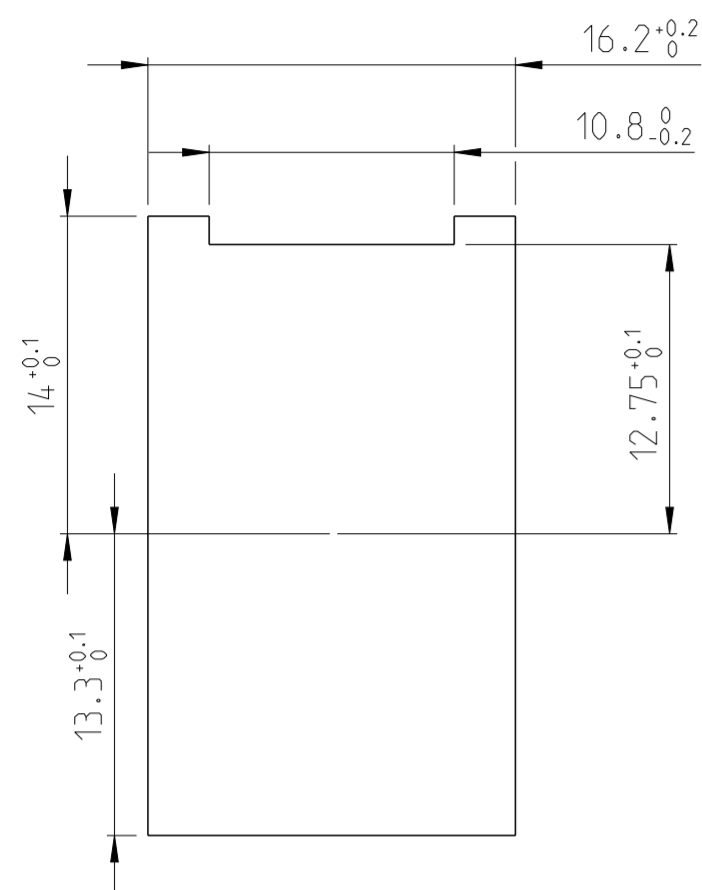

SEE DETAIL B
 (VOIR DETAIL)

DETAIL B
 SCALE 4:1
 (ECHELLE)

SECTION A-A
 (COUPE)

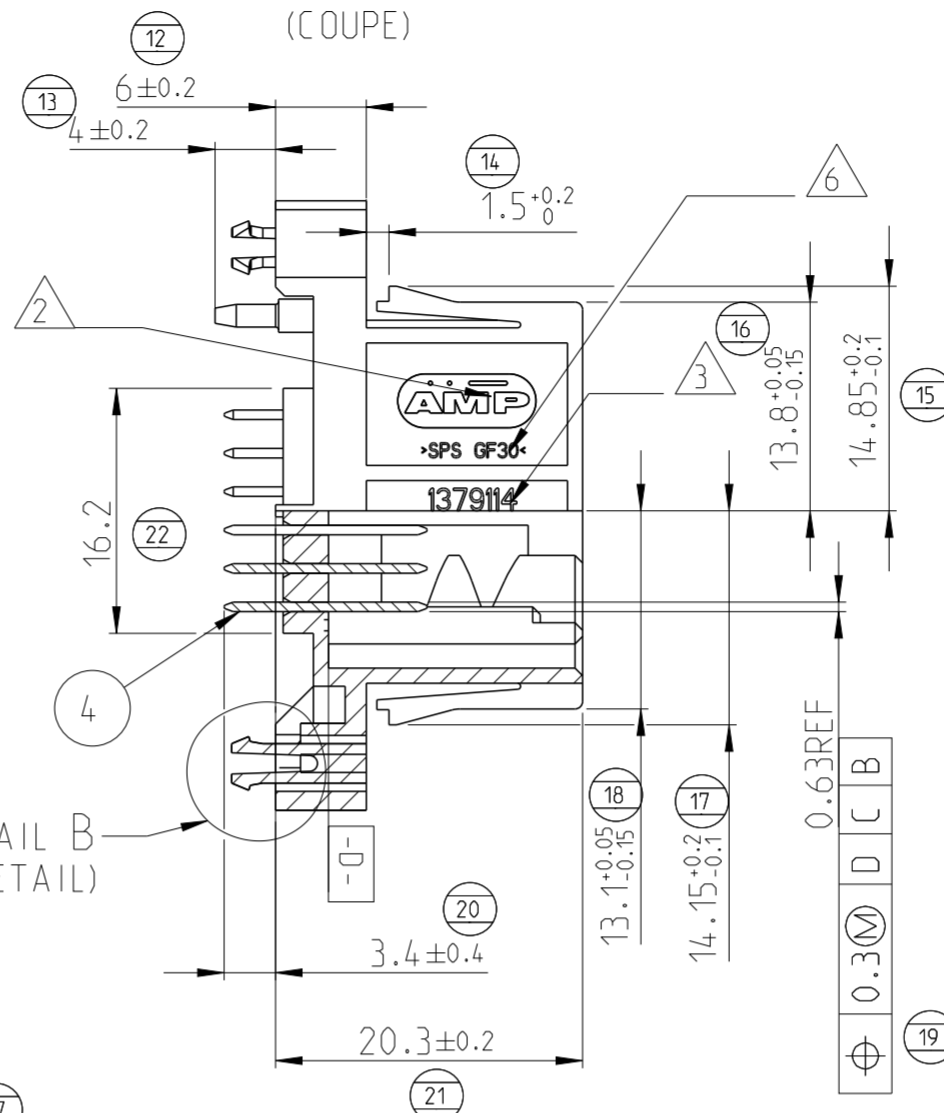

REVISIONS				
P	LTR	DESCRIPTION	DATE	APVD
A		ADD INFORMATION - UPDATED	03NOV2000	JL JLQ
B		CHANGE SPS MATERIAL	10OCT2001	SG JLQ
C		MODIFY MATERIAL TYPE IN TABLE	27FEB2009	SG JL
D		NEW P/N 1-1379114-1 FOR SPECIFIC PACKAGING	21JAN2015	NT.N JL

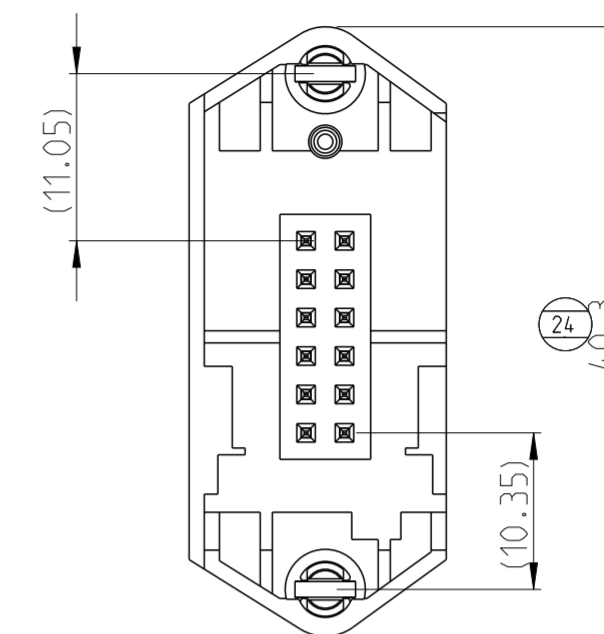

- 1 DATE CODE
- 2 TE LOGO
LOGO DE TE
- 3 ASSY PART NUMBER
REFERENCE DU PRODUIT ASSEMBLE
- 4 REVISION STATUS
REVISION DU MOULE
- 5 CAVITY MARKING
N° D'EMPREINTE DU MOULE
- 6 NO CONTRACTUAL MARKING
MARQUAGE NON CONTRACTUEL
- 7 MATING PART :
CONNECTORS PN 185341 AND 185343
CONTRE PARTIE :
CONNECTEURS REF 185341 AND 185343

RECOMMANDATION IMPLANTATION CI
 RECOMMENDED PCB DETAILS

VUE DE DESSUS / VIEW FROM TOP

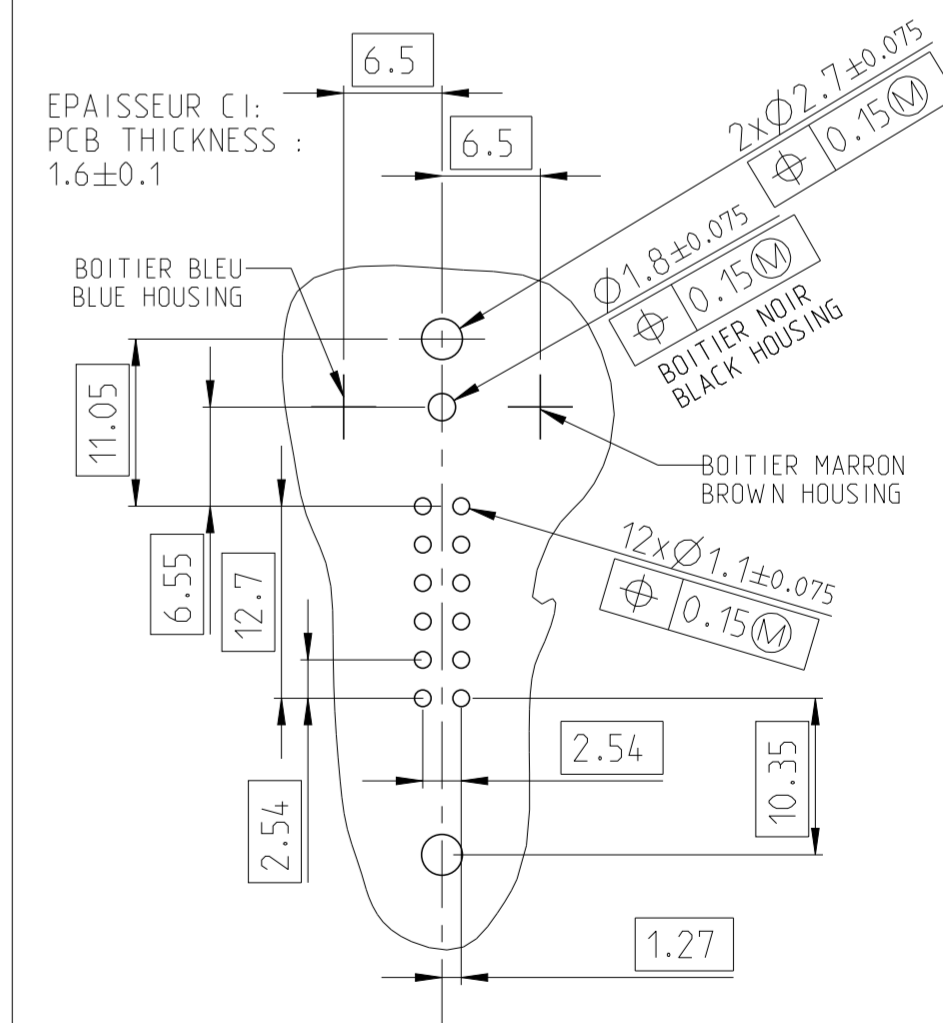

DETROMPAGES / CODINGS

SCALE 1:1
 (ECHELLE)

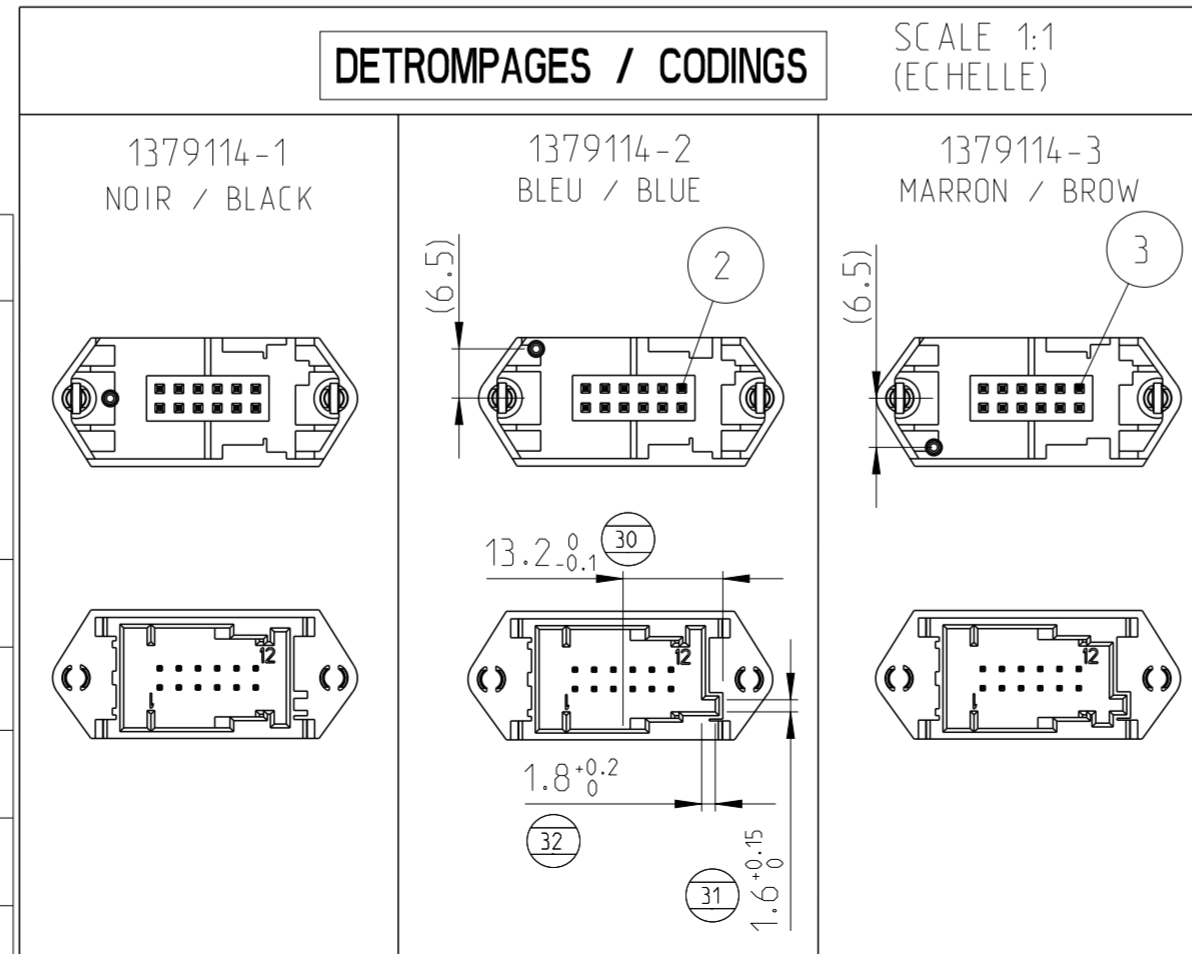

REF / ASSY PN	QTY	MATERIAL	DESIGNATION / NAME	COULEUR / COLOR	REP.
1379114-1	12	CuSn6	CONTACT MQS 0.63x0.63	POST ETAME / POST TIN	4
1379114-2	-	SPS GF20	BOITIER / HOUSING	MARRON / BROWN	3
1379114-3	-	SPS GF20	BOITIER / HOUSING	BLEU / BLUE	2
1-1379114-1	1	SPS GF20	BOITIER / HOUSING	NOIR / BLACK	1
D PACKAGING SPECIFIC IN TRAY WITH STRAP CONDITIONNEMENT EN PLATEAU SPECIFIQUE AVEC COURROIE					

THIS DRAWING IS A CONTROLLED DOCUMENT.

DIMENSIONS:
 mm

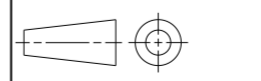

MATERIAL

TOLERANCES UNLESS OTHERWISE SPECIFIED:
 P-PLC ± -
 F-PLC ± -
 S-PLC ± 0.3
 B-PLC ± -
 H-PLC ± -
 ANGLES ± 5°
 FINISH SEE TABLE

DWN	J. DREUX	25APR2000
CHK	J. LAQUERRE	25APR2000
APVD	JJ. REVIL	25APR2000
PRODUCT SPEC	108-15180	
APPLICATION SPEC		
WEIGHT	3.7 g	
Customer Drawing		

STE TE Connectivity

12W MQS HEADER
 WITH /WITHOUT BOARD-LOCKS
 EMBASE 12V MQS AVEC /SANS B-LOCKS

SIZE	A2	CAGE CODE		DRAWING NO	1379114	RESTRICTED TO
SCALE	2:1	SHEET	1	OF	1	REV D