

- 1
- 2
- 3
- 4
- 5
- 6
- 7
- 8
- 9
- 10
- 11
- 12
- 13
- 14
- 15
- 16
- 17
- 18

**MATERIAL**

Glass-fibre reinforced polyamide based (PA) technopolymer, RAL 5005 blue colour, matte finish.

Produced from FDA compliant raw material (FDA CFR.21 and EU 10/2011).

**MOUNTING**

Threaded blind hole.

**FEATURES AND APPLICATIONS**

The RAL 5005 blue colour is easily visible in case of accidental food contamination.

Particularly suitable for applications in the food and pharmaceutical industries.



ELESA Original design

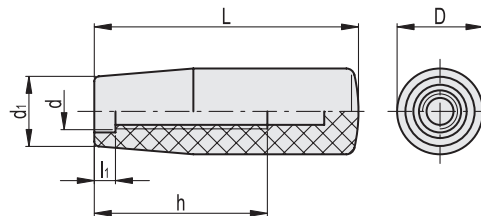

Conversion Table	
1 mm = 0.039 inch	
L	
mm	inch
80	3.15

METRIC

Code	Description	D	L	d	d1	h	l1	⚖️
194307	I.780/80-M10-VD	26.5	80	M10	21	55	7	45

Fixed & Revolving handles