

CODINGS  
SCALE 4:1

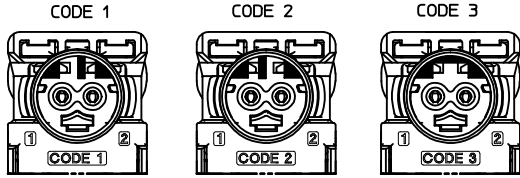

CONNECTOR IN DELIVERY CONDITION  
PRE-LOCKED CPA

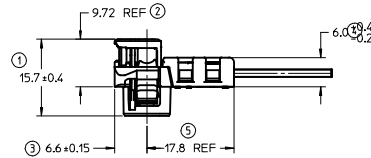

CONNECTOR IN MATED CONDITION  
LOCKED CPA

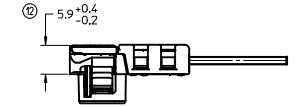

NOTES:

1. MATERIALS: SEE COMPONENT TABLE.
2. FINISHES: SEE COMPONENT TABLE.
3. APPLICATION SPECIFICATION: AS-98853-001.
4. PERFORMANCE SPECIFICATION:  
ISO/FDIS 19072-2:2007(E), DATE: 2007-MAR-15-PARTIAL.
5. PACKAGING SPECIFICATION: PK-98853-002.
6. CONNECTOR MATES TO INTERFACE DEFINED BY:  
USCAR DRAWING 999-U-002-1-Z03, REV. A00, DATE: 2007-AUG-24,  
ISO/TS 19072-4:2009(E), DATED: 2009-JUL-21.  
POCKET DEFINED BY:  
USCAR DRAWING 999-U-002-1-Z02, REV. 03, DATE: 2006-JAN-16,  
ISO/DIS 19072-1:2007(E), DATE: 2007-MAR-15.
7. AREA FOR MARKING AFTER ELECTRICAL TEST:  
TESTING DATE IN FORM: DD-MM-YY  
TESTING TIME IN FORM: HH:MM  
AND HARNESS REVISION.
8. OPTIONAL CABLE TYPES:  
FLRY-A, 19-STRANDS, OD=Ø15±0.1  
FLRY, 7-STRANDS, OD=Ø15±0.1  
JACKETED CABLE: FLRYWYW-A, 2 X 0.50MM±2, TWIST LENGTH: 40±5.0.
9. OPTIONAL CABLE COLOR AND LENGTH AS REQUIRED FOR APPLICATION.
10. FINISHED GOOD MATERIAL NUMBER ASSIGNED TO HARNESS ASSEMBLY WHICH INCLUDES DEFINED CONNECTOR AND ASSEMBLED CABLE. REFER TO APPROPRIATE DOCUMENT FOR DETAILED HARNESS ASSEMBLY SPECIFICATION.

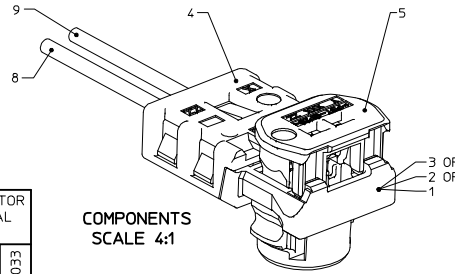
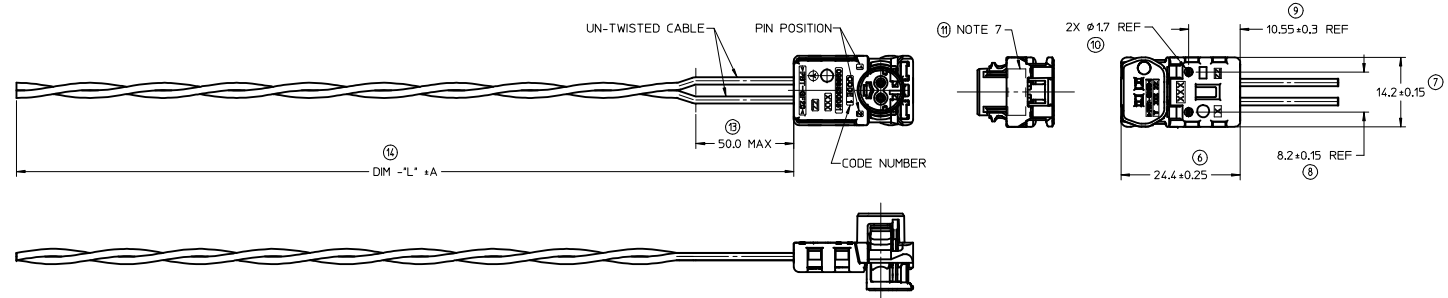

COMPONENTS  
SCALE 4:1

HARNESS MATERIAL NO.	CODE	DIM. L	TOL. A	PIN POS.	CABLE COLOR	CABLE TYPE	HARNESS WEIGHT
988538133	3	1000	±20	1	BROWN-ORANGE	FLRY-A	16.08 g
				2	BLACK-ORANGE		
988538032	2	1000	±20	1	BROWN-ORANGE	FLRY-A	16.08 g
				2	BLACK-ORANGE		
988537931	1	1000	±20	1	BROWN-ORANGE	FLRY-A	16.08 g
				2	BLACK-ORANGE		

COMPONENTS TABLE

ITEM	TITLE	TYPE AND MATERIAL	QTY	1	2	3	COLOUR
10	FERRITE	CIRCUIT = 2	1	X	X	X	GREY
9	CABLE	FLRY, 2x0.50sqmm, OD=Ø150±0.10	1	-	-	-	SEE NOTE 9
8			1	-	-	-	
7	REC. TERMINAL	COPPER ALLOY;	1	X	X	X	---
6		GOLD PLATED, 0.5 MICROMETER MIN.	1	X	X	X	---
5	CPA	PBT, 20% GLASS FILLED	1	X	X	X	ORANGE
4	COVER	PBT, 20% GLASS FILLED	1	X	X	X	YELLOW
3	HOUSING	CODE 3; PBT, 20% GLASS FILLED	1	-	-	X	YELLOW
2	HOUSING	CODE 2; PBT, 20% GLASS FILLED	1	-	X	-	LIGHT-GREEN
1	HOUSING	CODE 1; PBT, 20% GLASS FILLED	1	X	-	-	BLACK

CONNECTOR MATERIAL NUMBER
988538881
988530032
988530033

LAST INSPECTION NUMBER: 14

SCALE 1:1

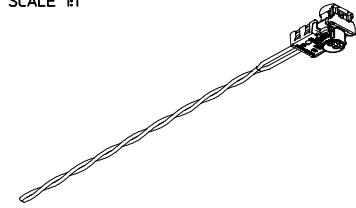

<p>ORIGINAL RELEASE EC NO: CPG2012-1798 DRAWN:HEMARTINEZ 2012/05/31 CHKD:JPAWLICKI 2012/05/31 APPR:KMONROE 2012/06/22</p>	<p>QUALITY SYMBOLS V=0 V=0 V=0</p>	<p>GENERAL TOLERANCES (UNLESS SPECIFIED)</p> <table border="1"> <thead> <tr> <th></th> <th>mm</th> <th>INCH</th> </tr> </thead> <tbody> <tr> <td>4 PLACES</td> <td>±---</td> <td>±---</td> </tr> <tr> <td>3 PLACES</td> <td>±---</td> <td>±---</td> </tr> <tr> <td>2 PLACES</td> <td>±0.05</td> <td>±---</td> </tr> <tr> <td>1 PLACE</td> <td>±0.1</td> <td>±---</td> </tr> <tr> <td>0 PLACE</td> <td>±---</td> <td>±---</td> </tr> </tbody> </table>		mm	INCH	4 PLACES	±---	±---	3 PLACES	±---	±---	2 PLACES	±0.05	±---	1 PLACE	±0.1	±---	0 PLACE	±---	±---	<p>DIMENSION STYLE IN/MM</p>	<p>SCALE 2:1</p>	<p>DESIGN UNITS METRIC</p>	<p>THIRD ANGLE PROJECTION</p>
			mm	INCH																				
		4 PLACES	±---	±---																				
		3 PLACES	±---	±---																				
2 PLACES	±0.05	±---																						
1 PLACE	±0.1	±---																						
0 PLACE	±---	±---																						
<p>DRAFT WHERE APPLICABLE MUST REMAIN WITHIN DIMENSIONS</p>	<p>ANGULAR ±1/2°</p>	<p>DRAWN BY HEMARTINEZ 2012/05/31</p>	<p>DATE 2012/05/31</p>	<p>TITLE SQUIB II RA AK-2 CONN HARNESS ASSY 0.50MM2 CABLE</p>	<p>MATERIAL NO. SD-98853-013</p>	<p>SHEET NO. 1 OF 1</p>																		
<p>THIS DRAWING CONTAINS INFORMATION THAT IS PROPRIETARY TO MOLEX INCORPORATED AND SHOULD NOT BE USED WITHOUT WRITTEN PERMISSION</p>	<p>SEE TABLE</p>	<p>APPROVED BY KMONROE 2012/06/22</p>	<p>DATE 2012/06/22</p>	<p>MOLEX</p>	<p>DOCUMENT NO.</p>	<p>1 OF 1</p>																		