

SCALE 5:1

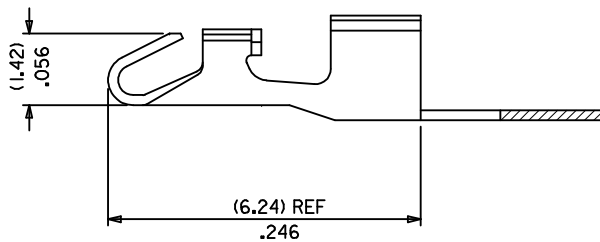

NOTES.

1. MATERIAL: (0.20)/.008 PHOSPHOR BRONZE
2. PLATING: HOT TIN DIP
3. TERMINAL WILL ACCOMMODATE
22 AWG SOLID OR FUSED WIRE
24 AND 26 AWG SOLID, STRANDED OR FUSED WIRE
WITH (1.52)/.060 MAX. INSULATION DIA.
4. P.C.B. MOUNTING HOLE:
22 AWG DIA (1.23/1.30)-.048/.051
24 AND 26 AWG DIA (1.17/1.25)-.046/.049
5. MAX. P.C.B. THICKNESS (1.19±0.20)/.047±.008

UPDATED BORDER EC NO: E2007-0844 DRWN:DMAHER CHKD: APPR:EFOLAN 2007/04/05 2007/04/12 2007/04/13	DESCRIPTION REV	QUALITY SYMBOLS	GENERAL TOLERANCES (UNLESS SPECIFIED)	DIMENSION STYLE	SCALE	DESIGN UNITS	THIRD ANGLE PROJECTION																								
		$\nabla=0$ $\text{C}=0$	<table border="1"> <thead> <tr> <th></th> <th>mm</th> <th>INCH</th> </tr> </thead> <tbody> <tr> <td>4 PLACES</td> <td>± ---</td> <td>± ---</td> </tr> <tr> <td>3 PLACES</td> <td>± ---</td> <td>± .008</td> </tr> <tr> <td>2 PLACES</td> <td>± 0.20</td> <td>± .015</td> </tr> <tr> <td>1 PLACE</td> <td>± 0.38</td> <td>± ---</td> </tr> </tbody> </table>		mm	INCH	4 PLACES	± ---	± ---	3 PLACES	± ---	± .008	2 PLACES	± 0.20	± .015	1 PLACE	± 0.38	± ---	MM/IN	10:1	METRIC										
			mm	INCH																											
		4 PLACES	± ---	± ---																											
3 PLACES	± ---	± .008																													
2 PLACES	± 0.20	± .015																													
1 PLACE	± 0.38	± ---																													
	<table border="1"> <thead> <tr> <th></th> <th>mm</th> <th>INCH</th> </tr> </thead> <tbody> <tr> <td>ANGULAR</td> <td>± .5 °</td> <td></td> </tr> </tbody> </table>		mm	INCH	ANGULAR	± .5 °		<table border="1"> <tr> <td>DRAWN BY</td> <td>DATE</td> <td>TITLE</td> </tr> <tr> <td>CTOBIN</td> <td>98/07/06</td> <td>PCM CRIM TERM BRD-IN STAND ALONE 1TNL</td> </tr> <tr> <td>CHECKED BY</td> <td>DATE</td> <td></td> </tr> <tr> <td>TMAHON</td> <td>98/07/06</td> <td></td> </tr> <tr> <td>APPROVED BY</td> <td>DATE</td> <td></td> </tr> <tr> <td>MWILHITE</td> <td>98/07/06</td> <td></td> </tr> <tr> <td>MATERIAL NO.</td> <td>901980002</td> <td></td> </tr> </table>	DRAWN BY	DATE	TITLE	CTOBIN	98/07/06	PCM CRIM TERM BRD-IN STAND ALONE 1TNL	CHECKED BY	DATE		TMAHON	98/07/06		APPROVED BY	DATE		MWILHITE	98/07/06		MATERIAL NO.	901980002		MOLEX INCORPORATED DOCUMENT NO. SD-90198	SHEET NO. 2 OF 2
	mm	INCH																													
ANGULAR	± .5 °																														
DRAWN BY	DATE	TITLE																													
CTOBIN	98/07/06	PCM CRIM TERM BRD-IN STAND ALONE 1TNL																													
CHECKED BY	DATE																														
TMAHON	98/07/06																														
APPROVED BY	DATE																														
MWILHITE	98/07/06																														
MATERIAL NO.	901980002																														
		DRAFT WHERE APPLICABLE MUST REMAIN WITHIN DIMENSIONS	SIZE A3	THIS DRAWING CONTAINS INFORMATION THAT IS PROPRIETARY TO MOLEX INCORPORATED AND SHOULD NOT BE USED WITHOUT WRITTEN PERMISSION																											