

DIMENSIONING AND TOLERANCING PER ASME Y14.5M (USD STANDARDS). THIS DRAWING IS A CONTROLLED DOCUMENT.

PART NUMBER	REV	FIRST USED
1385299-1	E	854400-1
1385299-2	E	565435-5
1385299-3	E	354500-1

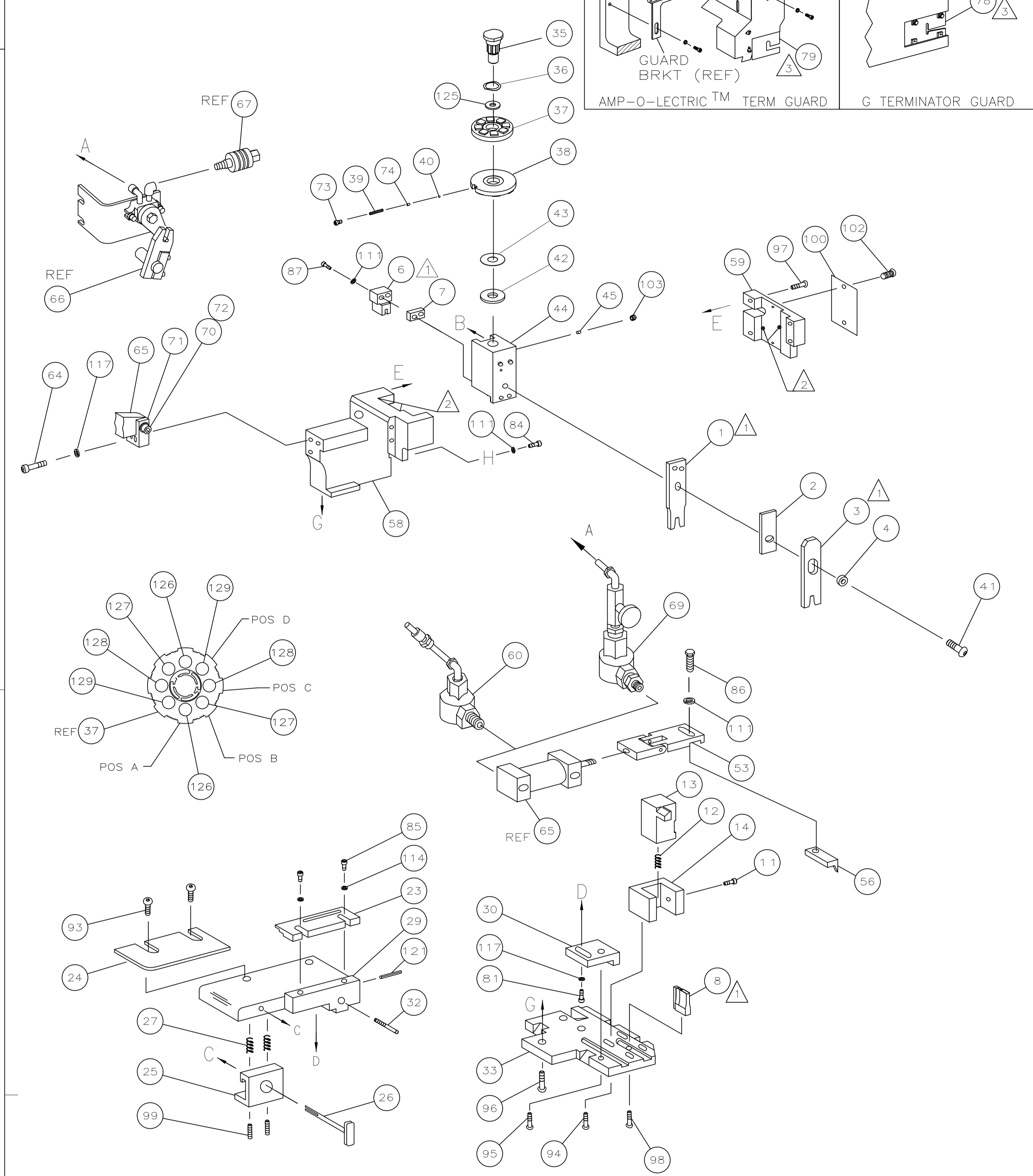

- 1 RECOMMENDED SPARE PARTS.
- 2 GREASE LIGHTLY.
- 3 GUARD MUST BE IN PLACE WHEN OPERATING APPLICATOR IN A BENCH MACHINE.
- 4 SEE DRAWING FOR COMPONENTS

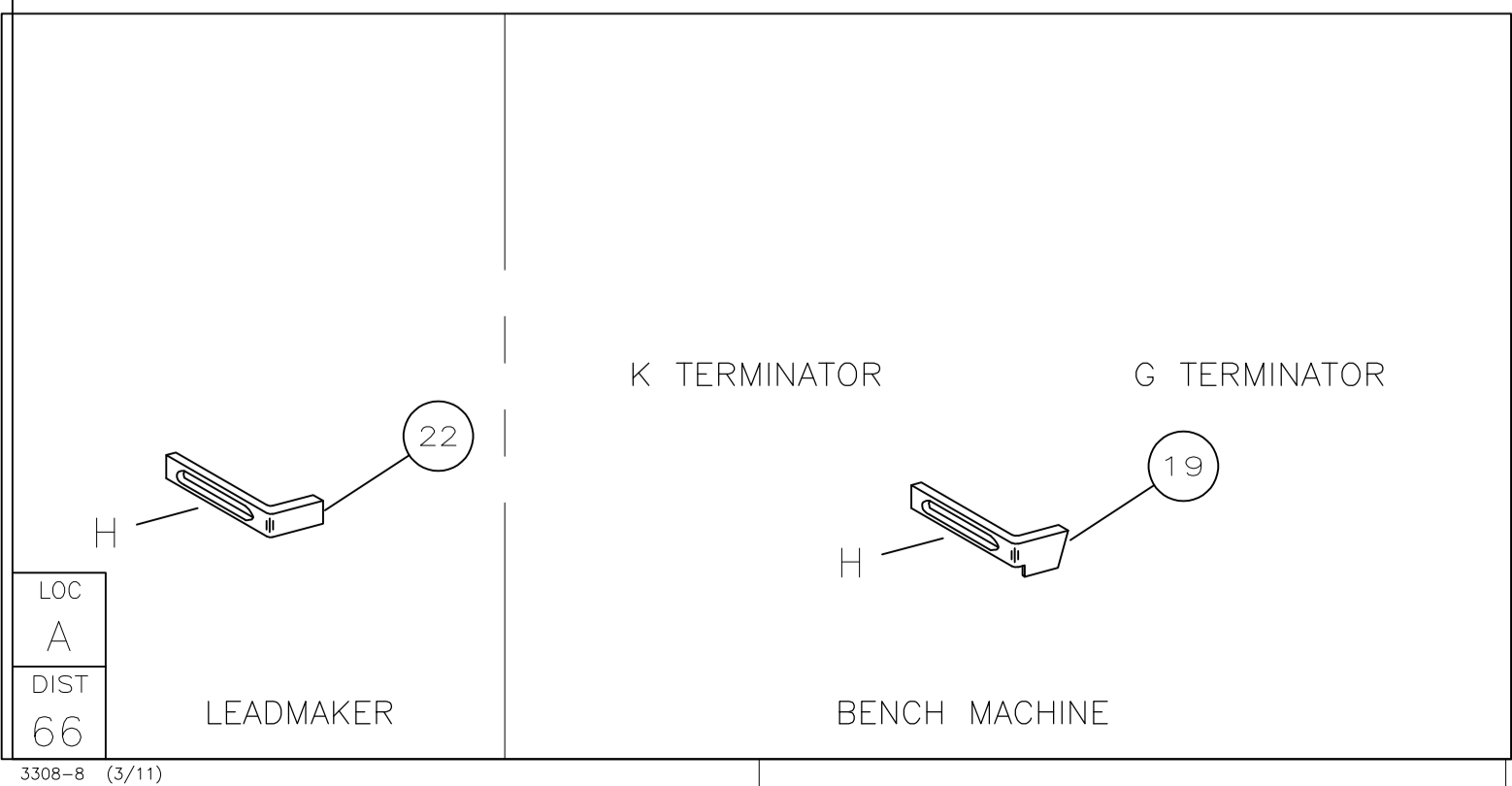

AMP PN		MFR PN		MOLEX TERMINAL		CUSTOMER CRIMP SPECS	
286984-1	08-58-0110	A	.044 ±.001 [1.12 ±0.03mm]	CRIMP HEIGHT		WIRE SIZE	
286984-2	08-58-0187	B	.0415 ±.0015 [1.045±0.025mm]	CRIMP HEIGHT		WIRE SIZE	
286984-3	08-50-0187	C	.039 ±.001 [0.99 ±0.03mm]	CRIMP HEIGHT		WIRE SIZE	
286984-4	08-52-0112	D	.037 ±.001 [0.94 ±0.03mm]	CRIMP HEIGHT		WIRE SIZE	
WIRE STRIP LENGTH		TERM APPL SPEC		FEED		APPL INSTRUCTION	
.109-.125		NONE		.280		408-8040	
INSUL		.100 [2.54mm]		0		Ø.110 MAX	
SET UP GAGE		LAYOUT		458637-1		L2562	

QTY REQD PER ASSY	REF	QTY REQD PER ASSY	REF	PART NO	DESCRIPTION	ITEM NO
2	2	2	-	5-354779-4	PIN, WIRE DISC (.3260)D	129
2	2	2	-	5-354779-0	PIN, WIRE DISC (.3240)C	128
2	2	2	-	4-354779-5	PIN, WIRE DISC (.3215)B	127
2	2	2	-	4-354779-0	PIN, WIRE DISC (.3190)A	126
1	1	1	-	986950-1	WASHER, FLAT PRECISION	125
1	1	1	-	4-21028-0	PIN,SLT SPR(Ø.093x.75)ST GDE PL	121
2	2	2	-	21024-5	WASHER, LOCK(#10)ADJ BLOCK	117
2	2	2	-	21024-2	WASHER,LOCK(#4)FRONT STP GUIDE	114
4	4	4	-	21024-4	WASHER,LOCK(#8)STRIPPER	111
1	1	1	-	21009-2	SCR,SKT SET(1/4-20x.25 LW)RAM	103
2	2	2	-	21017-2	SCR,DRIVE(#2x.19)ID PLATE	102
1	1	1	-	461264-1	PLATE, IDENTIFICATION	100
2	2	2	-	5-21006-6	SCR,SET(10-32x.75)DRAG	99
1	1	1	-	22733-8	SCR,BHC(8-32x.38 LW)ANVIL	98
4	4	4	-	2-21002-9	SCR,BHC(10-32x.75)CAP	97
3	3	3	-	2-22733-8	SCR,BHC(10-32x.62)HOUSING	96
1	1	1	-	2-21002-7	SCR,BHC(10-32x.50)ADJ BLOCK	95
2	2	2	-	2-21002-2	SCR,BHC(8-32x.50)SHEAR	94
2	2	2	-	2-21002-1	SCR,BHC(8-32x.38)R STRIP GUIDE	93
1	1	1	-	21009-2	SCR,SKT SET(1/4-20x.25 LW)RAM	103
2	2	2	-	21017-2	SCR,DRIVE(#2x.19)ID PLATE	102
1	1	1	-	461264-1	PLATE, IDENTIFICATION	100
2	2	2	-	5-21006-6	SCR,SET(10-32x.75)DRAG	99
1	1	1	-	22733-8	SCR,BHC(8-32x.38 LW)ANVIL	98
4	4	4	-	2-21002-9	SCR,BHC(10-32x.75)CAP	97
3	3	3	-	2-22733-8	SCR,BHC(10-32x.62)HOUSING	96
1	1	1	-	2-21002-7	SCR,BHC(10-32x.50)ADJ BLOCK	95
2	2	2	-	2-21002-2	SCR,BHC(8-32x.50)SHEAR	94
2	2	2	-	2-21002-1	SCR,BHC(8-32x.38)R STRIP GUIDE	93
1	1	1	-	21009-2	SCR,SKT SET(1/4-20x.25 LW)RAM	103
2	2	2	-	21017-2	SCR,DRIVE(#2x.19)ID PLATE	102
1	1	1	-	461264-1	PLATE, IDENTIFICATION	100
2	2	2	-	5-21006-6	SCR,SET(10-32x.75)DRAG	99
1	1	1	-	22733-8	SCR,BHC(8-32x.38 LW)ANVIL	98
4	4	4	-	2-21002-9	SCR,BHC(10-32x.75)CAP	97
3	3	3	-	2-22733-8	SCR,BHC(10-32x.62)HOUSING	96
1	1	1	-	2-21002-7	SCR,BHC(10-32x.50)ADJ BLOCK	95
2	2	2	-	2-21002-2	SCR,BHC(8-32x.50)SHEAR	94
2	2	2	-	2-21002-1	SCR,BHC(8-32x.38)R STRIP GUIDE	93
1	1	1	-	21009-2	SCR,SKT SET(1/4-20x.25 LW)RAM	103
2	2	2	-	21017-2	SCR,DRIVE(#2x.19)ID PLATE	102
1	1	1	-	461264-1	PLATE, IDENTIFICATION	100
2	2	2	-	5-21006-6	SCR,SET(10-32x.75)DRAG	99
1	1	1	-	22733-8	SCR,BHC(8-32x.38 LW)ANVIL	98
4	4	4	-	2-21002-9	SCR,BHC(10-32x.75)CAP	97
3	3	3	-	2-22733-8	SCR,BHC(10-32x.62)HOUSING	96
1	1	1	-	2-21002-7	SCR,BHC(10-32x.50)ADJ BLOCK	95
2	2	2	-	2-21002-2	SCR,BHC(8-32x.50)SHEAR	94
2	2	2	-	2-21002-1	SCR,BHC(8-32x.38)R STRIP GUIDE	93
1	1	1	-	21009-2	SCR,SKT SET(1/4-20x.25 LW)RAM	103
2	2	2	-	21017-2	SCR,DRIVE(#2x.19)ID PLATE	102
1	1	1	-	461264-1	PLATE, IDENTIFICATION	100
2	2	2	-	5-21006-6	SCR,SET(10-32x.75)DRAG	99
1	1	1	-	22733-8	SCR,BHC(8-32x.38 LW)ANVIL	98
4	4	4	-	2-21002-9	SCR,BHC(10-32x.75)CAP	97
3	3	3	-	2-22733-8	SCR,BHC(10-32x.62)HOUSING	96
1	1	1	-	2-21002-7	SCR,BHC(10-32x.50)ADJ BLOCK	95
2	2	2	-	2-21002-2	SCR,BHC(8-32x.50)SHEAR	94
2	2	2	-	2-21002-1	SCR,BHC(8-32x.38)R STRIP GUIDE	93
1	1	1	-	21009-2	SCR,SKT SET(1/4-20x.25 LW)RAM	103
2	2	2	-	21017-2	SCR,DRIVE(#2x.19)ID PLATE	102
1	1	1	-	461264-1	PLATE, IDENTIFICATION	100
2	2	2	-	5-21006-6	SCR,SET(10-32x.75)DRAG	99
1	1	1	-	22733-8	SCR,BHC(8-32x.38 LW)ANVIL	98
4	4	4	-	2-21002-9	SCR,BHC(10-32x.75)CAP	97
3	3	3	-	2-22733-8	SCR,BHC(10-32x.62)HOUSING	96
1	1	1	-	2-21002-7	SCR,BHC(10-32x.50)ADJ BLOCK	95
2	2	2	-	2-21002-2	SCR,BHC(8-32x.50)SHEAR	94
2	2	2	-	2-21002-1	SCR,BHC(8-32x.38)R STRIP GUIDE	93
1	1	1	-	21009-2	SCR,SKT SET(1/4-20x.25 LW)RAM	103
2	2	2	-	21017-2	SCR,DRIVE(#2x.19)ID PLATE	102
1	1	1	-	461264-1	PLATE, IDENTIFICATION	100
2	2	2	-	5-21006-6	SCR,SET(10-32x.75)DRAG	99
1	1	1	-	22733-8	SCR,BHC(8-32x.38 LW)ANVIL	98
4	4	4	-	2-21002-9	SCR,BHC(10-32x.75)CAP	97
3	3	3	-	2-22733-8	SCR,BHC(10-32x.62)HOUSING	96
1	1	1	-	2-21002-7	SCR,BHC(10-32x.50)ADJ BLOCK	95
2	2	2	-	2-21002-2	SCR,BHC(8-32x.50)SHEAR	94
2	2	2	-	2-21002-1	SCR,BHC(8-32x.38)R STRIP GUIDE	93
1	1	1	-	21009-2	SCR,SKT SET(1/4-20x.25 LW)RAM	103
2	2	2	-	21017-2	SCR,DRIVE(#2x.19)ID PLATE	102
1	1	1	-	461264-1	PLATE, IDENTIFICATION	100
2	2	2	-	5-21006-6	SCR,SET(10-32x.75)DRAG	99
1	1	1	-	22733-8	SCR,BHC(8-32x.38 LW)ANVIL	98
4	4	4	-	2-21002-9	SCR,BHC(10-32x.75)CAP	97
3	3	3	-	2-22733-8	SCR,BHC(10-32x.62)HOUSING	96
1	1	1	-	2-21002-7	SCR,BHC(10-32x.50)ADJ BLOCK	95
2	2	2	-	2-21002-2	SCR,BHC(8-32x.50)SHEAR	94
2	2	2	-	2-21002-1	SCR,BHC(8-32x.38)R STRIP GUIDE	93
1	1	1	-	21009-2	SCR,SKT SET(1/4-20x.25 LW)RAM	103
2	2	2	-	21017-2	SCR,DRIVE(#2x.19)ID PLATE	102
1	1	1	-	461264-1	PLATE, IDENTIFICATION	100
2	2	2	-	5-21006-6	SCR,SET(10-32x.75)DRAG	99
1	1	1	-	22733-8	SCR,BHC(8-32x.38 LW)ANVIL	98
4	4	4	-	2-21002-9	SCR,BHC(10-32x.75)CAP	97
3	3	3	-	2-22733-8	SCR,BHC(10-32x.62)HOUSING	96
1	1	1	-	2-21002-7	SCR,BHC(10-32x.50)ADJ BLOCK	95
2	2	2	-	2-21002-2	SCR,BHC(8-32x.50)SHEAR	94
2	2	2	-	2-21002-1	SCR,BHC(8-32x.38)R STRIP GUIDE	93
1	1	1	-	21009-2	SCR,SKT SET(1/4-20x.25 LW)RAM	103
2	2	2	-	21017-2	SCR,DRIVE(#2x.19)ID PLATE	102
1	1	1	-	461264-1	PLATE, IDENTIFICATION	100
2	2	2	-	5-21006-6	SCR,SET(10-32x.75)DRAG	99
1	1	1	-	22733-8	SCR,BHC(8-32x.38 LW)ANVIL	98
4	4	4	-	2-21002-9	SCR,BHC(10-32x.75)CAP	97
3	3	3	-	2-22733-8	SCR,BHC(10-32x.62)HOUSING	96
1	1	1	-	2-21002-7	SCR,BHC(10-32x.50)ADJ BLOCK	95
2	2	2	-	2-21002-2	SCR,BHC(8-32x.50)SHEAR	94
2	2	2	-	2-21002-1	SCR,BHC(8-32x.38)R STRIP GUIDE	93
1	1	1	-	21009-2	SCR,SKT SET(1/4-20x.25 LW)RAM	103
2	2	2	-	21017-2	SCR,DRIVE(#2x.19)ID PLATE	102
1	1	1	-	461264-1	PLATE, IDENTIFICATION	100
2	2	2	-	5-21006-6	SCR,SET(10-32x.75)DRAG	99
1	1	1	-	22733-8	SCR,BHC(8-32x.38 LW)ANVIL	98
4	4	4	-	2-21002-9	SCR,BHC(10-32x.75)CAP	97
3	3	3	-			