



LEMO USA, Inc.  
635 Park Court  
P.O. Box 2408  
Rohnert Park, CA 94927-2408

Main (707) 578-8811  
Toll Free (800) 444-5366  
Fax (707) 578-0869  
Email [info@lemousa.com](mailto:info@lemousa.com)

## PRODUCT UPDATE

Number: 083  
By: LEMO SA  
Date: February 4, 2011

### **NEW COLLETS – Size 00 to Size 3E, 3K, 3B, & 3S** **Immediate Attention Required !**

This update is to inform you that LEMO has modified various collets and will be superseding them as soon as the existing stock is depleted. The change was made for three reasons:

1. Improved collet cable size coverage range per each collet
2. Reduces the number of collets to improve manufacturing efficiency
3. Decreases inventory in the supply chain

Modifications to the collets are the slots. They were previously slanted and are now straight (see image below). This change does not impact the mechanical properties. For instance, the tightening of the collet will not be affected. Most importantly, the cable dimensions covered by the collet will change.

**See the #083 Appendix A (attached) with a list of collets that have been modified along with the NEW cable information.**

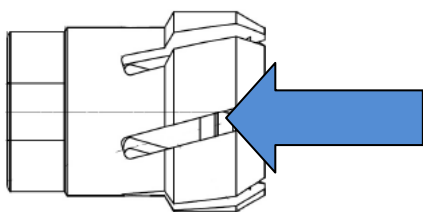

OLD

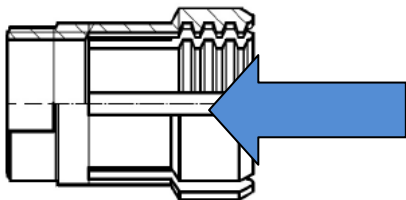

NEW

If you have any questions or concerns regarding this change, please contact Customer Service or Applications Engineering at 1-800-444-5366 or email: [info@lemousa.com](mailto:info@lemousa.com)

# Collets

## FFA.00 Series

Old	New	Cable ø	
		min.	max.
FFA.00.715.CN	FFA.00.717.CNP	1.3	1.7
FFA.00.717.CN			
FFA.00.722.CN	FFA.00.722.CNP	>1.7	2.2
FFA.00.725.CN	FFA.00.727.CNP	>2.2	2.7
FFA.00.727.CN			
FFA.00.729.CN	FFA.00.731.CNP	>2.7	3.1
FFA.00.731.CN			

## FFC.00 Series

Old	New	Cable ø	
		min.	max.
FFC.00.716.CN	FFC.00.717.CNP	1.3	1.7
FFC.00.719.CN	FFC.00.722.CNP	>1.7	2.2
FFC.00.722.CN			
FFC.00.727.CN	FFC.00.727.CNP	>2.2	2.7
FFC.00.729.CN	FFC.00.731.CNP	>2.7	3.1
FFC.00.731.CN			

## FGG.00 Series

Old	New	Cable ø	
		min.	max.
FGG.00.717.DN	FGG.00.722.DNP	1.4	2.2
FGG.00.722.DN			
FGG.00.727.DN	FGG.00.727.DNP	>2.2	2.7
FGG.00.730.DN	FGG.00.735.DNP	>2.7	3.5
FGG.00.735.DN			

## PSA.00 Series

Old	New	Cable ø	
		min.	max.
PSA.00.717.CN	PSA.00.722.CNP	1.4	2.2
PSA.00.722.CN			
PSA.00.727.CN	PSA.00.727.CNP	>2.2	2.7
PSA.00.731.CN	PSA.00.735.CNP	>2.7	3.5
PSA.00.735.CN			

## FFA.0S Series

Old	New	Cable ø	
		min.	max.
FFA.0S.717.CN	FFA.0S.722.CNP	1.3	2.2
FFA.0S.722.CN			
FFA.0S.727.CN	FFA.0S.732.CNP	>2.2	3.2
FFA.0S.732.CN			
FFA.0S.737.CN	FFA.0S.737.CNP	>3.2	3.7
FFA.0S.742.CN	FFA.0S.744.CNP	>3.7	4.4
FFA.0S.744.CN			

## FLA.0S Series

Old	New	Cable ø	
		min.	max.
FLA.0S.717.CN	FLA.0S.722.CNP	1.3	2.2
FLA.0S.722.CN			
FLA.0S.727.CN	FLA.0S.732.CNP	>2.2	3.2
FLA.0S.730.CN			
FLA.0S.732.CN			
FLA.0S.737.CN	FLA.0S.737.CNP	>3.2	3.7
FLA.0S.742.CN	FLA.0S.744.CNP	>3.7	4.4
FLA.0S.744.CN			

## FFA.0S Series

Old	New	Cable ø	
		min.	max.
FFA.0S.717.LN	FFA.0S.722.LNP	1.3	2.2
FFA.0S.722.LN			
FFA.0S.727.LN	FFA.0S.732.LNP	>2.2	3.2
FFA.0S.732.LN			
FFA.0S.737.LN	FFA.0S.737.LNP	>3.2	3.7
FFA.0S.742.LN	FFA.0S.744.LNP	>3.7	4.4
FFA.0S.744.LN			
FFA.0S.748.LN	FFA.0S.748.LNP	4.4	5.8

## FGG.0B Series

Old	New	Cable ø	
		min.	max.
FGG.0B.721.DN	FGG.0B.722.DNP	1.4	2.2
FGG.0B.725.DN	FGG.0B.732.DNP	>2.2	3.2
FGG.0B.731.DN			
FGG.0B.735.DN	FGG.0B.742.DNP	>3.2	4.2
FGG.0B.742.DN			
FGG.0B.752.DN	FGG.0B.752.DNP	>4.2	5.2
FGG.0B.756.DN	FGG.0B.756.DNP	>5.2	5.6

### FFA.0E/0K Series

Old	New	Cable ø	
		min.	max.
FFA.0E.716.CN FFA.0E.721.CN	FGG.0K.722.BNP	1.4	2.2
FFA.0E.731.CN	FGG.0K.732.BNP	>2.2	3.2
FFA.0E.742.CN FFA.0E.742.CNY FFA.0E.742.BN	FGG.0K.742.BNP	>3.2	4.2
FFA.0E.747.CN FFA.0E.747.BN FFA.0E.752.CN FFA.0E.752.BN	FGG.0K.752.BNP	>4.2	5.2

### FFA.1S Series

Old	New	Cable ø	
		min.	max.
FFA.1S.717.CN FFA.1S.722.CN	FFA.1S.722.CNP	1.2	2.2
FFA.1S.727.CN FFA.1S.732.CN	FFA.1S.732.CNP	>2.2	3.2
FFA.1S.737.CN FFA.1S.742.CN	FFA.1S.742.CNP	>3.2	4.2
FFA.1S.747.CN FFA.1S.752.CN	FFA.1S.752.CNP	>4.2	5.2
FFA.1S.757.CN FFA.1S.762.CN	FFA.1S.762.CNP	>5.2	6.2
FFA.1S.766.CN FFA.1S.768.CN	FFA.1S.768.CNP	>6.2	6.8

### FLA.1S Series

Old	New	Cable ø	
		min.	max.
FLA.1S.717.CN FLA.1S.722.CN	FLA.1S.722.CNP	1.2	2.2
FLA.1S.727.CN FLA.1S.732.CN	FLA.1S.732.CNP	>2.2	3.2
FLA.1S.737.CN FLA.1S.742.CN	FLA.1S.742.CNP	>3.2	4.2
FLA.1S.747.CN FLA.1S.752.CN	FLA.1S.752.CNP	>4.2	5.2
FLA.1S.757.CN FLA.1S.762.CN	FLA.1S.762.CNP	>5.2	6.2
FLA.1S.766.CN FLA.1S.768.CN	FLA.1S.768.CNP	>6.2	6.8

### FFA.1S Series

Old	New	Cable ø	
		min.	max.
FFA.1S.717.LN FFA.1S.722.LN	FFA.1S.722.LNP	1.2	2.2
FFA.1S.727.LN FFA.1S.732.LN	FFA.1S.732.LNP	>2.2	3.2
FFA.1S.737.LN FFA.1S.742.LN	FFA.1S.742.LNP	>3.2	4.2
FFA.1S.747.LN FFA.1S.750.LN FFA.1S.752.LN	FFA.1S.752.LNP	>4.2	5.2
FFA.1S.757.LN FFA.1S.762.LN	FFA.1S.762.LNP	>5.2	6.2
FFA.1S.766.LN	FFA.1S.766.LNP	>6.2	6.6

### FGG.1B Series

Old	New	Cable ø	
		min.	max.
FGG.1B.735.DN FGG.1B.742.DN	FGG.1B.742.DNP	2.5	4.2
FGG.1B.752.DN	FGG.1B.752.DNP	>4.2	5.2
FGG.1B.762.DN	FGG.1B.762.DNP	>5.2	6.2
FGG.1B.772.DB FGG.1B.772.DN	FGG.1B.772.DNP	>6.2	7.2
FGG.1B.776.DN	FGG.1B.776.DNP	>7.2	7.6

### FFA.1E/1K Series

Old	New	Cable ø	
		min.	max.
FFA.1E.716.CN FFA.1E.722.CN	FGG.1K.722.BNP	1.4	2.2
FFA.1E.732.CN FFA.1E.742.CN	FGG.1K.732.BNP FGG.1K.742.BNP	>2.2 >3.2	3.2 4.2
FFA.1E.752.CN FFA.1E.752.BN	FGG.1K.752.BNP	>4.2	5.2
FFA.1E.762.CN FFA.1E.762.BN	FGG.1K.762.BNP	>5.2	6.2
FFA.1E.772.CN FFA.1E.772.BN	FGG.1K.772.BNP	>6.2	7.2

### FFA.2S Series

Old	New	Cable ø	
		min.	max.
FFA.2S.717.CN	FFA.2S.727.CNP	1.3	2.7
FFA.2S.727.CN			
FFA.2S.732.CN	FFA.2S.732.CNP	>2.5	3.2
FFA.2S.737.CN	FFA.2S.742.CNP	>3.2	4.2
FFA.2S.742.CN			
FFA.2S.747.CN	FFA.2S.752.CNP	>4.2	5.2
FFA.2S.752.CN			
FFA.2S.757.CN	FFA.2S.762.CNP	>5.2	6.2
FFA.2S.762.CN			
FFA.2S.767.CN	FFA.2S.772.CNP	>6.2	7.2
FFA.2S.772.CN			
FFA.2S.777.CN	FFA.2S.782.CNP	>7.2	8.2
FFA.2S.782.CN			
FFA.2S.787.CN	FFA.2S.787.CNP	>8.2	8.7

### FLA.2S Series

Old	New	Cable ø	
		min.	max.
FLA.2S.717.CN	FLA.2S.727.CNP	1.3	2.7
FLA.2S.727.CN			
FLA.2S.732.CN	FLA.2S.732.CNP	>2.7	3.2
FLA.2S.742.CN	FLA.2S.742.CNP	>3.2	4.2
FLA.2S.747.CN	FLA.2S.752.CNP	>4.2	5.2
FLA.2S.752.CN			
FLA.2S.757.CN	FLA.2S.762.CNP	>5.2	6.2
FLA.2S.762.CN			
FLA.2S.767.CN	FLA.2S.772.CNP	>6.2	7.2
FLA.2S.772.CN			
FLA.2S.777.CN	FLA.2S.782.CNP	>7.2	8.2
FLA.2S.782.CN			
FLA.2S.787.CN	FLA.2S.787.CNP	>8.2	8.7

### FFA.2S Series

Old	New	Cable ø	
		min.	max.
FFA.2S.727.LN	FFA.2S.732.LNP	2.5	3.2
FFA.2S.732.LN			
FFA.2S.737.LN	FFA.2S.742.LNP	>3.2	4.2
FFA.2S.742.LN			
FFA.2S.747.LN	FFA.2S.752.LNP	>4.2	5.2
FFA.2S.752.LN			
FFA.2S.757.LN	FFA.2S.762.LNP	>5.2	6.2
FFA.2S.762.LN			
FFA.2S.767.LN	FFA.2S.772.LNP	>6.2	7.2
FFA.2S.772.LN			
FFA.2S.777.LN	FFA.2S.782.LNP	>7.2	8.2
FFA.2S.782.LN			
FFA.2S.787.LN	FFA.2S.787.LNP	>8.2	8.7

### FGG.2B Series

Old	New	Cable ø	
		min.	max.
FGG.2B.742.DN	FGG.2B.742.DNP	3.2	4.2
FGG.2B.748.DN	FGG.2B.752.DNP	>4.2	5.2
FGG.2B.752.DN			
FGG.2B.762.DN	FGG.2B.762.DNP	>5.2	6.2
FGG.2B.772.DN	FGG.2B.772.DNP	>6.2	7.2
FGG.2B.782.DN	FGG.2B.782.DNP	>7.2	8.2
FGG.2B.792.DN	FGG.2B.792.DNP	>8.2	9.2
FGG.2B.799.DN	FGG.2B.799.DNP	>9.2	9.9

### FFA.2E/FGG.2K Series

Old	New	Cable ø	
		min.	max.
FFA.2E.722.CN	FGG.2K.742.BNP	3.0	4.2
FFA.2E.742.CN			
FFA.2E.752.CN	FGG.2K.752.BNP	>4.2	5.2
FFA.2E.762.CN	FGG.2K.762.BNP	>5.2	6.2
FFA.2E.772.CN	FGG.2K.772.BNP	>6.2	7.2
FFA.2E.782.CN	FGG.2K.782.BNP	>7.2	8.2
FFA.2E.792.CN	FGG.2K.792.BNP	>8.2	9.2

### FFA.3S/CN Series

Old	New	Cable ø	
		min.	max.
FFA.3S.732.CN	FFA.3S.742.CNP	2.7	4.2
FFA.3S.742.CN			
FFA.3S.747.CN	FFA.3S.757.CNP	>4.2	5.7
FFA.3S.752.CN			
FFA.3S.757.CN	FFA.3S.772.CNP	>5.7	7.2
FFA.3S.762.CN			
FFA.3S.767.CN	FFA.3S.787.CNP	>7.2	8.7
FFA.3S.772.CN			
FFA.3S.782.CN	FFA.3S.797.CNP	>8.7	9.7
FFA.3S.787.CN			
FFA.3S.792.CN	FFA.3S.797.CNP	>8.7	9.7
FFA.3S.797.CN			
FFA.3S.705.CN	FFA.3S.711.CNP	>9.7	10.7
FFA.3S.710.CN			
FFA.3S.711.CN			

### FLA.3S Series

Old	New	Cable ø	
		min.	max.
FLA.3S.732.CN FLA.3S.742.CN	FLA.3S.742.CNP	2.7	4.2
FLA.3S.747.CN			
FLA.3S.752.CN FLA.3S.757.CN	FLA.3S.757.CNP	>4.2	5.7
FLA.3S.762.CN			
FLA.3S.767.CN FLA.3S.772.CN	FLA.3S.772.CNP	>5.7	7.2
FLA.3S.777.CN			
FLA.3S.782.CN FLA.3S.787.CN	FLA.3S.787.CNP	>7.2	8.7
FLA.3S.792.CN FLA.3S.797.CN			
FLA.3S.707.CN FLA.3S.710.CN FLA.3S.711.CN	FLA.3S.711.CNP	>9.7	10.7

### FFA.3S/LN Series

Old	New	Cable ø	
		min.	max.
FFA.3S.742.LN	FFA.3S.742.LNP	2.7	4.2
FFA.3S.747.LN FFA.3S.752.LN			
FFA.3S.762.LN FFA.3S.767.LN FFA.3S.772.LN	FFA.3S.772.LNP	>5.7	7.2
FFA.3S.777.LN			
FFA.3S.782.LN FFA.3S.787.LN			
FFA.3S.792.LN FFA.3S.797.LN	FFA.3S.797.LNP	>8.7	9.7
FFA.3S.710.LN FFA.3S.711.LN			

### FGG.3B Series

Old	New	Cable ø	
		min.	max.
FGG.3B.762.DN FGG.3B.772.DN	FGG.3B.772.DNP	>6.2	7.7
FGG.3B.782.DN			
FGG.3B.792.DN FGG.3B.793.DN	FGG.3B.792.DNP	>7.7	9.2
FGG.3B.710.DN			
FGG.3B.711.DN FGG.3B.712.DN	FGG.3B.712.DNP	>10.7	11.9

### FFA.3E/FGG.3K Series

Old	New	Cable ø	
		min.	max.
FFA.3E.732.CN FFA.3E.742.CN	FGG.3K.742.BNP	2.7	4.2
FFA.3E.752.CN			
FFA.3E.762.CN FFA.3E.772.CN	FGG.3K.772.BNP	>5.7	7.2
FFA.3E.782.CN			
FFA.3E.792.CN FFA.3E.710.CN	FGG.3K.710.BNP	>8.7	10.2
FFA.3E.711.CN FFA.3E.712.CN			