

Description: 0.283" Right Angle / Machined

Dimensions (inch/mm)

Pins	A	B	C	D	E	F
9	1.213	0.984	0.665	0.327	0.240	0.492
	30.80	25.00	16.90	8.30	6.10	12.50
15	1.543	1.311	0.994	0.327	0.240	0.492
	39.20	33.30	25.25	8.30	6.10	12.50
25	2.089	1.852	1.533	0.327	0.240	0.492
	53.05	47.05	38.95	8.30	6.10	12.50

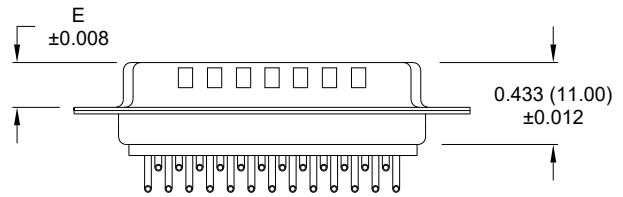
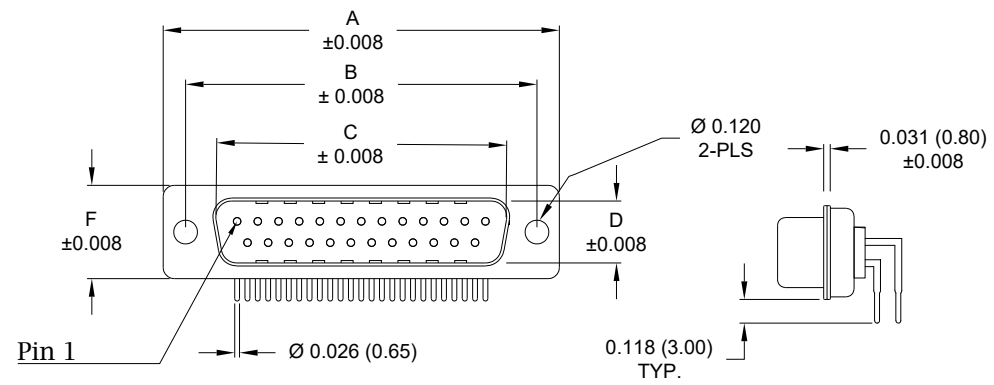

Meets IP67 Standards  
(See page 3 for sealing details)

**Material:**

- Shell: Nickel Plated Steel
- Insulator: Glass-Filled Nylon Thermoplastic, UL94 V-0
- Process Temperature: 260°C
- Contact: Precision Machined Copper Alloy
- Seal: Flexible F08 Adhesive

**Electrical:**

- Current Rating: 5 AMPS
- Contact Resistance: 10 mOhms Max.
- Insulation Resistance: 5 GOhms Min.
- Working Voltage: 250V
- Temperature: -55° C TO +125° C

773- EYY- 11Y RYY 1

- Series**
- Position**  
E09  
E15  
E25
- Gender**  
1 = Male
- Termination**  
1 = PCB Mounting
- Shell Plating**  
3 = Nickel
- RoHS Compliant**
- Hardware Options**  
00 = No Hardware  
01 = 0.065" Clinch Nut (Board Side)  
0A = 0.098" Clinch Nut (Board Side)  
14 = Standard Bracket with 4-40 Screwlock  
46 = Boardlock Bracket with 4-40 Insert
- Plating Options**  
1 = Gold Flash  
2 = 30µ" Gold

RoHS COMPLIANT

UNITS = inch [mm]

DO NOT SCALE FROM DRAWING



THESE DRAWINGS AND SPECIFICATIONS ARE THE PROPERTY OF NorComp AND SHALL NOT BE REPRODUCED, COPIED OR USED AS THE BASIS FOR THE MANUFACTURE OR SALE OF APPARATUS WITHOUT WRITTEN PERMISSION.

DRAWN:  
Pam Jenkins  
DATE:  
06/29/2009

NorComp

SCALE: NTS SHEET 1 OF 4 REV 17  
DWG NO. 773-EYY-11Y RYY 1

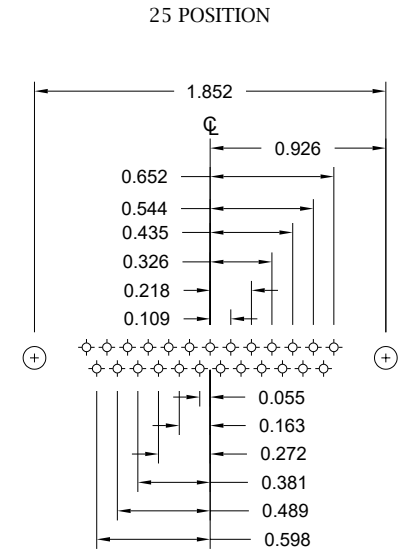
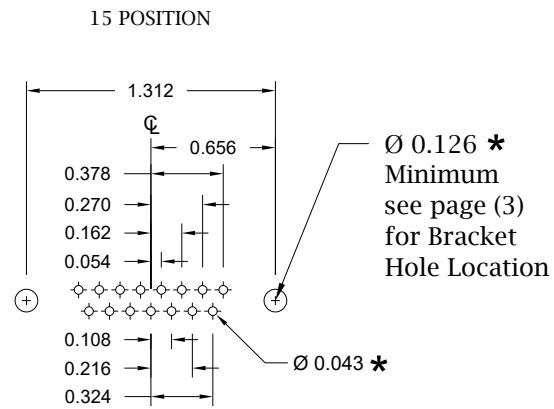
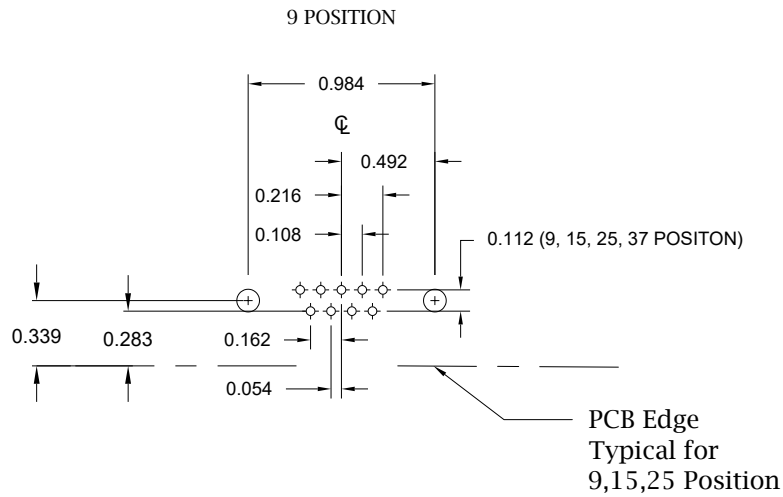

UNITS = inch

\* Typical Suggested Size  
 May Not Be Suitable For All Applications

RoHS COMPLIANT

DO NOT SCALE FROM DRAWING



THESE DRAWINGS AND SPECIFICATIONS ARE THE PROPERTY OF NorComp AND SHALL NOT BE REPRODUCED, COPIED OR USED AS THE BASIS FOR THE MANUFACTURE OR SALE OF APPARATUS WITHOUT WRITTEN PERMISSION.

DRAWN:  
 Pam Jenkins

DATE:  
 06/29/2009

NorComp

SCALE:  
 NTS

SHEET OF  
 2 4

REV  
 17

DWG NO.

773-EYY-11YRY1

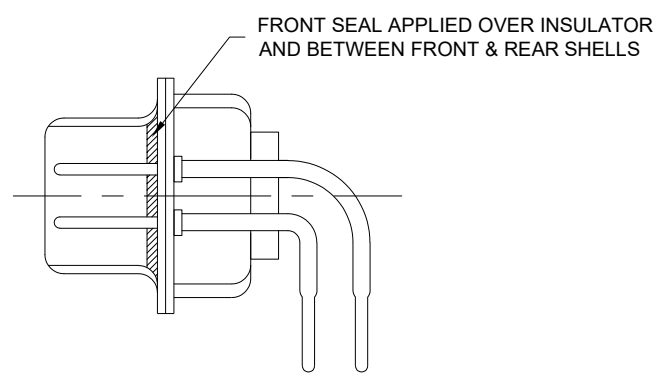
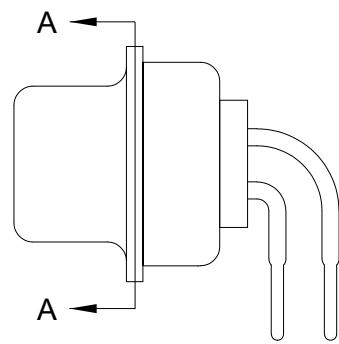

DETAIL A-A

RoHS COMPLIANT

DO NOT SCALE FROM DRAWING



THESE DRAWINGS AND SPECIFICATIONS ARE THE PROPERTY OF NorComp AND SHALL NOT BE REPRODUCED, COPIED OR USED AS THE BASIS FOR THE MANUFACTURE OR SALE OF APPARATUS WITHOUT WRITTEN PERMISSION.

DRAWN:  
Pam Jenkins  
DATE:  
06/29/2009

NorComp

SCALE: NTS	SHEET 3 OF 4	REV 17
DWG NO. 773-EYY-11YRYY1		

**01 Hardware Option**  
0.065" Clinch Nut (Board Side)

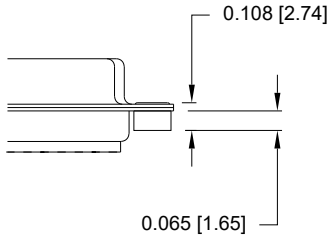

Clinch Nut has 4-40 Internal Threads

**0A Hardware Option**  
0.098" Clinch Nut (Board Side)

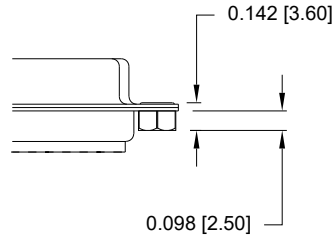

Clinch Nut has 4-40 Internal Threads

14 Hardware Option		
	Description	NorComp Part Number
1	4-40 Screwlock	SFSO4401NR
2	Bracket	K501CZ
3	Lock Washer	LW1T
4	4-40 Nut	N4401N

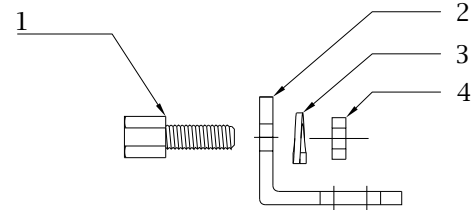

\*\*Search Hardware Part Number To Obtain Technical Specifications.

**46 Hardware Option**  
Boardlock Bracket and 4-40 Insert

#4-40 Threaded Insert

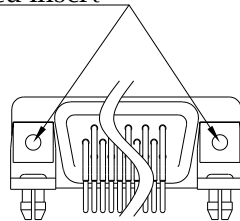

9-25 Position Connector Boardlock Bracket

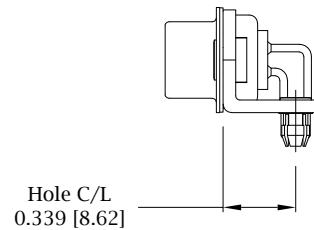

Boardlock Brackets Come Assembled On Connector

Recommend max torque for all options => 40 in-oz

RoHS COMPLIANT



THESE DRAWINGS AND SPECIFICATIONS ARE THE PROPERTY OF NorComp AND SHALL NOT BE REPRODUCED, COPIED OR USED AS THE BASIS FOR THE MANUFACTURE OR SALE OF APPARATUS WITHOUT WRITTEN PERMISSION.

DRAWN:  
**Pam Jenkins**  
DATE:  
**06/29/2009**

UNITS = inch [mm]

DO NOT SCALE FROM DRAWING

**NorComp**

SCALE: NTS	SHEET 4	OF 4	REV 17
---------------	------------	---------	-----------

DWG NO. **773-EYY-11YRY1**