

REV.	ECN NO.	DATE	SIGN	DESCRIPTION

ALTW
DCC. DEPT.
CONFIDENTIAL
2012-04-25
ISSUED

ALTW
CONFIDENTIAL
2012-04-05
R&D DEPT.

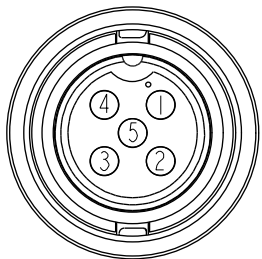
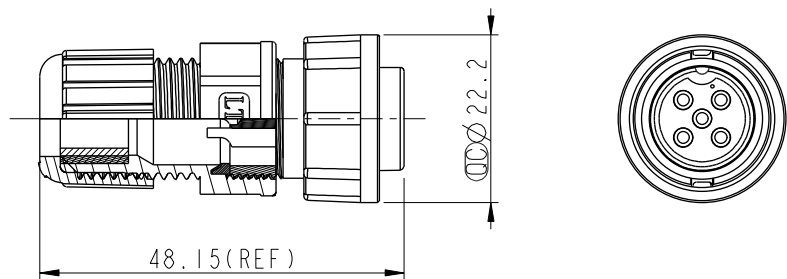
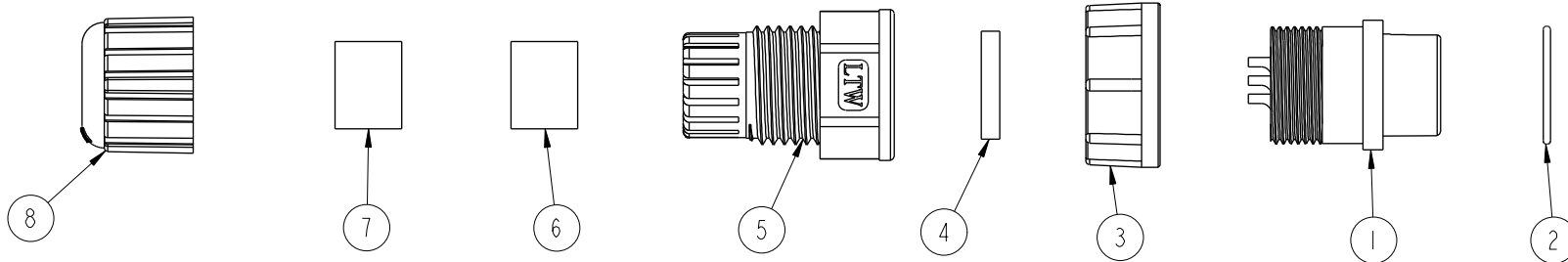

Pin Assignments
Front View

Notes:

- * \varnothing Important Dimension To Check.
- * Waterproof Rate: IP67
- * Housing: Nylon+GF, Black.
- * Male Pin: Copper Alloy, Gold Plated.
- * O-Ring: EPDM, Black.
- * Lock Nut: Nylon+GF, Black.
- * Gasket: EPDM, Black.
- * Clamp Ring: Nylon, Black.
- * Sealing Nut: Nylon, Black.
- * Seals B1 for Cable OD: $\varnothing 7.6\text{mm} \sim \varnothing 9.6\text{MM}$
- * Seals B2 for Cable OD: $\varnothing 4.0\text{MM} \sim \varnothing 7.6\text{MM}$
- * One Set Unassembled in One PE Bag.

UNIT: mm

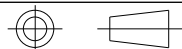

TOLERANCE
.X ±0.25
.XX ±0.1
.XXX ±0.05
ANGLES ±1°

TITLE MIDDLE ASSY LOCK 5PIN F CONN M PIN			
SCALE 1:1	SIZE A4	SHEET 1 OF 1	
REV. A	WC-REV. A.2	Ⓞ: Inspection item	

Amphenol LTW
安費諾亮泰企業股份有限公司

ITEM NO. CB-05BFMA-LL7001	DRAWN BY SamChang	DATE 2012-04-05
DWG NO. CB-05BFMA-LL7001	CHECKED BY Jeffrey	DATE 2012-04-25
CUSTOMER ALTW	APPROVED BY Lion	DATE 2012-04-25

THIS DOCUMENT IS SUBJECT TO CHANGE WITHOUT NOTICE. IT IS CONFIDENTIAL AND A PROPERTY OF AMPHENOL LTW. DISCLOSURE TO THIRD PARTY HAS TO BE AUTHORIZED BY AMPHENOL LTW.