

10 9 8 7 6 5 4 3 2 1

PLATING OPTION	ASSEMBLY PART NO.	CKT SIZE	A	B	C	D	VOID PIN
TIN/LEAD	70246-3480	34	1,600/40.64	1,880/47.75	2,000/50.80	1,900/48.26	5
TIN	70246-3485	34	1,600/40.64	1,880/47.75	2,000/50.80	1,900/48.26	5

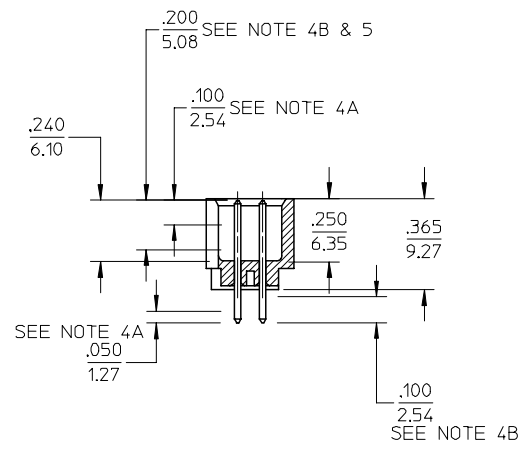

SECTION E-E

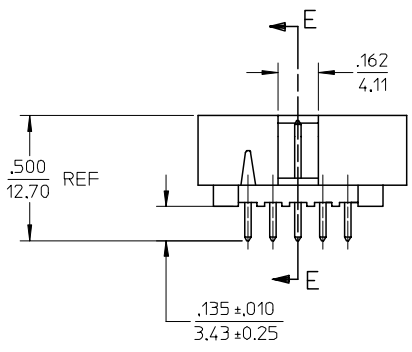
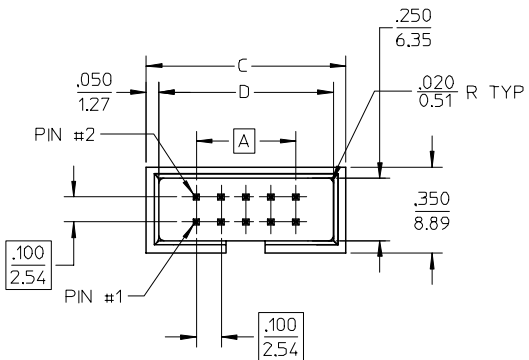
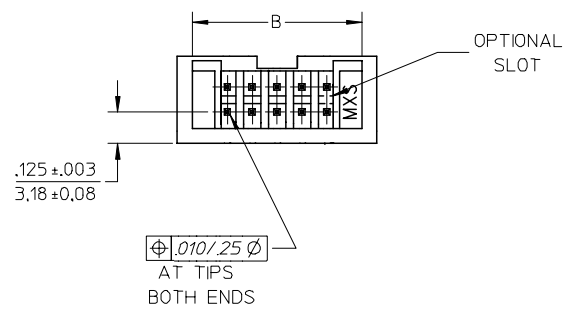

NOTES:

1. MATERIAL : PINS .025 SQUARE. WAFER 15% G.F. PBT
2. PIN PUSHOUT FORCE (9.072KG)/2LBS MIN.
3. PRODUCT SPEC: PS-70246 APPLIES.
4. WAFER TO BE FLAT WITHIN (0.03MM/CM) 0.003IN/IN
5. DIMENSIONS FOR PLATING LOCATION : A-MEASURE POINT FOR THICKNESS. B-MINIMUM COVERAGE
6. GOLD END OF PIN UNLESS OVERALL PLATED.
7. FINISH : (ALL WITH 50uin MIN NICKEL UNDERPLATE OVERALL.) 15uin MIN AU & 75uin TIN OR TIN/LEAD IN SELECTED AREAS.

ADD ASSY P/N FOR LF	REV	DESCRIPTION
EC NO: S2005-0480	2004/12/15	DRWN:KSEE
	2004/12/15	CHKD:PTLIM
	2004/12/17	APPR:SKTOH

QUALITY SYMBOLS
▽=0
▽=0

GENERAL TOLERANCES (UNLESS SPECIFIED)
4 PLACES ± --- ± ---
3 PLACES ± --- ± .008
2 PLACES ± 0.20 ± ---
1 PLACE ± --- ± ---
ANGULAR ± 3 °
DRAFT WHERE APPLICABLE MUST REMAIN WITHIN DIMENSIONS

DIMENSION STYLE	
IN/MM	
DRAWN BY	DATE
KCLING	1992/12/07
CHECKED BY	DATE
GWANG	1992/12/07
APPROVED BY	DATE
RWONG	1992/12/07
MATERIAL NO.	DOCUMENT NO.
SEE TABLE	SD-70246-3480

SCALE	DESIGN UNITS	THIRD ANGLE PROJECTION
NTS	METRIC	
TITLE		
C-GRID SHROUDED HEADER W/ VOID OPTION (SLOTTED W/O STANDOFFS)		
MOLEX INCORPORATED		
SHEET NO.		1 OF 1

9 8 7 6 5 4 3 2 1