

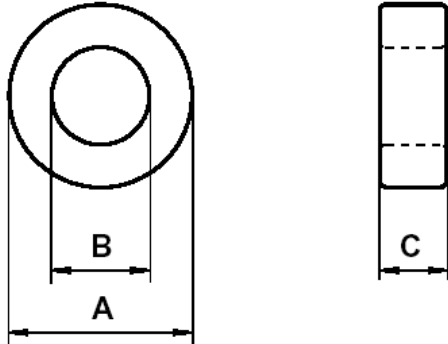

Specification for:
ZW41306TC

110 Delta Drive
Pittsburgh, PA 15238
Phone: 412/696-1333
Fax: 412/696-0333
Email:magnetics@spang.com

DIMENSIONS



(mm)	Uncoated Nominal:	Coated Min:	Coated Max:
O.D. (A)	12.7	12.43	13.47
I.D. (B)	7.92	7.16	8.18
Ht. (C)	6.35	6.19	7.01

Eff. Parameters		
A _e mm ²	l _e mm	V _e mm ³
14.9	31.2	465

INDUCTANCE

AL value (nH/T ²)	Test conditions
5936 ± 30%	10 kHz, 0.5 mT (For N = 5, use 0.15 mA), 25°C

ELECTRICAL LOSSES

tan δ / μ _i	Production lot limit Average	Test conditions	
≤ 3.5 · 10 ⁻⁶	≤ 3 · 10 ⁻⁶	10 kHz	0.5 mT, 25°C
≤ 55 · 10 ⁻⁶	≤ 45 · 10 ⁻⁶	100 kHz	

COATING

Epoxy rated for 200°C continuous operation.
Voltage breakdown rating 1,500 V Min Wire-to-Wire.

NOTE

Spec. Modifications	Previous	Revised
2005.12.16	Breakdown voltage > 1,000 V LF: General W material	Breakdown voltage > 1,500 V LF: Detail as indicated