



2200-2300 MHz Cavity Bandpass Filter

Part Number: AB2250B1153



ANATECH ELECTRONICS INC
RF & Microwave Filters & Products

Electrical specifications

- Passband:** 2200-2300MHz
- Passband Insertion Loss:** ≤0.8dB
- Passband Ripple:** ≤0.4dB
- Passband Return Loss:** ≥19dB
- Rejection:** ≥95dB@DC-2120MHz
- Rejection 2:** ≥95dB@2400-4000MHz
- Power Handling:** 40W(CW)
- Input / Output Impedance:** 50 Ohms

Mechanical

- Connector Type:** N-Female/N-Female
- Dimensions:** 4.57 x 2.52 x 1.58 inches

Environmental

- Operating Temperature:** -20 to +55 deg. C
- Storage temperature:** -65 to +95 deg.C
- Shock:** 20 G's, ½ sine, 11ms
- Vibration:** 10 G's, 10-2000Hz
- Relative Humidity:** 0-95%
- Environmentally Sealed:** IP65

Outline Drawing:

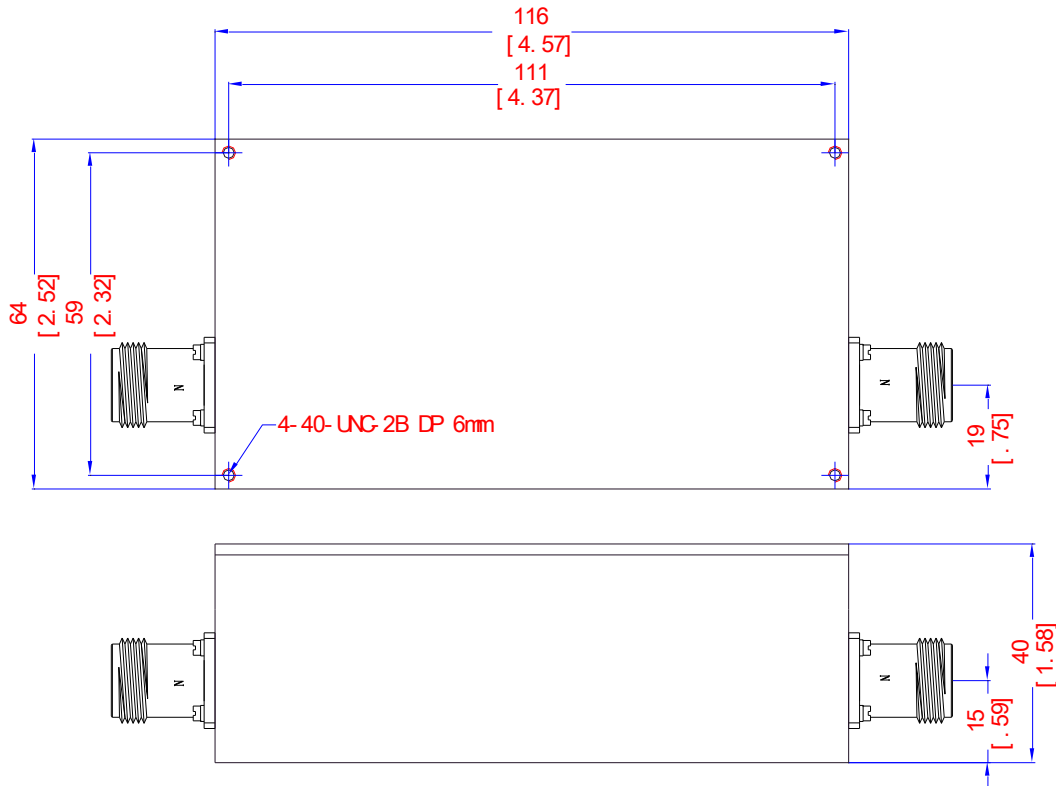



Response Plot:

