

LOOSE PIECE		TAPE MOUNTED		SPECIFICATIONS						
MATERIAL NUMBER	ENGINEERING NUMBER	MATERIAL NUMBER	ENGINEERING NUMBER	STUD SIZE	"S" ±.005 [0.13]	"W" ±.010 [0.25]	"C" MIN.	"L" MAX.	"H"	STOCK ±.001 [0.025] THICKNESS
190570037	B-501-12HD	---	---	12	.515 [13.08]	.750 [19.05]	.611 [15.52]	1.700 [43.18]	---	.050 [1.27]
190570041	B-501-76HD	---	---	76	.453 [11.51]					
190570067	B-528-08HD	---	---	8	.173 [4.39]	.375 [9.53]	.303 [7.70]	1.205 [30.61]	---	.050 [1.27]
190570069	B-528-10HD	---	---	10	.198 [5.03]					
190570073	B-530-14HD	---	---	14	.265 [6.73]	.530 [13.46]	.393 [9.98]	1.372 [34.85]	---	.050 [1.27]
190570075	B-530-56HD	---	---	56	.328 [8.33]					
190570082	B-536-06HD	---	---	6	.146 [3.71]	.282 [7.16]	.306 [7.77]	1.161 [29.49]	---	.050 [1.27]
190570084	B-536-08HD	---	---	8	.173 [4.39]					
190570109	B-540-38HD	190570110	B-540-38HDT	38	.390 [9.91]	.592 [15.04]	.466 [11.84]	1.476 [37.49]	1.172 [29.77]	.050 [1.27]
190570111	B-540-56HD	---	---	56	.328 [8.33]					

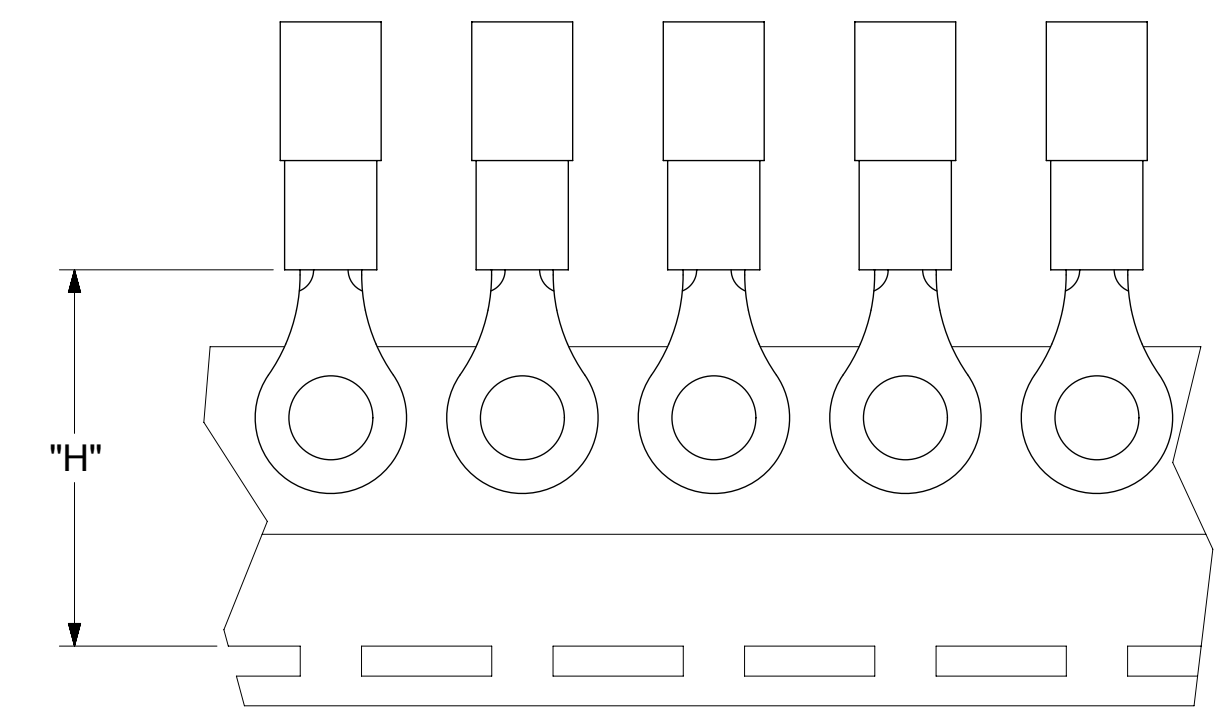
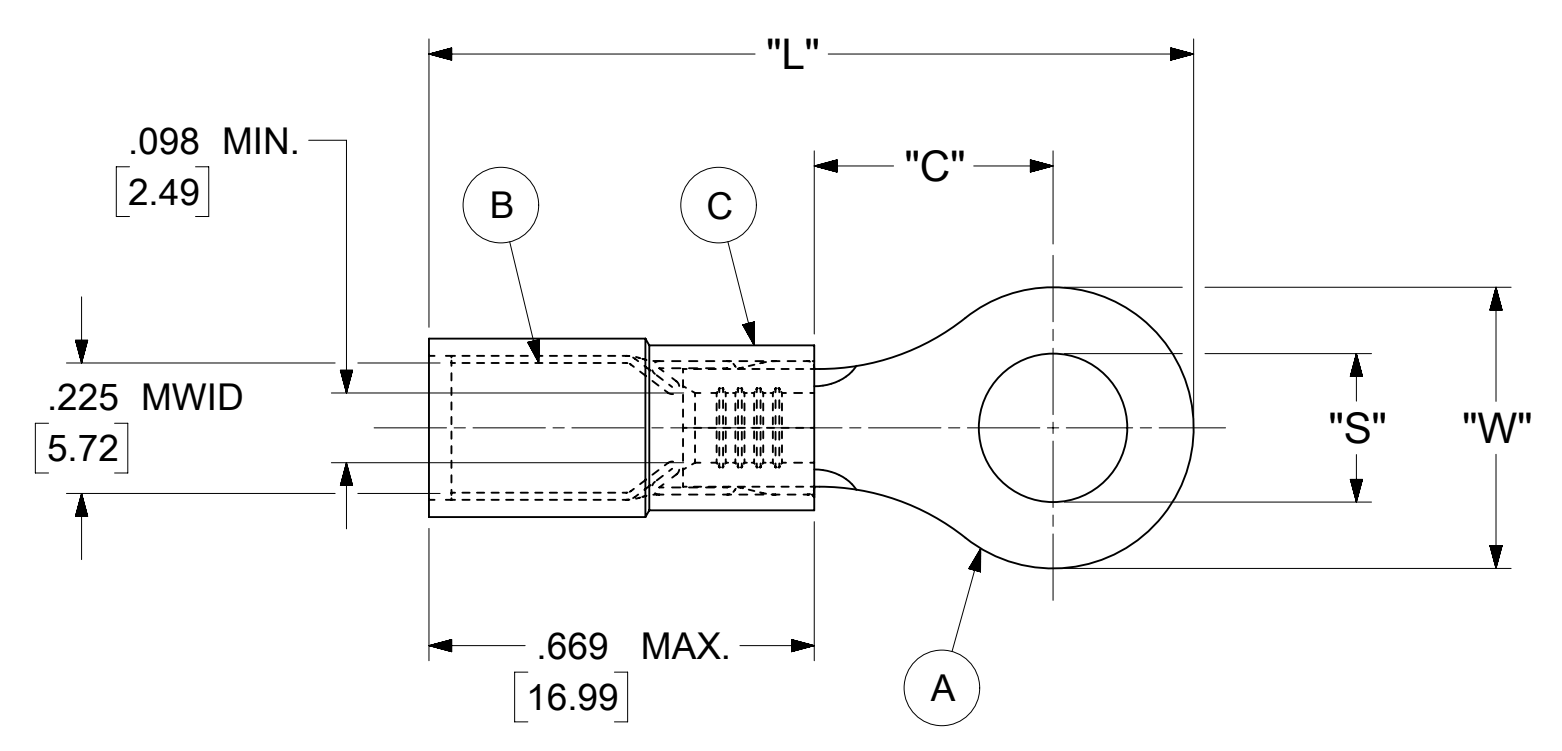

PARTS ON TAPE

- NOTES:
- MATERIAL:
 - (A). RING TONGUE TERMINAL: COPPER
PLATING: ELECTRO-TIN (.0003 MIN.)
 - (B). TIN-PLATED BRASS FUNNEL FERRULE
 - (C). INSULATION: NYLON (YELLOW)
 - MWID: MAXIMUM WIRE INSULATION DIAMETER
 - WIRE SIZE: 16 -14 AWG
1.0 -2.5 MM²
 - "UL" LISTING #E32244
"CSA" LISTING #18689
 - ALL DIMENSIONS IN INCHES/[MM].
 - PARTS ARE ROHS COMPLIANT.
 - DIMS. SHOWN ARE FOR REFERENCE ONLY.

THIS DRAWING CONTAINS INFORMATION THAT IS PROPRIETARY TO MOLEX ELECTRONIC TECHNOLOGIES, LLC AND SHOULD NOT BE USED WITHOUT WRITTEN PERMISSION									
SYMBOLS		DIMENSION UNITS		SCALE		CURRENT REV DESC:			
▽ = 0	INCH/MM	NTS							
▽ = 0	GENERAL TOLERANCES (UNLESS SPECIFIED)								
▽ = 0		MM	INCH						
▽ = 0	4 PLACES	±	---	±	---	EC NO: 625846			
▽ = 0	3 PLACES	±	---	±	0.005	DRWN: ABENJAMINLW 2019/08/28			
▽ = 0	2 PLACES	±	0.13	±	0.01	CHK'D: GROJAS01 2019/10/17			
▽ = 0	1 PLACE	±	0.25	±	---	APPR: JMACNEIL 2019/10/18			
▽ = 0	0 PLACES	±	---	±	---	INITIAL REVISION:			
▽ = 0	ANGULAR TOL	±	0.5 °			DRWN: JJ 1984/11/29			
▽ = 0	DRAFT WHERE APPLICABLE MUST REMAIN WITHIN DIMENSIONS		THIRD ANGLE PROJECTION		DRAWING		SERIES		
▽ = 0			C-SIZE		19057				
DOCUMENT STATUS		P1		RELEASE DATE		2019/10/18		22:51:53	

molex

RING TONGUE HEAVY DUTY
TERMINAL AVIKRIMP 500-SERIES

PRODUCT CUSTOMER DRAWING

DOCUMENT NUMBER	DOC TYPE	DOC PART	REVISION
BHDCD50101	PSD	001	A

MATERIAL NUMBER	CUSTOMER	SHEET NUMBER
SEE TABLE	GENERAL MARKET	1 OF 1