

**Material and Finish**

Shell: Steel, Nickel Plated  
 Insulator: PBT thermoplastic with glass-fiber reinforcement, UL94V-0 rated  
 Color: Black  
 Contact Material:  
 Plug - Brass  
 Contact Plating Options:  
 Standard: gold flash on mating end, tin on termination end, nickel underplate on entire contact  
 15 Option: 15u" gold on mating end, tin on termination end, nickel underplate on entire contact  
 30 Option: 30u" gold on mating end, tin on termination end, nickel underplate on entire contact

**Electrical Specifications**

Rated Current: 1.5A  
 Rated Voltage: 29 Vac  
 Insulation Resistance: more than 1000 megohms at 500V DC  
 Contact Resistance: 13 milliohms max.  
 Dielectric Strength: 1000V for 1 minute  
 Durability Rating: 500 mating cycles min.  
 Operating Temperature: -55°C to +75°C

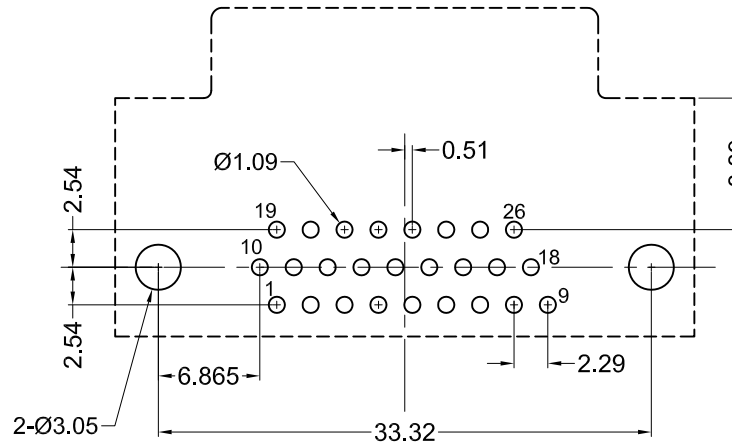
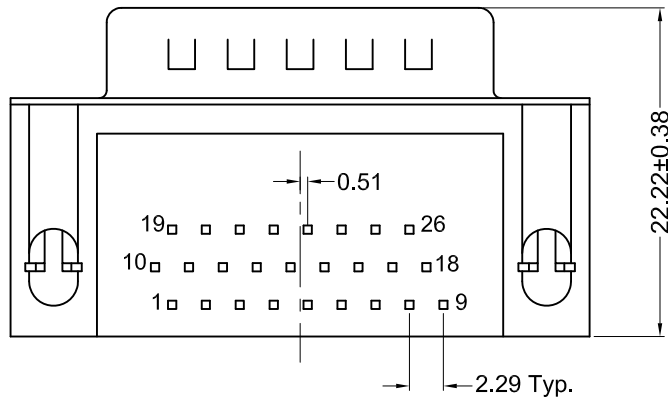

Recommended PCB Layout (Bottom View)

Part Number	Contact Area Plating Finish
K66X-A26P-N	Gold Flash (standard)
K66X-A26P-N15	15u" Gold (15 option)
K66X-A26P-N30	30u" Gold (30 option)



Tolerances
X.X ± 0.25
X.XX ± 0.15
Unless Stated Otherwise

REV.	DATE	DESCRIPTION	REV. BY	CHK. BY	DRAWN BY	DATE		
A1	12/14/05	New Drawing	R. Aguirre	H. MA	R. Aguirre	10/05/05		
A2	02/27/08	ECO # 07-049	S. Vien	H. Ma				
A3	12/11/08	ECO #08-084	S. Vien	H. MA		UNITS		
A4	06/04/14	ECO #14-027	H. MA	P. DalCanto				
A5	02/17/16	ECO #15-019	H. MA	W. Cook				
A6	12/31/17	ECO #17-028	J. Elbanna	C. Furumasu				
								mm

**K66X-A26P-N**

High Density D-Sub, RoHS Compliant

Male, 26 Pos., Grounding Board Locks

