

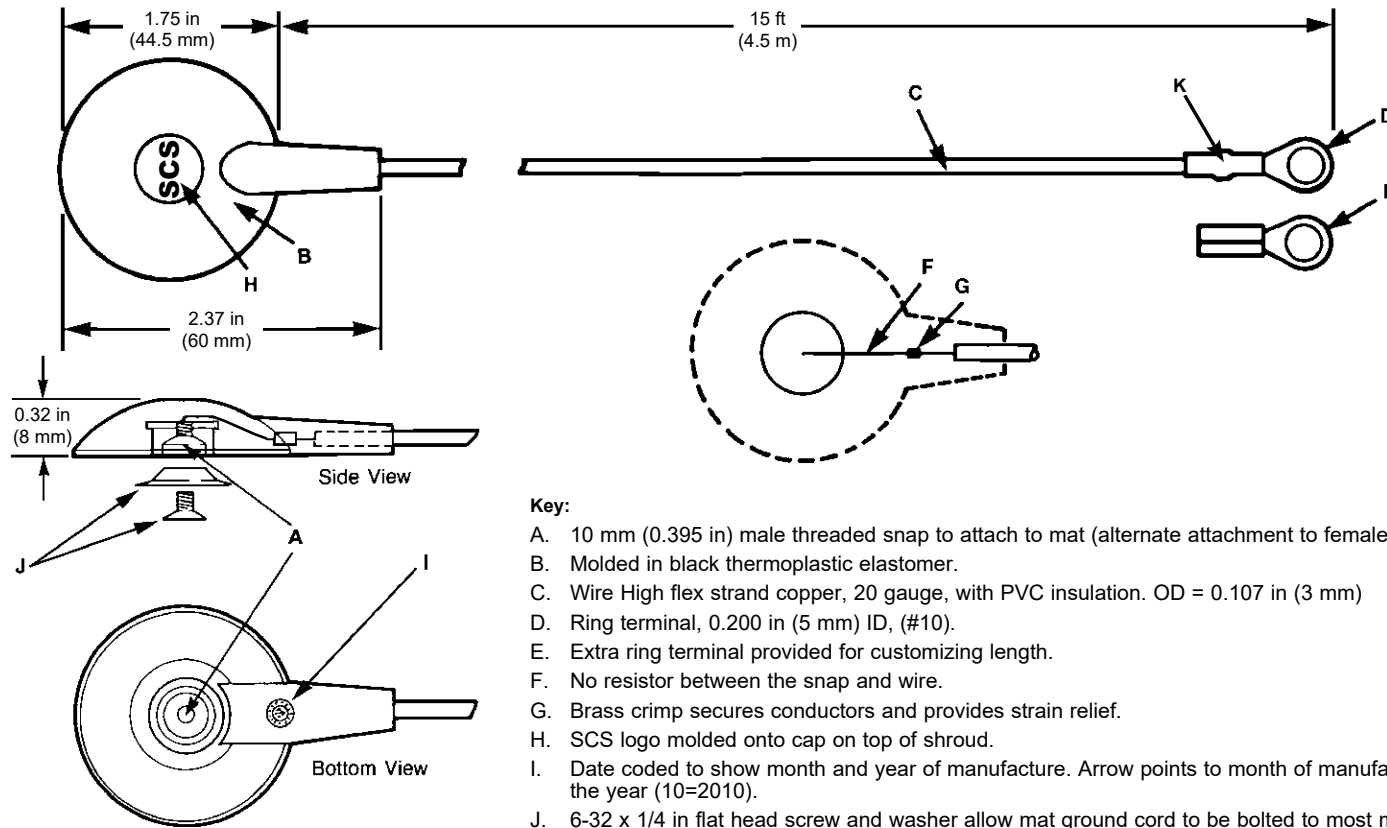

Made in the United States of America



**Key:**

- A. 10 mm (0.395 in) male threaded snap to attach to mat (alternate attachment to female socket snap).
- B. Molded in black thermoplastic elastomer.
- C. Wire High flex strand copper, 20 gauge, with PVC insulation. OD = 0.107 in (3 mm)
- D. Ring terminal, 0.200 in (5 mm) ID, (#10).
- E. Extra ring terminal provided for customizing length.
- F. No resistor between the snap and wire.
- G. Brass crimp secures conductors and provides strain relief.
- H. SCS logo molded onto cap on top of shroud.
- I. Date coded to show month and year of manufacture. Arrow points to month of manufacture (12:00 = December), numerals indicate the year (10=2010).
- J. 6-32 x 1/4 in flat head screw and washer allow mat ground cord to be bolted to most mats by shorter or alternate longer screw (x 3/8 in long) depending on mat thickness.
- K. Heat shrink tubing applied on ring terminal end of the cord.

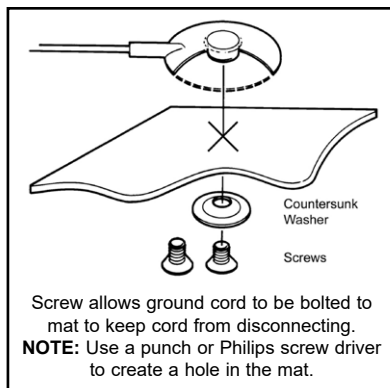

Item	Wire Insulation Color	Resistance
770115	Green / Yellow	No Resistor

Unless otherwise specified tolerance  $\pm 10\%$   
Specifications and procedures subject to change without notice.

**GROUND CORD, MAT, THREADED 10 MM SNAP STUD**



926 JR Industrial Drive, Sanford, NC 27332  
WEB SITE: [StaticControl.com](http://StaticControl.com)  
PHONE: EAST (919) 718-0000 | WEST: (909) 627-9634

**DRAWING NUMBER**  
770115

**DATE:**  
April  
2019