

ASS'Y P/N	CABLE O.D.
8280-XPG-513	.13-.15 [3.3-3.8]
8280-XPG-516	.16-.18 [4.1-4.6]
8280-XPG-519	.19-.21 [4.8-5.3]
8280-XPG-522	.22-.25 [5.6-6.4]
8280-XPG-526	.25-.27 [6.3-6.8]
8280-XPG-528	.265-.285 [6.6-7.1]

ASSEMBLY P/N	CONTACT QTY
8280-2PG-5XX	2 #20
8280-3PG-5XX	3 #20
8280-4PG-5XX	4 #20
8280-5PG-5XX	5 #20
8280-6PG-5XX	6 #20
8280-7PG-5XX	7 #20
8280-8PG-5XX	8 #20
8280-XPG-5XX	

NOTES:
 1. ALL PARTS TO BE BULK PACKED
 2. CONTACTS SHIPPED UNASSEMBLED
 3. ALL DIMENSIONS ARE REFERENCE EXCEPT THOSE WITH A TOLERANCE

CUSTOMER APPROVAL

THIS DOCUMENT CONTAINS CONFIDENTIAL INFORMATION PROPRIETARY TO CONXALL CORPORATION. ANY REPRODUCTION, DISCLOSURE, OR USE OF THIS DOCUMENT /INFORMATION IS EXPRESSLY PROHIBITED UNLESS AUTHORIZED IN WRITING BY CONXALL CORPORATION.

APPROVED BY: _____
 DATE: _____

CUSTOMER PRINT

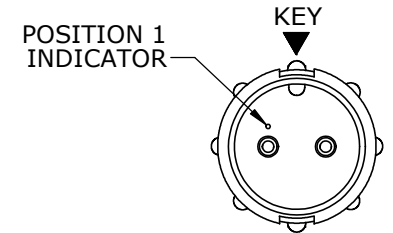

FACE VIEW
8280-2PG-5XX SHOWN

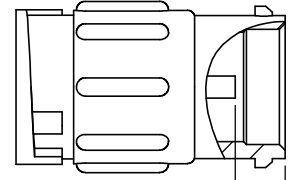

.173±.015
CONTACT HEIGHT

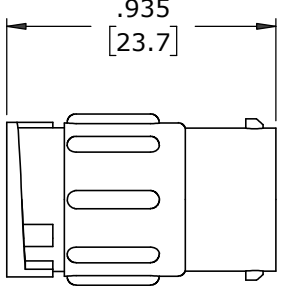

.935
[23.7]

IN-LINE CONNECTOR, MALE
MAT'L: NYLON, BLACK

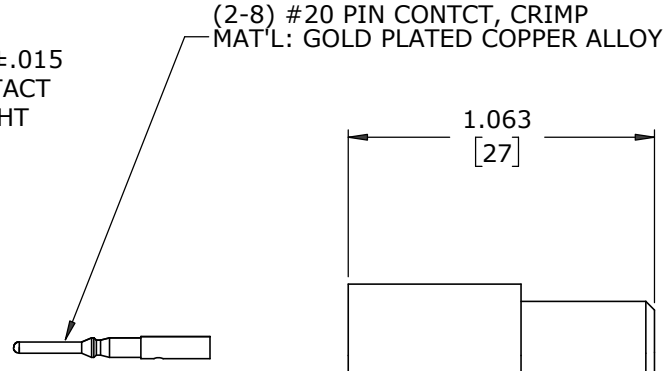

(2-8) #20 PIN CONTCT, CRIMP
MAT'L: GOLD PLATED COPPER ALLOY

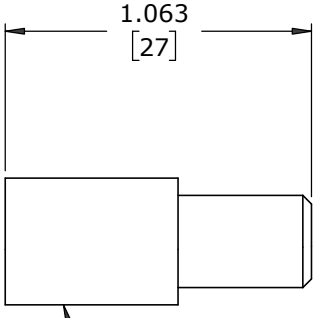

1.063
[27]

GROMMET
MAT'L: RUBBER, BLACK

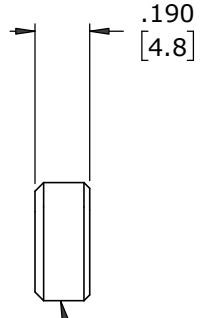

.190
[4.8]

CABLE GRIP
MAT'L: POLYPROPYLENE, BLACK

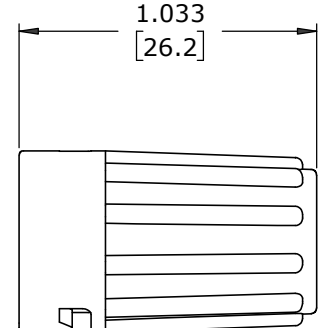

1.033
[26.2]

BACKSHELL
MAT'L: NYLON, BLACK

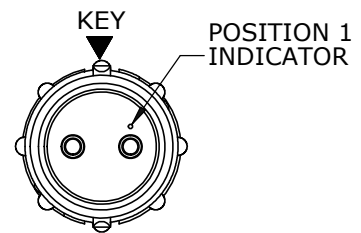

WIRE VIEW
8280-2PG-5XX SHOWN

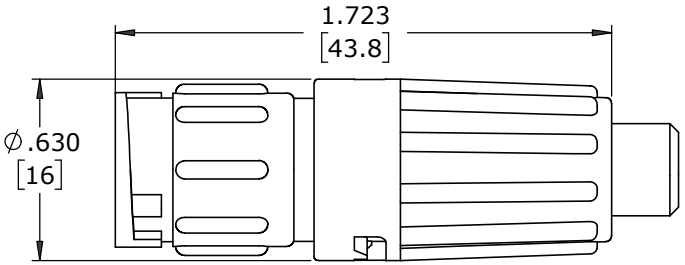

Ø.630
[16]

1.723
[43.8]

SHOWN ASSEMBLED
FOR CUSTOMER REFERENCE ONLY

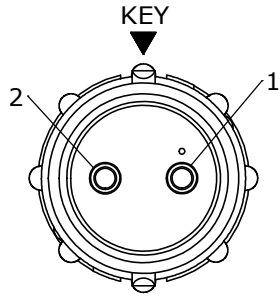

WIRE VIEW
8280-2PG-5XX

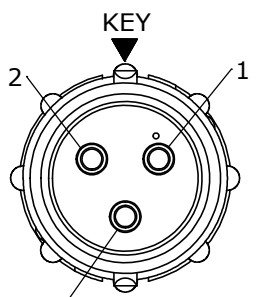

WIRE VIEW
8280-3PG-5XX

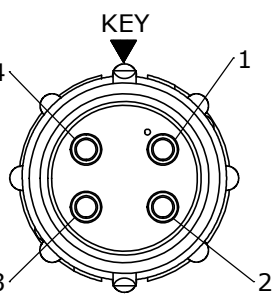

WIRE VIEW
8280-4PG-5XX

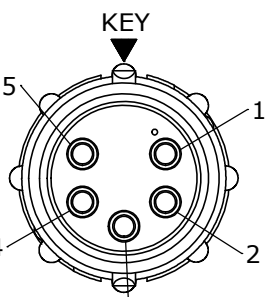

WIRE VIEW
8280-5PG-5XX

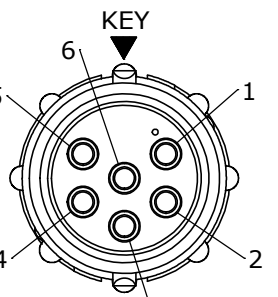

WIRE VIEW
8280-6PG-5XX

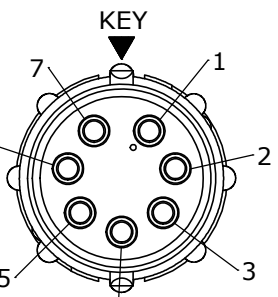

WIRE VIEW
8280-7PG-5XX

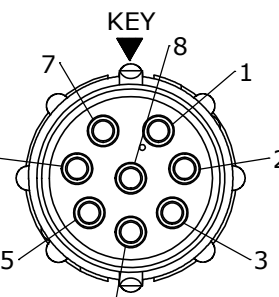

WIRE VIEW
8280-8PG-5XX

DIMENSIONS IN BRACKETS [] ARE IN MILLIMETERS UNLESS INDICATED

RoHS COMPLIANT

A	MA	02-04-21	DRAWING CREATED PER DOR 21-S149SL-2	
REV.	INIT.	DATE	DESCRIPTION	
			ORIG. DRAWN BY: MA	DATE: 02-04-21
<small>ALL INFORMATION ILLUSTRATED IS THE PROPERTY OF "CONXALL CORPORATION". UNAUTHORIZED DUPLICATION OR DISTRIBUTION OF THIS DOCUMENT IS PROHIBITED.</small> <small>ALL UNITS ARE IN FEET, INCHES, FRACTION OF INCHES AND DECIMALS.</small>			 601 E. WILDWOOD VILLA PARK, IL 60181	
APPROVED BY:			PART NUMBER: 8280-XPG-5XX	
SCALE	SIZE	SHEET	REV	
NTS	B	1 OF 1	A	
FILE:	DIRECTORY:			
8280-XPG-5XX	SLW			